

MARTIN, MARSHA H, BERTRAM T III,  
MARTIN, THOMAS H, MYERS, ALLENE  
2805 PARKLAND BLVD  
TAMPA FL 33609

B26102P158

Property Data			Assessment Record				
Neighborhood	5 Little Sebago		Year	Land	Buildings	Exempt	Total
Tree Growth Year	0		2011	9,750	0	0	9,750
REVIEW	0		2012	9,750	0	0	9,750
Building Permit	0		2013	9,750	0	0	9,750
Zone/Land Use	12 Limited Residential		2014	9,750	0	0	9,750
Secondary Zone	23 Lake District		2015	9,800	0	0	9,800
Topography	2 Rolling		2016	9,800	0	0	9,800
1. Hill	4. Below St	7.	2017	9,800	0	0	9,800
2. Rolling	5. Low	8.	2018	9,800	0	0	9,800
3. Above St	6. Swampy	9.	2019	11,500	0	0	11,500
4. Multiple			2020	11,500	0	0	11,500
1. Public	4. Dug Well/Po	7. Cesspool	2021	11,500	0	0	11,500
2. Water	5. Dug Well	8. Lake	2022	11,500	0	0	11,500
3. Holding Ta	6. Septic	9. None	2023	12,400	0	0	12,400
Street	3 Gravel		Calc.	28,600	0	0	28,600
1. Paved	4. Proposed	8.					
2. Semi Imp	5. R/O/W	9.					
3. Gravel	6.						

Inspection Witnessed By:

X	Date	Date Insp.
No./Date	Description	Date Insp.

Notes:

Gray

Sale Data		
Sale Date	5/19/2008	
Price		
Sale Type		
1. Land	4. Mobile	7. COM
2. L & B	5. Other	8.
3. Building	6. Condo	9.
Financing		
1. Convent	4. Seller	7.
2. FHA/VA	5. Private	8.
3. Assumed	6. Cash	9. Unknown
Validity		
1. Valid	4. Split	7. Multiple
2. Related	5. Partial	8. Other
3. Distress	6. Exempt	9. Estate
Verified		
1. Buyer	4. Agent	7. Family
2. Seller	5. Pub Rec	8. Other
3. Lender	6. MLS	9.

Front Foot	Type	Effective		Influence		Influence Codes
		Frontage	Depth	Factor	Code	
11. Water (0-200)				%		1. Unimproved
12. Water (201-400)				%		2. Excess Frtg
13. Water (401-800)				%		3. Topography
14. Water (801-160)				%		4. Size/Shape
15. Water (1601-32)				%		5. Access
				%		6. Restriction
				%		7. Open Space
				%		8. Environmental
				%		9. Condo
				%		30. Blueberry(1-20
				%		31. Blueberry(21 -
				%		32. Crop Land
				%		33. Pasture
				%		34. Shorefront B
				%		35. Shorefront C
				%		36. ANTENNA SITE
				%		37. Softwood TG
				%		38. Mixed Wood TG
				%		39. Hardwood TG
				%		40. Wasteland
				%		41. Woodland
				%		42. Mobile Home Si
				%		43. Camp Site
				%		44. Lot Improvemen
				%		45. BA SF - Oce
				%		46. SP Meadow Cond
<b>Total Acreage</b>		0.17				

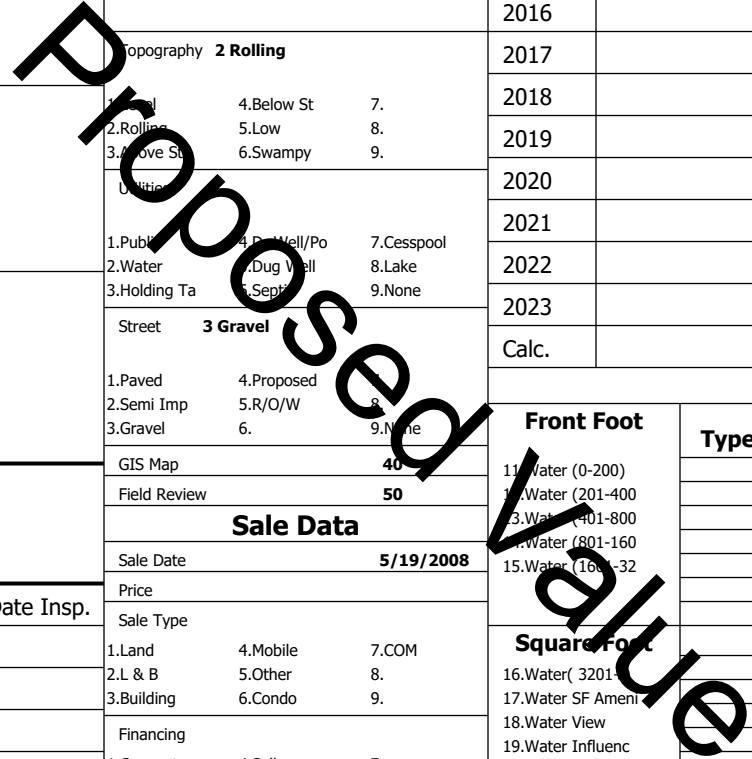

Gray

Map Lot 040-317-035-000

Account 4194

Location 85 NORTHERN OAKS DR

Card 1

Of 1

8/05/2024

Building Style <b>0</b>	SF Bsmt Living <b>0</b>	Layout <b>0</b>
1.Conv. 5.Garrison 9.NE farm	Fin Bsmt Grade <b>0 0</b>	1.Typical 4. 7.
2.Ranch 6.Split 10.Colonia	Secondary Heat <b>0</b>	2.Inadeq 5. 8.
3.R Ranch/ 7.Contemp 11.Cottage	Heat Type <b>100% 0</b>	3. 6. 9.
4.Cape 8.Log 12.Gambrel	1.HWBB 5.FWA 9.None	Attic <b>0</b>
Dwelling Units <b>0</b>	2.HWCI 6.Monitor 10.UNH2F	1.1/4 Fin 4.Full Fin 7.
Other Units <b>0</b>	3.HWRF 7.Electric 11.Geother	2.1/2 Fin 5.FI/Stair 8.
Stories <b>0</b>	4.Steam 8.FI/Wall 12.Heat/Co	3.3/4 Fin 6. 9.None
1.1 4.1.5 7.	Cool Type <b>0% 9 None</b>	Insulation <b>0</b>
2.2 5.1.75 8.	1.Central 4.W&C Air 7.	1.Full 4.Minimal 7.
3.3 6.2.5 9.	2.Evapor 5. 8.	2.Heavy 5. 8.
Exterior Walls <b>0</b>	3.H Pump 6. 9.None	3.Capped 6. 9.None
1.Clapboar 5.Stucco 9.B & B	Kitchen Style <b>0</b>	Unfinished % <b>0%</b>
2.Vin/Al 6.Brick 10.Cemplan	1.Modern 4.Obsolete	Grade & Factor <b>0 0%</b>
3.Compos./ 7.Stone 11.Concret	2.Typical 5. 8.	1.E Grade 4.B Grade 7.SC Grade
4.Asbestos 8.Wood Shi 12.Wood Bo	3.Old Type 6. 9.None	2.C Grade 5.A Grade 8.
Roof Surface <b>0</b>	Bath(s) Style <b>0</b>	3.D Grade 6.AA Grade 9.Same
1.Asphalt 4.Composit 7.Other	1.Modern 4.Obsolete 7.	SQFT (Footprint) <b>0</b>
2.Slate 5.Wood 8.	2.Typical 5. 8.	1.Poor Avg 7.V G
3.Metal 6.Roll Roo 9.	3.Old Type 6. 9.None	2.Fair Avg 8.Exc
SF Masonry Trim <b>0</b>	# Rooms <b>0</b>	3.Avg- Good 9.Same
SOLAR VOLTAIC <b>0</b>	# Bedrooms <b>0</b>	Phys. % Good <b>0%</b>
OPEN-4- <b>0</b>	# Full Baths <b>0</b>	Funct. % Good <b>100%</b>
Year Built <b>0</b>	# Half Baths <b>0</b>	Functional Code <b>9 None</b>
Year Remodeled <b>0</b>	# Addn Fixtures <b>0</b>	1.Incomp 4.Delap 7.Layoff
Foundation <b>0</b>	# Fireplaces <b>0</b>	2.O-Built 5.Bsmt 8.Long term
1.Concrete 4.Wood 7.		3.Damage 6.Style None
2.C Block 5.Slab 8.		Econ. % Good <b>100%</b>
3.Br/Stone 6.Piers 9.		Economic Code <b>None</b>
Basement <b>0</b>		0.None 3.No Power 6.Obsolete
1.1/4 Bmt 4.Full Bmt 7.		1.Location 4.Generate 9.None
2.1/2 Bmt 5.Crwl 8.		2.Encroach 5.Flood Pl 9.
3.3/4 Bmt 6. 9.None		Entrance Code <b>0</b>
Bsmt Gar # Cars <b>0</b>		1.Interior 4.Vacant 7.
Wet Basement <b>0</b>		2.Refusal 5.Estimate 8.
1.Dry 4. 7.		3.Informed 6. 9.
2.Damp 5. 8.		Information Code <b>0</b>
3.Wet 6. 9.		1.Owner 4.Agent 7.
		2.Relative 5.Estimate 8.
		3.Tenant 6.Other 9.



Date Inspected 8/20/2015

**Additions, Outbuildings & Improvements**

Type	Year	Units	Grade	Cond	Phys.	Funct.	Sound Value
					%	%	1.One Story Fram
					%	%	2.Two Story Fram
					%	%	3.Three Story Fr
					%	%	4.1 & 1/2 Story
					%	%	5.1 & 3/4 Story
					%	%	6.2 & 1/2 Story
					%	%	21.Open Frame Por
					%	%	22.Encl Frame Por
					%	%	23.Frame Garage
					%	%	24.Frame Shed
					%	%	25.Frame Bay Wind
					%	%	26.1SFr Overhang
					%	%	27.Unfin Basement
					%	%	28.Unfinished Att
					%	%	29.Finished Attic

Proposed Value