

LAVERDIERE, MICHELE L  
LAVERDIERE, TREVOR A  
9288 MOUNTAIN RD  
GRANTVILLE PA 17028

B29626P187

<b>Property Data</b>		
Neighborhood	5 Little Sebago	
Tree Growth Year	0	
REVIEW	0	
Building Permit	0	
Zone/Land Use	12 Limited Residential	
Secondary Zone		
Topography	1 Level	
1. Soil	4. Below St	7.
2. Rolling	5. Low	8.
3. Above St	6. Swampy	9.
1. Public Well/Point	4. Filled Well/Point	
2. Water	4. Dug Well/Po	7. Cesspool
3. Holding Ta	5. Septic	8. Lake
		9. None
Street	3 Gravel	
1. Paved	4. Proposed	8.
2. Semi Imp	5. R/O/W	9.
3. Gravel	6.	None
GIS Map	40	
Field Review	50	

Inspection Witnessed By:

X		Date
No./Date	Description	Date Insp.

Notes:

Gray

<b>Assessment Record</b>				
Year	Land	Buildings	Exempt	Total
2011	246,960	99,531	13,600	332,891
2012	246,960	99,531	13,600	332,891
2013	246,960	99,531	13,600	332,891
2014	246,960	99,531	13,600	332,891
2015	247,000	99,500	14,400	332,100
2016	247,000	99,500	0	346,500
2017	247,000	99,500	0	346,500
2018	247,000	99,500	0	346,500
2019	413,200	163,400	0	576,600
2020	413,200	163,400	0	576,600
2021	413,200	163,400	0	576,600
2022	413,200	163,400	0	576,600
2023	413,200	182,800	0	596,000
Calc.	826,300	266,500	0	1,092,800

<b>Land Data</b>						
<b>Front Foot</b>	<b>Type</b>	<b>Effective</b>		<b>Influence</b>		<b>Influence Codes</b>
		<b>Frontage</b>	<b>Depth</b>	<b>Factor</b>	<b>Code</b>	
11. Water (0-200)	11	200	000	100 %	0	1.Unimproved
12. Water (201-400)				%		2.Excess Frtg
13. Water (401-800)				%		3.Topography
14. Water (801-160)				%		4.Size/Shape
15. Water (1601-32)				%		5.Access
				%		6.Restriction
				%		7.Open Space
				%		8.Environmental
				%		9.Condo
<b>Square Foot</b>						<b>Acres</b>
16. Water ( 3201				%		30.Blueberry(1-20
17. Water SF Amen				%		31.Blueberry(21 -
18. Water View				%		32.Crop Land
19. Water Influen				%		33.Pasture
20. ShoreFront A				%		34.Shorefront B
				%		35.Shorefront C
				%		36.ANTENNA SITE
				%		37.Softwood TG
				%		38.Mixed Wood TG
				%		39.Hardwood TG
				%		40.Wasteland
				%		41.Woodland
				%		42.Mobile Home Si
				%		43.Camp Site
				%		44.Lot Improvemen
				%		45.BA SF - Oce
				%		46.SP Meadow Cond
<b>Fract. Acre</b>						
21. Base Lot						
22. Base Lot Vacan						
23. Base Lot Unpav						
<b>Acres</b>						
24. Acres to 10						
25. Acres 11-30						
26. Acres 31-50						
27. Acres 51& over						
28. Acres 71 & Ove						
29. Woods (41+)						
<b>Total Acreage</b>						0.82

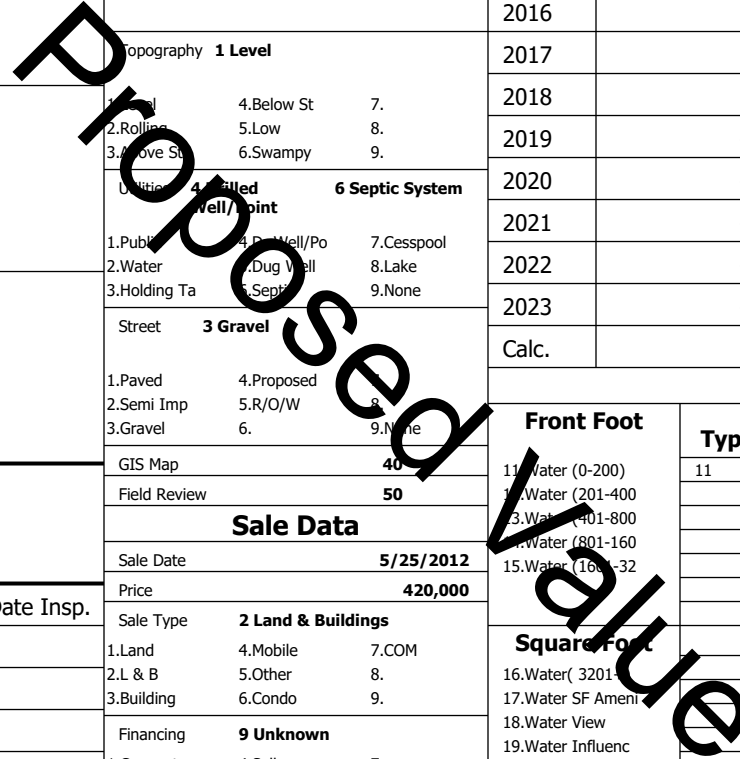

**Gray**

Map Lot 040-317-033-000

Account 4192

Location 81 NORTHERN OAKS DR

Card 1

Of 1

8/05/2024

Building Style <b>2 Ranch</b>	SF Bsmt Living <b>960</b>	Layout <b>1 Typical</b>
1.Conv. 5.Garrison 9.NE farm	Fin Bsmt Grade <b>3 100</b>	1.Typical 4. 7.
2.Ranch 6.Split 10.Colonia	Secondary Heat <b>0</b>	2.Inadeq 5. 8.
3.R Ranch/ 7.Contemp 11.Cottage	Heat Type <b>100% 8 Floor/Wall Unit</b>	3. 6. 9.
4.Cape 8.Log 12.Gambrel	1.HWBB 5.FWA 9.None	Attic <b>9 None</b>
Dwelling Units <b>1</b>	2.HWCI 6.Monitor 10.UNH2F	1.1/4 Fin 4.Full Fin 7.
Other Units <b>0</b>	3.HWRF 7.Electric 11.Geother	2.1/2 Fin 5.FI/Stair 8.
Stories <b>1 One Story</b>	4.Steam 8.FI/Wall 12.Heat/Co	3.3/4 Fin 6. 9.None
1.1 4.1.5 7.	Cool Type <b>0% 9 None</b>	Insulation <b>1 Full</b>
2.2 5.1.75 8.	1.Central 4.W&C Air 7.	1.Full 4.Minimal 7.
3.3 6.2.5 9.	2.Evapor 5. 8.	2.Heavy 5. 8.
Exterior Walls <b>2 Vinyl/Aluminum</b>	3.H Pump 6. 9.None	3.Capped 6. 9.None
1.Clapboar 5.Stucco 9.B & B	Kitchen Style <b>2 Typical</b>	Unfinished % <b>0%</b>
2.Vin/Al 6.Brick 10.Cemplan	1.Modern 4.Obsolete	Grade & Factor <b>3 Average 110%</b>
3.Compos./ 7.Stone 11.Concret	2.Typical 5. 8.	1.E Grade 4.B Grade 7.SC Grade
4.Asbestos 8.Wood Shi 12.Wood Bo	3.Old Type 6. 9.None	2.C Grade 5.A Grade 8.
Roof Surface <b>0</b>	Bath(s) Style <b>2 Typical Bath(s)</b>	3.C Grade 6.AA Grade 9.Same
1.Asphalt 4.Composit 7.Other	1.Modern 4.Obsolete 7.	SQFT (Footprint) <b>960</b>
2.Slate 5.Wood 8.	2.Typical 5. 8.	Condition <b>5 Good</b>
3.Metal 6.Roll Roo 9.	3.Old Type 6. 9.None	1.Poor 2.Avg 7.V G
SF Masonry Trim <b>0</b>	# Rooms <b>6</b>	2.Fair 3.Avg 8.Exc
SOLAR VOLTAIC <b>0</b>	# Bedrooms <b>3</b>	3.Avg- 4.Good 9.Same
OPEN-4- <b>0</b>	# Full Baths <b>2</b>	Phys. % Good <b>0%</b>
Year Built <b>1975</b>	# Half Baths <b>0</b>	Funct. % Good <b>100%</b>
Year Remodeled <b>0</b>	# Addn Fixtures <b>0</b>	Functional Code <b>9 None</b>
Foundation <b>1 Concrete</b>	# Fireplaces <b>0</b>	1.Incomp 4.Delap 5.Playo
1.Concrete 4.Wood 7.		2.O-Built 5.Bsmt 6.Long term
2.C Block 5.Slab 8.		3.Damage 6.Style 7.None
3.Br/Stone 6.Piers 9.		Econ. % Good <b>100%</b>
Basement <b>4 Full Basement</b>		Economic Code <b>None</b>
1.1/4 Bmt 4.Full Bmt 7.		0.None 3.No Power 6.Obsolete
2.1/2 Bmt 5.Crwl 8.		1.Location 4.Generate 9.None
3.3/4 Bmt 6. 9.None		2.Encroach 5.Flood Pl 9.
Bsmt Gar # Cars <b>0</b>		Entrance Code <b>3 Information Only</b>
Wet Basement <b>1 Dry Basement</b>		1.Interior 4.Vacant 7.
1.Dry 4. 7.		2.Refusal 5.Estimate 8.
2.Damp 5. 8.		3.Informed 6. 9.
3.Wet 6. 9.		Information Code <b>1 Owner</b>
		1.Owner 4.Agent 7.
		2.Relative 5.Estimate 8.
		3.Tenant 6.Other 9.

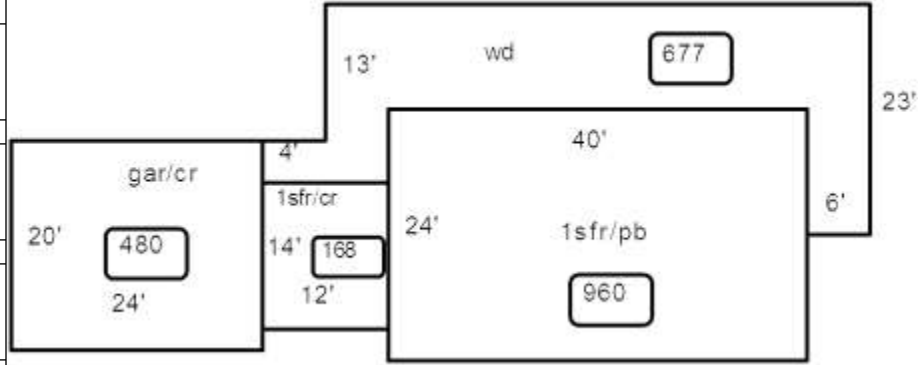

Date Inspected 8/20/2015

**Additions, Outbuildings & Improvements**

Type	Year	Units	Grade	Cond	Phys.	Funct.	Sound Value
1 One Story Frame	0	168	0 0	0	0 %	100 %	
23 Frame Garage	0	480	0 0	0	0 %	100 %	
68 Wood Deck	0	677	0 0	0	0 %	100 %	
85 Bunkhouse	0	324	3 100	4	0 %	100 %	
62 Patio	0	288	0 0	0	0 %	100 %	
					%	%	
					%	%	
					%	%	
					%	%	
					%	%	
					%	%	

