

LABRECQUE, MICHAEL E  
75 NORTHERN OAKS DR  
RAYMOND ME 04071

B7681P36

Property Data			Assessment Record						
Neighborhood <b>5 Little Sebago</b>			Year	Land	Buildings	Exempt	Total		
Tree Growth Year <b>0</b>			2011	138,650	58,545	8,500	188,695		
REVIEW <b>0</b>			2012	138,650	58,545	8,500	188,695		
Building Permit <b>0</b>			2013	138,650	58,545	8,500	188,695		
Zone/Land Use <b>12 Limited Residential</b>			2014	138,650	58,545	8,500	188,695		
Secondary Zone			2015	138,700	58,500	9,000	188,200		
Topography <b>1 Level</b>			2016	138,700	58,500	9,000	188,200		
1. Level 4. Below St 7.			2017	138,700	58,500	13,500	183,700		
2. Rolling 5. Low 8.			2018	138,700	58,500	18,000	179,200		
3. Above St 6. Swampy 9.			2019	204,200	88,000	20,000	272,200		
Utilities <b>8 No Water 6 Septic System</b>			2020	204,200	88,000	20,000	272,200		
1. Public 4. Driv Well/Po 7. Cesspool			2021	204,200	88,000	25,000	267,200		
2. Water 5. Dug Well 8. Lake			2022	204,200	88,000	25,000	267,200		
3. Holding Ta 6. Septic 9. None			2023	204,200	99,400	25,000	278,600		
Street <b>3 Gravel</b>			Calc.	408,400	157,200	25,000	540,600		
1. Paved 4. Proposed			<b>Land Data</b>						
2. Semi Imp 5. R/O/W			<b>Front Foot</b>	<b>Type</b>	<b>Effective</b>		<b>Influence</b>		<b>Influence Codes</b>
3. Gravel 6. None 9. None			11. Water (0-200)	11	Frontage	Depth	Factor	Code	
GIS Map <b>40</b>			12. Water (201-400)				100 %	0	1. Unimproved
Field Review <b>50</b>			13. Water (401-800)				%		2. Excess Frtg
<b>Sale Data</b>			14. Water (801-160)				%		3. Topography
Sale Date			15. Water (161-32)				%		4. Size/Shape
Price			16. Water (3201-)				%		5. Access
Sale Type			17. Water SF Amen				%		6. Restriction
1. Land 4. Mobile 7. COM			18. Water View				%		7. Open Space
2. L & B 5. Other 8.			19. Water Influen				%		8. Environmental
3. Building 6. Condo 9.			20. ShoreFront A				%		9. Condo
Financing			<b>Square Foot</b>	<b>Square Feet</b>			%		<b>Acres</b>
1. Convent 4. Seller 7.			21. Base Lot				%		30. Blueberry(1-20
2. FHA/VA 5. Private 8.			22. Base Lot Vacan				%		31. Blueberry(21 -
3. Assumed 6. Cash 9. Unknown			23. Base Lot Unpav				%		32. Crop Land
Validity			<b>Acres</b>	<b>Acres/Sites</b>			%		33. Pasture
1. Valid 4. Split 7. Multiple			24. Acres to 10	20		0.21	100 %	0	34. Shorefront B
2. Related 5. Partial 8. Other			25. Acres 11-30				%		35. Shorefront C
3. Distress 6. Exempt 9. Estate			26. Acres 31-50				%		36. ANTENNA SITE
Verified			27. Acres 51& over				%		37. Softwood TG
1. Buyer 4. Agent 7. Family			28. Acres 71 & Ove				%		38. Mixed Wood TG
2. Seller 5. Pub Rec 8. Other			29. Woods (41+)				%		39. Hardwood TG
3. Lender 6. MLS 9.			<b>Total Acreage</b>		0.21				40. Wasteland

Inspection Witnessed By:

No./Date	Description	Date Insp.
X		

Notes:

Gray

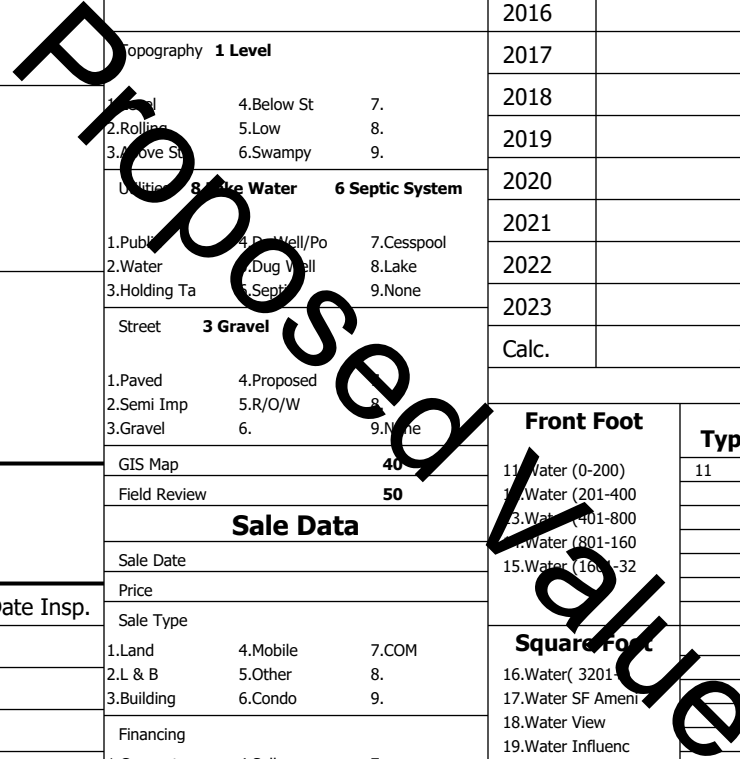

46.SP Meadow Cond

**Gray**

Map Lot 040-317-030-000

Account 4189

Location 75 NORTHERN OAKS DR

Card 1

Of 1

8/05/2024

Building Style <b>11 Cottage/Camp</b>	SF Bsmt Living <b>0</b>	Layout <b>1 Typical</b>
1.Conv. 5.Garrison 9.NE farm	Fin Bsmt Grade <b>0 0</b>	1.Typical 4. 7.
2.Ranch 6.Split 10.Colonia	Secondary Heat <b>2</b>	2.Inadeq 5. 8.
3.R Ranch/ 7.Contemp 11.Cottage	Heat Type <b>100% 5 Forced Warm Air</b>	3. 6. 9.
4.Cape 8.Log 12.Gambrel	1.HWBB 5.FWA 9.None	Attic <b>9 None</b>
Dwelling Units <b>1</b>	2.HWCI 6.Monitor 10.UNH2F	1.1/4 Fin 4.Full Fin 7.
Other Units <b>0</b>	3.HWRF 7.Electric 11.Geother	2.1/2 Fin 5.FI/Stair 8.
Stories <b>1 One Story</b>	4.Steam 8.FI/Wall 12.Heat/Co	3.3/4 Fin 6. 9.None
1.1 4.1.5 7.	Cool Type <b>0% 9 None</b>	Insulation <b>4 Minimal</b>
2.2 5.1.75 8.	1.Central 4.W&C Air 7.	1.Full 4.Minimal 7.
3.3 6.2.5 9.	2.Evapor 5. 8.	2.Heavy 5. 8.
Exterior Walls <b>14 Masonite</b>	3.H Pump 6. 9.None	3.Capped 6. 9.None
1.Clapboard 5.Stucco 9.B & B	Kitchen Style <b>2 Typical</b>	Unfinished % <b>0%</b>
2.Vin/Al 6.Brick 10.Cemplan	1.Modern 4.Obsolete	Grade & Factor <b>3 Average 100%</b>
3.Compos./ 7.Stone 11.Concret	2.Typical 5. 8.	1.E Grade 4.B Grade 7.SC Grade
4.Asbestos 8.Wood Shi 12.Wood Bo	3.Old Type 6. 9.None	2.C Grade 5.A Grade 8.
Roof Surface <b>3 Metal</b>	Bath(s) Style <b>2 Typical Bath(s)</b>	3.E Grade 6.AA Grade 9.Same
1.Asphalt 4.Composit 7.Other	1.Modern 4.Obsolete 7.	SQFT (Footprint) <b>768</b>
2.Slate 5.Wood 8.	2.Typical 5. 8.	Condition <b>4 Average</b>
3.Metal 6.Roll Roo 9.	3.Old Type 6. 9.None	1.Poor Avg 7.V G
SF Masonry Trim <b>0</b>	# Rooms <b>4</b>	2.Fair Avg 8.Exc
SOLAR VOLTAIC <b>0</b>	# Bedrooms <b>2</b>	3.Avg-Good 9.Same
OPEN-4- <b>0</b>	# Full Baths <b>0</b>	Phys. % Good <b>0%</b>
Year Built <b>1957</b>	# Half Baths <b>1</b>	Funct. % Good <b>100%</b>
Year Remodeled <b>0</b>	# Addn Fixtures <b>0</b>	Functional Code <b>9 None</b>
Foundation <b>6 Piers</b>	# Fireplaces <b>0</b>	1.Incomp 4.Delap 5.Layoff
1.Concrete 4.Wood 7.		2.O-Built 5.Bsmt 6.Long Term
2.C Block 5.Slab 8.		3.Damage 6.Style 9.None
3.Br/Stone 6.Piers 9.		Econ. % Good <b>100%</b>
Basement <b>9 No Basement</b>		Economic Code <b>None</b>
1.1/4 Bmt 4.Full Bmt 7.	0.None 3.No Power 6.Obsolete	
2.1/2 Bmt 5.Crwl 8.	1.Location 4.Generate 9.None	
3.3/4 Bmt 6. 9.None	2.Encroach 5.Flood Pl 9.	
Bsmt Gar # Cars <b>0</b>	Entrance Code <b>3 Information Only</b>	
Wet Basement <b>9 No Basement</b>	1.Interior 4.Vacant 7.	
1.Dry 4. 7.	2.Refusal 5.Estimate 8.	
2.Damp 5. 8.	3.Informed 6. 9.	
3.Wet 6. 9.	Information Code <b>1 Owner</b>	
	1.Owner 4.Agent 7.	
	2.Relative 5.Estimate 8.	
	3.Tenant 6.Other 9.	

Date Inspected 8/20/2015

**Additions, Outbuildings & Improvements**

Type	Year	Units	Grade	Cond	Phys.	Funct.	Sound Value
22 Encl Frame Porch	0	132	0 0	0	0 %	100 %	
43 2S Frame Garage	2009	1008	3 100	4	0 %	100 %	
					%	%	
					%	%	
					%	%	
					%	%	
					%	%	
					%	%	
					%	%	
					%	%	
					%	%	
					%	%	
					%	%	
					%	%	
					%	%	
					%	%	
					%	%	
					%	%	
					%	%	
					%	%	
					%	%	

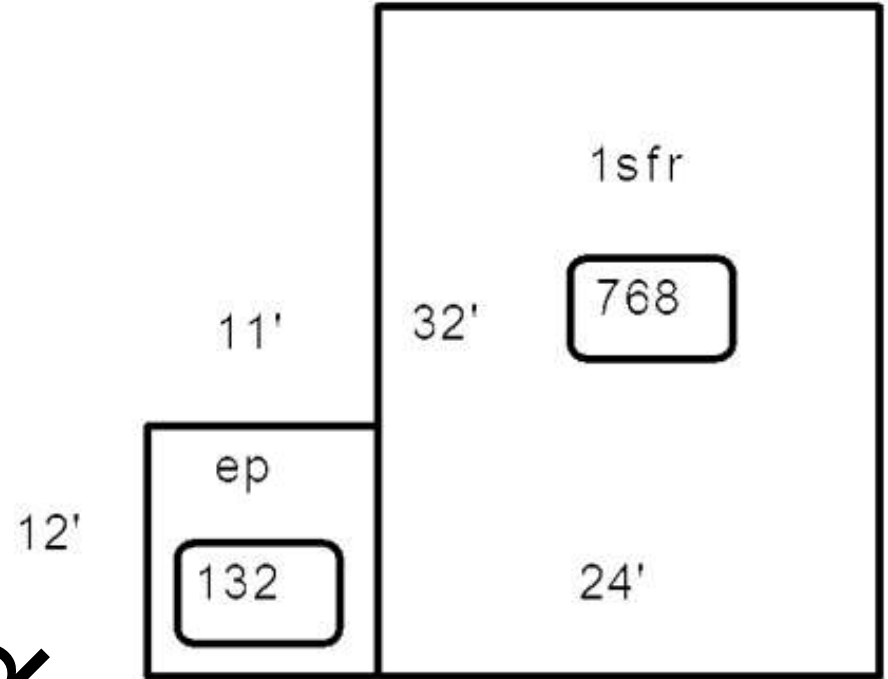

*Proposed Value*