

ERRINGTON, ELLEN  
ERRINGTON, KEVIN  
139 DEPOT ROAD  
GRAY ME 04039

B32341P124

Previous Owner  
WINK, RALPH C  
WINK, ESKA L  
3 STONEY CREEK DRIVE  
SCARBOROUGH ME 04074  
Sale Date: 6/12/2015

Property Data			Assessment Record				
Neighborhood	82 Average Location		Year	Land	Buildings	Exempt	Total
Tree Growth Year	0		2012	71,800	0	0	71,800
REVIEW	0		2013	71,800	0	0	71,800
Building Permit	0		2014	71,800	0	0	71,800
Zone/Land Use	11 Rural Residential & Agri		2015	42,000	0	0	42,000
Secondary Zone	24 Resource Protection		2016	42,000	0	0	42,000
Topography	2 Rolling		2017	42,000	0	0	42,000
1. Hill	4. Below St	7.	2018	42,000	0	0	42,000
2. Rolling	5. Low	8.	2019	62,500	0	0	62,500
3. Above St	6. Swampy	9.	2020	62,500	0	0	62,500
4. Utility			2021	62,500	0	0	62,500
1. Public	4. Dr. Well/Po	7. Cesspool	2022	76,400	0	0	76,400
2. Water	5. Dug Well	8. Lake	2023	80,900	0	0	80,900
3. Holding Ta	6. Septic	9. None	Calc.	217,600	0	0	217,600
Street	1 Paved						
1. Paved	4. Proposed	8.					
2. Semi Imp	5. R/O/W	9.					
3. Gravel	6.						
GIS Map	37						
Field Review	1						

Land Data		Front Foot		Effective		Influence		Influence Codes
Type		Frontage	Depth	Factor	Code			
1. Water (0-200)				%				1. Unimproved
2. Water (201-400)				%				2. Excess Frtg
3. Water (401-800)				%				3. Topography
4. Water (801-1600)				%				4. Size/Shape
5. Water (1601-3200)				%				5. Access
				%				6. Restriction
				%				7. Open Space
				%				8. Environmental
				%				9. Condo
				%				30. Blueberry(11-20
				%				31. Blueberry(21 -
				%				32. Crop Land
				%				33. Pasture
				%				34. Shorefront B
				%				35. Shorefront C
				%				36. ANTENNA SITE
				%				37. Softwood TG
				%				38. Mixed Wood TG
				%				39. Hardwood TG
				%				40. Wasteland
				%				41. Woodland
				%				42. Mobile Home Si
				%				43. Camp Site
				%				44. Lot Improvemen
				%				45. BA SF - Oce
				%				46. SP Meadow Cond
<b>Total Acreage</b>		38.80						

Inspection Witnessed By:

X	Date	Date Insp.
No./Date	Description	Date Insp.

Notes:  
5/24-FR=DR

Gray

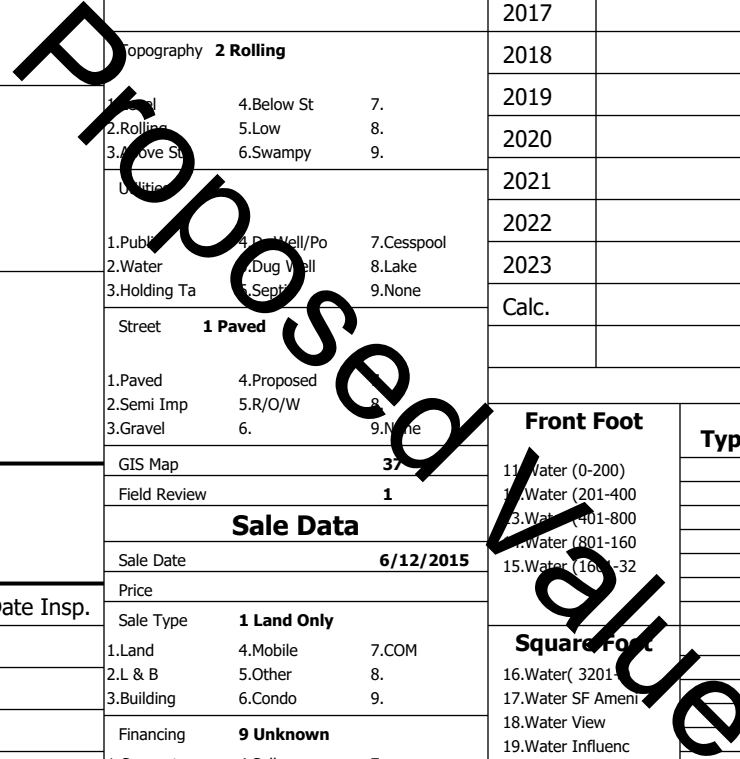

Building Style <b>0</b>	SF Bsmt Living <b>0</b>	Layout <b>0</b>
1.Conv. 5.Garrison 9.NE farm	Fin Bsmt Grade <b>0 0</b>	1.Typical 4. 7.
2.Ranch 6.Split 10.Colonia	Secondary Heat <b>0</b>	2.Inadeq 5. 8.
3.R Ranch/ 7.Contemp 11.Cottage	Heat Type <b>100% 0</b>	3. 6. 9.
4.Cape 8.Log 12.Gambrel	1.HWBB 5.FWA 9.None	Attic <b>0</b>
Dwelling Units <b>0</b>	2.HWCI 6.Monitor 10.UNH2F	1.1/4 Fin 4.Full Fin 7.
Other Units <b>0</b>	3.HWRF 7.Electric 11.Geother	2.1/2 Fin 5.FI/Stair 8.
Stories <b>0</b>	4.Steam 8.FI/Wall 12.Heat/Co	3.3/4 Fin 6. 9.None
1.1 4.1.5 7.	Cool Type <b>0% 9 None</b>	Insulation <b>0</b>
2.2 5.1.75 8.	1.Central 4.W&C Air 7.	1.Full 4.Minimal 7.
3.3 6.2.5 9.	2.Evapor 5. 8.	2.Heavy 5. 8.
Exterior Walls <b>0</b>	3.H Pump 6. 9.None	3.Capped 6. 9.None
1.Clapboar 5.Stucco 9.B & B	Kitchen Style <b>0</b>	Unfinished % <b>0%</b>
2.Vin/Al 6.Brick 10.Cemplan	1.Modern 4.Obsolete	Grade & Factor <b>0 0%</b>
3.Compos./ 7.Stone 11.Concret	2.Typical 5. 8.	1.E Grade 4.B Grade 7.SC Grade
4.Asbestos 8.Wood Shi 12.Wood Bo	3.Old Type 6. 9.None	2.C Grade 5.A Grade 8.
Roof Surface <b>0</b>	Bath(s) Style <b>0</b>	3.D Grade 6.AA Grade 9.Same
1.Asphalt 4.Composit 7.Other	1.Modern 4.Obsolete 7.	SQFT (Footprint) <b>0</b>
2.Slate 5.Wood 8.	2.Typical 5. 8.	1.Poor Avg 7.V G
3.Metal 6.Roll Roo 9.	3.Old Type 6. 9.None	2.Fair Avg 8.Exc
SF Masonry Trim <b>0</b>	# Rooms <b>0</b>	3.Avg- Good 9.Same
SOLAR VOLTAIC <b>0</b>	# Bedrooms <b>0</b>	Phys. % Good <b>0%</b>
OPEN-4- <b>0</b>	# Full Baths <b>0</b>	Funct. % Good <b>100%</b>
Year Built <b>0</b>	# Half Baths <b>0</b>	Functional Code <b>9 None</b>
Year Remodeled <b>0</b>	# Addn Fixtures <b>0</b>	1.Incomp 4.Delap 9.No Plan
Foundation <b>0</b>	# Fireplaces <b>0</b>	2.O-Built 5.Bsmt 8.Long term
1.Concrete 4.Wood 7.		3.Damage 6.Style None
2.C Block 5.Slab 8.		Econ. % Good <b>100%</b>
3.Br/Stone 6.Piers 9.		Economic Code <b>None</b>
Basement <b>0</b>		0.None 3.No Power 6.Obsolete
1.1/4 Bmt 4.Full Bmt 7.		1.Location 4.Generate 9.None
2.1/2 Bmt 5.Crwl 8.		2.Encroach 5.Flood Pl 9.
3.3/4 Bmt 6. 9.None		Entrance Code <b>5 Estimated</b>
Bsmt Gar # Cars <b>0</b>		1.Interior 4.Vacant 7.
Wet Basement <b>0</b>		2.Refusal 5.Estimate 8.
1.Dry 4. 7.		3.Informed 6. 9.
2.Damp 5. 8.		Information Code <b>5 Estimate</b>
3.Wet 6. 9.		1.Owner 4.Agent 7.
		2.Relative 5.Estimate 8.
		3.Tenant 6.Other 9.



Date Inspected 5/23/2024

Additions, Outbuildings & Improvements							
Type	Year	Units	Grade	Cond	Phys.	Funct.	Sound Value
					%	%	1.One Story Fram
					%	%	2.Two Story Fram
					%	%	3.Three Story Fr
					%	%	4.1 & 1/2 Story
					%	%	5.1 & 3/4 Story
					%	%	6.2 & 1/2 Story
					%	%	21.Open Frame Por
					%	%	22.Encl Frame Por
					%	%	23.Frame Garage
					%	%	24.Frame Shed
					%	%	25.Frame Bay Wind
					%	%	26.1SFr Overhang
					%	%	27.Unfin Basement
					%	%	28.Unfinished Att
					%	%	29.Finished Attic

Proposed Value