

PORTLAND SAND & GRAVEL CO, INC  
C/O ANTHONY MANCINI  
61 ROSE DRIVE  
CUMBERLAND ME 04021

B6307P313

Property Data			Assessment Record				
Neighborhood	69 Gravel Pit		Year	Land	Buildings	Exempt	Total
Tree Growth Year	0		2011	35,000	0	0	35,000
REVIEW	0		2012	35,000	0	0	35,000
Building Permit	0		2013	35,000	0	0	35,000
Zone/Land Use	11 Rural Residential & Agri		2014	35,000	0	0	35,000
Secondary Zone			2015	35,000	0	0	35,000
Topography	2 Rolling		2016	35,000	0	0	35,000
1. Hill	4. Below St	7.	2017	35,000	0	0	35,000
2. Rolling	5. Low	8.	2018	35,000	0	0	35,000
3. Above St	6. Swampy	9.	2019	0	0	0	0
4. Utility			2020	0	0	0	0
1. Public	4. Dr. Well/Po	7. Cesspool	2021	0	0	0	0
2. Water	5. Dug Well	8. Lake	2022	0	0	0	0
3. Holding Ta	6. Septic	9. None	2023	0	0	0	0
Street	1 Paved		Calc.	0	0	0	0
1. Paved	4. Proposed	8.					
2. Semi Imp	5. R/O/W	9.					
3. Gravel	6. None						
GIS Map	37						
Field Review	0						

Land Data		Influence Codes	
Type	Effective		Code
	Frontage	Depth	
11. Water (0-200)			1. Unimproved
12. Water (201-400)			2. Excess Frtg
13. Water (401-800)			3. Topography
14. Water (801-160)			4. Size/Shape
15. Water (1601-32)			5. Access
			6. Restriction
			7. Open Space
			8. Environmental
			9. Condo
Square Foot		Acres	
Square Feet			
16. Water (3201-)			30. Blueberry(1-20
17. Water SF Amen			31. Blueberry(21 -
18. Water View			32. Crop Land
19. Water Influen			33. Pasture
20. ShoreFront A			34. Shorefront B
			35. Shorefront C
			36. ANTENNA SITE
			37. Softwood TG
			38. Mixed Wood TG
			39. Hardwood TG
			40. Wasteland
			41. Woodland
			42. Mobile Home Si
			43. Camp Site
			44. Lot Improvemen
			45. BA SF - Oce
			46. SP Meadow Cond
<b>Total Acreage</b>		0.00	

Inspection Witnessed By:

No./Date	Description	Date Insp.
X		

Notes:

Gray

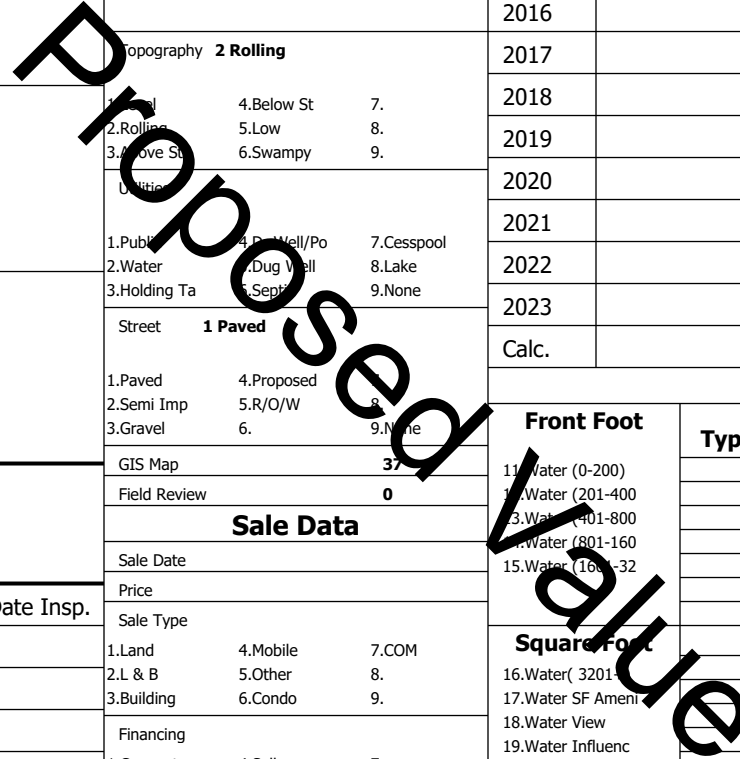

**Gray**

Map Lot 037-033-041-000

Account 1951

Location 71 MAYALL RD

Card 1

Of 1

8/05/2024

Building Style <b>0</b>	SF Bsmt Living <b>0</b>	Layout <b>0</b>
1.Conv. 5.Garrison 9.NE farm	Fin Bsmt Grade <b>0 0</b>	1.Typical 4. 7.
2.Ranch 6.Split 10.Colonia	Secondary Heat <b>0</b>	2.Inadeq 5. 8.
3.R Ranch/ 7.Contemp 11.Cottage	Heat Type <b>100% 0</b>	3. 6. 9.
4.Cape 8.Log 12.Gambrel	1.HWBB 5.FWA 9.None	Attic <b>0</b>
Dwelling Units <b>0</b>	2.HWCI 6.Monitor 10.UNH2F	1.1/4 Fin 4.Full Fin 7.
Other Units <b>0</b>	3.HWRF 7.Electric 11.Geother	2.1/2 Fin 5.FI/Stair 8.
Stories <b>0</b>	4.Steam 8.FI/Wall 12.Heat/Co	3.3/4 Fin 6. 9.None
1.1 4.1.5 7.	Cool Type <b>0% 9 None</b>	Insulation <b>0</b>
2.2 5.1.75 8.	1.Central 4.W&C Air 7.	1.Full 4.Minimal 7.
3.3 6.2.5 9.	2.Evapor 5. 8.	2.Heavy 5. 8.
Exterior Walls <b>0</b>	3.H Pump 6. 9.None	3.Capped 6. 9.None
1.Clapboar 5.Stucco 9.B & B	Kitchen Style <b>0</b>	Unfinished % <b>0%</b>
2.Vin/Al 6.Brick 10.Cemplan	1.Modern 4.Obsolete	Grade & Factor <b>0 0%</b>
3.Compos./ 7.Stone 11.Concret	2.Typical 5. 8.	1.E Grade 4.B Grade 7.SC Grade
4.Asbestos 8.Wood Shi 12.Wood Bo	3.Old Type 6. 9.None	2.C Grade 5.A Grade 8.
Roof Surface <b>0</b>	Bath(s) Style <b>0</b>	3.D Grade 6.AA Grade 9.Same
1.Asphalt 4.Composit 7.Other	1.Modern 4.Obsolete 7.	SQFT (Footprint) <b>0</b>
2.Slate 5.Wood 8.	2.Typical 5. 8.	1.Poor Avg 7.V G
3.Metal 6.Roll Roo 9.	3.Old Type 6. 9.None	2.Fair Avg 8.Exc
SF Masonry Trim <b>0</b>	# Rooms <b>0</b>	3.Avg- Good 9.Same
SOLAR VOLTAIC <b>0</b>	# Bedrooms <b>0</b>	Phys. % Good <b>0%</b>
OPEN-4- <b>0</b>	# Full Baths <b>0</b>	Funct. % Good <b>100%</b>
Year Built <b>0</b>	# Half Baths <b>0</b>	Functional Code <b>9 None</b>
Year Remodeled <b>0</b>	# Addn Fixtures <b>0</b>	1.Incomp 4.Delap 7.Layoff
Foundation <b>0</b>	# Fireplaces <b>0</b>	2.O-Built 5.Bsmt 8.Long term
1.Concrete 4.Wood 7.		3.Damage 6.Style None
2.C Block 5.Slab 8.		Econ. % Good <b>100%</b>
3.Br/Stone 6.Piers 9.		Economic Code <b>None</b>
Basement <b>0</b>		0.None 3.No Power 6.Obsolete
1.1/4 Bmt 4.Full Bmt 7.		1.Location 4.Generate 9.None
2.1/2 Bmt 5.Crwl 8.		2.Encroach 5.Flood Pl 9.
3.3/4 Bmt 6. 9.None		Entrance Code <b>0</b>
Bsmt Gar # Cars <b>0</b>		1.Interior 4.Vacant 7.
Wet Basement <b>0</b>		2.Refusal 5.Estimate 8.
1.Dry 4. 7.		3.Informed 6. 9.
2.Damp 5. 8.	Information Code <b>0</b>	
3.Wet 6. 9.	1.Owner 4.Agent 7.	
Date Inspected	2.Relative 5.Estimate 8.	
	3.Tenant 6.Other 9.	

**Additions, Outbuildings & Improvements**

Type	Year	Units	Grade	Cond	Phys.	Funct.	Sound Value
					%	%	1.One Story Fram
					%	%	2.Two Story Fram
					%	%	3.Three Story Fr
					%	%	4.1 & 1/2 Story
					%	%	5.1 & 3/4 Story
					%	%	6.2 & 1/2 Story
					%	%	21.Open Frame Por
					%	%	22.Encl Frame Por
					%	%	23.Frame Garage
					%	%	24.Frame Shed
					%	%	25.Frame Bay Wind
					%	%	26.1SFr Overhang
					%	%	27.Unfin Basement
					%	%	28.Unfinished Att
					%	%	29.Finished Attic

Proposed Value