

FOSTER REALTY TRUST
FOSTER - TRUSTEE, GREGORY E
PO BOX 157
GRAY ME 04039

B38272P138

Previous Owner
FOSTER, CLIFTON E
FOSTER, RUTH F
PO BOX 157
GRAY ME 04039
Sale Date: 6/04/2021

Inspection Witnessed By:

X

Date

No./Date	Description	Date Insp.

Notes:
5/24-FR=DR

Gray

Property Data		
Neighborhood	82 Average Location	
Tree Growth Year	0	
REVIEW	0	
Building Permit	0	
Zone/Land Use	19 Village Center	
Secondary Zone		
Topography	1 Level	
1. Hill	4. Below St	7.
2. Rolling	5. Low	8.
3. Above St	6. Swampy	9.
Utilities	5. No Well	6. Septic System
1. Public	4. Dry Well/Po	7. Cesspool
2. Water	5. Dug Well	8. Lake
3. Holding Ta	6. Septic	9. None
Street	3 Gravel	
1. Paved	4. Proposed	8.
2. Semi Imp	5. R/O/W	9.
3. Gravel	6.	9. None
GIS Map	36	
Field Review	0	
Sale Data		
Sale Date	6/04/2021	
Price		
Sale Type	2 Land & Buildings	
1. Land	4. Mobile	7. COM
2. L & B	5. Other	8.
3. Building	6. Condo	9.
Financing	9 Unknown	
1. Convent	4. Seller	7.
2. FHA/VA	5. Private	8.
3. Assumed	6. Cash	9. Unknown
Validity	2 Related Parties	
1. Valid	4. Split	7. Multiple
2. Related	5. Partial	8. Other
3. Distress	6. Exempt	9. Estate
Verified	5 Public Record	
1. Buyer	4. Agent	7. Family
2. Seller	5. Pub Rec	8. Other
3. Lender	6. MLS	9.

Assessment Record				
Year	Land	Buildings	Exempt	Total
2011	49,500	251,328	13,600	287,228
2012	49,500	251,328	13,600	287,228
2013	49,500	251,328	13,600	287,228
2014	49,500	251,328	13,600	287,228
2015	49,500	251,300	14,400	286,400
2016	49,500	251,300	14,400	286,400
2017	49,500	251,300	18,900	281,900
2018	49,500	251,300	23,400	277,400
2019	105,300	334,600	26,000	413,900
2020	105,300	334,600	26,000	413,900
2021	105,300	334,600	31,000	408,900
2022	105,300	334,600	31,000	408,900
2023	105,300	363,900	0	469,200
Calc.	136,000	598,100	0	734,100

Land Data					
Type	Effective		Influence		Influence Codes
	Frontage	Depth	Factor	Code	
1. Water (0-200)			%		1. Unimproved
2. Water (201-400)			%		2. Excess Frtg
3. Water (401-800)			%		3. Topography
4. Water (801-160)			%		4. Size/Shape
5. Water (1601-32)			%		5. Access
			%		6. Restriction
			%		7. Open Space
			%		8. Environmental
			%		9. Condo
Square Foot		Square Feet		Acres	
16. Water (3201-			%		30. Blueberry(11-20
17. Water SF Amen			%		31. Blueberry(21 -
18. Water View			%		32. Crop Land
19. Water Influen			%		33. Pasture
20. ShoreFront A			%		34. Shorefront B
			%		35. Shorefront C
			%		36. ANTENNA SITE
23	1.84	100	%	0	37. Softwood TG
24	2.66	100	%	0	38. Mixed Wood TG
			%		39. Hardwood TG
			%		40. Wasteland
			%		41. Woodland
			%		42. Mobile Home Si
			%		43. Camp Site
			%		44. Lot Improvemen
			%		45. BA SF - Oce
			%		46. SP Meadow Cond
Total Acreage		4.50			

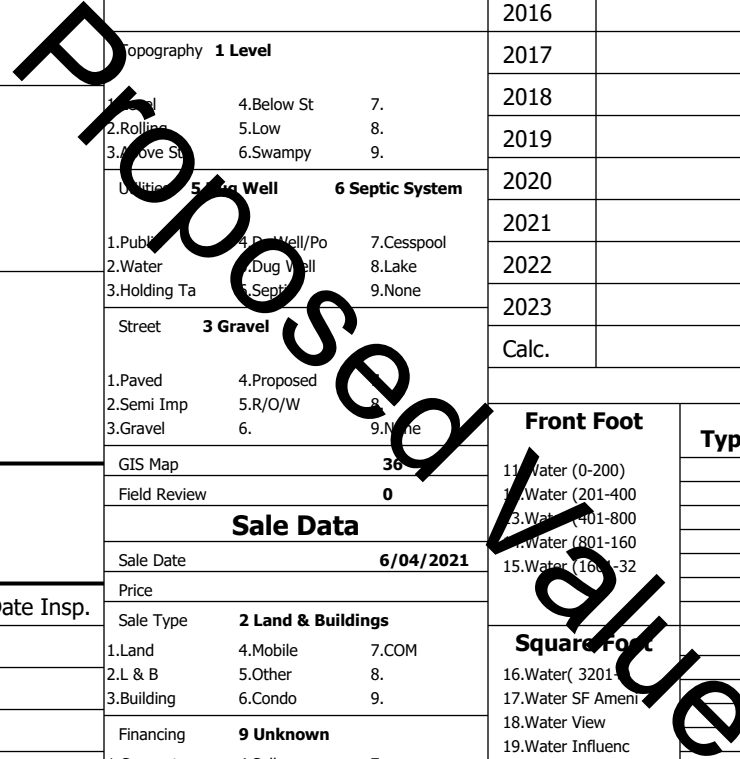

Gray

Map Lot 036-406-111-000

Account 4540

Location 6 PENNELL LN

Card 1

Of 1

8/05/2024

Building Style 4 Cape Cod	SF Bsmt Living 0	Layout 1 Typical
1.Conv. 5.Garrison 9.NE farm	Fin Bsmt Grade 0 0	1.Typical 4. 7.
2.Ranch 6.Split 10.Colonia	Secondary Heat 2	2.Inadeq 5. 8.
3.R Ranch/ 7.Contemp 11.Cottage	Heat Type 100% 1 Hot Water BB	3. 6. 9.
4.Cape 8.Log 12.Gambrel	1.HWBB 5.FWA 9.None	Attic 9 None
Dwelling Units 1	2.HWCI 6.Monitor 10.UNH2F	1.1/4 Fin 4.Full Fin 7.
Other Units 0	3.HWRF 7.Electric 11.Geother	2.1/2 Fin 5.FI/Stair 8.
Stories 4 One & 1/2 Story	4.Steam 8.FI/Wall 12.Heat/Co	3.3/4 Fin 6. 9.None
1.1 4.1.5 7.	Cool Type 0% 9 None	Insulation 1 Full
2.2 5.1.75 8.	1.Central 4.W&C Air 7.	1.Full 4.Minimal 7.
3.3 6.2.5 9.	2.Evapor 5. 8.	2.Heavy 5. 8.
Exterior Walls 1 Clapboard	3.H Pump 6. 9.None	3.Capped 6. 9.None
1.Clapboar 5.Stucco 9.B & B	Kitchen Style 2 Typical	Unfinished % 0%
2.Vin/Al 6.Brick 10.Cemplan	1.Modern 4.Obsolete	Grade & Factor 3 Average 120%
3.Compos./ 7.Stone 11.Concret	2.Typical 5. 8.	1.E Grade 4.B Grade 7.SC Grade
4.Asbestos 8.Wood Shi 12.Wood Bo	3.Old Type 6. 9.None	2.D Grade 5.A Grade 8.
Roof Surface 1 Asphalt Shingles	Bath(s) Style 2 Typical Bath(s)	3.Grade 6.AA Grade 9.Same
1.Asphalt 4.Composit 7.Other	1.Modern 4.Obsolete 7.	SQFT (Footprint) 1344
2.Slate 5.Wood 8.	2.Typical 5. 8.	Condition 5 Above Average
3.Metal 6.Roll Roo 9.	3.Old Type 6. 9.None	1.Poor 2.Avg 7.V G
SF Masonry Trim 0	# Rooms 7	2.Fair 3.Avg 8.Exc
SOLAR VOLTAIC 0	# Bedrooms 4	3.Avg- 4.Good 9.Same
OPEN-4- 0	# Full Baths 3	Phys. % Good 0%
Year Built 1990	# Half Baths 0	Funct. % Good 100%
Year Remodeled 0	# Addn Fixtures 0	Functional Code 9 None
Foundation 1 Concrete	# Fireplaces 1	1.Incomp 4.Delap 5.Layoff
1.Concrete 4.Wood 7.		2.O-Built 5.Bsmt 6.Long term
2.C Block 5.Slab 8.		3.Damage 6.Style 7.None
3.Br/Stone 6.Piers 9.		Econ. % Good 100%
Basement 4 Full Basement		Economic Code None
1.1/4 Bmt 4.Full Bmt 7.		0.None 3.No Power 6.Obsolete
2.1/2 Bmt 5.CrwI 8.		1.Location 4.Generate 9.None
3.3/4 Bmt 6. 9.None		2.Encroach 5.Flood Pl 9.
Bsmt Gar # Cars 0		Entrance Code 5 Estimated
Wet Basement 1 Dry Basement		1.Interior 4.Vacant 7.
1.Dry 4. 7.		2.Refusal 5.Estimate 8.
2.Damp 5. 8.		3.Informed 6. 9.
3.Wet 6. 9.		Information Code 5 Estimate
		1.Owner 4.Agent 7.
		2.Relative 5.Estimate 8.
		3.Tenant 6.Other 9.

Date Inspected 5/23/2024

Additions, Outbuildings & Improvements

Type	Year	Units	Grade	Cond	Phys.	Funct.	Sound Value
11 1 Story/Basement	0	308	0 0	0	0	% 100 %	1.One Story Fram
11 1 Story/Basement	0	192	0 0	0	0	% 100 %	2.Two Story Fram
21 Open Frame	0	90	0 0	0	0	% 100 %	3.Three Story Fr
68 Wood Deck	0	336	0 0	0	0	% 100 %	4.1 & 1/2 Story
26 1SFr Overhang	0	48	0 0	0	0	% 100 %	5.1 & 3/4 Story
74 1.5 St Garage	0	1296	0 0	0	0	% 100 %	6.2 & 1/2 Story
24 Frame Shed	0	640	2 100	4	0	% 100 %	21.Open Frame Por
27 Unfin Basement	0	1296	0 0	0	0	% 100 %	22.Encl Frame Por
68 Wood Deck	2012	120	0 0	0	0	% 100 %	23.Frame Garage
29 Finished Attic	0	308	0 0	0	0	% 100 %	24.Frame Shed
							25.Frame Bay Wind
							26.1SFr Overhang
							27.Unfin Basement
							28.Unfinished Att
							29.Finished Attic

