

REGINALD S REID & CATHERINE T REID TRUST
REGINALD REID & CATHERINE T REID - CO TRUSTEES
51 LOMBARD STREET
PRESQUE ISLE ME 04769

B38328P1
Previous Owner
QUALITY INVESTMENTS, LLC
PO BOX 1005

SACO ME 04072
Sale Date: 6/18/2021

Inspection Witnessed By:

No./Date	Description	Date Insp.
X		

Notes:
5/24-FR=DR

Gray

Property Data		
Neighborhood	82 Average Location	
Tree Growth Year	0	
REVIEW	0	
Building Permit	0	
Zone/Land Use	19 Village Center	
Secondary Zone		
Topography	2 Rolling	
1. Soil	4. Below St	7.
2. Rolling	5. Low	8.
3. Above St	6. Swampy	9.
1. Public	4. Dug Well/Po	7. Cesspool
2. Water	5. Dug Well	8. Lake
3. Holding Ta	6. Septic	9. None
Street	1 Paved	
1. Paved	4. Proposed	8.
2. Semi Imp	5. R/O/W	9.
3. Gravel	6.	9. None
GIS Map	36	
Field Review	0	
Sale Data		
Sale Date	6/18/2021	
Price	167,000	
Sale Type	1 Land Only	
1. Land	4. Mobile	7. COM
2. L & B	5. Other	8.
3. Building	6. Condo	9.
Financing	9 Unknown	
1. Convent	4. Seller	7.
2. FHA/VA	5. Private	8.
3. Assumed	6. Cash	9. Unknown
Validity	1 Arms Length Sale	
1. Valid	4. Split	7. Multiple
2. Related	5. Partial	8. Other
3. Distress	6. Exempt	9. Estate
Verified	5 Public Record	
1. Buyer	4. Agent	7. Family
2. Seller	5. Pub Rec	8. Other
3. Lender	6. MLS	9.

Assessment Record				
Year	Land	Buildings	Exempt	Total
2011	100,700	0	0	100,700
2012	100,700	0	0	100,700
2013	100,700	0	0	100,700
2014	100,700	0	0	100,700
2015	100,100	0	0	100,100
2016	100,100	0	0	100,100
2017	100,100	0	0	100,100
2018	100,100	0	0	100,100
2019	96,800	0	0	96,800
2020	96,800	0	0	96,800
2021	96,800	0	0	96,800
2022	96,800	0	0	96,800
2023	100,200	0	0	100,200
Calc.	174,500	0	0	174,500

Land Data					
Type	Effective		Influence		Influence Codes
	Frontage	Depth	Factor	Code	
11. Water (0-200)			%		1. Unimproved
12. Water (201-400)			%		2. Excess Frtg
13. Water (401-800)			%		3. Topography
14. Water (801-160)			%		4. Size/Shape
15. Water (1601-32)			%		5. Access
			%		6. Restriction
			%		7. Open Space
			%		8. Environmental
			%		9. Condo
Square Foot		Square Feet		Acres	
16. Water (3201-			%		30. Blueberry(1-20
17. Water SF Amen			%		31. Blueberry(21 -
18. Water View			%		32. Crop Land
19. Water Influen			%		33. Pasture
20. ShoreFront A			%		34. Shorefront B
			%		35. Shorefront C
			%		36. ANTENNA SITE
22. Base Lot Vacan	1.84	100	%	0	37. Softwood TG
23. Base Lot Unpav	10.00	100	%	0	38. Mixed Wood TG
	2.64	100	%	0	39. Hardwood TG
			%		40. Wasteland
			%		41. Woodland
			%		42. Mobile Home Si
			%		43. Camp Site
			%		44. Lot Improvemen
			%		45. BA SF - Oce
			%		46. SP Meadow Cond
Total Acreage		14.48			

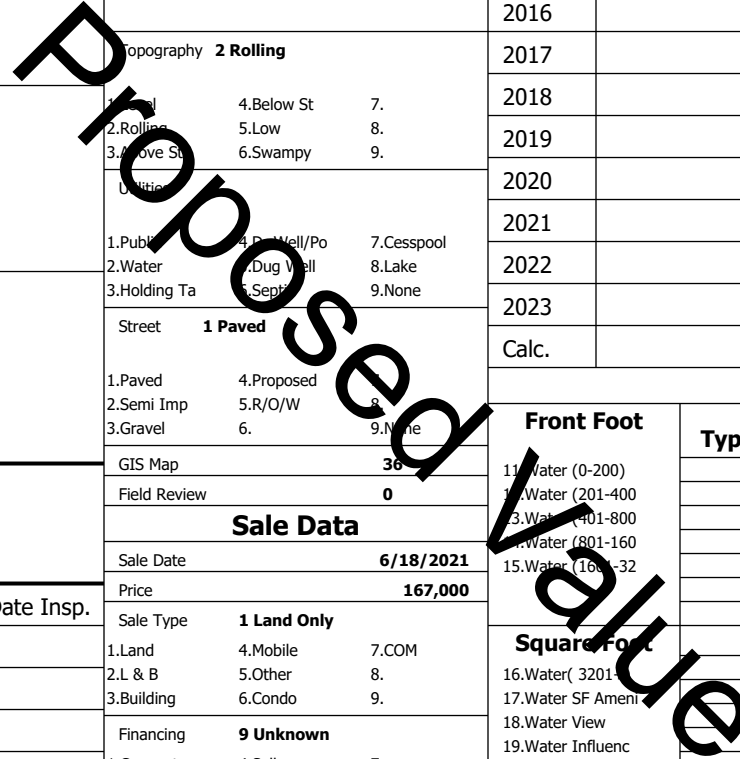

Gray

Map Lot 036-406-012-000

Account 4529

Location YARMOUTH RD

Card 1

Of 1

8/05/2024

Building Style 0	SF Bsmt Living 0	Layout 0
1.Conv. 5.Garrison 9.NE farm	Fin Bsmt Grade 0 0	1.Typical 4. 7.
2.Ranch 6.Split 10.Colonia	Secondary Heat 0	2.Inadeq 5. 8.
3.R Ranch/ 7.Contemp 11.Cottage	Heat Type 100% 0	3. 6. 9.
4.Cape 8.Log 12.Gambrel	1.HWBB 5.FWA 9.None	Attic 0
Dwelling Units 0	2.HWCI 6.Monitor 10.UNH2F	1.1/4 Fin 4.Full Fin 7.
Other Units 0	3.HWRF 7.Electric 11.Geother	2.1/2 Fin 5.FI/Stair 8.
Stories 0	4.Steam 8.FI/Wall 12.Heat/Co	3.3/4 Fin 6. 9.None
1.1 4.1.5 7.	Cool Type 0% 9 None	Insulation 0
2.2 5.1.75 8.	1.Central 4.W&C Air 7.	1.Full 4.Minimal 7.
3.3 6.2.5 9.	2.Evapor 5. 8.	2.Heavy 5. 8.
Exterior Walls 0	3.H Pump 6. 9.None	3.Capped 6. 9.None
1.Clapboar 5.Stucco 9.B & B	Kitchen Style 0	Unfinished % 0%
2.Vin/Al 6.Brick 10.Cemplan	1.Modern 4.Obsolete	Grade & Factor 0 0%
3.Compos./ 7.Stone 11.Concret	2.Typical 5. 8.	1.E Grade 4.B Grade 7.SC Grade
4.Asbestos 8.Wood Shi 12.Wood Bo	3.Old Type 6. 9.None	2.C Grade 5.A Grade 8.
Roof Surface 0	Bath(s) Style 0	3.D Grade 6.AA Grade 9.Same
1.Asphalt 4.Composit 7.Other	1.Modern 4.Obsolete 7.	SQFT (Footprint) 0
2.Slate 5.Wood 8.	2.Typical 5. 8.	1.Poor Avg 7.V G
3.Metal 6.Roll Roo 9.	3.Old Type 6. 9.None	2.Fair Avg 8.Exc
SF Masonry Trim 0	# Rooms 0	3.Avg- Good 9.Same
SOLAR VOLTAIC 0	# Bedrooms 0	Phys. % Good 0%
OPEN-4- 0	# Full Baths 0	Funct. % Good 0%
Year Built 0	# Half Baths 0	Functional Code 9 None
Year Remodeled 0	# Addn Fixtures 0	1.Incomp 4.Delap 9.No Plan
Foundation 0	# Fireplaces 0	2.O-Built 5.Bsmt 8.Long term
1.Concrete 4.Wood 7.		3.Damage 6.Style None
2.C Block 5.Slab 8.		Econ. % Good 100%
3.Br/Stone 6.Piers 9.		Economic Code None
Basement 0		0.None 3.No Power 6.Obsolete
1.1/4 Bmt 4.Full Bmt 7.		1.Location 4.Generate 9.None
2.1/2 Bmt 5.Crwl 8.		2.Encroach 5.Flood Pl 9.
3.3/4 Bmt 6. 9.None		Entrance Code 5 Estimated
Bsmt Gar # Cars 0		1.Interior 4.Vacant 7.
Wet Basement 0		2.Refusal 5.Estimate 8.
1.Dry 4. 7.		3.Informed 6. 9.
2.Damp 5. 8.		Information Code 5 Estimate
3.Wet 6. 9.		1.Owner 4.Agent 7.
		2.Relative 5.Estimate 8.
		3.Tenant 6.Other 9.



Date Inspected 5/23/2024

Additions, Outbuildings & Improvements

Type	Year	Units	Grade	Cond	Phys.	Funct.	Sound Value
					%	%	1.One Story Fram
					%	%	2.Two Story Fram
					%	%	3.Three Story Fr
					%	%	4.1 & 1/2 Story
					%	%	5.1 & 3/4 Story
					%	%	6.2 & 1/2 Story
					%	%	21.Open Frame Por
					%	%	22.Encl Frame Por
					%	%	23.Frame Garage
					%	%	24.Frame Shed
					%	%	25.Frame Bay Wind
					%	%	26.1SFr Overhang
					%	%	27.Unfin Basement
					%	%	28.Unfinished Att
					%	%	29.Finished Attic

Proposed Value