

GRAIVER, WILLOW S
324 GRAY ROAD
FALMOUTH ME 04105

B37535P174

Property Data			Assessment Record				
Neighborhood	82 Average Location		Year	Land	Buildings	Exempt	Total
Tree Growth Year	0		2022	45,000	0	0	45,000
REVIEW	0		2023	50,000	0	0	50,000
Building Permit	0		Calc.	87,800	0	0	87,800
Zone/Land Use	19 Village Center						
Secondary Zone							
Topography	1 Level						
1. Hill	4. Below St	7.					
2. Rolling	5. Low	8.					
3. Above St	6. Swampy	9.					
Utilities	9 None						
1. Public	4. Dr. Well/Po	7. Cesspool					
2. Water	5. Dug Well	8. Lake					
3. Holding Ta	6. Septic	9. None					
Street	1 Paved						
1. Paved	4. Proposed	8.					
2. Semi Imp	5. R/O/W	9.					
3. Gravel	6. None						

Inspection Witnessed By:

X	Date	Date Insp.
No./Date	Description	Date Insp.

Notes:
2/12/2021 - B37811P141 - Attorney Affidavit addressing order of recorded deeds (B37535P166/B37535P174/B37537P330). No Subdivision Violation noted. 5-24 DR FIELD REVIEW

Gray

Sale Data		
Sale Date	12/07/2020	
Price	20,000	
Sale Type	1 Land Only	
1. Land	4. Mobile	7. COM
2. L & B	5. Other	8.
3. Building	6. Condo	9.
Financing	9 Unknown	
1. Convent	4. Seller	7.
2. FHA/VA	5. Private	8.
3. Assumed	6. Cash	9. Unknown
Validity	4 Split/Assemblage	
1. Valid	4. Split	7. Multiple
2. Related	5. Partial	8. Other
3. Distress	6. Exempt	9. Estate
Verified	5 Public Record	
1. Buyer	4. Agent	7. Family
2. Seller	5. Pub Rec	8. Other
3. Lender	6. MLS	9.

Type	Effective		Influence		Influence Codes
	Frontage	Depth	Factor	Code	
11. Water (0-200)			%		1. Unimproved
12. Water (201-400)			%		2. Excess Frtg
13. Water (401-800)			%		3. Topography
14. Water (801-160)			%		4. Size/Shape
15. Water (1601-32)			%		5. Access
			%		6. Restriction
			%		7. Open Space
			%		8. Environmental
			%		9. Condo
			%		30. Blueberry(1-20
			%		31. Blueberry(21 -
			%		32. Crop Land
			%		33. Pasture
			%		34. Shorefront B
			%		35. Shorefront C
			%		36. ANTENNA SITE
			%		37. Softwood TG
			%		38. Mixed Wood TG
			%		39. Hardwood TG
			%		40. Wasteland
			%		41. Woodland
			%		42. Mobile Home Si
			%		43. Camp Site
			%		44. Lot Improvemen
			%		45. BA SF - Oce
			%		46. SP Meadow Cond
Total Acreage			0.50		

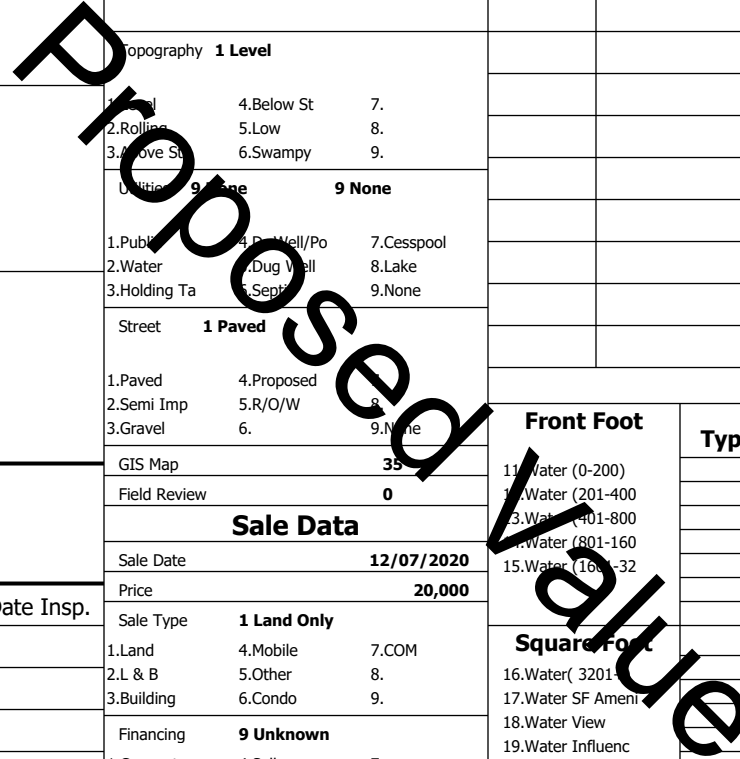

Gray

Map Lot 035-403-066-001

Account 5061

Location COLLEY HILL RD

Card 1

Of 1

8/05/2024

Building Style	SF Bsmt Living			Layout						
1.Conv.	5.Garrison	9.NE farm	Fin Bsmt Grade	1.Typical	4.	7.				
2.Ranch	6.Split	10.Colonia	Secondary Heat	2.Inadeq	5.	8.				
3.R Ranch/	7.Contemp	11.Cottage	Heat Type	3.	6.	9.				
4.Cape	8.Log	12.Gambrel	1.HWBB	5.FWA	9.None	Attic				
Dwelling Units	2.HWCI			6.Monitor	10.UNH2F	1.1/4 Fin				
Other Units	3.HWRF			7.Electric	11.Geother	4.Full Fin				
Stories	4.Steam			8.F/Wall	12.Heat/Co	2.1/2 Fin				
1.1	4.1.5	7.	Cool Type			5.F/Stair				
2.2	5.1.75	8.	1.Central	4.W&C Air	7.	3.3/4 Fin				
3.3	6.2.5	9.	2.Evapor	5.	8.	6.				
Exterior Walls	3.H Pump			6.	9.None	9.None				
1.Clapboar	5.Stucco	9.B & B	Kitchen Style	Unfinished %						
2.Vin/Al	6.Brick	10.Cemplan	1.Modern	4.Obsolete	7.	Grade & Factor				
3.Compos./	7.Stone	11.Concret	2.Typical	5.	8.	1.E Grade				
4.Asbestos	8.Wood Shi	12.Wood Bo	3.Old Type	6.	9.None	4.B Grade				
Roof Surface	Bath(s) Style			7.SC Grade						
1.Asphalt	4.Composit	7.Other	1.Modern	4.Obsolete	7.	2.C Grade				
2.Slate	5.Wood	8.	2.Typical	5.	8.	5.A Grade				
3.Metal	6.Roll Roo	9.	3.Old Type	6.	9.None	8.				
SF Masonry Trim	# Rooms			9.Same						
SOLAR VOLTAIC	# Bedrooms			SQFT (Footprint)						
OPEN-4-	# Full Baths			1.Poor						
Year Built	# Half Baths			2.Fair						
Year Remodeled	# Addn Fixtures			3.Avg-						
Foundation	# Fireplaces			Phys. % Good						
1.Concrete	4.Wood	7.					Funct. % Good			
2.C Block	5.Slab	8.					Functional Code			
3.Br/Stone	6.Piers	9.					1.Incomp	4.Delap	5.Layoff	
Basement							2.O-Built	5.Bsmt	8.Long term	
1.1/4 Bmt	4.Full Bmt	7.					3.Damage	6.Style	9.None	
2.1/2 Bmt	5.Crwl	8.					Econ. % Good	Economic Code		
3.3/4 Bmt	6.	9.None					0.None	3.No Power	6.Obsolete	
Bsmt Gar # Cars							1.Location	4.Generate	9.None	
Wet Basement							2.Encroach	5.Flood Pl	9.	
1.Dry	4.	7.					Entrance Code	5 Estimated		
2.Damp	5.	8.	1.Interior	4.Vacant	7.					
3.Wet	6.	9.	2.Refusal	5.Estimate	8.					
			3.Informed	6.	9.					
			Information Code	5 Estimate						
			1.Owner	4.Agent	7.					
			2.Relative	5.Estimate	8.					
			3.Tenant	6.Other	9.					

Date Inspected 5/17/2024

Additions, Outbuildings & Improvements							
Type	Year	Units	Grade	Cond	Phys.	Funct.	Sound Value
					%	%	1.One Story Fram
					%	%	2.Two Story Fram
					%	%	3.Three Story Fr
					%	%	4.1 & 1/2 Story
					%	%	5.1 & 3/4 Story
					%	%	6.2 & 1/2 Story
					%	%	21.Open Frame Por
					%	%	22.Encl Frame Por
					%	%	23.Frame Garage
					%	%	24.Frame Shed
					%	%	25.Frame Bay Wind
					%	%	26.1SFr Overhang
					%	%	27.Unfin Basement
					%	%	28.Unfinished Att
					%	%	29.Finished Attic

Proposed Value