

TAYLOR, HELEN R  
PO BOX 8  
GRAY ME 04039

B3141P401

Inspection Witnessed By:

X	Date	Date Insp.
No./Date	Description	Date Insp.

Notes:  
5-24 DR FIELD REVIEW

Gray

Property Data			Assessment Record						
Neighborhood <b>83 Avg-Good Location</b>			Year	Land	Buildings	Exempt	Total		
Tree Growth Year <b>0</b>			2011	40,240	89,018	13,600	115,658		
REVIEW <b>0</b>			2012	40,240	89,018	13,600	115,658		
Building Permit <b>0</b>			2013	40,240	89,018	13,600	115,658		
Zone/Land Use <b>22 Wellhead Protection II</b>			2014	40,240	89,018	13,600	115,658		
Secondary Zone			2015	40,200	89,000	14,400	114,800		
Topography <b>1 Level</b>			2016	40,200	89,000	14,400	114,800		
1. Valid 4. Below St 7.			2017	40,200	89,000	18,900	110,300		
2. Rolling 5. Low 8.			2018	40,200	89,000	23,400	105,800		
3. Above St 6. Swampy 9.			2019	47,300	108,400	26,000	129,700		
Utilities <b>2 Public Water 6 Septic System</b>			2020	47,300	108,400	26,000	129,700		
1. Public 4. Dr. Well/Po 7. Cesspool			2021	47,300	108,400	31,000	124,700		
2. Water 8. Lake			2022	47,300	108,400	31,000	124,700		
3. Holding Ta 9. None			2023	47,300	125,200	31,000	141,500		
Street <b>1 Paved</b>			Calc.	117,100	167,400	31,000	253,500		
1. Paved 4. Proposed			<b>Land Data</b>						
2. Semi Imp 5. R/O/W			<b>Front Foot</b>	<b>Type</b>	<b>Effective</b>		<b>Influence</b>		<b>Influence Codes</b>
3. Gravel 6. None			11. Water (0-200)		<b>Frontage</b>	<b>Depth</b>	<b>Factor</b>	<b>Code</b>	
GIS Map <b>35</b>			12. Water (201-400)				%		1. Unimproved
Field Review <b>1</b>			13. Water (401-800)				%		2. Excess Frtg
<b>Sale Data</b>			14. Water (801-160)				%		3. Topography
Sale Date <b>9/01/1970</b>			15. Water (161-32)				%		4. Size/Shape
Price			16. Water (3201-)				%		5. Access
Sale Type			17. Water SF Amen				%		6. Restriction
1. Land 4. Mobile 7.COM			18. Water View				%		7. Open Space
2. L & B 5. Other 8.			19. Water Influen				%		8. Environmental
3. Building 6. Condo 9.			20. ShoreFront A				%		9. Condo
Financing			<b>Square Foot</b>	<b>Square Feet</b>			%		<b>Acres</b>
1. Convent 4. Seller 7.			21. Base Lot				%		30. Blueberry(1-20
2. FHA/VA 5. Private 8.			22. Base Lot Vacan				%		31. Blueberry(21 -
3. Assumed 6. Cash 9.Unknown			23. Base Lot Unpav				%		32. Crop Land
Validity			<b>Fract. Acre</b>	<b>Acres/Sites</b>			%		33. Pasture
1. Valid 4. Split 7. Multiple			24. Acres to 10	21	0.37	100	%	0	34. Shorefront B
2. Related 5. Partial 8. Other			25. Acres 11-30				%		35. Shorefront C
3. Distress 6. Exempt 9. Estate			26. Acres 31-50				%		36. ANTENNA SITE
Verified			27. Acres 51& over				%		37. Softwood TG
1. Buyer 4. Agent 7. Family			28. Acres 71 & Ove				%		38. Mixed Wood TG
2. Seller 5. Pub Rec 8. Other			29. Woods (41+)				%		39. Hardwood TG
3. Lender 6. MLS 9.			<b>Total Acreage</b> 0.37						40. Wasteland
									41. Woodland
									42. Mobile Home Si
									43. Camp Site
									44. Lot Improvemen
									45. BA SF - Oce
									46. SP Meadow Cond

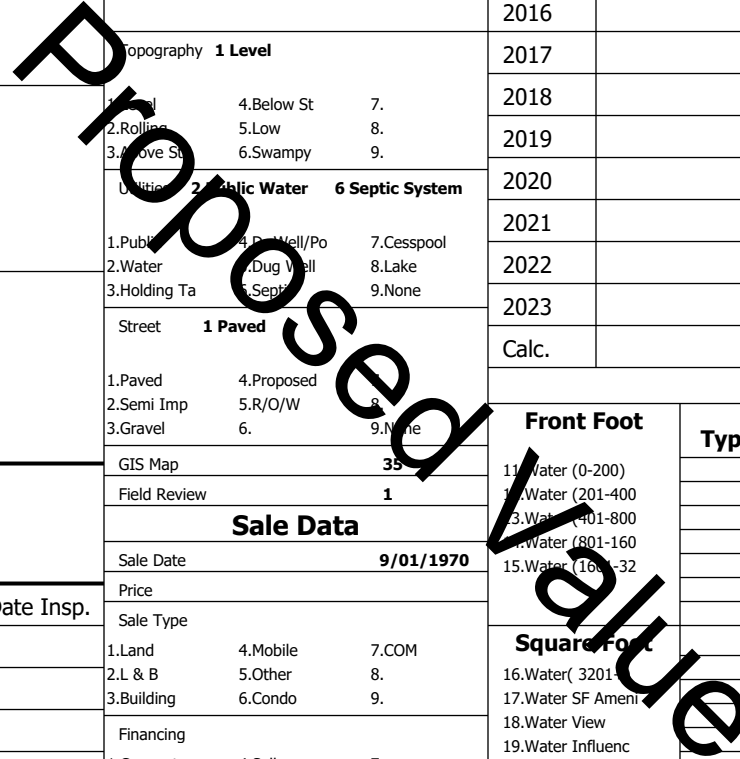

**Gray**

Map Lot 035-403-010-000

Account 4365

Location 22 GRAY PARK

Card 1

Of 1

8/05/2024

Building Style <b>2 Ranch</b>	SF Bsmt Living <b>0</b>	Layout <b>1 Typical</b>
1.Conv. 5.Garrison 9.NE farm	Fin Bsmt Grade <b>0 0</b>	1.Typical 4. 7.
2.Ranch 6.Split 10.Colonia	Secondary Heat <b>0</b>	2.Inadeq 5. 8.
3.R Ranch/ 7.Contemp 11.Cottage	Heat Type <b>100% 5 Forced Warm Air</b>	3. 6. 9.
4.Cape 8.Log 12.Gambrel	1.HWBB 5.FWA 9.None	Attic <b>9 None</b>
Dwelling Units <b>1</b>	2.HWCI 6.Monitor 10.UNH2F	1.1/4 Fin 4.Full Fin 7.
Other Units <b>0</b>	3.HWRF 7.Electric 11.Geother	2.1/2 Fin 5.FI/Stair 8.
Stories <b>1 One Story</b>	4.Steam 8.FI/Wall 12.Heat/Co	3.3/4 Fin 6. 9.None
1.1 4.1.5 7.	Cool Type <b>0% 9 None</b>	Insulation <b>1 Full</b>
2.2 5.1.75 8.	1.Central 4.W&C Air 7.	1.Full 4.Minimal 7.
3.3 6.2.5 9.	2.Evapor 5. 8.	2.Heavy 5. 8.
Exterior Walls <b>2 Vinyl/Aluminum</b>	3.H Pump 6. 9.None	3.Capped 6. 9.None
1.Clapboard 5.Stucco 9.B & B	Kitchen Style <b>2 Typical</b>	Unfinished % <b>0%</b>
2.Vin/Al 6.Brick 10.Cemplan	1.Modern 4.Obsolete	Grade & Factor <b>3 Average 100%</b>
3.Compos./ 7.Stone 11.Concret	2.Typical 5. 8.	1.E Grade 4.B Grade 7.SC Grade
4.Asbestos 8.Wood Shi 12.Wood Bo	3.Old Type 6. 9.None	2.D Grade 5.A Grade 8.
Roof Surface <b>1 Asphalt Shingles</b>	Bath(s) Style <b>2 Typical Bath(s)</b>	3.C Grade 6.AA Grade 9.Same
1.Asphalt 4.Composit 7.Other	1.Modern 4.Obsolete 7.	SQFT (Footprint) <b>864</b>
2.Slate 5.Wood 8.	2.Typical 5. 8.	Condition <b>5 Above Average</b>
3.Metal 6.Roll Roo 9.	3.Old Type 6. 9.None	1.Poor 2.Avg 7.V G
SF Masonry Trim <b>0</b>	# Rooms <b>5</b>	2.Fair 3.Good 8.Exc
SOLAR VOLTAIC <b>0</b>	# Bedrooms <b>3</b>	3.Avg- 9.Same
OPEN-4- <b>0</b>	# Full Baths <b>1</b>	Phys. % Good <b>0%</b>
Year Built <b>1954</b>	# Half Baths <b>0</b>	Funct. % Good <b>100%</b>
Year Remodeled <b>0</b>	# Addn Fixtures <b>0</b>	Functional Code <b>9 None</b>
Foundation <b>2 Concrete Block</b>	# Fireplaces <b>0</b>	1.Incomp 4.Delap 5.Delay
1.Concrete 4.Wood 7.		2.O-Built 5.Bsmt 6.Long term
2.C Block 5.Slab 8.		3.Damage 6.Style
3.Br/Stone 6.Piers 9.		Econ. % Good <b>100%</b>
Basement <b>4 Full Basement</b>		Economic Code <b>None</b>
1.1/4 Bmt 4.Full Bmt 7.		0.None 3.No Power 6.Obsolete
2.1/2 Bmt 5.CrwI 8.		1.Location 4.Generate 9.None
3.3/4 Bmt 6. 9.None		2.Encroach 5.Flood Pl 9.
Bsmt Gar # Cars <b>0</b>		Entrance Code <b>5 Estimated</b>
Wet Basement <b>1 Dry Basement</b>		1.Interior 4.Vacant 7.
1.Dry 4. 7.		2.Refusal 5.Estimate 8.
2.Damp 5. 8.	3.Informed 6. 9.	
3.Wet 6. 9.	Information Code <b>5 Estimate</b>	
	1.Owner 4.Agent 7.	
	2.Relative 5.Estimate 8.	
	3.Tenant 6.Other 9.	

Date Inspected 5/17/2024

**Additions, Outbuildings & Improvements**

Type	Year	Units	Grade	Cond	Phys.	Funct.	Sound Value
1 One Story Frame	0	240	0 0	0	0 %	100 %	
24 Frame Shed	0	240	4 100	0	0 %	100 %	
21 Open Frame	0	69	0 0	0	0 %	100 %	
24 Frame Shed	0	144	3 100	4	0 %	100 %	
24 Frame Shed	2008	96	3 100	4	0 %	100 %	
					%	%	
					%	%	
					%	%	
					%	%	
					%	%	
					%	%	
					%	%	

