

TOMBARELLI, KEVIN M
 TOMBARELLI, KATHY L
 7 GRAY PARK
 GRAY ME 04039

B35078P93

Previous Owner
 SKILLING, CORA L & ROBERT A (DEWISEES)
 C/O BRUCE SKILLING-PERSONAL REPRESENTATIVE
 146 MOUNTAIN VIEW ROAD
 GRAY ME 04039
 Sale Date: 8/17/2018

| Property Data | | |
|------------------|--------------------------------|-------------|
| Neighborhood | 83 Avg-Good Location | |
| Tree Growth Year | 0 | |
| REVIEW | 0 | |
| Building Permit | 0 | |
| Zone/Land Use | 19 Village Center | |
| Secondary Zone | | |
| Topography | 1 Level | |
| 1. Soil | 4. Below St | 7. |
| 2. Rolling | 5. Low | 8. |
| 3. Above St | 6. Swampy | 9. |
| Utilities | 2 Public Water 6 Septic System | |
| 1. Public | 4. Dr. Well/Po | 7. Cesspool |
| 2. Water | 5. Dug Well | 8. Lake |
| 3. Holding Ta | 6. Septic | 9. None |
| Street | 1 Paved | |
| 1. Paved | 4. Proposed | 8. |
| 2. Semi Imp | 5. R/O/W | 9. |
| 3. Gravel | 6. | |
| GIS Map | 35 | |
| Field Review | 1 | |
| Sale Data | | |
| Sale Date | 8/17/2018 | |
| Price | 159,000 | |
| Sale Type | 2 Land & Buildings | |
| 1. Land | 4. Mobile | 7. COM |
| 2. L & B | 5. Other | 8. |
| 3. Building | 6. Condo | 9. |
| Financing | 9 Unknown | |
| 1. Convent | 4. Seller | 7. |
| 2. FHA/VA | 5. Private | 8. |
| 3. Assumed | 6. Cash | 9. Unknown |
| Validity | 1 Arms Length Sale | |
| 1. Valid | 4. Split | 7. Multiple |
| 2. Related | 5. Partial | 8. Other |
| 3. Distress | 6. Exempt | 9. Estate |
| Verified | 5 Public Record | |
| 1. Buyer | 4. Agent | 7. Family |
| 2. Seller | 5. Pub Rec | 8. Other |
| 3. Lender | 6. MLS | 9. |

| Assessment Record | | | | |
|-------------------|---------|-----------|--------|---------|
| Year | Land | Buildings | Exempt | Total |
| 2011 | 38,000 | 64,920 | 0 | 102,920 |
| 2012 | 38,000 | 64,920 | 0 | 102,920 |
| 2013 | 38,000 | 64,920 | 0 | 102,920 |
| 2014 | 38,000 | 64,920 | 0 | 102,920 |
| 2015 | 38,000 | 64,900 | 0 | 102,900 |
| 2016 | 38,000 | 64,900 | 0 | 102,900 |
| 2017 | 38,000 | 64,900 | 0 | 102,900 |
| 2018 | 38,000 | 64,900 | 0 | 102,900 |
| 2019 | 35,600 | 90,100 | 0 | 125,700 |
| 2020 | 35,600 | 90,100 | 0 | 125,700 |
| 2021 | 35,600 | 90,100 | 25,000 | 100,700 |
| 2022 | 35,600 | 92,000 | 25,000 | 102,600 |
| 2023 | 35,600 | 107,200 | 25,000 | 117,800 |
| Calc. | 110,700 | 144,900 | 25,000 | 230,600 |

Inspection Witnessed By:

| No./Date | Description | Date Insp. |
|----------|-------------|------------|
| X | | |
| | | |
| | | |

Notes:
5-24 DR FIELD REVIEW

Gray

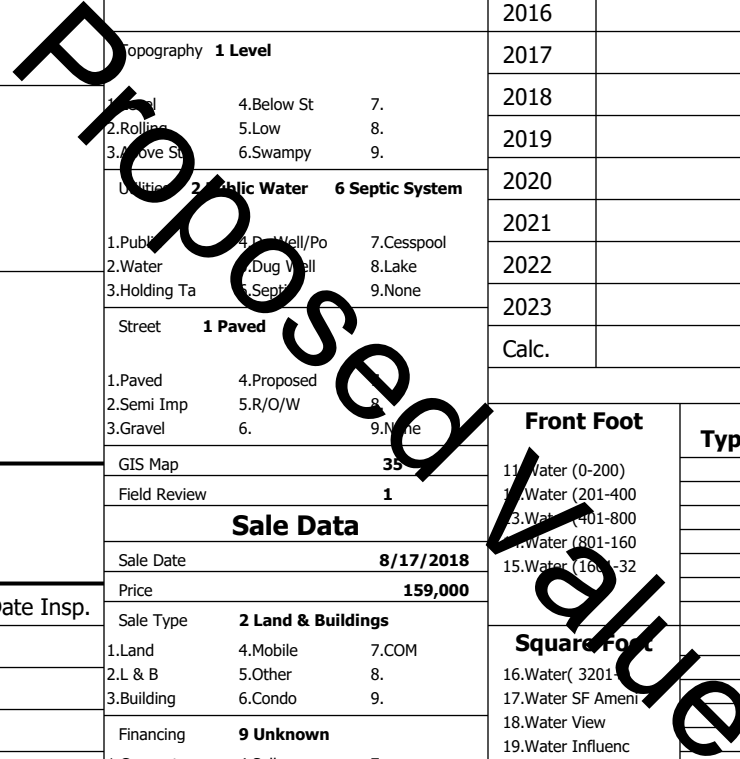

| Land Data | | | | | |
|-----------------------------|-----------|-------|-----------|------|------------------|
| Type | Effective | | Influence | | Influence Codes |
| | Frontage | Depth | Factor | Code | |
| 1. Water (0-200) | | | % | | 1. Unimproved |
| 2. Water (201-400) | | | % | | 2. Excess Frtg |
| 3. Water (401-800) | | | % | | 3. Topography |
| 4. Water (801-1600) | | | % | | 4. Size/Shape |
| 5. Water (1601-3200) | | | % | | 5. Access |
| 6. Water (3201-6400) | | | % | | 6. Restriction |
| 7. Water (6401-12800) | | | % | | 7. Open Space |
| 8. Water (12801-25600) | | | % | | 8. Environmental |
| 9. Water (25601-51200) | | | % | | 9. Condo |
| 10. Water (51201-102400) | | | % | | |
| 11. Water (102401-204800) | | | % | | |
| 12. Water (204801-409600) | | | % | | |
| 13. Water (409601-819200) | | | % | | |
| 14. Water (819201-1638400) | | | % | | |
| 15. Water (1638401-3276800) | | | % | | |
| 16. Water (3276801-6553600) | | | % | | |
| 17. Water SF Amenities | | | % | | |
| 18. Water View | | | % | | |
| 19. Water Influenced | | | % | | |
| 20. ShoreFront A | | | % | | |
| 21. Base Lot | | | % | | |
| 22. Base Lot Vacant | | | % | | |
| 23. Base Lot Unpaved | | | % | | |
| 24. Acres to 10 | | | % | | |
| 25. Acres 11-30 | | | % | | |
| 26. Acres 31-50 | | | % | | |
| 27. Acres 51 & over | | | % | | |
| 28. Acres 71 & Over | | | % | | |
| 29. Woods (41+) | | | % | | |
| Total Acreage | | | 0.21 | | |

- 30. Blueberry(1-20
- 31. Blueberry(21 -
- 32. Crop Land
- 33. Pasture
- 34. Shorefront B
- 35. Shorefront C
- 36. ANTENNA SITE
- 37. Softwood TG
- 38. Mixed Wood TG
- 39. Hardwood TG
- 40. Wasteland
- 41. Woodland
- 42. Mobile Home Si
- 43. Camp Site
- 44. Lot Improvemen
- 45. BA SF - Oce
- 46. SP Meadow Cond

