

AITKENHEAD, ALEXANDRA
8 SUNSET VIEW #4
GRAY ME 04039

B18833P160 B33587P199

Previous Owner
UNDERWOOD, JAIME B
8 SUNSET VIEW #4

GRAY ME 04039
Sale Date: 11/07/2016

Property Data		
Neighborhood	83 Avg-Good Location	
Tree Growth Year	0	
REVIEW	0	
Building Permit	0	
Zone/Land Use	19 Village Center	
Secondary Zone		
Topography	1 Level	
1. Soil	4. Below St	7.
2. Rolling	5. Low	8.
3. Above St	6. Swampy	9.
Utilities	2 Public Water 6 Septic System	
1. Public	4. Dr. Well/Po	7. Cesspool
2. Water	5. Dug Well	8. Lake
3. Holding Ta	6. Septic	9. None
Street	1 Paved	
1. Paved	4. Proposed	8.
2. Semi Imp	5. R/O/W	9.
3. Gravel	6.	
GIS Map	35	
Field Review	1	
Sale Data		
Sale Date	11/07/2016	
Price	82,000	
Sale Type	2 Land & Buildings	
1. Land	4. Mobile	7. COM
2. L & B	5. Other	8.
3. Building	6. Condo	9.
Financing	9 Unknown	
1. Convent	4. Seller	7.
2. FHA/VA	5. Private	8.
3. Assumed	6. Cash	9. Unknown
Validity	8 Other Non Valid	
1. Valid	4. Split	7. Multiple
2. Related	5. Partial	8. Other
3. Distress	6. Exempt	9. Estate
Verified	1 Buyer	
1. Buyer	4. Agent	7. Family
2. Seller	5. Pub Rec	8. Other
3. Lender	6. MLS	9.

Assessment Record				
Year	Land	Buildings	Exempt	Total
2011	20,000	51,216	0	71,216
2012	20,000	51,216	0	71,216
2013	20,000	51,216	0	71,216
2014	20,000	51,216	0	71,216
2015	20,000	51,200	0	71,200
2016	20,000	51,200	0	71,200
2017	20,000	51,200	0	71,200
2018	20,000	51,200	0	71,200
2019	20,000	84,900	0	104,900
2020	20,000	84,900	0	104,900
2021	20,000	84,900	0	104,900
2022	20,000	84,900	0	104,900
2023	20,000	105,900	0	125,900
Calc.	88,000	116,900	0	204,900

Land Data						
Type	Effective		Influence		Influence Codes	
	Frontage	Depth	Factor	Code		
11. Water (0-200)			%		1. Unimproved	
12. Water (201-400)			%		2. Excess Frtg	
13. Water (401-800)			%		3. Topography	
14. Water (801-160)			%		4. Size/Shape	
15. Water (1601-32)			%		5. Access	
			%		6. Restriction	
			%		7. Open Space	
			%		8. Environmental	
			%		9. Condo	
Square Foot		Square Feet		Acres		
16. Water(3201-			%		30. Blueberry(1-20	
17. Water SF Amen			%		31. Blueberry(21 -	
18. Water View			%		32. Crop Land	
19. Water Influen			%		33. Pasture	
20. ShoreFront A			%		34. Shorefront B	
			%		35. Shorefront C	
Fract. Acre		Acreage/Sites				
21. Base Lot	47	1.00	100	%	0	36. ANTENNA SITE
22. Base Lot Vacan				%		37. Softwood TG
23. Base Lot Unpav				%		38. Mixed Wood TG
				%		39. Hardwood TG
24. Acres to 10				%		40. Wasteland
25. Acres 11-30				%		41. Woodland
26. Acres 31-50				%		42. Mobile Home Si
27. Acres 51& over				%		43. Camp Site
28. Acres 71 & Ove				%		44. Lot Improvemen
29. Woods (41+)				%		45. BA SF - Oce
						46. SP Meadow Cond
Total Acreage		0.00				

Inspection Witnessed By:

No./Date	Description	Date Insp.
X		

Notes:

Gray

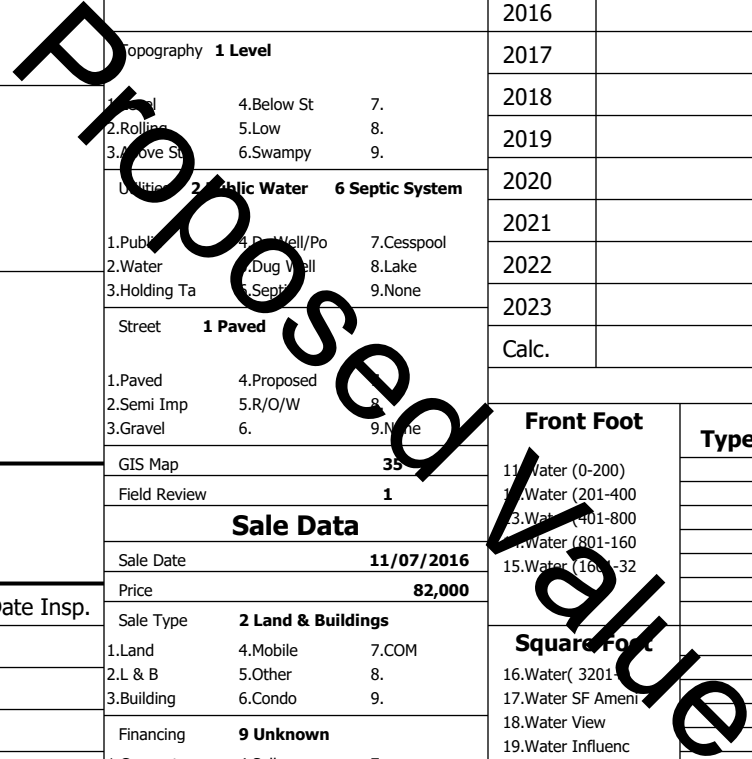

Gray

Map Lot 035-402-023-004

Account 4317

Location 8 SUNSET VIEW #4

Card 1

Of 1

8/05/2024

Building Style 19 Sunset Condo	SF Bsmt Living 0	Layout 1 Typical
1.Conv. 5.Garrison 9.NE farm	Fin Bsmt Grade 0 0	1.Typical 4. 7.
2.Ranch 6.Split 10.Colonia	Secondary Heat 0	2.Inadeq 5. 8.
3.R Ranch/ 7.Contemp 11.Cottage	Heat Type 100% 1 Hot Water BB	3. 6. 9.
4.Cape 8.Log 12.Gambrel	1.HWBB 5.FWA 9.None	Attic 9 None
Dwelling Units 1	2.HWCI 6.Monitor 10.UNH2F	1.1/4 Fin 4.Full Fin 7.
Other Units 0	3.HWRF 7.Electric 11.Geother	2.1/2 Fin 5.FI/Stair 8.
Stories 5 One & 3/4 Story	4.Steam 8.FI/Wall 12.Heat/Co	3.3/4 Fin 6. 9.None
1.1 4.1.5 7.	Cool Type 0% 9 None	Insulation 1 Full
2.2 5.1.75 8.	1.Central 4.W&C Air 7.	1.Full 4.Minimal 7.
3.3 6.2.5 9.	2.Evapor 5. 8.	2.Heavy 5. 8.
Exterior Walls 8 Wood Shingle	3.H Pump 6. 9.None	3.Capped 6. 9.None
1.Clapboar 5.Stucco 9.B & B	Kitchen Style 2 Typical	Unfinished % 0%
2.Vin/Al 6.Brick 10.Cemplan	1.Modern 4.Obsolete	Grade & Factor 3 Average 100%
3.Compos./ 7.Stone 11.Concret	2.Typical 5. 8.	1.E Grade 4.B Grade 7.SC Grade
4.Asbestos 8.Wood Shi 12.Wood Bo	3.Old Type 6. 9.None	2.O Grade 5.A Grade 8.
Roof Surface 1 Asphalt Shingles	Bath(s) Style 2 Typical Bath(s)	3.O Grade 6.AA Grade 9.Same
1.Asphalt 4.Composit 7.Other	1.Modern 4.Obsolete 7.	SQFT (Footprint) 402
2.Slate 5.Wood 8.	2.Typical 5. 8.	Condition 4 Average
3.Metal 6.Roll Roo 9.	3.Old Type 6. 9.None	1.Poor Avg 7.V G
SF Masonry Trim 0	# Rooms 4	2.Fair Avg 8.Exc
SOLAR VOLTAIC 0	# Bedrooms 2	3.Avg-Good 9.Same
OPEN-4- 0	# Full Baths 1	Phys. % Good 0%
Year Built 1973	# Half Baths 0	Funct. % Good 100%
Year Remodeled 0	# Addn Fixtures 0	Functional Code 9 None
Foundation 1 Concrete	# Fireplaces 0	1.Incomp 4.Delap 5.Layoff
1.Concrete 4.Wood 7.		2.O-Built 5.Bsmt 6.Land Term
2.C Block 5.Slab 8.		3.Damage 6.Style 7.None
3.Br/Stone 6.Piers 9.		Econ. % Good 100%
Basement 4 Full Basement		Economic Code None
1.1/4 Bmt 4.Full Bmt 7.		0.None 3.No Power 6.Obsolete
2.1/2 Bmt 5.Crwl 8.		1.Location 4.Generate 9.None
3.3/4 Bmt 6. 9.None		2.Encroach 5.Flood Pl 9.
Bsmt Gar # Cars 0		Entrance Code 5 Estimated
Wet Basement 1 Dry Basement		1.Interior 4.Vacant 7.
1.Dry 4. 7.		2.Refusal 5.Estimate 8.
2.Damp 5. 8.	3.Informed 6. 9.	
3.Wet 6. 9.	Information Code 5 Estimate	
	1.Owner 4.Agent 7.	
	2.Relative 5.Estimate 8.	
	3.Tenant 6.Other 9.	

Date Inspected 12/16/2015

Additions, Outbuildings & Improvements

Type	Year	Units	Grade	Cond	Phys.	Funct.	Sound Value
68 Wood Deck	0	128	0 0	0	0 %	0 %	
26 1SFr Overhang	0	14	0 0	0	0 %	0 %	
					%	%	
					%	%	
					%	%	
					%	%	
					%	%	
					%	%	
					%	%	
					%	%	
					%	%	

