

CUMBERLAND COUNTY FEDERAL CREDIT UNION
101 GRAY RD
FALMOUTH ME 04105

B26211P58

Property Data			Assessment Record						
Neighborhood 16 Lewiston Commercial			Year	Land	Buildings	Exempt	Total		
Tree Growth Year 0			2011	178,133	613,560	0	791,693		
REVIEW c			2012	178,133	613,560	0	791,693		
Building Permit 0			2013	178,133	613,560	0	791,693		
Zone/Land Use 13 Commercial			2014	178,133	613,560	0	791,693		
Secondary Zone			2015	178,100	613,600	0	791,700		
Topography 1 Level			2016	178,100	613,600	0	791,700		
1. Level 4. Below St 7.			2017	178,100	613,600	0	791,700		
2. Rolling 5. Low 8.			2018	178,100	613,600	0	791,700		
3. Above St 6. Swampy 9.			2019	146,200	688,600	0	834,800		
Utilities 2 Public Water 6 Septic System			2020	146,200	688,600	0	834,800		
1. Public 4. Dr. Well/Po 7. Cesspool			2021	146,200	688,600	0	834,800		
2. Water 8. Dug Well 8. Lake			2022	146,200	688,500	0	834,700		
3. Holding Ta 9. None			2023	146,200	688,500	0	834,700		
Street 1 Paved			Calc.	260,200	923,200	0	1,183,400		
1. Paved 4. Proposed			Land Data						
2. Semi Imp 5. R/O/W			Front Foot	Type	Effective		Influence		Influence Codes
3. Gravel 6. 9. None					Frontage	Depth	Factor	Code	
GIS Map 0			11. Water (0-200)				%		1. Unimproved
Field Review 0			12. Water (201-400)				%		2. Excess Frtg
Sale Data			13. Water (401-800)				%		3. Topography
Sale Date 7/16/2008			14. Water (801-160)				%		4. Size/Shape
Price 245,000			15. Water (161-32)				%		5. Access
Sale Type 1 Land Only			Square Foot				%		6. Restriction
1. Land 4. Mobile 7.COM			Square Feet				%		7. Open Space
2. L & B 5. Other 8.			16. Water (3201-				%		8. Environmental
3. Building 6. Condo 9.			17. Water SF Amen				%		9. Condo
Financing			18. Water View				%		Acres
1. Convent 4. Seller 7.			19. Water Influen				%		30. Blueberry(1-20
2. FHA/VA 5. Private 8.			20. ShoreFront A				%		31. Blueberry(21 -
3. Assumed 6. Cash 9. Unknown			Fract. Acre				%		32. Crop Land
Validity			21. Base Lot				%		33. Pasture
1. Valid 4. Split 7. Multiple			22. Base Lot Vacan				%		34. Shorefront B
2. Related 5. Partial 8. Other			23. Base Lot Unpav				%		35. Shorefront C
3. Distress 6. Exempt 9. Estate			Acres				%		36. ANTENNA SITE
Verified			24. Acres to 10				%		37. Softwood TG
1. Buyer 4. Agent 7. Family			25. Acres 11-30				%		38. Mixed Wood TG
2. Seller 5. Pub Rec 8. Other			26. Acres 31-50				%		39. Hardwood TG
3. Lender 6. MLS 9.			27. Acres 51& over				%		40. Wasteland
			28. Acres 71 & Ove				%		41. Woodland
			29. Woods (41+)				%		42. Mobile Home Si
			Total Acreage 0.95						43. Camp Site

Inspection Witnessed By:

X	Date	Description	Date Insp.

Notes:

Gray

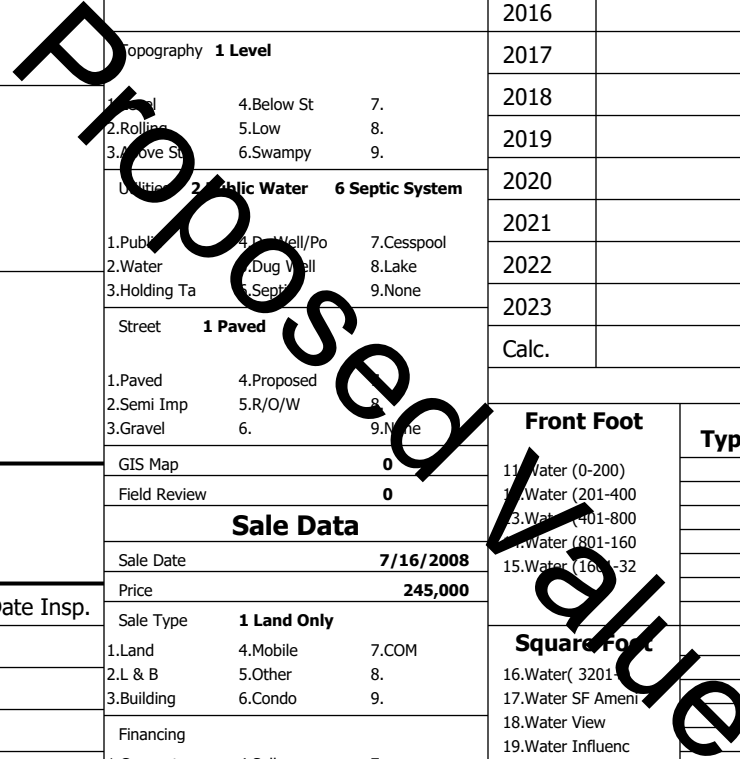

Gray

Map Lot 035-025-017-001

Account 4627

Location 43 LEWISTON RD

Card 1 Of 1

8/05/2024

Building Style 0	SF Bsmt Living 0	Layout 0
1.Conv. 5.Garrison 9.NE farm	Fin Bsmt Grade 0 0	1.Typical 4. 7.
2.Ranch 6.Split 10.Colonia	Secondary Heat 0	2.Inadeq 5. 8.
3.R Ranch/ 7.Contemp 11.Cottage	Heat Type 100% 0	3. 6. 9.
4.Cape 8.Log 12.Gambrel	1.HWBB 5.FWA 9.None	Attic 0
Dwelling Units 0	2.HWCI 6.Monitor 10.UNH2F	1.1/4 Fin 4.Full Fin 7.
Other Units 0	3.HWRF 7.Electric 11.Geother	2.1/2 Fin 5.FI/Stair 8.
Stories 0	4.Steam 8.FI/Wall 12.Heat/Co	3.3/4 Fin 6. 9.None
1.1 4.1.5 7.	Cool Type 0% 9 None	Insulation 0
2.2 5.1.75 8.	1.Central 4.W&C Air 7.	1.Full 4.Minimal 7.
3.3 6.2.5 9.	2.Evapor 5. 8.	2.Heavy 5. 8.
Exterior Walls 0	3.H Pump 6. 9.None	3.Capped 6. 9.None
1.Clapboar 5.Stucco 9.B & B	Kitchen Style 0	Unfinished % 0%
2.Vin/Al 6.Brick 10.Cemplan	1.Modern 4.Obsolete	Grade & Factor 0 0%
3.Compos./ 7.Stone 11.Concret	2.Typical 5. 8.	1.E Grade 4.B Grade 7.SC Grade
4.Asbestos 8.Wood Shi 12.Wood Bo	3.Old Type 6. 9.None	2.O Grade 5.A Grade 8.
Roof Surface 0	Bath(s) Style 0	3.Grade 6.AA Grade 9.Same
1.Asphalt 4.Composit 7.Other	1.Modern 4.Obsolete 7.	SQFT (Footprint) 0
2.Slate 5.Wood 8.	2.Typical 5. 8.	1.Poor Avg 7.V G
3.Metal 6.Roll Roo 9.	3.Old Type 6. 9.None	2.Fair Avg 8.Exc
SF Masonry Trim 0	# Rooms 0	3.Avg- Good 9.Same
SOLAR VOLTAIC 0	# Bedrooms 0	Phys. % Good 0%
OPEN-4- 0	# Full Baths 0	Funct. % Good 100%
Year Built 0	# Half Baths 0	Functional Code 9 None
Year Remodeled 0	# Addn Fixtures 0	1.Incomp 4.Delap 9.None
Foundation 0	# Fireplaces 0	2.O-Built 5.Bsmt 8.Long term
1.Concrete 4.Wood 7.		3.Damage 6.Style 9.None
2.C Block 5.Slab 8.		Econ. % Good 100%
3.Br/Stone 6.Piers 9.		Economic Code None
Basement 0		0.None 3.No Power 6.Obsolete
1.1/4 Bmt 4.Full Bmt 7.		1.Location 4.Generate 9.None
2.1/2 Bmt 5.Crwl 8.		2.Encroach 5.Flood Pl 9.
3.3/4 Bmt 6. 9.None		Entrance Code 1 Interior Inspect
Bsmt Gar # Cars 0		1.Interior 4.Vacant 7.
Wet Basement 0		2.Refusal 5.Estimate 8.
1.Dry 4. 7.		3.Informed 6. 9.
2.Damp 5. 8.		Information Code 4 Agent
3.Wet 6. 9.		1.Owner 4.Agent 7.
		2.Relative 5.Estimate 8.
		3.Tenant 6.Other 9.

Date Inspected 12/11/2015

Additions, Outbuildings & Improvements

Type	Year	Units	Grade	Cond	Phys.	Funct.	Sound Value
281 BANK FRAME	2009	2976	4 100	4	0 %	100 %	
21 Open Frame	2009	92	4 100	4	0 %	100 %	1.One Story Fram
21 Open Frame	2009	140	4 100	4	0 %	100 %	2.Two Story Fram
276 SERVICE	2009	481	4 100	4	0 %	100 %	3.Three Story Fr
283 BSMT BANK	2009	2976	4 100	4	0 %	50 %	4.1 & 1/2 Story
					%	%	5.1 & 3/4 Story
					%	%	6.2 & 1/2 Story
					%	%	21.Open Frame Por
					%	%	22.Encl Frame Por
					%	%	23.Frame Garage
					%	%	24.Frame Shed
					%	%	25.Frame Bay Wind
					%	%	26.1SFr Overhang
					%	%	27.Unfin Basement
					%	%	28.Unfinished Att
					%	%	29.Finished Attic

