

EMERY, SALLY A
PO BOX 102
GRAY ME 04039

B4033P336

Inspection Witnessed By:

No./Date	Description	Date Insp.
X		

Notes:
2/25/2020 Home is being rented - No Homestead Exemption
5-24 DR FIELD REVIEW

Gray

Property Data			Assessment Record					
Neighborhood 81 Fair-Traffic			Year	Land	Buildings	Exempt	Total	
Tree Growth Year 0			2011	42,000	104,222	8,500	137,722	
REVIEW 0			2012	42,000	104,222	8,500	137,722	
Building Permit 0			2013	42,000	104,222	8,500	137,722	
Zone/Land Use 22 Wellhead Protection II			2014	42,000	104,222	8,500	137,722	
Secondary Zone 21 Wellhead Prot I			2015	42,000	104,200	9,000	137,200	
Topography 1 Level			2016	42,000	104,200	9,000	137,200	
1. Level 4. Below St 7.			2017	42,000	104,200	13,500	132,700	
2. Rolling 5. Low 8.			2018	42,000	104,200	18,000	128,200	
3. Above St 6. Swampy 9.			2019	61,200	198,400	20,000	239,600	
Utilities 2 Public Water 6 Septic System			2020	61,200	198,400	20,000	239,600	
1. Public 4. Drilled Well/Po 7. Cesspool			2021	61,200	198,400	25,000	234,600	
2. Water 8. Lake			2022	61,200	198,400	25,000	234,600	
3. Holding Ta 9. None			2023	61,200	225,500	25,000	261,700	
Street 1 Paved			Calc.	111,700	307,000	25,000	393,700	
1. Paved 4. Proposed			Land Data					
2. Semi Imp 5. R/O/W			Front Foot	Type	Effective		Influence	
3. Gravel 6. None			11. Water (0-200)		Frontage	Depth	Factor	Code
GIS Map 35			12. Water (201-400)				%	1. Unimproved
Field Review 1			13. Water (401-800)				%	2. Excess Frtg
Sale Data			14. Water (801-160)				%	3. Topography
Sale Date			15. Water (161-32)				%	4. Size/Shape
Price			16. Water (3201-)				%	5. Access
Sale Type			17. Water SF Amen				%	6. Restriction
1. Land 4. Mobile 7.COM			18. Water View				%	7. Open Space
2. L & B 5. Other 8.			19. Water Influen				%	8. Environmental
3. Building 6. Condo 9.			20. ShoreFront A				%	9. Condo
Financing			Square Foot	Square Feet				Acres
1. Convent 4. Seller 7.			21. Base Lot	21	1.00	100	%	30. Blueberry(11-20
2. FHA/VA 5. Private 8.			22. Base Lot Vacan				%	31. Blueberry(21 -
3. Assumed 6. Cash 9. Unknown			23. Base Lot Unpav				%	32. Crop Land
Validity			Acres				%	33. Pasture
1. Valid 4. Split 7. Multiple			24. Acres to 10				%	34. Shorefront B
2. Related 5. Partial 8. Other			25. Acres 11-30				%	35. Shorefront C
3. Distress 6. Exempt 9. Estate			26. Acres 31-50				%	36. ANTENNA SITE
Verified			27. Acres 51& over				%	37. Softwood TG
1. Buyer 4. Agent 7. Family			28. Acres 71 & Ove				%	38. Mixed Wood TG
2. Seller 5. Pub Rec 8. Other			29. Woods (41+)				%	39. Hardwood TG
3. Lender 6. MLS 9.			Total Acreage		1.00			40. Wasteland
								41. Woodland
								42. Mobile Home Si
								43. Camp Site
								44. Lot Improvemen
								45. BA SF - Oce
								46. SP Meadow Cond

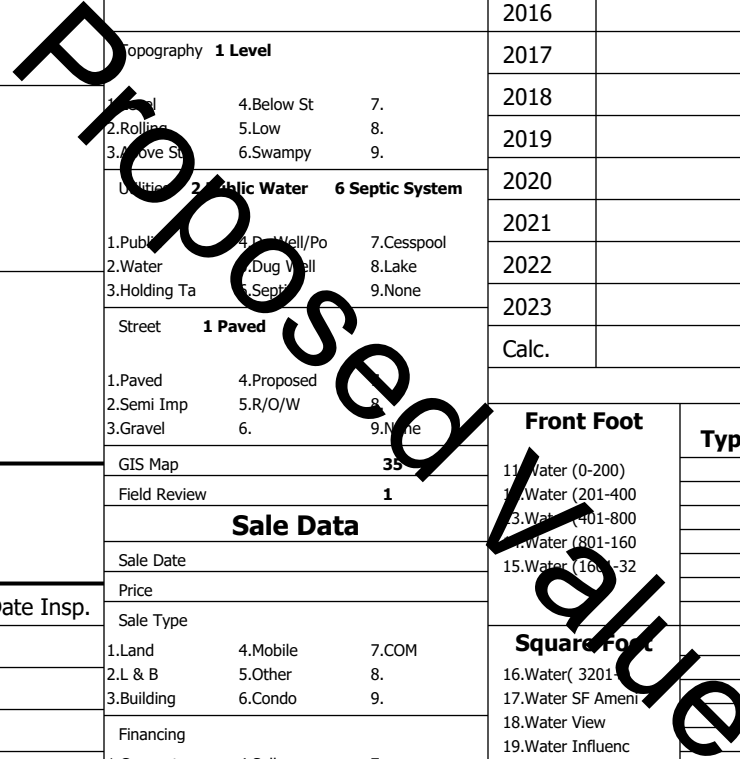

Gray

Map Lot 035-025-010-000

Account 1371

Location 50 SHAKER RD

Card 1

Of 1

8/05/2024

Building Style 10 Colonial	SF Bsmt Living 0	Layout 1 Typical
1.Conv. 5.Garrison 9.NE farm	Fin Bsmt Grade 0 0	1.Typical 4. 7.
2.Ranch 6.Split 10.Colonia	Secondary Heat 0	2.Inadeq 5. 8.
3.R Ranch/ 7.Contemp 11.Cottage	Heat Type 100% 4 Steam	3. 6. 9.
4.Cape 8.Log 12.Gambrel	1.HWBB 5.FWA 9.None	Attic 5 Floor & Stairs
Dwelling Units 1	2.HWCI 6.Monitor 10.UNH2F	1.1/4 Fin 4.Full Fin 7.
Other Units 0	3.HWRF 7.Electric 11.Geother	2.1/2 Fin 5.FI/Stair 8.
Stories 2 Two Story	4.Steam 8.FI/Wall 12.Heat/Co	3.3/4 Fin 6. 9.None
1.1 4.1.5 7.	Cool Type 0% 9 None	Insulation 1 Full
2.2 5.1.75 8.	1.Central 4.W&C Air 7.	1.Full 4.Minimal 7.
3.3 6.2.5 9.	2.Evapor 5. 8.	2.Heavy 5. 8.
Exterior Walls 2 Vinyl/Aluminum	3.H Pump 6. 9.None	3.Capped 6. 9.None
1.Clapboar 5.Stucco 9.B & B	Kitchen Style 2 Typical	Unfinished % 0%
2.Vin/Al 6.Brick 10.Cemplan	1.Modern 4.Obsolete	Grade & Factor 3 Average 110%
3.Compos./ 7.Stone 11.Concret	2.Typical 5. 8.	1.E Grade 4.B Grade 7.SC Grade
4.Asbestos 8.Wood Shi 12.Wood Bo	3.Old Type 6. 9.None	2.D Grade 5.A Grade 8.
Roof Surface 3 Metal	Bath(s) Style 2 Typical Bath(s)	3.Grade 6.AA Grade 9.Same
1.Asphalt 4.Composit 7.Other	1.Modern 4.Obsolete 7.	SQFT (Footprint) 840
2.Slate 5.Wood 8.	2.Typical 5. 8.	Condition 4 Average
3.Metal 6.Roll Roo 9.	3.Old Type 6. 9.None	1.Poor Avg 7.V G
SF Masonry Trim 0	# Rooms 6	2.Fair Avg 8.Exc
SOLAR VOLTAIC 0	# Bedrooms 3	3.Avg- Good 9.Same
OPEN-4- 0	# Full Baths 1	Phys. % Good 0%
Year Built 1930	# Half Baths 1	Funct. % Good 100%
Year Remodeled 1970	# Addn Fixtures 1	Functional Code 9 None
Foundation 3 Brick &/or Stone	# Fireplaces 0	1.Incomp 4.Delap 5.Layoff
1.Concrete 4.Wood 7.		2.O-Built 5.Bsmt 6.Long term
2.C Block 5.Slab 8.		3.Damage 6.Style 9.None
3.Br/Stone 6.Piers 9.		Econ. % Good 100%
Basement 4 Full Basement		Economic Code None
1.1/4 Bmt 4.Full Bmt 7.		0.None 3.No Power 6.Obsolete
2.1/2 Bmt 5.Crwl 8.		1.Location 4.Generate 9.None
3.3/4 Bmt 6. 9.None		2.Encroach 5.Flood Pl 9.
Bsmt Gar # Cars 0		Entrance Code 5 Estimated
Wet Basement 1 Dry Basement		1.Interior 4.Vacant 7.
1.Dry 4. 7.		2.Refusal 5.Estimate 8.
2.Damp 5. 8.	3.Informed 6. 9.	
3.Wet 6. 9.	Information Code 5 Estimate	
	1.Owner 4.Agent 7.	
	2.Relative 5.Estimate 8.	
	3.Tenant 6.Other 9.	

Date Inspected 5/17/2024

Additions, Outbuildings & Improvements

Type	Year	Units	Grade	Cond	Phys.	Funct.	Sound Value
22 Encl Frame Porch	0	240	0 0	0	0	100 %	
11 1 Story/Basement	0	260	0 0	0	0	100 %	
22 Encl Frame Porch	0	98	0 0	0	0	100 %	
23 Frame Garage	0	1000	3 100	4	0	100 %	
24 Frame Shed	0	352	3 100	4	0	100 %	
24 Frame Shed	0	600	2 100	4	0	100 %	
24 Frame Shed	0	80	3 100	4	0	100 %	
					%	%	
					%	%	
					%	%	

