

EMERY, SALLY A
EMERY, HEATH L & KELLY K
50 SHAKER ROAD
GRAY ME 04039

B23972P210 B36340P283

Previous Owner
BARTON, JANE N (HEIRS)
C/O CRAIG BARTON
61 SHAKER ROAD
GRAY ME 04039
Sale Date: 1/14/2020

| Property Data | | |
|------------------|--------------------------------|-------------|
| Neighborhood | 81 Fair-Traffic | |
| Tree Growth Year | 0 | |
| REVIEW | 0 | |
| Building Permit | 0 | |
| Zone/Land Use | 22 Wellhead Protection II | |
| Secondary Zone | 21 Wellhead Prot I | |
| Topography | 1 Level | |
| 1. Soil | 4. Below St | 7. |
| 2. Rolling | 5. Low | 8. |
| 3. Above St | 6. Swampy | 9. |
| Utilities | 2 Public Water 6 Septic System | |
| 1. Public | 4. Dr. Well/Po | 7. Cesspool |
| 2. Water | 5. Dug Well | 8. Lake |
| 3. Holding Ta | 6. Septic | 9. None |
| Street | 1 Paved | |
| 1. Paved | 4. Proposed | 8. |
| 2. Semi Imp | 5. R/O/W | 9. |
| 3. Gravel | 6. | |
| GIS Map | 35 | |
| Field Review | 1 | |
| Sale Data | | |
| Sale Date | 1/14/2020 | |
| Price | 350,000 | |
| Sale Type | 2 Land & Buildings | |
| 1. Land | 4. Mobile | 7. COM |
| 2. L & B | 5. Other | 8. |
| 3. Building | 6. Condo | 9. |
| Financing | 9 Unknown | |
| 1. Convent | 4. Seller | 7. |
| 2. FHA/VA | 5. Private | 8. |
| 3. Assumed | 6. Cash | 9. Unknown |
| Validity | 1 Arms Length Sale | |
| 1. Valid | 4. Split | 7. Multiple |
| 2. Related | 5. Partial | 8. Other |
| 3. Distress | 6. Exempt | 9. Estate |
| Verified | 5 Public Record | |
| 1. Buyer | 4. Agent | 7. Family |
| 2. Seller | 5. Pub Rec | 8. Other |
| 3. Lender | 6. MLS | 9. |

| Assessment Record | | | | |
|-------------------|---------|-----------|--------|---------|
| Year | Land | Buildings | Exempt | Total |
| 2012 | 65,700 | 169,629 | 8,500 | 226,829 |
| 2013 | 65,700 | 169,600 | 9,000 | 226,300 |
| 2014 | 65,700 | 169,600 | 9,000 | 226,300 |
| 2018 | 65,700 | 169,600 | 18,000 | 217,300 |
| 2019 | 112,700 | 149,200 | 20,000 | 241,900 |
| 2021 | 113,600 | 149,200 | 0 | 262,800 |
| 2022 | 113,600 | 149,200 | 0 | 262,800 |
| 2023 | 113,600 | 167,700 | 0 | 281,300 |
| Calc. | 224,200 | 234,700 | 0 | 458,900 |

Inspection Witnessed By:

| X | Date |
|----------|-------------|
| No./Date | Description |
| | Date Insp. |

Notes:
2/25/2020 Home is being rented - No Homestead Exemption
5-24 DR FIELD REVIEW

Gray

| Land Data | | | | | |
|----------------------|-----------|-------------|-----------|-------|--------------------|
| Type | Effective | | Influence | | Influence Codes |
| | Frontage | Depth | Factor | Code | |
| 11. Water (0-200) | | | % | | 1. Unimproved |
| 12. Water (201-400) | | | % | | 2. Excess Frtg |
| 13. Water (401-800) | | | % | | 3. Topography |
| 14. Water (801-160) | | | % | | 4. Size/Shape |
| 15. Water (1601-32) | | | % | | 5. Access |
| | | | % | | 6. Restriction |
| | | | % | | 7. Open Space |
| | | | % | | 8. Environmental |
| | | | % | | 9. Condo |
| Square Foot | | Square Feet | | Acres | |
| 16. Water (3201-) | | | % | | 30. Blueberry(1-20 |
| 17. Water SF Amen | | | % | | 31. Blueberry(21 - |
| 18. Water View | | | % | | 32. Crop Land |
| 19. Water Influen | | | % | | 33. Pasture |
| 20. ShoreFront A | | | % | | 34. Shorefront B |
| | | | % | | 35. Shorefront C |
| | | | % | | 36. ANTENNA SITE |
| 21. Base Lot | 1.84 | 100 | % | 0 | 37. Softwood TG |
| 22. Base Lot Vacan | 10.00 | 100 | % | 0 | 38. Mixed Wood TG |
| 23. Base Lot Unpav | 9.28 | 100 | % | 0 | 39. Hardwood TG |
| | | | % | | 40. Wasteland |
| | | | % | | 41. Woodland |
| | | | % | | 42. Mobile Home Si |
| | | | % | | 43. Camp Site |
| | | | % | | 44. Lot Improvemen |
| | | | % | | 45. BA SF - Oce |
| | | | % | | 46. SP Meadow Cond |
| Total Acreage | | 21.12 | | | |

EMERY, SALLY A
EMERY, HEATH L & KELLY K
50 SHAKER ROAD
GRAY ME 04039

B23972P210 B36340P283

Previous Owner
BARTON, JANE N (HEIRS)
C/O CRAIG BARTON
61 SHAKER ROAD
GRAY ME 04039
Sale Date: 1/14/2020

| Property Data | | | Assessment Record | | | | |
|------------------|---------------------------|--|-------------------|------|-----------|--------|---------|
| Neighborhood | 81 Fair-Traffic | | Year | Land | Buildings | Exempt | Total |
| Tree Growth Year | 0 | | 2013 | 0 | 0 | 0 | 0 |
| REVIEW | 0 | | 2014 | 0 | 0 | 0 | 0 |
| Building Permit | 0 | | 2018 | 0 | 0 | 0 | 0 |
| Zone/Land Use | 22 Wellhead Protection II | | 2019 | 0 | 69,500 | 0 | 69,500 |
| Secondary Zone | 21 Wellhead Prot I | | 2021 | 0 | 69,500 | 0 | 69,500 |
| Topography | | | 2022 | 0 | 69,500 | 0 | 69,500 |
| | | | 2023 | 0 | 69,500 | 0 | 69,500 |
| | | | Calc. | 0 | 173,800 | 0 | 173,800 |

| Land Data | | Front Foot | | Effective | | Influence | | Influence Codes |
|----------------------|--|------------|-------|-----------|------|-----------|--|-------------------|
| Type | | Frontage | Depth | Factor | Code | | | |
| 11. Water (0-200) | | | | % | | | | 1.Unimproved |
| 12. Water (201-400) | | | | % | | | | 2.Excess Frtg |
| 13. Water (401-800) | | | | % | | | | 3.Topography |
| 14. Water (801-160) | | | | % | | | | 4.Size/Shape |
| 15. Water (1601-32) | | | | % | | | | 5.Access |
| | | | | % | | | | 6.Restriction |
| | | | | % | | | | 7.Open Space |
| | | | | % | | | | 8.Environmental |
| | | | | % | | | | 9.Condo |
| | | | | % | | | | 30.Blueberry(1-20 |
| | | | | % | | | | 31.Blueberry(21 - |
| | | | | % | | | | 32.Crop Land |
| | | | | % | | | | 33.Pasture |
| | | | | % | | | | 34.Shorefront B |
| | | | | % | | | | 35.Shorefront C |
| | | | | % | | | | 36.ANTENNA SITE |
| | | | | % | | | | 37.Softwood TG |
| | | | | % | | | | 38.Mixed Wood TG |
| | | | | % | | | | 39.Hardwood TG |
| | | | | % | | | | 40.Wasteland |
| | | | | % | | | | 41.Woodland |
| | | | | % | | | | 42.Mobile Home Si |
| | | | | % | | | | 43.Camp Site |
| | | | | % | | | | 44.Lot Improvemen |
| | | | | % | | | | 45.BA SF - Oce |
| | | | | % | | | | 46.SP Meadow Cond |
| Total Acreage | | 0.00 | | | | | | |

Inspection Witnessed By:

| X | Date |
|----------|-------------|
| No./Date | Description |
| | Date Insp. |

Notes:
5/24 DR FIELD REVIEW

Gray

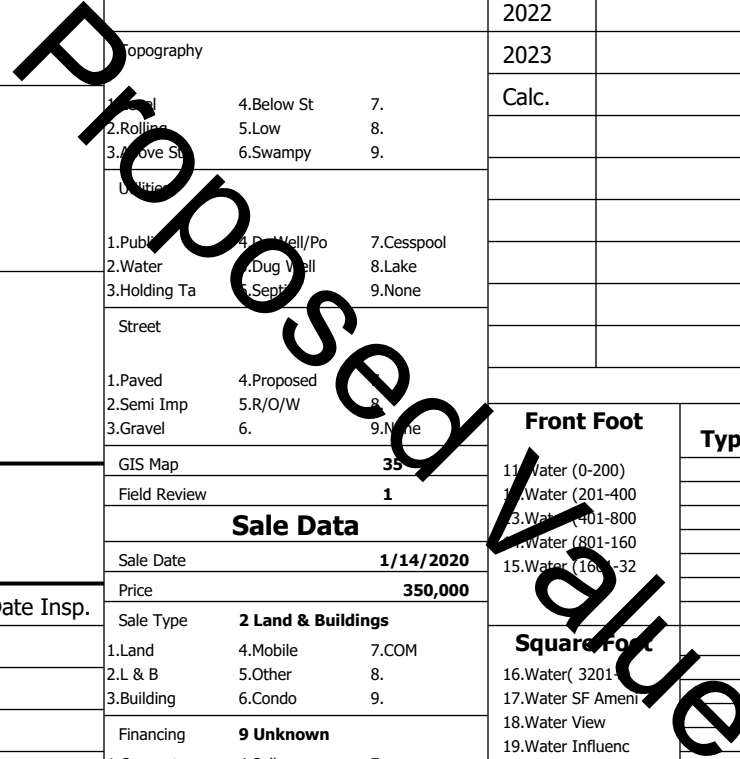

Gray

Map Lot 035-025-009-000

Account 1370

Location 52 SHAKER RD

Card 2

Of 2

8/05/2024

| | | | | | | |
|--------------------------|----------------|------------|---|------------|------------|----------------------------------|
| Building Style | SF Bsmt Living | | | Layout | | |
| 1.Conv. | 5.Garrison | 9.NE farm | Fin Bsmt Grade | | | 1.Typical 4. 7. |
| 2.Ranch | 6.Split | 10.Colonia | Secondary Heat | | | 2.Inadeq 5. 8. |
| 3.R Ranch/ | 7.Contemp | 11.Cottage | Heat Type | | | 3. 6. 9. |
| 4.Cape | 8.Log | 12.Gambrel | 1.HWBB | 5.FWA | 9.None | Attic |
| Dwelling Units | | | 2.HWCI | 6.Monitor | 10.UNH2F | 1.1/4 Fin 4.Full Fin 7. |
| Other Units | | | 3.HWRF | 7.Electric | 11.Geother | 2.1/2 Fin 5.F/Stair 8. |
| Stories | | | 4.Steam | 8.F/Wall | 12.Heat/Co | 3.3/4 Fin 6. 9.None |
| 1.1 | 4.1.5 | 7. | Cool Type | | | Insulation |
| 2.2 | 5.1.75 | 8. | 1.Central | 4.W&C Air | 7. | 1.Full 4.Minimal 7. |
| 3.3 | 6.2.5 | 9. | 2.Evapor | 5. | 8. | 2.Heavy 5. 8. |
| Exterior Walls | | | 3.H Pump | 6. | 9.None | 3.Capped 6. 9.None |
| 1.Clapboar | 5.Stucco | 9.B & B | Kitchen Style | | | Unfinished % |
| 2.Vin/Al | 6.Brick | 10.Cemplan | 1.Modern | 4.Obsolete | 7. | Grade & Factor |
| 3.Compos./ | 7.Stone | 11.Concret | 2.Typical | 5. | 8. | 1.E Grade 4.B Grade 7.SC Grade |
| 4.Asbestos | 8.Wood Shi | 12.Wood Bo | 3.Old Type | 6. | 9.None | 2.D Grade 5.A Grade 8. |
| Roof Surface | | | Bath(s) Style | | | 3.C Grade 6.AA Grade 9.Same |
| 1.Asphalt | 4.Composit | 7.Other | 1.Modern | 4.Obsolete | 7. | SQFT (Footprint) |
| 2.Slate | 5.Wood | 8. | 2.Typical | 5. | 8. | 1.Poor 2.Avg 7.V G |
| 3.Metal | 6.Roll Roo | 9. | 3.Old Type | 6. | 9.None | 2.Fair 3.Avg 8.Exc |
| SF Masonry Trim | | | # Rooms | | | 3.Avg- 9.Good 9.Same |
| SOLAR VOLTAIC | | | # Bedrooms | | | Phys. % Good |
| OPEN-4- | | | # Full Baths | | | Funct. % Good |
| Year Built | | | # Half Baths | | | Functional Code |
| Year Remodeled | | | # Addn Fixtures | | | 1.Incomp 4.Delap 7.Poor |
| Foundation | | | # Fireplaces | | | 2.O-Built 5.Bsmt 8.Long term |
| 1.Concrete | 4.Wood | 7. |  | | | 3.Damage 6.Style None |
| 2.C Block | 5.Slab | 8. | | | | Econ. % Good |
| 3.Br/Stone | 6.Piers | 9. | | | | Economic Code |
| Basement | | | | | | 0.None 3.No Power 6.Obsolete |
| 1.1/4 Bmt | 4.Full Bmt | 7. | | | | 1.Location 4.Generate 9.None |
| 2.1/2 Bmt | 5.Crwl | 8. | | | | 2.Encroach 5.Flood Pl 9. |
| 3.3/4 Bmt | 6. | 9.None | | | | Entrance Code 5 Estimated |
| Bsmt Gar # Cars | | | | | | 1.Interior 4.Vacant 7. |
| Wet Basement | | | | | | 2.Refusal 5.Estimate 8. |
| 1.Dry | 4. | 7. | | | | 3.Informed 6. 9. |
| 2.Damp | 5. | 8. | Information Code 5 Estimate | | | |
| 3.Wet | 6. | 9. | 1.Owner 4.Agent 7. | | | |
| Date Inspected 5/17/2024 | | | 2.Relative 5.Estimate 8. | | | |
| | | | 3.Tenant 6.Other 9. | | | |

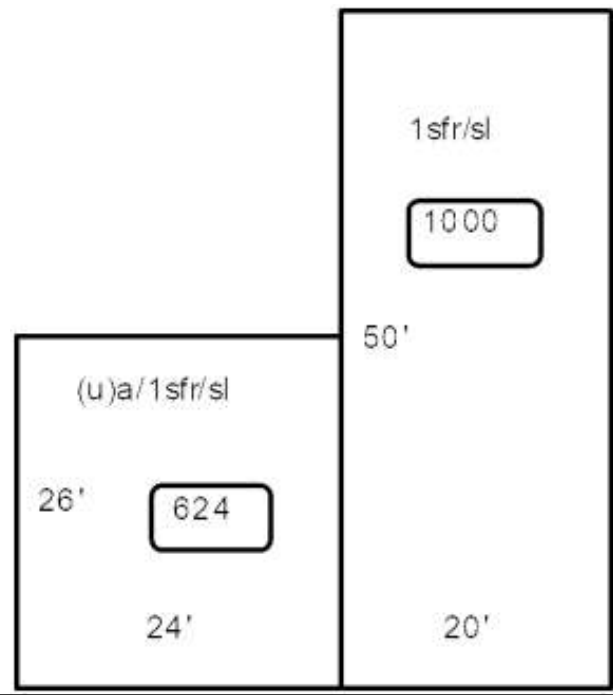

Proposed Value

| Additions, Outbuildings & Improvements | | | | | | | | |
|--|------|-------|-------|------|-------|--------|-------------|-------------------|
| Type | Year | Units | Grade | Cond | Phys. | Funct. | Sound Value | |
| 1 One Story Frame | 1985 | 1624 | 2 100 | 4 | 0 % | 100 % | | 1.One Story Fram |
| 23 Frame Garage | 1950 | 1800 | 2 100 | 3 | 0 % | 100 % | | 2.Two Story Fram |
| 61 Canopy | 1950 | 300 | 2 100 | 3 | 0 % | 100 % | | 3.Three Story Fr |
| | | | | | % | % | | 4.1 & 1/2 Story |
| | | | | | % | % | | 5.1 & 3/4 Story |
| | | | | | % | % | | 6.2 & 1/2 Story |
| | | | | | % | % | | 21.Open Frame Por |
| | | | | | % | % | | 22.Encl Frame Por |
| | | | | | % | % | | 23.Frame Garage |
| | | | | | % | % | | 24.Frame Shed |
| | | | | | % | % | | 25.Frame Bay Wind |
| | | | | | % | % | | 26.1SFr Overhang |
| | | | | | % | % | | 27.Unfin Basement |
| | | | | | % | % | | 28.Unfinished Att |
| | | | | | % | % | | 29.Finished Attic |