

ALLEN, TERRI L  
56 SHAKER RD  
GRAY ME 04039

B12903P343

Inspection Witnessed By:

X	Date	Date Insp.
No./Date	Description	Date Insp.

Notes:  
5/24 DR FIELD REVIEW

Gray

Property Data			Assessment Record						
Neighborhood <b>81 Fair-Traffic</b>			Year	Land	Buildings	Exempt	Total		
Tree Growth Year <b>0</b>			2011	49,000	75,897	8,500	116,397		
REVIEW <b>0</b>			2012	49,000	75,897	8,500	116,397		
Building Permit <b>0</b>			2013	49,000	75,897	8,500	116,397		
Zone/Land Use <b>22 Wellhead Protection II</b>			2014	49,000	75,897	8,500	116,397		
Secondary Zone <b>21 Wellhead Prot I</b>			2015	49,000	75,900	9,000	115,900		
Topography <b>1 Level</b>			2016	49,000	75,900	9,000	115,900		
1. Level 4. Below St 7.			2017	49,000	75,900	13,500	111,400		
2. Rolling 5. Low 8.			2018	49,000	75,900	18,000	106,900		
3. Above St 6. Swampy 9.			2019	71,500	127,000	20,000	178,500		
Utilities <b>2 Public Water 6 Septic System</b>			2020	71,500	127,000	20,000	178,500		
1. Public 4. Dr. Well/Po 7. Cesspool			2021	71,500	127,000	25,000	173,500		
2. Water 5. Dug Well 8. Lake			2022	71,500	127,000	25,000	173,500		
3. Holding Ta 6. Septic 9. None			2023	71,500	144,400	25,000	190,900		
Street <b>1 Paved</b>			Calc.	131,100	201,300	25,000	307,400		
1. Paved 4. Proposed			<b>Land Data</b>						
2. Semi Imp 5. R/O/W			<b>Front Foot</b>	<b>Type</b>	<b>Effective</b>		<b>Influence</b>		<b>Influence Codes</b>
3. Gravel 6. None					<b>Frontage</b>	<b>Depth</b>	<b>Factor</b>	<b>Code</b>	
GIS Map <b>35</b>			11. Water (0-200)				%		1. Unimproved
Field Review <b>1</b>			12. Water (201-400)				%		2. Excess Frtg
<b>Sale Data</b>			13. Water (401-800)				%		3. Topography
Sale Date <b>1/13/1997</b>			14. Water (801-160)				%		4. Size/Shape
Price			15. Water (161-32)				%		5. Access
Sale Type							%		6. Restriction
1. Land 4. Mobile 7. COM			<b>Square Foot</b>	<b>Square Feet</b>					7. Open Space
2. L & B 5. Other 8.			16. Water ( 3201-				%		8. Environmental
3. Building 6. Condo 9.			17. Water SF Amen				%		9. Condo
Financing			18. Water View				%		<b>Acres</b>
1. Convent 4. Seller 7.			19. Water Influen				%		30. Blueberry(1-20
2. FHA/VA 5. Private 8.			20. ShoreFront A				%		31. Blueberry(21 -
3. Assumed 6. Cash 9. Unknown							%		32. Crop Land
Validity			<b>Fract. Acre</b>	<b>Acres/Sites</b>					33. Pasture
1. Valid 4. Split 7. Multiple			21. Base Lot	21	1.84	100	%	0	34. Shorefront B
2. Related 5. Partial 8. Other			22. Base Lot Vacan	24	2.16	100	%	0	35. Shorefront C
3. Distress 6. Exempt 9. Estate			23. Base Lot Unpav				%		36. ANTENNA SITE
Verified			<b>Acres</b>				%		37. Softwood TG
1. Buyer 4. Agent 7. Family			24. Acres to 10				%		38. Mixed Wood TG
2. Seller 5. Pub Rec 8. Other			25. Acres 11-30				%		39. Hardwood TG
3. Lender 6. MLS 9.			26. Acres 31-50				%		40. Wasteland
			27. Acres 51& over				%		41. Woodland
			28. Acres 71 & Ove				%		42. Mobile Home Si
			29. Woods (41+)				%		43. Camp Site
			<b>Total Acreage</b>		<b>4.00</b>				44. Lot Improvemen
									45. BA SF - Oce
									46. SP Meadow Cond

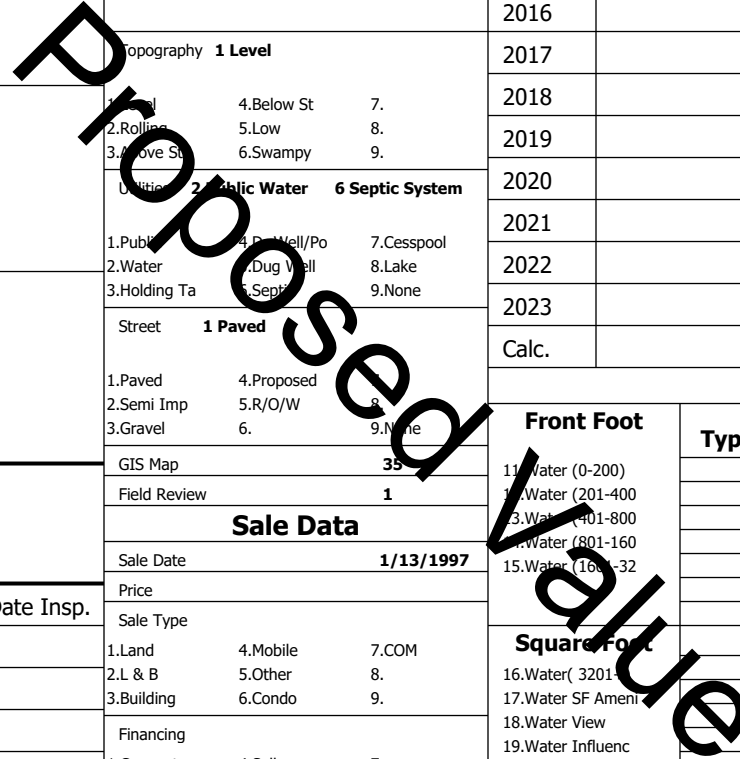

**Gray**

Map Lot 035-025-008-001

Account 1489

Location 58 SHAKER RD

Card 1 Of 1

8/05/2024

Building Style <b>2 Ranch</b>	SF Bsmt Living <b>0</b>	Layout <b>1 Typical</b>
1.Conv. 5.Garrison 9.NE farm	Fin Bsmt Grade <b>0 0</b>	1.Typical 4. 7.
2.Ranch 6.Split 10.Colonia	Secondary Heat <b>0</b>	2.Inadeq 5. 8.
3.R Ranch/ 7.Contemp 11.Cottage	Heat Type <b>100% 5 Forced Warm Air</b>	3. 6. 9.
4.Cape 8.Log 12.Gambrel	1.HWBB 5.FWA 9.None	Attic <b>9 None</b>
Dwelling Units <b>1</b>	2.HWCI 6.Monitor 10.UNH2F	1.1/4 Fin 4.Full Fin 7.
Other Units <b>0</b>	3.HWRF 7.Electric 11.Geother	2.1/2 Fin 5.FI/Stair 8.
Stories <b>1 One Story</b>	4.Steam 8.FI/Wall 12.Heat/Co	3.3/4 Fin 6. 9.None
1.1 4.1.5 7.	Cool Type <b>0% 9 None</b>	Insulation <b>1 Full</b>
2.2 5.1.75 8.	1.Central 4.W&C Air 7.	1.Full 4.Minimal 7.
3.3 6.2.5 9.	2.Evapor 5. 8.	2.Heavy 5. 8.
Exterior Walls <b>2 Vinyl/Aluminum</b>	3.H Pump 6. 9.None	3.Capped 6. 9.None
1.Clapboard 5.Stucco 9.B & B	Kitchen Style <b>2 Typical</b>	Unfinished % <b>0%</b>
2.Vin/Al 6.Brick 10.Cemplan	1.Modern 4.Obsolete	Grade & Factor <b>3 Average 100%</b>
3.Compos./ 7.Stone 11.Concret	2.Typical 5. 8.	1.E Grade 4.B Grade 7.SC Grade
4.Asbestos 8.Wood Shi 12.Wood Bo	3.Old Type 6. 9.None	2.O Grade 5.A Grade 8.
Roof Surface <b>1 Asphalt Shingles</b>	Bath(s) Style <b>2 Typical Bath(s)</b>	3.C Grade 6.AA Grade 9.Same
1.Asphalt 4.Composit 7.Other	1.Modern 4.Obsolete 7.	SQFT (Footprint) <b>1120</b>
2.Slate 5.Wood 8.	2.Typical 5. 8.	Foundation <b>4 Average</b>
3.Metal 6.Roll Roo 9.	3.Old Type 6. 9.None	1.Poor 2.Avg 7.V G
SF Masonry Trim <b>0</b>	# Rooms <b>5</b>	2.Fair 3.Good 8.Exc
SOLAR VOLTAIC <b>0</b>	# Bedrooms <b>3</b>	3.Avg- 4.Good 9.Same
OPEN-4- <b>0</b>	# Full Baths <b>1</b>	Phys. % Good <b>0%</b>
Year Built <b>1984</b>	# Half Baths <b>0</b>	Funct. % Good <b>100%</b>
Year Remodeled <b>0</b>	# Addn Fixtures <b>0</b>	Functional Code <b>9 None</b>
Foundation <b>1 Concrete</b>	# Fireplaces <b>0</b>	1.Incomp 4.Delap 5.Playo
1.Concrete 4.Wood 7.		2.O-Built 5.Bsmt 6.Long term
2.C Block 5.Slab 8.		3.Damage 6.Style 7.None
3.Br/Stone 6.Piers 9.		Econ. % Good <b>100%</b>
Basement <b>4 Full Basement</b>		Economic Code <b>None</b>
1.1/4 Bmt 4.Full Bmt 7.		0.None 3.No Power 6.Obsolete
2.1/2 Bmt 5.Crwl 8.		1.Location 4.Generate 9.None
3.3/4 Bmt 6. 9.None		2.Encroach 5.Flood Pl 9.
Bsmt Gar # Cars <b>0</b>		Entrance Code <b>5 Estimated</b>
Wet Basement <b>1 Dry Basement</b>		1.Interior 4.Vacant 7.
1.Dry 4. 7.		2.Refusal 5.Estimate 8.
2.Damp 5. 8.		3.Informed 6. 9.
3.Wet 6. 9.		Information Code <b>5 Estimate</b>
		1.Owner 4.Agent 7.
		2.Relative 5.Estimate 8.
		3.Tenant 6.Other 9.

Date Inspected 5/17/2024

**Additions, Outbuildings & Improvements**

Type	Year	Units	Grade	Cond	Phys.	Funct.	Sound Value
68 Wood Deck	2010	140	0 0	0	0	100 %	
23 Frame Garage	1984	624	3 100	4	0	100 %	
89 DH Bsmt Entry	1984	1	0 0	0	0	100 %	
						% %	1.One Story Fram
						% %	2.Two Story Fram
						% %	3.Three Story Fr
						% %	4.1 & 1/2 Story
						% %	5.1 & 3/4 Story
						% %	6.2 & 1/2 Story
						% %	21.Open Frame Por
						% %	22.Encl Frame Por
						% %	23.Frame Garage
						% %	24.Frame Shed
						% %	25.Frame Bay Wind
						% %	26.1SFr Overhang
						% %	27.Unfin Basement
						% %	28.Unfinished Att
						% %	29.Finished Attic

