

BREWER, JUSTIN P  
BREWER, KELLY M  
381 RAMSDELL ROAD  
GRAY ME 04039

B29723P299

Inspection Witnessed By:

No./Date	Description	Date Insp.
X		

Notes:

Gray

Property Data			Assessment Record						
Neighborhood <b>5 Little Sebago</b>			Year	Land	Buildings	Exempt	Total		
Tree Growth Year <b>0</b>			2011	38,500	139,698	0	178,198		
REVIEW <b>0</b>			2012	47,500	139,698	0	187,198		
Building Permit <b>0</b>			2013	47,500	139,698	0	187,198		
Zone/Land Use <b>12 Limited Residential</b>			2014	47,500	135,898	8,500	174,898		
Secondary Zone <b>23 Lake District</b>			2015	47,500	135,900	9,000	174,400		
Topography <b>1 Level</b> <b>3 Above Street</b>			2016	47,500	135,900	9,000	174,400		
1. Level 4. Below St 7.			2017	47,500	135,900	13,500	169,900		
2. Rolling 5. Low 8.			2018	47,500	135,900	18,000	165,400		
3. Above St 6. Swampy 9.			2019	399,900	192,100	20,000	572,000		
Utilities <b>4 Filled Well/Point</b> <b>6 Septic System</b>			2020	399,900	192,100	20,000	572,000		
1. Public 4. Dug Well/Po 7. Cesspool			2021	399,900	192,100	25,000	567,000		
2. Water 5. Dug Well 8. Lake			2022	399,900	259,000	25,000	633,900		
3. Holding Ta 6. Septic 9. None			2023	399,900	290,700	25,000	665,600		
Street <b>3 Gravel</b>			Calc.	813,800	433,700	25,000	1,222,500		
1. Paved 4. Proposed			<b>Land Data</b>						
2. Semi Imp 5. R/O/W			<b>Front Foot</b>	<b>Type</b>	<b>Effective</b>		<b>Influence</b>		<b>Influence Codes</b>
3. Gravel 6. None 9. None			11. Water (0-200)	49	200	000	90 %	5	
GIS Map <b>35</b>			12. Water (201-400)	49	026	000	90 %	5	1. Unimproved
Field Review <b>1</b>			13. Water (401-800)				%		2. Excess Frtg
<b>Sale Data</b>			14. Water (801-160)				%		3. Topography
Sale Date <b>6/15/2012</b>			15. Water (161-32)				%		4. Size/Shape
Price							%		5. Access
Sale Type							%		6. Restriction
1. Land 4. Mobile 7.COM			<b>Square Foot</b>	<b>Square Feet</b>					7. Open Space
2. L & B 5. Other 8.			16. Water ( 3201-				%		8. Environmental
3. Building 6. Condo 9.			17. Water SF Amen				%		9. Condo
Financing			18. Water View				%		<b>Acres</b>
1. Convent 4. Seller 7.			19. Water Influen				%		30. Blueberry(1-20
2. FHA/VA 5. Private 8.			20. ShoreFront A				%		31. Blueberry(21 -
3. Assumed 6. Cash 9.Unknown							%		32. Crop Land
Validity			<b>Fract. Acre</b>	<b>Acreege/Sites</b>					33. Pasture
1. Valid 4. Split 7. Multiple			21. Base Lot	34		1.88	100 %	0	34. Shorefront B
2. Related 5. Partial 8. Other			22. Base Lot Vacan				%		35. Shorefront C
3. Distress 6. Exempt 9. Estate			23. Base Lot Unpav				%		36. ANTENNA SITE
Verified			<b>Acres</b>				%		37. Softwood TG
1. Buyer 4. Agent 7. Family			24. Acres to 10				%		38. Mixed Wood TG
2. Seller 5. Pub Rec 8. Other			25. Acres 11-30				%		39. Hardwood TG
3. Lender 6. MLS 9.			26. Acres 31-50				%		40. Wasteland
			27. Acres 51& over				%		41. Woodland
			28. Acres 71 & Ove				%		42. Mobile Home Si
			29. Woods (41+)				%		43. Camp Site
				<b>Total Acreege</b>		<b>1.88</b>			44. Lot Improvemen
									45. BA SF - Oce
									46. SP Meadow Cond

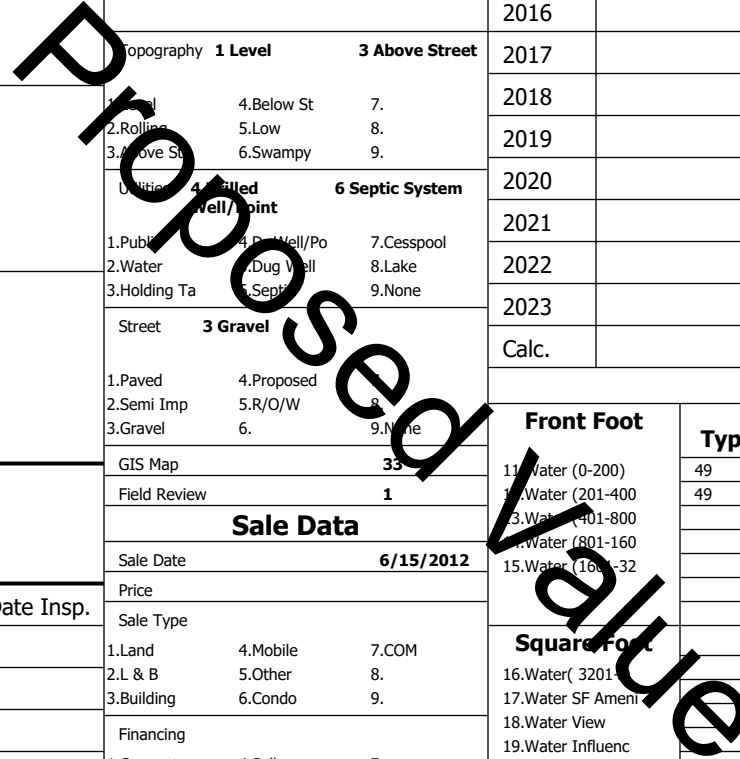

**Gray**

Map Lot 033-304-075-000

Account 3601

Location 381 RAMSDELL RD

Card 1

Of 1

8/05/2024

Building Style <b>1 Conventional</b>	SF Bsmt Living <b>0</b>	Layout <b>1 Typical</b>
1.Conv. 5.Garrison 9.NE farm	Fin Bsmt Grade <b>0 0</b>	1.Typical 4. 7.
2.Ranch 6.Split 10.Colonia	Secondary Heat <b>2</b>	2.Inadeq 5. 8.
3.R Ranch/ 7.Contemp 11.Cottage	Heat Type <b>100% 1 Hot Water BB</b>	3. 6. 9.
4.Cape 8.Log 12.Gambrel	1.HWBB 5.FWA 9.None	Attic <b>9 None</b>
Dwelling Units <b>1</b>	2.HWCI 6.Monitor 10.UNH2F	1.1/4 Fin 4.Full Fin 7.
Other Units <b>0</b>	3.HWRF 7.Electric 11.Geother	2.1/2 Fin 5.FI/Stair 8.
Stories <b>2 Two Story</b>	4.Steam 8.FI/Wall 12.Heat/Co	3.3/4 Fin 6. 9.None
1.1 4.1.5 7.	Cool Type <b>0% 9 None</b>	Insulation <b>1 Full</b>
2.2 5.1.75 8.	1.Central 4.W&C Air 7.	1.Full 4.Minimal 7.
3.3 6.2.5 9.	2.Evapor 5. 8.	2.Heavy 5. 8.
Exterior Walls <b>2 Vinyl/Aluminum</b>	3.H Pump 6. 9.None	3.Capped 6. 9.None
1.Clapboar 5.Stucco 9.B & B	Kitchen Style <b>2 Typical</b>	Unfinished % <b>0%</b>
2.Vin/Al 6.Brick 10.Cemplan	1.Modern 4.Obsolete	Grade & Factor <b>3 Average 110%</b>
3.Compos./ 7.Stone 11.Concret	2.Typical 5. 8.	1.E Grade 4.B Grade 7.SC Grade
4.Asbestos 8.Wood Shi 12.Wood Bo	3.Old Type 6. 9.None	2.C Grade 5.A Grade 8.
Roof Surface <b>1 Asphalt Shingles</b>	Bath(s) Style <b>2 Typical Bath(s)</b>	3.C Grade 6.AA Grade 9.Same
1.Asphalt 4.Composit 7.Other	1.Modern 4.Obsolete 7.	SQFT (Footprint) <b>581</b>
2.Slate 5.Wood 8.	2.Typical 5. 8.	Condition <b>5 Good</b>
3.Metal 6.Roll Roo 9.	3.Old Type 6. 9.None	1.Poor Avg 7.V G
SF Masonry Trim <b>0</b>	# Rooms <b>8</b>	2.Fair Avg 8.Exc
SOLAR VOLTAIC <b>0</b>	# Bedrooms <b>5</b>	3.Avg- Good 9.Same
OPEN-4- <b>0</b>	# Full Baths <b>2</b>	Phys. % Good <b>0%</b>
Year Built <b>2006</b>	# Half Baths <b>0</b>	Funct. % Good <b>100%</b>
Year Remodeled <b>0</b>	# Addn Fixtures <b>2</b>	Functional Code <b>9 None</b>
Foundation <b>1 Concrete</b>	# Fireplaces <b>0</b>	1.Incomp 4.Delap 5.Playo
1.Concrete 4.Wood 7.		2.O-Built 5.Bsmt 6.Long term
2.C Block 5.Slab 8.		3.Damage 6.Style None
3.Br/Stone 6.Piers 9.		Econ. % Good <b>100%</b>
Basement <b>4 Full Basement</b>		Economic Code <b>None</b>
1.1/4 Bmt 4.Full Bmt 7.		0.None 3.No Power 6.Obsolete
2.1/2 Bmt 5.Crw1 8.		1.Location 4.Generate 9.None
3.3/4 Bmt 6. 9.None		2.Encroach 5.Flood Pl 9.
Bsmt Gar # Cars <b>0</b>		Entrance Code <b>5 Estimated</b>
Wet Basement <b>1 Dry Basement</b>		1.Interior 4.Vacant 7.
1.Dry 4. 7.		2.Refusal 5.Estimate 8.
2.Damp 5. 8.		3.Informed 6. 9.
3.Wet 6. 9.		Information Code <b>5 Estimate</b>
		1.Owner 4.Agent 7.
		2.Relative 5.Estimate 8.
		3.Tenant 6.Other 9.

Date Inspected 8/24/2015

**Additions, Outbuildings & Improvements**

Type	Year	Units	Grade	Cond	Phys.	Funct.	Sound Value
68 Wood Deck	0	420	0 0	0	0	100 %	
61 Canopy	2006	60	3 100	4	0	100 %	
24 Frame Shed	2006	120	3 100	4	0	100 %	
11 1 Story/Basement	2006	559	0 0	0	0	100 %	
23 Frame Garage	2017	780	0 0	0	0	100 %	
81 1 St/Garage	2017	624	0 0	0	0	100 %	
68 Wood Deck	2017	192	0 0	0	0	100 %	
						%	
						%	
						%	

- 1.One Story Fram
- 2.Two Story Fram
- 3.Three Story Fr
- 4.1 & 1/2 Story
- 5.1 & 3/4 Story
- 6.2 & 1/2 Story
- 21.Open Frame Por
- 22.Encl Frame Por
- 23.Frame Garage
- 24.Frame Shed
- 25.Frame Bay Wind
- 26.1SFr Overhang
- 27.Unfin Basement
- 28.Unfinished Att
- 29.Finished Attic

