

KANACH, GEORGETTE L
123 RAMSDELL RD.
GRAY ME 04039

B31184P185

Property Data			Assessment Record					
Neighborhood	82 Average Location		Year	Land	Buildings	Exempt	Total	
Tree Growth Year	0		2011	47,250	49,408	0	96,658	
REVIEW	0		2012	47,250	49,408	0	96,658	
Building Permit	0		2013	47,250	49,408	0	96,658	
Zone/Land Use	11 Rural Residential & Agri		2014	46,200	49,408	0	95,608	
Secondary Zone			2015	46,200	49,400	0	95,600	
Topography	2 Rolling		2016	46,200	49,400	0	95,600	
1. Hill	4. Below St	7.	2017	46,200	49,400	0	95,600	
2. Rolling	5. Low	8.	2018	46,200	49,400	0	95,600	
3. Above St	6. Swampy	9.	2019	70,000	41,500	0	111,500	
Utilities	4. Filled Well/Point		2020	70,000	41,500	0	111,500	
1. Public	4. Dug Well/Po	7. Cesspool	2021	70,000	41,500	25,000	86,500	
2. Water	5. Dug Well	8. Lake	2022	70,000	41,500	25,000	86,500	
3. Holding Ta	6. Septic	9. None	2023	70,000	41,500	25,000	86,500	
Street	1 Paved		Calc.	125,000	56,600	25,000	156,600	
1. Paved	4. Proposed	8.	Land Data					
2. Semi Imp	5. R/O/W	9.	Front Foot	Type	Effective	Influence	Influence Codes	
3. Gravel	6.	9.	11. Water (0-200)		Frontage	Depth	Factor	Code
GIS Map	35		12. Water (201-400)				%	1. Unimproved
Field Review	1		13. Water (401-800)				%	2. Excess Frtg
Sale Data			14. Water (801-160)				%	3. Topography
Sale Date	4/18/2012		15. Water (161-320)				%	4. Size/Shape
Price	76,500		16. Water (321-640)				%	5. Access
Sale Type	2 Land & Buildings		17. Water SF Amen				%	6. Restriction
1. Land	4. Mobile	7. COM	18. Water View				%	7. Open Space
2. L & B	5. Other	8.	19. Water Influen				%	8. Environmental
3. Building	6. Condo	9.	20. ShoreFront A				%	9. Condo
Financing			Square Foot	Square Feet				Acres
1. Convent	4. Seller	7.	16. Water (3201				%	30. Blueberry(1-20
2. FHA/VA	5. Private	8.	17. Water SF Amen				%	31. Blueberry(21 -
3. Assumed	6. Cash	9. Unknown	18. Water View				%	32. Crop Land
Validity			19. Water Influen				%	33. Pasture
1. Valid	4. Split	7. Multiple	20. ShoreFront A				%	34. Shorefront B
2. Related	5. Partial	8. Other	Fract. Acre				%	35. Shorefront C
3. Distress	6. Exempt	9. Estate	21. Base Lot	21	1.84	100	%	36. ANTENNA SITE
Verified			22. Base Lot Vacan				%	37. Softwood TG
1. Buyer	4. Agent	7. Family	23. Base Lot Unpav				%	38. Mixed Wood TG
2. Seller	5. Pub Rec	8. Other	Acres				%	39. Hardwood TG
3. Lender	6. MLS	9.	24. Acres to 10				%	40. Wasteland
			25. Acres 11-30				%	41. Woodland
			26. Acres 31-50				%	42. Mobile Home Si
			27. Acres 51& over				%	43. Camp Site
			28. Acres 71 & Ove				%	44. Lot Improvemen
			29. Woods (41+)				%	45. BA SF - Oce
			Total Acreage	1.84				46. SP Meadow Cond

Inspection Witnessed By:

X	Date	Description	Date Insp.

Notes:
5/24-FR=DR

Gray

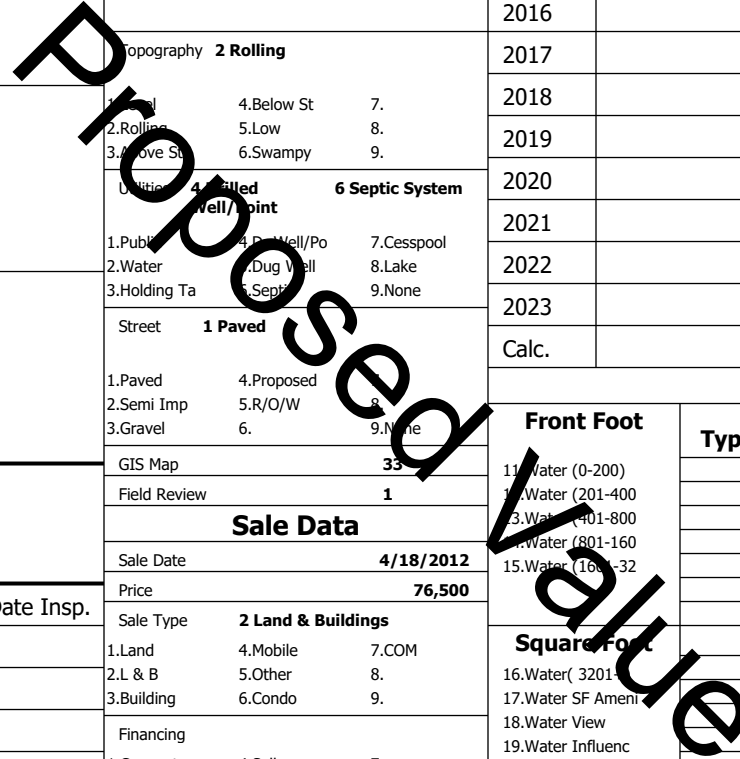

Gray

Map Lot 033-014-014-000

Account 587

Location 123 RAMSDELL RD

Card 1

Of 1

8/05/2024

Building Style 0	SF Bsmt Living 0	Layout 0
1.Conv. 5.Garrison 9.NE farm	Fin Bsmt Grade 0 0	1.Typical 4. 7.
2.Ranch 6.Split 10.Colonia	Secondary Heat 0	2.Inadeq 5. 8.
3.R Ranch/ 7.Contemp 11.Cottage	Heat Type 100% 0	3. 6. 9.
4.Cape 8.Log 12.Gambrel	1.HWBB 5.FWA 9.None	Attic 0
Dwelling Units 0	2.HWCI 6.Monitor 10.UNH2F	1.1/4 Fin 4.Full Fin 7.
Other Units 0	3.HWRF 7.Electric 11.Geother	2.1/2 Fin 5.FI/Stair 8.
Stories 0	4.Steam 8.FI/Wall 12.Heat/Co	3.3/4 Fin 6. 9.None
1.1 4.1.5 7.	Cool Type 0% 9 None	Insulation 0
2.2 5.1.75 8.	1.Central 4.W&C Air 7.	1.Full 4.Minimal 7.
3.3 6.2.5 9.	2.Evapor 5. 8.	2.Heavy 5. 8.
Exterior Walls 0	3.H Pump 6. 9.None	3.Capped 6. 9.None
1.Clapboar 5.Stucco 9.B & B	Kitchen Style 0	Unfinished % 0%
2.Vin/Al 6.Brick 10.Cemplan	1.Modern 4.Obsolete	Grade & Factor 0 0%
3.Compos./ 7.Stone 11.Concret	2.Typical 5. 8.	1.E Grade 4.B Grade 7.SC Grade
4.Asbestos 8.Wood Shi 12.Wood Bo	3.Old Type 6. 9.None	2.D Grade 5.A Grade 8.
Roof Surface 0	Bath(s) Style 0	3.C Grade 6.AA Grade 9.Same
1.Asphalt 4.Composit 7.Other	1.Modern 4.Obsolete 7.	SQFT (Footprint) 0
2.Slate 5.Wood 8.	2.Typical 5. 8.	1.Pool 2.Avg 7.V G
3.Metal 6.Roll Roo 9.	3.Old Type 6. 9.None	2.F 3.Avg 8.Exc
SF Masonry Trim 0	# Rooms 0	3.Avg- 9.Good 9.Same
SOLAR VOLTAIC 0	# Bedrooms 0	Phys. % Good 0%
OPEN-4- 0	# Full Baths 0	Funct. % Good 100%
Year Built 0	# Half Baths 0	Functional Code 9 None
Year Remodeled 0	# Addn Fixtures 0	1.Incomp 4.Delap 5.Layoff
Foundation 0	# Fireplaces 0	2.O-Built 5.Bsmt 6.Long term
1.Concrete 4.Wood 7.		3.Damage 6.Style
2.C Block 5.Slab 8.		Econ. % Good 100%
3.Br/Stone 6.Piers 9.		Economic Code None
Basement 0		0.None 3.No Power 6.Obsolete
1.1/4 Bmt 4.Full Bmt 7.		1.Location 4.Generate 9.None
2.1/2 Bmt 5.Crwl 8.		2.Encroach 5.Flood Pl 9.
3.3/4 Bmt 6. 9.None		Entrance Code 5 Estimated
Bsmt Gar # Cars 0		1.Interior 4.Vacant 7.
Wet Basement 0		2.Refusal 5.Estimate 8.
1.Dry 4. 7.		3.Informed 6. 9.
2.Damp 5. 8.		Information Code 5 Estimate
3.Wet 6. 9.		1.Owner 4.Agent 7.
		2.Relative 5.Estimate 8.
		3.Tenant 6.Other 9.

Date Inspected 5/23/2024

Additions, Outbuildings & Improvements

Type	Year	Units	Grade	Cond	Phys.	Funct.	Sound Value
754 Champion	2002	16x72	4 100	4	0 %	100 %	1.One Story Fram
21 Open Frame	0	85	3 100	0	0 %	100 %	2.Two Story Fram
24 Frame Shed	0	120	3 100	4	0 %	100 %	3.Three Story Fr
24 Frame Shed	2012	96	3 100	4	0 %	100 %	4.1 & 1/2 Story
24 Frame Shed	2009	200	3 100	4	0 %	100 %	5.1 & 3/4 Story
68 Wood Deck	2010	120	3 100	0	0 %	100 %	6.2 & 1/2 Story
					%	%	21.Open Frame Por
					%	%	22.Encl Frame Por
					%	%	23.Frame Garage
					%	%	24.Frame Shed
					%	%	25.Frame Bay Wind
					%	%	26.1SFr Overhang
					%	%	27.Unfin Basement
					%	%	28.Unfinished Att
					%	%	29.Finished Attic

