

DOWD, SHANNON
DOWD, PATRICIA
160 RAMSDELL ROAD
GRAY ME 04039

B39857P212

Previous Owner
BENDIXON, RICHARD J
160 RAMSDELL ROAD

GRAY ME 04039
Sale Date: 11/21/2022

Property Data			Assessment Record				
Neighborhood	82 Average Location		Year	Land	Buildings	Exempt	Total
Tree Growth Year	0		2011	47,000	67,642	8,500	106,142
REVIEW	0		2012	47,000	67,642	8,500	106,142
Building Permit	0		2013	47,000	67,642	8,500	106,142
Zone/Land Use	11 Rural Residential & Agri		2014	47,000	67,642	8,500	106,142
Secondary Zone			2015	47,000	67,600	9,000	105,600
			2016	47,000	67,600	9,000	105,600
Topography	2 Rolling		2017	47,000	67,600	13,500	101,100
			2018	47,000	67,600	18,000	96,600
			2019	70,500	110,800	20,000	161,300
			2020	70,500	110,800	20,000	161,300
			2021	70,500	110,800	25,000	156,300
			2022	70,500	110,800	25,000	156,300
			2023	70,500	129,700	25,000	175,200
			Calc.	126,100	167,500	0	293,600

Land Data					
Type	Effective		Influence		Influence Codes
	Frontage	Depth	Factor	Code	
1. Water (0-200)			%		1.Unimproved
2. Water (201-400)			%		2.Excess Frtg
3. Water (401-800)			%		3.Topography
4. Water (801-160)			%		4.Size/Shape
5. Water (1601-32)			%		5.Access
			%		6.Restriction
			%		7.Open Space
			%		8.Environmental
			%		9.Condo
Square Foot		Square Feet		Acres	
16. Water (3201			%		30.Blueberry(1-20
17. Water SF Amen			%		31.Blueberry(21 -
18. Water View			%		32.Crop Land
19. Water Influen			%		33.Pasture
20. ShoreFront A			%		34.Shorefront B
			%		35.Shorefront C
Fract. Acre		Acreage/Sites			
21. Base Lot	21	1.84	100 %	0	36.ANTENNA SITE
22. Base Lot Vacan	24	0.18	100 %	0	37.Softwood TG
23. Base Lot Unpav			%		38.Mixed Wood TG
			%		39.Hardwood TG
			%		40.Wasteland
			%		41.Woodland
			%		42.Mobile Home Si
			%		43.Camp Site
			%		44.Lot Improvemen
			%		45.BA SF - Oce
			%		46.SP Meadow Cond
Total Acreage		2.02			

Inspection Witnessed By:

X	Date
No./Date	Description
	Date Insp.

Notes:
5/24-FR=DR

Gray

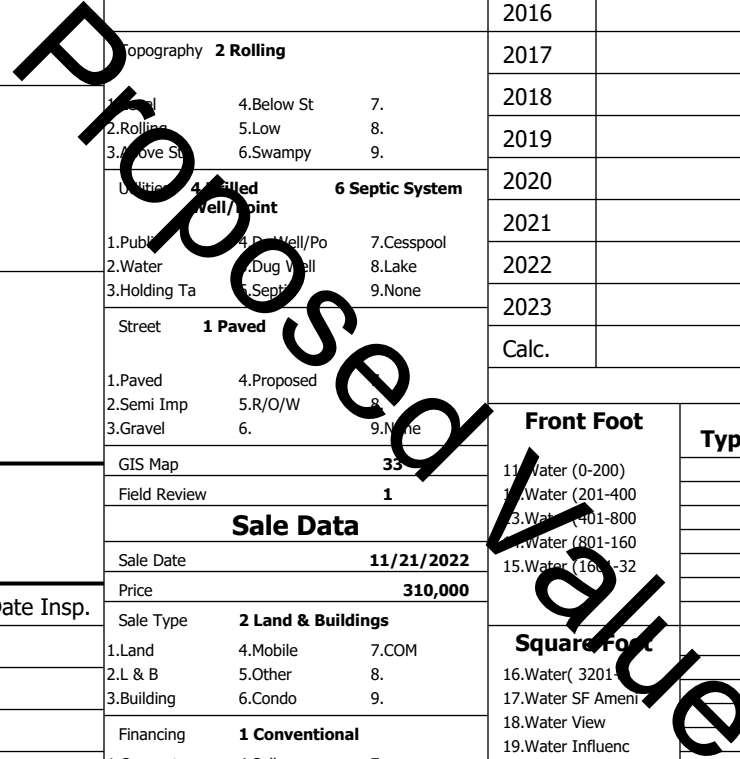

Gray

Map Lot 033-009-001-002

Account 246

Location 160 RAMSDELL RD

Card 1

Of 1

8/05/2024

Building Style 3 Raised Ranch/Split	SF Bsmt Living 192	Layout 1 Typical
1.Conv. 5.Garrison 9.NE farm	Fin Bsmt Grade 2 100	1.Typical 4. 7.
2.Ranch 6.Split 10.Colonia	Secondary Heat 0	2.Inadeq 5. 8.
3.R Ranch/ 7.Contemp 11.Cottage	Heat Type 100% 1 Hot Water BB	3. 6. 9.
4.Cape 8.Log 12.Gambrel	1.HWBB 5.FWA 9.None	Attic 9 None
Dwelling Units 1	2.HWCI 6.Monitor 10.UNH2F	1.1/4 Fin 4.Full Fin 7.
Other Units 0	3.HWRF 7.Electric 11.Geother	2.1/2 Fin 5.FI/Stair 8.
Stories 1 One Story	4.Steam 8.FI/Wall 12.Heat/Co	3.3/4 Fin 6. 9.None
1.1 4.1.5 7.	Cool Type 0% 9 None	Insulation 1 Full
2.2 5.1.75 8.	1.Central 4.W&C Air 7.	1.Full 4.Minimal 7.
3.3 6.2.5 9.	2.Evapor 5. 8.	2.Heavy 5. 8.
Exterior Walls 2 Vinyl/Aluminum	3.H Pump 6. 9.None	3.Capped 6. 9.None
1.Clapboard 5.Stucco 9.B & B	Kitchen Style 2 Typical	Unfinished % 0%
2.Vin/Al 6.Brick 10.Cemplan	1.Modern 4.Obsolete	Grade & Factor 3 Average 100%
3.Compos./ 7.Stone 11.Concret	2.Typical 5. 8.	1.E Grade 4.B Grade 7.SC Grade
4.Asbestos 8.Wood Shi 12.Wood Bo	3.Old Type 6. 9.None	2.D Grade 5.A Grade 8.
Roof Surface 1 Asphalt Shingles	Bath(s) Style 2 Typical Bath(s)	3.C Grade 6.AA Grade 9.Same
1.Asphalt 4.Composit 7.Other	1.Modern 4.Obsolete 7.	SQFT (Footprint) 864
2.Slate 5.Wood 8.	2.Typical 5. 8.	Condition 4 Average
3.Metal 6.Roll Roo 9.	3.Old Type 6. 9.None	1.Poor Avg 7.V G
SF Masonry Trim 0	# Rooms 4	2.Fair Avg 8.Exc
SOLAR VOLTAIC 0	# Bedrooms 2	3.Avg- Good 9.Same
OPEN-4- 0	# Full Baths 1	Phys. % Good 0%
Year Built 1981	# Half Baths 0	Funct. % Good 100%
Year Remodeled 0	# Addn Fixtures 0	Functional Code 9 None
Foundation 1 Concrete	# Fireplaces 0	1.Incomp 4.Delap 9.Layoff
1.Concrete 4.Wood 7.		2.O-Built 5.Bsmt 8.Long term
2.C Block 5.Slab 8.		3.Damage 6.Style 9.None
3.Br/Stone 6.Piers 9.		Econ. % Good 100%
Basement 4 Full Basement		Economic Code None
1.1/4 Bmt 4.Full Bmt 7.		0.None 3.No Power 6.Obsolete
2.1/2 Bmt 5.CrwI 8.		1.Location 4.Generate 9.None
3.3/4 Bmt 6. 9.None		2.Encroach 5.Flood Pl 9.
Bsmt Gar # Cars 0		Entrance Code 5 Estimated
Wet Basement 1 Dry Basement		1.Interior 4.Vacant 7.
1.Dry 4. 7.		2.Refusal 5.Estimate 8.
2.Damp 5. 8.		3.Informed 6. 9.
3.Wet 6. 9.		Information Code 5 Estimate
		1.Owner 4.Agent 7.
		2.Relative 5.Estimate 8.
		3.Tenant 6.Other 9.

Date Inspected 5/23/2024

Additions, Outbuildings & Improvements

Type	Year	Units	Grade	Cond	Phys.	Funct.	Sound Value
68 Wood Deck	1992	240	3 100	4	0 %	100 %	1.One Story Fram
24 Frame Shed	0	96	3 100	4	0 %	100 %	2.Two Story Fram
							3.Three Story Fr
							4.1 & 1/2 Story
							5.1 & 3/4 Story
							6.2 & 1/2 Story
							21.Open Frame Por
							22.Encl Frame Por
							23.Frame Garage
							24.Frame Shed
							25.Frame Bay Wind
							26.1SFr Overhang
							27.Unfin Basement
							28.Unfinished Att
							29.Finished Attic

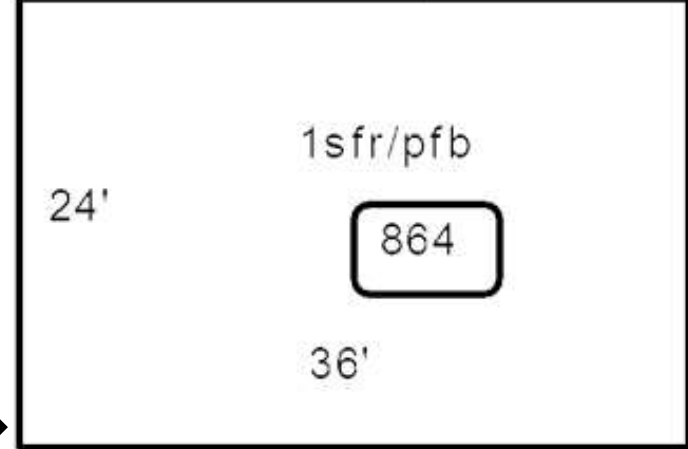
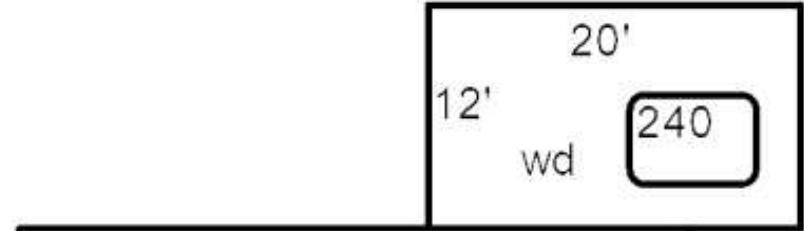

Proposed Value