

BENTLEY, LINDA H  
TRINGALL, LAURA  
66 DEER ACRES ROAD  
RAYMOND ME 04071

B32337P66

Property Data			Assessment Record						
Neighborhood <b>5 Little Sebago</b>			Year	Land	Buildings	Exempt	Total		
Tree Growth Year <b>0</b>			2011	141,000	70,392	8,500	202,892		
REVIEW <b>0</b>			2012	141,000	70,392	8,500	202,892		
Building Permit <b>0</b>			2013	141,000	70,392	8,500	202,892		
Zone/Land Use <b>12 Limited Residential</b>			2014	141,000	70,392	8,500	202,892		
Secondary Zone			2015	141,000	70,400	9,000	202,400		
Topography <b>1 Level</b>			2016	141,000	70,400	9,000	202,400		
1. Hill 4. Below St 7.			2017	141,000	70,400	13,500	197,900		
2. Rolling 5. Low 8.			2018	141,000	70,400	18,000	193,400		
3. Above St 6. Swampy 9.			2019	131,800	92,700	20,000	204,500		
Utilities <b>6 Electric System 4 Drilled Well/Point</b>			2020	131,800	92,700	20,000	204,500		
1. Public 4. Drilled Well/Po 7. Cesspool			2021	131,800	92,700	25,000	199,500		
2. Water 8. Dug Well 8. Lake			2022	131,800	92,700	25,000	199,500		
3. Holding Ta 9. Septic 9. None			2023	131,800	113,200	25,000	220,000		
Street <b>1 Paved</b>			Calc.	281,600	152,500	25,000	409,100		
1. Paved 4. Proposed			<b>Land Data</b>						
2. Semi Imp 5. R/O/W			<b>Front Foot</b>	<b>Type</b>	<b>Effective</b>		<b>Influence</b>		<b>Influence Codes</b>
3. Gravel 6. None					<b>Frontage</b>	<b>Depth</b>	<b>Factor</b>	<b>Code</b>	
GIS Map <b>32</b>			11. Water (0-200)	53	050	000	100 %	0	1. Unimproved
Field Review <b>50</b>			12. Water (201-400)				%		2. Excess Frtg
<b>Sale Data</b>			13. Water (401-800)				%		3. Topography
Sale Date <b>9/12/2000</b>			14. Water (801-160)				%		4. Size/Shape
Price			15. Water (161-32)				%		5. Access
Sale Type			<b>Square Foot</b>	<b>Square Feet</b>			%		6. Restriction
1. Land 4. Mobile 7. COM			16. Water (3201-)				%		7. Open Space
2. L & B 5. Other 8.			17. Water SF Amen				%		8. Environmental
3. Building 6. Condo 9.			18. Water View				%		9. Condo
Financing			19. Water Influen				%		<b>Acres</b>
1. Convent 4. Seller 7.			20. ShoreFront A				%		30. Blueberry(1-20
2. FHA/VA 5. Private 8.			<b>Fract. Acre</b>	<b>Acres/Sites</b>			%		31. Blueberry(21 -
3. Assumed 6. Cash 9. Unknown			21. Base Lot	35		0.17	100 %	0	32. Crop Land
Validity			22. Base Lot Vacan				%		33. Pasture
1. Valid 4. Split 7. Multiple			23. Base Lot Unpav				%		34. Shorefront B
2. Related 5. Partial 8. Other			<b>Acres</b>				%		35. Shorefront C
3. Distress 6. Exempt 9. Estate			24. Acres to 10				%		36. ANTENNA SITE
Verified			25. Acres 11-30				%		37. Softwood TG
1. Buyer 4. Agent 7. Family			26. Acres 31-50				%		38. Mixed Wood TG
2. Seller 5. Pub Rec 8. Other			27. Acres 51& over				%		39. Hardwood TG
3. Lender 6. MLS 9.			28. Acres 71 & Ove				%		40. Wasteland
			29. Woods (41+)				%		41. Woodland
			<b>Total Acreage</b>		<b>0.17</b>				42. Mobile Home Si

Inspection Witnessed By:

No./Date	Description	Date Insp.
X		

Notes:

Gray

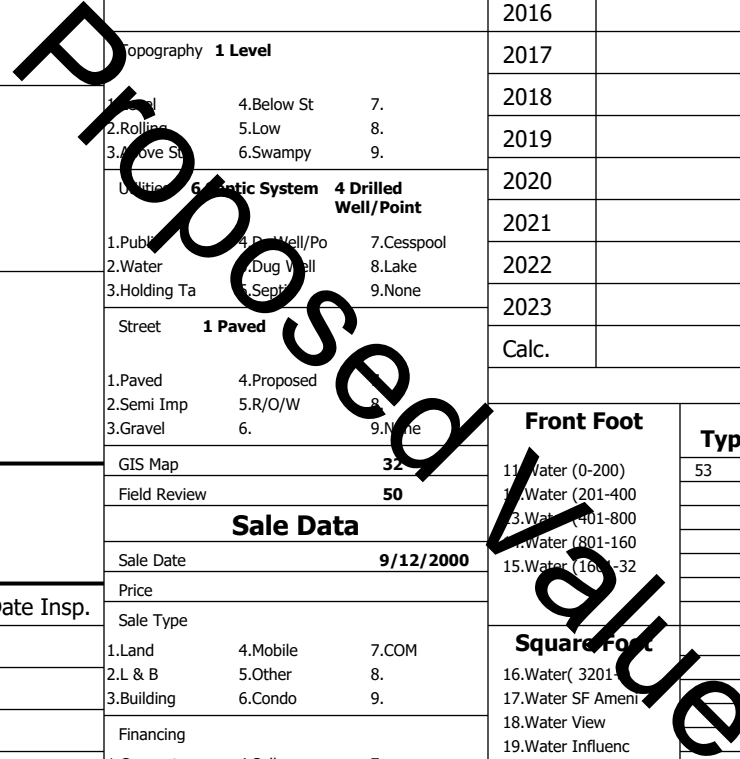

Gray

Map Lot 032-315-002-000

Account 4065

Location 66 DEER ACRES RD

Card 1

Of 1

8/05/2024

Building Style <b>1 Conventional</b>	SF Bsmt Living <b>0</b>	Layout <b>1 Typical</b>
1.Conv. 5.Garrison 9.NE farm	Fin Bsmt Grade <b>0 0</b>	1.Typical 4. 7.
2.Ranch 6.Split 10.Colonia	Secondary Heat <b>0</b>	2.Inadeq 5. 8.
3.R Ranch/ 7.Contemp 11.Cottage	Heat Type <b>100% 6 Monitor</b>	3. 6. 9.
4.Cape 8.Log 12.Gambrel	1.HWBB 5.FWA 9.None	Attic <b>9 None</b>
Dwelling Units <b>1</b>	2.HWCI 6.Monitor 10.UNH2F	1.1/4 Fin 4.Full Fin 7.
Other Units <b>0</b>	3.HWRF 7.Electric 11.Geother	2.1/2 Fin 5.FI/Stair 8.
Stories <b>1 One Story</b>	4.Steam 8.FI/Wall 12.Heat/Co	3.3/4 Fin 6. 9.None
1.1 4.1.5 7.	Cool Type <b>0% 9 None</b>	Insulation <b>1 Full</b>
2.2 5.1.75 8.	1.Central 4.W&C Air 7.	1.Full 4.Minimal 7.
3.3 6.2.5 9.	2.Evapor 5. 8.	2.Heavy 5. 8.
Exterior Walls <b>2 Vinyl/Aluminum</b>	3.H Pump 6. 9.None	3.Capped 6. 9.None
1.Clapboard 5.Stucco 9.B & B	Kitchen Style <b>2 Typical</b>	Unfinished % <b>0%</b>
2.Vin/Al 6.Brick 10.Cemplan	1.Modern 4.Obsolete	Grade & Factor <b>3 Average 110%</b>
3.Compos./ 7.Stone 11.Concret	2.Typical 5. 8.	1.E Grade 4.B Grade 7.SC Grade
4.Asbestos 8.Wood Shi 12.Wood Bo	3.Old Type 6. 9.None	2.D Grade 5.A Grade 8.
Roof Surface <b>1 Asphalt Shingles</b>	Bath(s) Style <b>2 Typical Bath(s)</b>	3.Grade 6.AA Grade 9.Same
1.Asphalt 4.Composit 7.Other	1.Modern 4.Obsolete 7.	SQFT (Footprint) <b>290</b>
2.Slate 5.Wood 8.	2.Typical 5. 8.	Condition <b>4 Average</b>
3.Metal 6.Roll Roo 9.	3.Old Type 6. 9.None	1.Poor Avg 7.V G
SF Masonry Trim <b>0</b>	# Rooms <b>4</b>	2.Fair Avg 8.Exc
SOLAR VOLTAIC <b>0</b>	# Bedrooms <b>2</b>	3.Avg- Good 9.Same
OPEN-4- <b>0</b>	# Full Baths <b>1</b>	Phys. % Good <b>0%</b>
Year Built <b>2006</b>	# Half Baths <b>0</b>	Funct. % Good <b>100%</b>
Year Remodeled <b>0</b>	# Addn Fixtures <b>0</b>	Functional Code <b>9 None</b>
Foundation <b>1 Concrete</b>	# Fireplaces <b>0</b>	1.Incomp 4.Delap 5.Layoff
1.Concrete 4.Wood 7.		2.O-Built 5.Bsmt 6.Long term
2.C Block 5.Slab 8.		3.Damage 6.Style 9.None
3.Br/Stone 6.Piers 9.		Econ. % Good <b>100%</b>
Basement <b>4 Full Basement</b>		Economic Code <b>None</b>
1.1/4 Bmt 4.Full Bmt 7.		0.None 3.No Power 6.Obsolete
2.1/2 Bmt 5.Crwl 8.		1.Location 4.Generate 9.None
3.3/4 Bmt 6. 9.None		2.Encroach 5.Flood Pl 9.
Bsmt Gar # Cars <b>0</b>		Entrance Code <b>1 Interior Inspect</b>
Wet Basement <b>1 Dry Basement</b>		1.Interior 4.Vacant 7.
1.Dry 4. 7.		2.Refusal 5.Estimate 8.
2.Damp 5. 8.		3.Informed 6. 9.
3.Wet 6. 9.		Information Code <b>1 Owner</b>
		1.Owner 4.Agent 7.
		2.Relative 5.Estimate 8.
		3.Tenant 6.Other 9.

Date Inspected 8/14/2015

Additions, Outbuildings & Improvements

Type	Year	Units	Grade	Cond	Phys.	Funct.	Sound Value
14 1.5	0	286	0 0	0	0 %	100 %	
68 Wood Deck	0	72	0 0	0	0 %	100 %	
24 Frame Shed	2000	89	2 100	3	0 %	100 %	
					%	%	
					%	%	
					%	%	
					%	%	
					%	%	
					%	%	
					%	%	
					%	%	

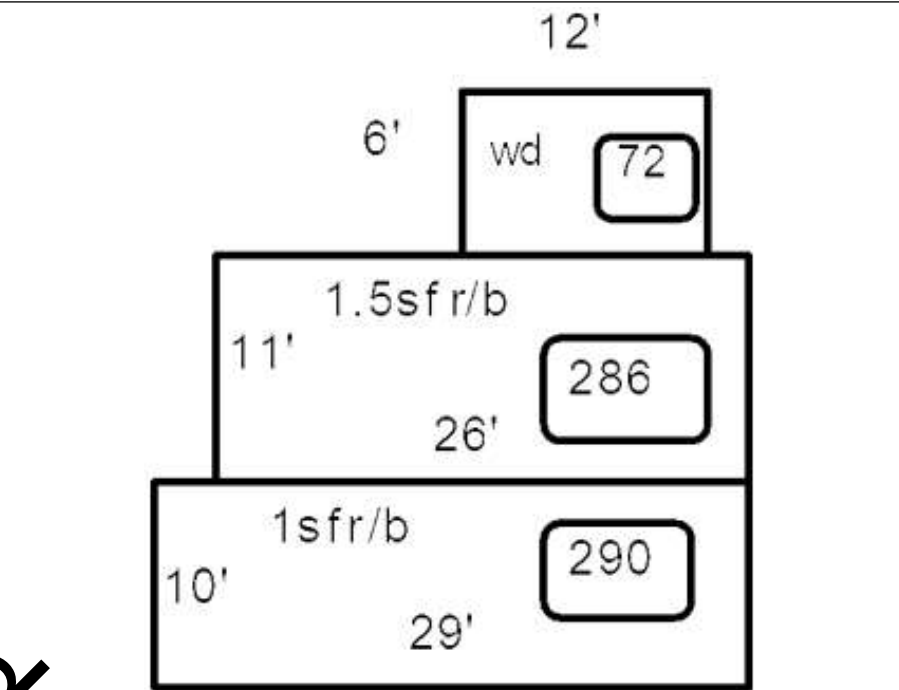

Proposed

Unfiled