

HARNOIS FAMILY TRUST  
16 EVERGREEN ROAD  
RAYMOND ME 040701

B39978P298

Previous Owner  
HARNOIS FAMILY TRUST  
HARNOIS, STEVEN GEORGE & BELANGER-HARNOIS, NANCY -  
1226 FAIRWAY GREENS DRIVE  
SUN CITY CENTER FL 33573  
Sale Date: 2/08/2023

Previous Owner  
HARNOIS, BRADFORD M - 50%  
HARNOIS - TRUSTEES, STEVEN GEORGE & NANCY BELANGER  
1226 FAIRWAY GREENS DRIVE  
SUN CITY CTR FL 33573  
Sale Date: 8/30/2021

Inspection Witnessed By:

X	Date	Date Insp.
No./Date	Description	Date Insp.

Notes:  
 B39978P298 - 2/8/2023 - Owners are: Steven George Harnois & Nancy Belanger Harnois as Co-Trustees of the Harnois Family Trust dated 12/17/2019  
 B39978P272 - 2/8/2023 - Owners are: Steven George Harnois and Nancy Belanger Harnois as Joint Tenants.  
 B38601P291 - 8/30/2021 - Owners are: Steven George Harnois and Nancy Belanger Harnois as Co-Trustees of the Harnois Family Trust dated 12/17/2019.  
 B36512P180 - 3/17/2020 - Owners are: Bradford M. Harnois Gray and Steven George Harnois & Nancy Belanger Harnois as Co-Trustees of the Harnois Family Trust dated 12/17/2019

Property Data			Assessment Record					
Neighborhood	5 Little Sebago		Year	Land	Buildings	Exempt	Total	
Tree Growth Year	0		2011	152,250	45,655	0	197,905	
REVIEW	0		2012	152,250	45,655	0	197,905	
Building Permit	0		2013	152,250	45,655	0	197,905	
Zone/Land Use	12 Limited Residential		2014	152,250	45,655	0	197,905	
Secondary Zone			2015	152,300	45,700	0	198,000	
Topography	1 Level		2016	152,300	45,700	0	198,000	
1. Above St	4. Below St	7.	2017	152,300	45,700	0	198,000	
2. Rolling	5. Low	8.	2018	152,300	45,700	0	198,000	
3. Above St	6. Swampy	9.	2019	235,400	73,500	0	308,900	
Utilities	6 Electric System 8 Lake Water		2020	235,400	73,500	0	308,900	
1. Public	4. Dr. Well/Po	7. Cesspool	2021	235,400	73,500	0	308,900	
2. Water	5. Dug Well	8. Lake	2022	235,400	73,500	0	308,900	
3. Holding Ta	6. Septic	9. None	2023	235,400	87,400	0	322,800	
Street	1 Paved		Calc.	470,800	110,100	0	580,900	
1. Paved	4. Proposed	8.	Land Data					
2. Semi Imp	5. R/O/W	9.	Front Foot	Type	Effective	Influence	Influence	
3. Gravel	6.	9. None	11. Water (0-200)	11	Frontage	Depth	Factor	Code
GIS Map	32		12. Water (201-400)	095	000	100	%	0
Field Review	50		13. Water (401-800)				%	
Sale Data			14. Water (801-160)				%	
Sale Date	2/08/2023		15. Water (161-320)				%	
Price			16. Water (3201-6400)				%	
Sale Type	2 Land & Buildings		17. Water SF Amenities				%	
1. Land	4. Mobile	7.COM	18. Water View				%	
2. L & B	5. Other	8.	19. Water Influenc				%	
3. Building	6. Condo	9.	20. ShoreFront A				%	
Financing	9 Unknown		Square Foot		Square Feet			
1. Convent	4. Seller	7.	16. Water ( 3201-6400)				%	
2. FHA/VA	5. Private	8.	17. Water SF Amenities				%	
3. Assumed	6. Cash	9.Unknown	18. Water View				%	
Validity	2 Related Parties		19. Water Influenc				%	
1. Valid	4. Split	7. Multiple	20. ShoreFront A				%	
2. Related	5. Partial	8. Other	Fract. Acre		Acreage/Sites			
3. Distress	6. Exempt	9. Estate	21. Base Lot	20	0.24	100	%	0
Verified	5 Public Record		22. Base Lot Vacant				%	
1. Buyer	4. Agent	7. Family	23. Base Lot Unpaved				%	
2. Seller	5. Pub Rec	8. Other	Acres				%	
3. Lender	6. MLS	9.	24. Acres to 10				%	
			25. Acres 11-30				%	
			26. Acres 31-50				%	
			27. Acres 51& over				%	
			28. Acres 71 & Over				%	
			29. Woods (41+)				%	
			Total Acreage		0.24			

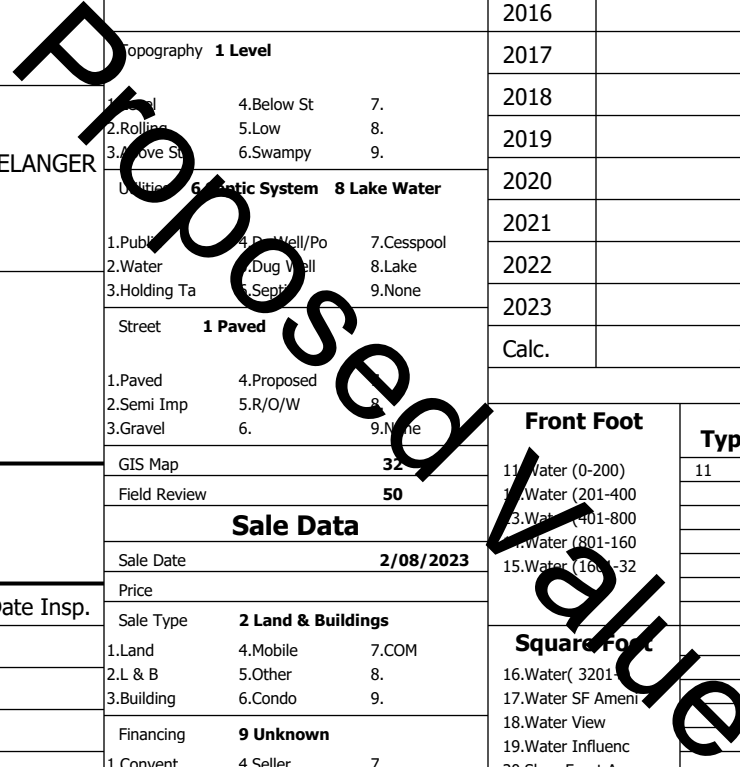

Type	Effective	Influence	Influence			
	Frontage	Depth	Factor	Code		
11	095	000	100	%	0	1. Unimproved
				%		2. Excess Frtg
				%		3. Topography
				%		4. Size/Shape
				%		5. Access
				%		6. Restriction
				%		7. Open Space
				%		8. Environmental
				%		9. Condo
				%		Acres
				%		30. Blueberry(1-20
				%		31. Blueberry(21 -
				%		32. Crop Land
				%		33. Pasture
				%		34. Shorefront B
				%		35. Shorefront C
				%		36. ANTENNA SITE
				%		37. Softwood TG
				%		38. Mixed Wood TG
				%		39. Hardwood TG
				%		40. Wasteland
				%		41. Woodland
				%		42. Mobile Home Si
				%		43. Camp Site
				%		44. Lot Improvemen
				%		45. BA SF - Oce
				%		46. SP Meadow Cond

