

ROGERS, CYNTHIA
 PO BOX 185
 GRAY ME 04039

B25475P98 B37964P116 B37964P116 B38030P101

Previous Owner
 DURGIN, DAVID, CARLENE & GEORGE
 ROGERS, CYNTHIA
 PO BOX 185
 GRAY ME 04039
 Sale Date: 5/20/2021

Property Data			Assessment Record				
Neighborhood	5 Little Sebago		Year	Land	Buildings	Exempt	Total
Tree Growth Year	0		2011	18,562	0	0	18,562
REVIEW	0		2012	18,562	0	0	18,562
Building Permit	0		2013	18,562	0	0	18,562
Zone/Land Use	12 Limited Residential		2014	18,562	0	0	18,562
Secondary Zone			2015	18,600	0	0	18,600
Topography	2 Rolling		2016	18,600	0	0	18,600
			2017	18,600	0	0	18,600
			2018	18,600	0	0	18,600
			2019	58,300	0	0	58,300
			2020	58,300	0	0	58,300
			2021	58,300	0	0	58,300
			2022	58,300	0	0	58,300
			2023	58,300	0	0	58,300
			Calc.	1,100	0	0	1,100

- 1. Above St
- 2. Rolling
- 3. Above St
- 4. Below St
- 5. Low
- 6. Swampy
- 7.
- 8.
- 9.

- 1. Public
- 2. Water
- 3. Holding Ta
- 4. Dug Well/Po
- 5. Septic
- 6. Cesspool
- 7. Lake
- 8. None
- 9. None

Inspection Witnessed By:		
X	Date	
No./Date	Description	Date Insp.

Notes:
 4/1/2023 - .25 acres enrolled in Tree Growth with contiguous lot 025-008-001-000

Gray

Land Data						
Type	Effective		Influence		Influence Codes	Acres
	Frontage	Depth	Factor	Code		
11. Water (0-200)			%		1. Unimproved	
12. Water (201-400)			%		2. Excess Frtg	
13. Water (401-800)			%		3. Topography	
14. Water (801-1600)			%		4. Size/Shape	
15. Water (1600-3200)			%		5. Access	
			%		6. Restriction	
			%		7. Open Space	
			%		8. Environmental	
			%		9. Condo	
			%		30. Blueberry(1-20	
			%		31. Blueberry(21 -	
			%		32. Crop Land	
			%		33. Pasture	
			%		34. Shorefront B	
			%		35. Shorefront C	
			%		36. ANTENNA SITE	
			%		37. Softwood TG	
			%		38. Mixed Wood TG	
			%		39. Hardwood TG	
			%		40. Wasteland	
			%		41. Woodland	
			%		42. Mobile Home Si	
			%		43. Camp Site	
			%		44. Lot Improvemen	
			%		45. BA SF - Oce	
			%		46. SP Meadow Cond	
Total Acreage			0.25			

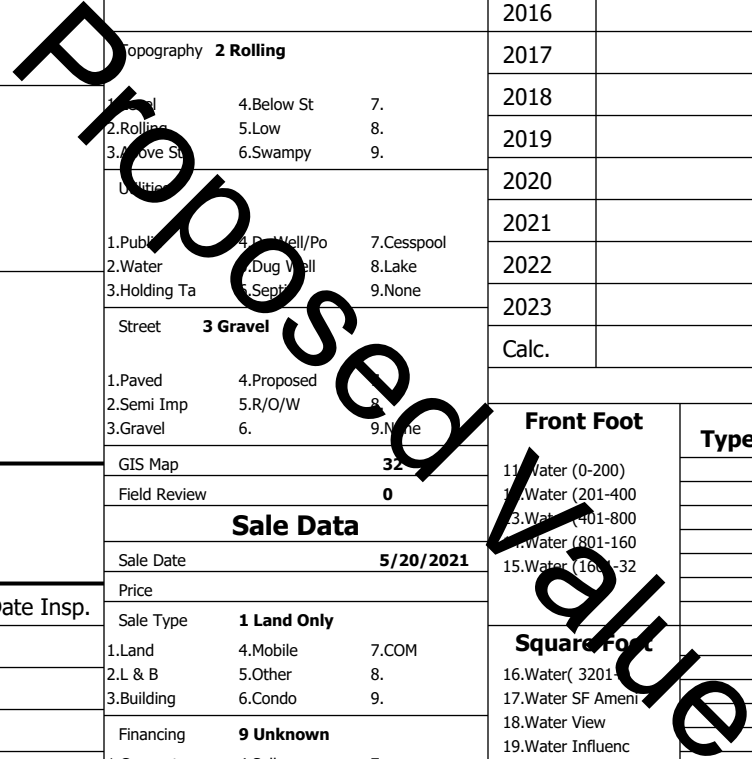

Gray

Map Lot 032-305-011-001

Account 3643

Location GRAPE ISLAND TR

Card 1

Of 1

8/05/2024

Building Style 0	SF Bsmt Living 0	Layout 0
1.Conv. 5.Garrison 9.NE farm	Fin Bsmt Grade 0 0	1.Typical 4. 7.
2.Ranch 6.Split 10.Colonia	Secondary Heat 0	2.Inadeq 5. 8.
3.R Ranch/ 7.Contemp 11.Cottage	Heat Type 100% 0	3. 6. 9.
4.Cape 8.Log 12.Gambrel	1.HWBB 5.FWA 9.None	Attic 0
Dwelling Units 0	2.HWCI 6.Monitor 10.UNH2F	1.1/4 Fin 4.Full Fin 7.
Other Units 0	3.HWRF 7.Electric 11.Geother	2.1/2 Fin 5.FI/Stair 8.
Stories 0	4.Steam 8.FI/Wall 12.Heat/Co	3.3/4 Fin 6. 9.None
1.1 4.1.5 7.	Cool Type 0% 9 None	Insulation 0
2.2 5.1.75 8.	1.Central 4.W&C Air 7.	1.Full 4.Minimal 7.
3.3 6.2.5 9.	2.Evapor 5. 8.	2.Heavy 5. 8.
Exterior Walls 0	3.H Pump 6. 9.None	3.Capped 6. 9.None
1.Clapboar 5.Stucco 9.B & B	Kitchen Style 0	Unfinished % 0%
2.Vin/Al 6.Brick 10.Cemplan	1.Modern 4.Obsolete	Grade & Factor 0 0%
3.Compos./ 7.Stone 11.Concret	2.Typical 5. 8.	1.E Grade 4.B Grade 7.SC Grade
4.Asbestos 8.Wood Shi 12.Wood Bo	3.Old Type 6. 9.None	2.C Grade 5.A Grade 8.
Roof Surface 0	Bath(s) Style 0	3.D Grade 6.AA Grade 9.Same
1.Asphalt 4.Composit 7.Other	1.Modern 4.Obsolete 7.	SQFT (Footprint) 0
2.Slate 5.Wood 8.	2.Typical 5. 8.	1.Poor Avg 7.V G
3.Metal 6.Roll Roo 9.	3.Old Type 6. 9.None	2.Fair Avg 8.Exc
SF Masonry Trim 0	# Rooms 0	3.Avg- Good 9.Same
SOLAR VOLTAIC 0	# Bedrooms 0	Phys. % Good 0%
OPEN-4- 0	# Full Baths 0	Funct. % Good 0%
Year Built 0	# Half Baths 0	Functional Code 9 None
Year Remodeled 0	# Addn Fixtures 0	1.Incomp 4.Delap 7.Layoff
Foundation 0	# Fireplaces 0	2.O-Built 5.Bsmt 8.Long term
1.Concrete 4.Wood 7.		3.Damage 6.Style None
2.C Block 5.Slab 8.		Econ. % Good 100%
3.Br/Stone 6.Piers 9.		Economic Code None
Basement 0		0.None 3.No Power 6.Obsolete
1.1/4 Bmt 4.Full Bmt 7.		1.Location 4.Generate 9.None
2.1/2 Bmt 5.Crwl 8.		2.Encroach 5.Flood Pl 9.
3.3/4 Bmt 6. 9.None		Entrance Code 0
Bsmt Gar # Cars 0		1.Interior 4.Vacant 7.
Wet Basement 0		2.Refusal 5.Estimate 8.
1.Dry 4. 7.		3.Informed 6. 9.
2.Damp 5. 8.		Information Code 0
3.Wet 6. 9.		1.Owner 4.Agent 7.
		2.Relative 5.Estimate 8.
		3.Tenant 6.Other 9.



Date Inspected 8/25/2015

Additions, Outbuildings & Improvements

Type	Year	Units	Grade	Cond	Phys.	Funct.	Sound Value
					%	%	1.One Story Fram
					%	%	2.Two Story Fram
					%	%	3.Three Story Fr
					%	%	4.1 & 1/2 Story
					%	%	5.1 & 3/4 Story
					%	%	6.2 & 1/2 Story
					%	%	21.Open Frame Por
					%	%	22.Encl Frame Por
					%	%	23.Frame Garage
					%	%	24.Frame Shed
					%	%	25.Frame Bay Wind
					%	%	26.1SFr Overhang
					%	%	27.Unfin Basement
					%	%	28.Unfinished Att
					%	%	29.Finished Attic

Proposed Value