

BOUCHER, BRIAN R
BOUCHER, SUSAN M
42 QUALEY ROAD
GRAY ME 04039

B23057P238

Property Data		
Neighborhood	5 Little Sebago	
Tree Growth Year	0	
REVIEW	0	
Building Permit	0	
Zone/Land Use	12 Limited Residential	
Secondary Zone		
Topography	4 Below Street 2 Rolling	
1. Hill	4. Below St	7.
2. Rolling	5. Low	8.
3. Above St	6. Swampy	9.
Utilities	4. Filled Well/Point 6 Septic System	
1. Public	4. Dug Well/Po	7. Cesspool
2. Water	5. Dug Well	8. Lake
3. Holding Ta	6. Septic	9. None
Street	3 Gravel	
1. Paved	4. Proposed	8.
2. Semi Imp	5. R/O/W	9.
3. Gravel	6.	9. None
GIS Map	32	
Field Review	1	

Inspection Witnessed By:

X		Date
No./Date	Description	Date Insp.

Notes:

Gray

Assessment Record				
Year	Land	Buildings	Exempt	Total
2011	105,075	75,382	0	180,457
2012	105,075	75,382	0	180,457
2013	105,075	75,382	0	180,457
2014	105,075	75,382	0	180,457
2015	105,100	78,600	0	183,700
2016	105,100	78,600	0	183,700
2017	105,100	78,600	0	183,700
2018	105,100	78,600	0	183,700
2019	167,500	130,400	0	297,900
2020	167,500	130,400	0	297,900
2021	167,500	130,400	0	297,900
2022	167,500	130,400	25,000	272,900
2023	167,500	148,700	25,000	291,200
Calc.	335,100	215,500	25,000	525,600

Land Data						
Front Foot	Type	Effective		Influence		Influence Codes
		Frontage	Depth	Factor	Code	
11. Water (0-200)	11	050	000	100 %	0	1. Unimproved
12. Water (201-400)				%		2. Excess Frtg
13. Water (401-800)				%		3. Topography
14. Water (801-160)				%		4. Size/Shape
15. Water (1601-32)				%		5. Access
				%		6. Restriction
				%		7. Open Space
				%		8. Environmental
				%		9. Condo
Square Foot		Square Feet				Acres
16. Water (3201-)				%		30. Blueberry(1-20
17. Water SF Amen				%		31. Blueberry(21 -
18. Water View				%		32. Crop Land
19. Water Influen				%		33. Pasture
20. ShoreFront A				%		34. Shorefront B
				%		35. Shorefront C
				%		36. ANTENNA SITE
				%		37. Softwood TG
				%		38. Mixed Wood TG
				%		39. Hardwood TG
				%		40. Wasteland
				%		41. Woodland
				%		42. Mobile Home Si
				%		43. Camp Site
				%		44. Lot Improvemen
				%		45. BA SF - Oce
				%		46. SP Meadow Cond
Fract. Acre		Acreage/Sites				
21. Base Lot	20		0.23	100 %	0	
22. Base Lot Vacan				%		
23. Base Lot Unpav				%		
Acres						
24. Acres to 10				%		
25. Acres 11-30				%		
26. Acres 31-50				%		
27. Acres 51& over				%		
28. Acres 71 & Ove				%		
29. Woods (41+)				%		
Total Acreage		0.23				

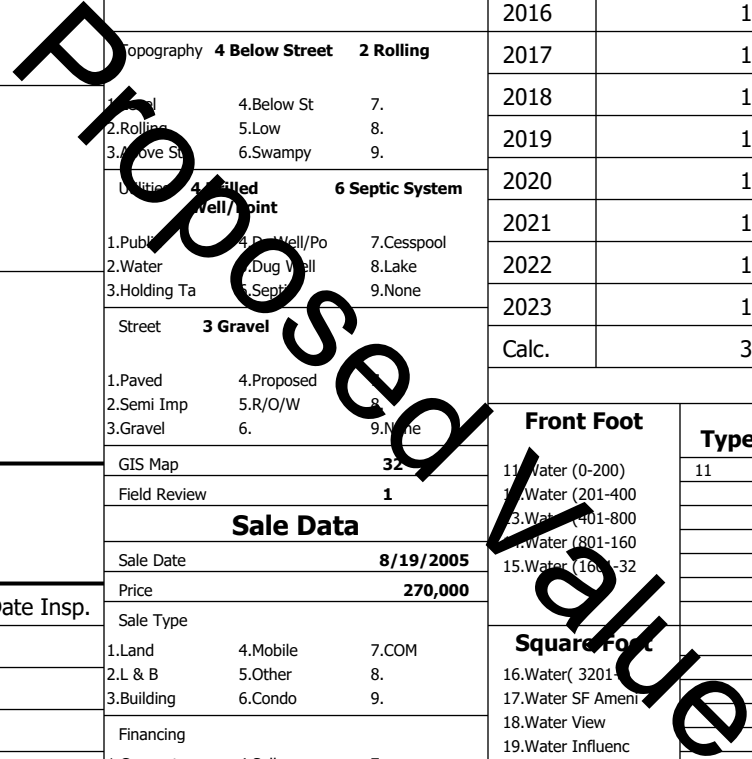

Gray

Map Lot 032-304-030-000

Account 3556

Location 42 QAULEY RD

Card 1

Of 1

8/05/2024

Building Style 1 Conventional	SF Bsmt Living 700	Layout 1 Typical
1.Conv. 5.Garrison 9.NE farm	Fin Bsmt Grade 3 100	1.Typical 4. 7.
2.Ranch 6.Split 10.Colonia	Secondary Heat 0	2.Inadeq 5. 8.
3.R Ranch/ 7.Contemp 11.Cottage	Heat Type 100% 5 Forced Warm Air	3. 6. 9.
4.Cape 8.Log 12.Gambrel	1.HWBB 5.FWA 9.None	Attic 9 None
Dwelling Units 1	2.HWCI 6.Monitor 10.UNH2F	1.1/4 Fin 4.Full Fin 7.
Other Units 0	3.HWRF 7.Electric 11.Geother	2.1/2 Fin 5.FI/Stair 8.
Stories 1 One Story	4.Steam 8.FI/Wall 12.Heat/Co	3.3/4 Fin 6. 9.None
1.1 4.1.5 7.	Cool Type 0% 9 None	Insulation 1 Full
2.2 5.1.75 8.	1.Central 4.W&C Air 7.	1.Full 4.Minimal 7.
3.3 6.2.5 9.	2.Evapor 5. 8.	2.Heavy 5. 8.
Exterior Walls 2 Vinyl/Aluminum	3.H Pump 6. 9.None	3.Capped 6. 9.None
1.Clapboard 5.Stucco 9.B & B	Kitchen Style 2 Typical	Unfinished % 0%
2.Vin/Al 6.Brick 10.Cemplan	1.Modern 4.Obsolete	Grade & Factor 3 Average 110%
3.Compos./ 7.Stone 11.Concret	2.Typical 5. 8.	1.E Grade 4.B Grade 7.SC Grade
4.Asbestos 8.Wood Shi 12.Wood Bo	3.Old Type 6. 9.None	2.D Grade 5.A Grade 8.
Roof Surface 1 Asphalt Shingles	Bath(s) Style 2 Typical Bath(s)	3.C Grade 6.AA Grade 9.Same
1.Asphalt 4.Composit 7.Other	1.Modern 4.Obsolete 7.	SQFT (Footprint) 720
2.Slate 5.Wood 8.	2.Typical 5. 8.	Condition 5 Good
3.Metal 6.Roll Roo 9.	3.Old Type 6. 9.None	1.Poor Avg 7.V G
SF Masonry Trim 0	# Rooms 4	2.Fair Avg 8.Exc
SOLAR VOLTAIC 0	# Bedrooms 2	3.Avg- Good 9.Same
OPEN-4- 0	# Full Baths 1	Phys. % Good 0%
Year Built 1957	# Half Baths 1	Funct. % Good 100%
Year Remodeled 2009	# Addn Fixtures 0	Functional Code 9 None
Foundation 1 Concrete	# Fireplaces 0	1.Incomp 4.Delap 7.Playo
1.Concrete 4.Wood 7.		2.O-Built 5.Bsmt 8.Long term
2.C Block 5.Slab 8.		3.Damage 6.Style 9.None
3.Br/Stone 6.Piers 9.		Econ. % Good 100%
Basement 4 Full Basement		Economic Code None
1.1/4 Bmt 4.Full Bmt 7.		0.None 3.No Power 6.Obsolete
2.1/2 Bmt 5.Crw 8.		1.Location 4.Generate 9.None
3.3/4 Bmt 6. 9.None		2.Encroach 5.Flood Pl 9.
Bsmt Gar # Cars 0		Entrance Code 5 Estimated
Wet Basement 1 Dry Basement		1.Interior 4.Vacant 7.
1.Dry 4. 7.		2.Refusal 5.Estimate 8.
2.Damp 5. 8.		3.Informed 6. 9.
3.Wet 6. 9.		Information Code 5 Estimate
		1.Owner 4.Agent 7.
		2.Relative 5.Estimate 8.
		3.Tenant 6.Other 9.

Date Inspected 8/20/2015

Additions, Outbuildings & Improvements

Type	Year	Units	Grade	Cond	Phys.	Funct.	Sound Value
11 1 Story/Basement	2009	90	3 110	4	0 %	100 %	
68 Wood Deck	2014	145	0 0	0	0 %	100 %	
1 One Story Frame	2014	171	0 0	0	0 %	100 %	
21 Open Frame	2014	171	0 0	0	0 %	100 %	
23 Frame Garage	2014	240	3 100	4	0 %	100 %	
27 Unfin Basement	2014	240	3 100	4	0 %	100 %	
					%	%	
					%	%	
					%	%	
					%	%	
					%	%	

