

DRIESCH, EDWARD A
DRIESCH, KAREN S
82 EAGER ROAD
NORTH FRANKLIN CT 06254

B6617P39

Property Data			Assessment Record						
Neighborhood 5 Little Sebago			Year	Land	Buildings	Exempt	Total		
Tree Growth Year 0			2011	37,100	80,036	0	117,136		
REVIEW 0			2012	37,100	80,036	0	117,136		
Building Permit 0			2013	37,100	80,036	0	117,136		
Zone/Land Use 12 Limited Residential			2014	37,100	90,510	0	127,610		
Secondary Zone 23 Lake District			2015	37,100	92,500	0	129,600		
Topography 2 Rolling			2016	37,100	92,500	0	129,600		
1. Hill 4. Below St 7.			2017	37,100	92,500	0	129,600		
2. Rolling 5. Low 8.			2018	37,100	92,500	0	129,600		
3. Above St 6. Swampy 9.			2019	93,900	161,100	0	255,000		
Utilities 4 Filled Well/Point 6 Septic System			2020	93,900	161,100	0	255,000		
1. Public 4. Dug Well/Po 7. Cesspool			2021	93,900	161,100	0	255,000		
2. Water 5. Dug Well 8. Lake			2022	93,900	161,100	0	255,000		
3. Holding Ta 6. Septic 9. None			2023	93,900	194,200	0	288,100		
Street 3 Gravel			Calc.	290,900	244,000	0	534,900		
1. Paved 4. Proposed			Land Data						
2. Semi Imp 5. R/O/W			Front Foot	Type	Effective		Influence		Influence Codes
3. Gravel 6. None 9. None					Frontage	Depth	Factor	Code	
GIS Map 32			11. Water (0-200)				%		1. Unimproved
Field Review 1			12. Water (201-400)				%		2. Excess Frtg
Sale Data			13. Water (401-800)				%		3. Topography
Sale Date			14. Water (801-160)				%		4. Size/Shape
Price			15. Water (161-32)				%		5. Access
Sale Type			Square Foot				%		6. Restriction
1. Land 4. Mobile 7. COM			Square Feet				%		7. Open Space
2. L & B 5. Other 8.			16. Water (3201-				%		8. Environmental
3. Building 6. Condo 9.			17. Water SF Amen				%		9. Condo
Financing			18. Water View				%		Acres
1. Convent 4. Seller 7.			19. Water Influen				%		30. Blueberry(1-20
2. FHA/VA 5. Private 8.			20. ShoreFront A				%		31. Blueberry(21 -
3. Assumed 6. Cash 9. Unknown			Fract. Acre				%		32. Crop Land
Validity			21. Base Lot	23	0.65	120	%	8	33. Pasture
1. Valid 4. Split 7. Multiple			22. Base Lot Vacan	17	1.00	100	%	0	34. Shorefront B
2. Related 5. Partial 8. Other			23. Base Lot Unpav				%		35. Shorefront C
3. Distress 6. Exempt 9. Estate			Acres				%		36. ANTENNA SITE
Verified			24. Acres to 10				%		37. Softwood TG
1. Buyer 4. Agent 7. Family			25. Acres 11-30				%		38. Mixed Wood TG
2. Seller 5. Pub Rec 8. Other			26. Acres 31-50				%		39. Hardwood TG
3. Lender 6. MLS 9.			27. Acres 51& over				%		40. Wasteland
			28. Acres 71 & Ove				%		41. Woodland
			29. Woods (41+)				%		42. Mobile Home Si
			Total Acreage 0.65						43. Camp Site
									44. Lot Improvemen
									45. BA SF - Oce
									46. SP Meadow Cond

Inspection Witnessed By:

No./Date	Description	Date Insp.
X		

Notes:

Gray

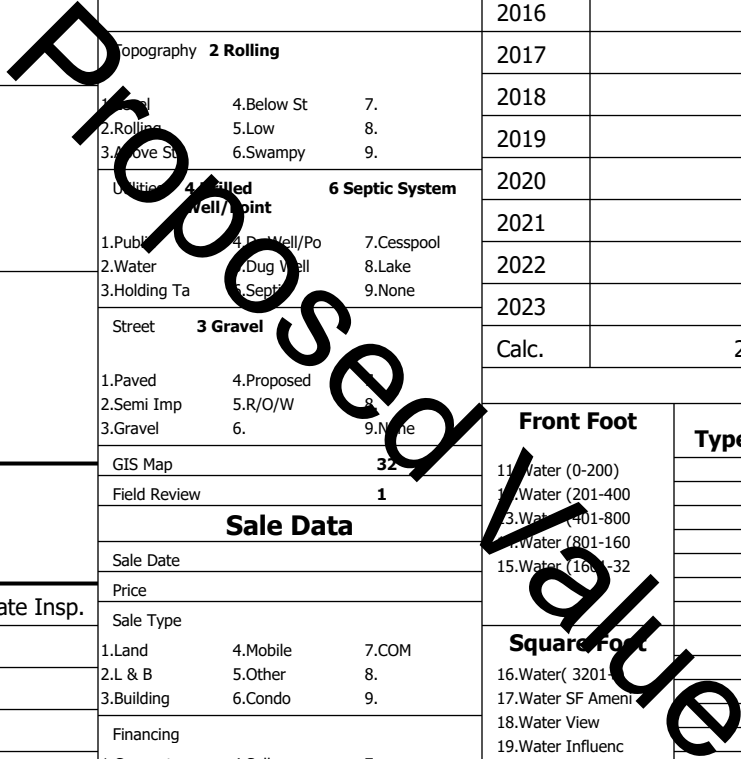

Gray

Map Lot 032-304-004-000

Account 3531

Location 29 QAULEY RD

Card 1

Of 1

8/05/2024

Building Style 1 Conventional	SF Bsmt Living 0	Layout 1 Typical
1.Conv. 5.Garrison 9.NE farm	Fin Bsmt Grade 0 0	1.Typical 4. 7.
2.Ranch 6.Split 10.Colonia	Secondary Heat 0	2.Inadeq 5. 8.
3.R Ranch/ 7.Contemp 11.Cottage	Heat Type 100% 6 Monitor	3. 6. 9.
4.Cape 8.Log 12.Gambrel	1.HWBB 5.FWA 9.None	Attic 2 1/2 Finished
Dwelling Units 1	2.HWCI 6.Monitor 10.UNH2F	1.1/4 Fin 4.Full Fin 7.
Other Units 0	3.HWRF 7.Electric 11.Geother	2.1/2 Fin 5.F/Stair 8.
Stories 2 Two Story	4.Steam 8.F/Wall 12.Heat/Co	3.3/4 Fin 6. 9.None
1.1 4.1.5 7.	Cool Type 0% 9 None	Insulation 1 Full
2.2 5.1.75 8.	1.Central 4.W&C Air 7.	1.Full 4.Minimal 7.
3.3 6.2.5 9.	2.Evapor 5. 8.	2.Heavy 5. 8.
Exterior Walls 8 Wood Shingle	3.H Pump 6. 9.None	3.Capped 6. 9.None
1.Clapboard 5.Stucco 9.B & B	Kitchen Style 2 Typical	Unfinished % 0%
2.Vin/Al 6.Brick 10.Cemplan	1.Modern 4.Obsolete	Grade & Factor 3 Average 110%
3.Compos./ 7.Stone 11.Concret	2.Typical 5. 8.	1.E Grade 4.B Grade 7.SC Grade
4.Asbestos 8.Wood Shi 12.Wood Bo	3.Old Type 6. 9.None	2.D Grade 5.A Grade 8.
Roof Surface 3 Metal	Bath(s) Style 2 Typical Bath(s)	3.C Grade 6.AA Grade 9.Same
1.Asphalt 4.Composit 7.Other	1.Modern 4.Obsolete 7.	SQFT (Footprint) 324
2.Slate 5.Wood 8.	2.Typical 5. 8.	Foundation 5 Good
3.Metal 6.Roll Roo 9.	3.Old Type 6. 9.None	1.Poor 2.Avg 7.V G
SF Masonry Trim 0	# Rooms 4	2.Fair 3.Good 8.Exc
SOLAR VOLTAIC 0	# Bedrooms 2	3.Avg- 9.Same
OPEN-4- 0	# Full Baths 2	Phys. % Good 0%
Year Built 1985	# Half Baths 0	Funct. % Good 100%
Year Remodeled 0	# Addn Fixtures 0	Functional Code 9 None
Foundation 2 Concrete Block	# Fireplaces 0	1.Incomp 4.Delap 9.No Layo
1.Concrete 4.Wood 7.		2.O-Built 5.Bsmt 8.Long term
2.C Block 5.Slab 8.		3.Damage 6.Style 9.None
3.Br/Stone 6.Piers 9.		Econ. % Good 100%
Basement 5 Crawl Space		Economic Code None
1.1/4 Bmt 4.Full Bmt 7.		0.None 3.No Power 6.Obsolete
2.1/2 Bmt 5.Crwl 8.		1.Location 4.Generate 9.None
3.3/4 Bmt 6. 9.None		2.Encroach 5.Flood Pl 9.
Bsmt Gar # Cars 0		Entrance Code 5 Estimated
Wet Basement 9 No Basement		1.Interior 4.Vacant 7.
1.Dry 4. 7.		2.Refusal 5.Estimate 8.
2.Damp 5. 8.	3.Informed 6. 9.	
3.Wet 6. 9.	Information Code 5 Estimate	
	1.Owner 4.Agent 7.	
	2.Relative 5.Estimate 8.	
	3.Tenant 6.Other 9.	

Date Inspected 8/19/2015

Additions, Outbuildings & Improvements

Type	Year	Units	Grade	Cond	Phys.	Funct.	Sound Value
1 One Story Frame	2003	320	3 110	4	0	% 100 %	1.One Story Fram
1 One Story Frame	0	108	0 0	0	0	% 100 %	2.Two Story Fram
21 Open Frame	0	144	0 0	0	0	% 100 %	3.Three Story Fr
43 2S Frame Garage	2013	300	3 110	4	0	% 100 %	4.1 & 1/2 Story
24 Frame Shed	0	128	2 100	4	0	% 100 %	5.1 & 3/4 Story
						% %	6.2 & 1/2 Story
						% %	21.Open Frame Por
						% %	22.Encl Frame Por
						% %	23.Frame Garage
						% %	24.Frame Shed
						% %	25.Frame Bay Wind
						% %	26.1SFr Overhang
						% %	27.Unfin Basement
						% %	28.Unfinished Att
						% %	29.Finished Attic

