

OCTOBER CORPORATION
C/O BOULOS ASSET MANAGEMENT
100 MIDDLE STREET
PORTLAND ME 04101

B23479P50

Property Data			Assessment Record				
Neighborhood	82 Average Location		Year	Land	Buildings	Exempt	Total
Tree Growth Year	0		2011	50,120	0	0	50,120
REVIEW	0		2012	50,120	0	0	50,120
Building Permit	0		2013	50,120	0	0	50,120
Zone/Land Use	11 Rural Residential & Agri		2014	50,120	0	0	50,120
Secondary Zone			2015	50,100	0	0	50,100
Topography	1 Level		2016	50,100	0	0	50,100
1. Hill	4. Below St	7.	2017	50,100	0	0	50,100
2. Rolling	5. Low	8.	2018	50,100	0	0	50,100
3. Above St	6. Swampy	9.	2019	77,000	0	0	77,000
Utilities			2020	77,000	0	0	77,000
1. Public	4. Dr. Well/Po	7. Cesspool	2021	77,000	0	0	77,000
2. Water	5. Dug Well	8. Lake	2022	77,000	0	0	77,000
3. Holding Ta	6. Septic	9. None	2023	81,500	0	0	81,500
Street	1 Paved		Calc.	189,000	0	0	189,000
1. Paved	4. Proposed	8.					
2. Semi Imp	5. R/O/W	9.					
3. Gravel	6. None						

Inspection Witnessed By:

X	Date	Date Insp.
No./Date	Description	Date Insp.

Notes:
5/24 DR FIELD REVIEW

Gray

Sale Data		
GIS Map	29	
Field Review	1	
Sale Date	12/07/2005	
Price	400,000	
Sale Type		
1. Land	4. Mobile	7. COM
2. L & B	5. Other	8.
3. Building	6. Condo	9.
Financing		
1. Convent	4. Seller	7.
2. FHA/VA	5. Private	8.
3. Assumed	6. Cash	9. Unknown
Validity		
1. Valid	4. Split	7. Multiple
2. Related	5. Partial	8. Other
3. Distress	6. Exempt	9. Estate
Verified		
1. Buyer	4. Agent	7. Family
2. Seller	5. Pub Rec	8. Other
3. Lender	6. MLS	9.

Land Data					
Type	Effective		Influence		Influence Codes
	Frontage	Depth	Factor	Code	
11. Water (0-200)			%		1. Unimproved
12. Water (201-400)			%		2. Excess Frtg
13. Water (401-800)			%		3. Topography
14. Water (801-160)			%		4. Size/Shape
15. Water (1601-32)			%		5. Access
			%		6. Restriction
			%		7. Open Space
			%		8. Environmental
			%		9. Condo
			%		30. Blueberry(1-20
			%		31. Blueberry(21 -
			%		32. Crop Land
			%		33. Pasture
			%		34. Shorefront B
			%		35. Shorefront C
			%		36. ANTENNA SITE
			%		37. Softwood TG
			%		38. Mixed Wood TG
			%		39. Hardwood TG
			%		40. Wasteland
			%		41. Woodland
			%		42. Mobile Home Si
			%		43. Camp Site
			%		44. Lot Improvemen
			%		45. BA SF - Oce
			%		46. SP Meadow Cond
Total Acreage			17.12		

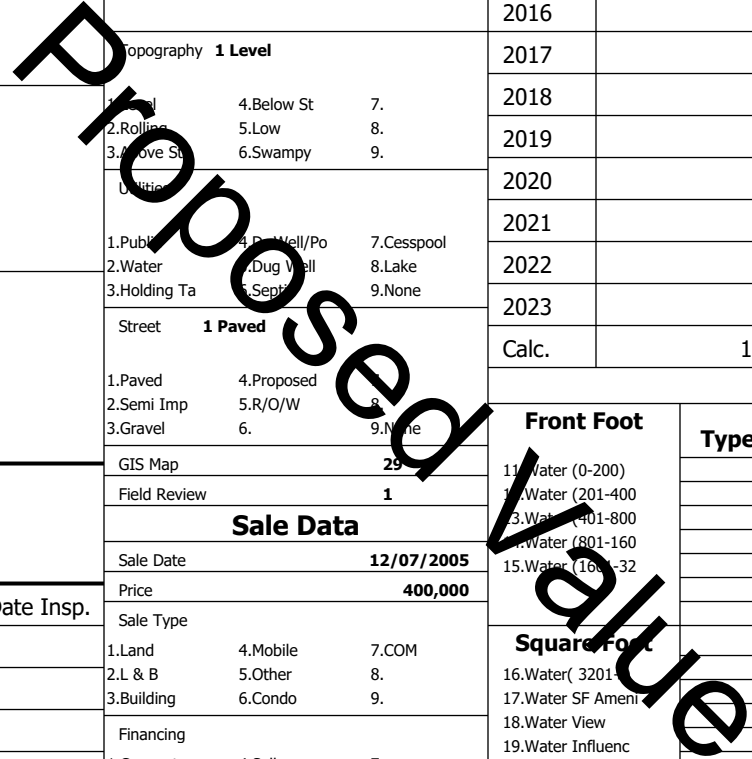

Building Style 0	SF Bsmt Living 0	Layout 0
1.Conv. 5.Garrison 9.NE farm	Fin Bsmt Grade 0 0	1.Typical 4. 7.
2.Ranch 6.Split 10.Colonia	Secondary Heat 0	2.Inadeq 5. 8.
3.R Ranch/ 7.Contemp 11.Cottage	Heat Type 100% 0	3. 6. 9.
4.Cape 8.Log 12.Gambrel	1.HWBB 5.FWA 9.None	Attic 0
Dwelling Units 0	2.HWCI 6.Monitor 10.UNH2F	1.1/4 Fin 4.Full Fin 7.
Other Units 0	3.HWRF 7.Electric 11.Geother	2.1/2 Fin 5.FI/Stair 8.
Stories 0	4.Steam 8.FI/Wall 12.Heat/Co	3.3/4 Fin 6. 9.None
1.1 4.1.5 7.	Cool Type 0% 9 None	Insulation 0
2.2 5.1.75 8.	1.Central 4.W&C Air 7.	1.Full 4.Minimal 7.
3.3 6.2.5 9.	2.Evapor 5. 8.	2.Heavy 5. 8.
Exterior Walls 0	3.H Pump 6. 9.None	3.Capped 6. 9.None
1.Clapboar 5.Stucco 9.B & B	Kitchen Style 0	Unfinished % 0%
2.Vin/Al 6.Brick 10.Cemplan	1.Modern 4.Obsolete	Grade & Factor 0 0%
3.Compos./ 7.Stone 11.Concret	2.Typical 5. 8.	1.E Grade 4.B Grade 7.SC Grade
4.Asbestos 8.Wood Shi 12.Wood Bo	3.Old Type 6. 9.None	2.C Grade 5.A Grade 8.
Roof Surface 0	Bath(s) Style 0	3.D Grade 6.AA Grade 9.Same
1.Asphalt 4.Composit 7.Other	1.Modern 4.Obsolete 7.	SQFT (Footprint) 0
2.Slate 5.Wood 8.	2.Typical 5. 8.	1.Poor Avg 7.V G
3.Metal 6.Roll Roo 9.	3.Old Type 6. 9.None	2.Fair Avg 8.Exc
SF Masonry Trim 0	# Rooms 0	3.Avg- Good 9.Same
SOLAR VOLTAIC 0	# Bedrooms 0	Phys. % Good 0%
OPEN-4- 0	# Full Baths 0	Funct. % Good 0%
Year Built 0	# Half Baths 0	Functional Code 9 None
Year Remodeled 0	# Addn Fixtures 0	1.Incomp 4.Delap 9.None
Foundation 0	# Fireplaces 0	2.O-Built 5.Bsmt 8.Long term
1.Concrete 4.Wood 7.		3.Damage 6.Style None
2.C Block 5.Slab 8.		Econ. % Good 100%
3.Br/Stone 6.Piers 9.		Economic Code None
Basement 0		0.None 3.No Power 6.Obsolete
1.1/4 Bmt 4.Full Bmt 7.		1.Location 4.Generate 9.None
2.1/2 Bmt 5.Crwl 8.		2.Encroach 5.Flood Pl 9.
3.3/4 Bmt 6. 9.None		Entrance Code 5 Estimated
Bsmt Gar # Cars 0		1.Interior 4.Vacant 7.
Wet Basement 0		2.Refusal 5.Estimate 8.
1.Dry 4. 7.		3.Informed 6. 9.
2.Damp 5. 8.		Information Code 5 Estimate
3.Wet 6. 9.		1.Owner 4.Agent 7.
		2.Relative 5.Estimate 8.
		3.Tenant 6.Other 9.



Date Inspected 5/15/2024

Additions, Outbuildings & Improvements							
Type	Year	Units	Grade	Cond	Phys.	Funct.	Sound Value
					%	%	1.One Story Fram
					%	%	2.Two Story Fram
					%	%	3.Three Story Fr
					%	%	4.1 & 1/2 Story
					%	%	5.1 & 3/4 Story
					%	%	6.2 & 1/2 Story
					%	%	21.Open Frame Por
					%	%	22.Encl Frame Por
					%	%	23.Frame Garage
					%	%	24.Frame Shed
					%	%	25.Frame Bay Wind
					%	%	26.1SFr Overhang
					%	%	27.Unfin Basement
					%	%	28.Unfinished Att
					%	%	29.Finished Attic

Proposed Value