

NILSSON, JAKE HAMILTON
 NILSSON, ELIZABETH PARKER
 179 MAYALL ROAD
 GRAY ME 04039

B35953P254

Previous Owner
 DEWAN, JANNA
 179 MAYALL

GRAY ME 04039
 Sale Date: 9/05/2019

Previous Owner
 SANBORN, JEFFREY D, HEIRS OF
 WINFIELD, PHYLLIS P/R
 114 EAST COMMONWEALTH DR
 PORTLAND ME 04103
 Sale Date: 5/20/2016

Inspection Witnessed By:

X Date

No./Date	Description	Date Insp.

Notes:
 5/24 DR FIELD REVIEW

Gray

Property Data		
Neighborhood	82 Average Location	
Tree Growth Year	0	
REVIEW	0	
Building Permit	0	
Zone/Land Use	11 Rural Residential & Agri	
Secondary Zone		
Topography	1 Level	
1. Well	4. Below St	7.
2. Rolling	5. Low	8.
3. Above St	6. Swampy	9.
Utilities	2 Public Water 6 Septic System	
1. Public	4. Drilled Well/Po	7. Cesspool
2. Water	5. Dug Well	8. Lake
3. Holding Ta	6. Septic	9. None
Street	1 Paved	
1. Paved	4. Proposed	8.
2. Semi Imp	5. R/O/W	9.
3. Gravel	6.	9. None
GIS Map	28	
Field Review	1	
Sale Data		
Sale Date	9/05/2019	
Price	215,000	
Sale Type	2 Land & Buildings	
1. Land	4. Mobile	7. COM
2. L & B	5. Other	8.
3. Building	6. Condo	9.
Financing	1 Conventional	
1. Convent	4. Seller	7.
2. FHA/VA	5. Private	8.
3. Assumed	6. Cash	9. Unknown
Validity	1 Arms Length Sale	
1. Valid	4. Split	7. Multiple
2. Related	5. Partial	8. Other
3. Distress	6. Exempt	9. Estate
Verified	5 Public Record	
1. Buyer	4. Agent	7. Family
2. Seller	5. Pub Rec	8. Other
3. Lender	6. MLS	9.

Assessment Record				
Year	Land	Buildings	Exempt	Total
2011	47,500	140,736	8,500	179,736
2012	47,500	140,736	8,500	179,736
2013	47,500	140,736	8,500	179,736
2014	47,500	140,736	8,500	179,736
2015	47,500	140,700	9,000	179,200
2016	47,500	140,700	9,000	179,200
2017	47,500	140,700	0	188,200
2018	47,500	140,700	0	188,200
2019	64,800	144,000	0	208,800
2020	64,800	144,000	0	208,800
2021	64,800	144,000	0	208,800
2022	64,800	144,000	0	208,800
2023	64,800	164,000	0	228,800
Calc.	129,000	241,000	0	370,000

Land Data					
Type	Effective		Influence		Influence Codes
	Frontage	Depth	Factor	Code	
1. Water (0-200)			%		1. Unimproved
2. Water (201-400)			%		2. Excess Frtg
3. Water (401-800)			%		3. Topography
4. Water (801-160)			%		4. Size/Shape
5. Water (1601-32)			%		5. Access
			%		6. Restriction
			%		7. Open Space
			%		8. Environmental
			%		9. Condo
Square Foot		Square Feet		Acres	
16. Water (3201-6400)			%		30. Blueberry(1-20
17. Water SF Amen			%		31. Blueberry(21 -
18. Water View			%		32. Crop Land
19. Water Influen			%		33. Pasture
20. ShoreFront A			%		34. Shorefront B
			%		35. Shorefront C
			%		36. ANTENNA SITE
21. Base Lot	1.84	100	%	0	37. Softwood TG
22. Base Lot Vacan	0.66	100	%	0	38. Mixed Wood TG
23. Base Lot Unpav			%		39. Hardwood TG
			%		40. Wasteland
			%		41. Woodland
			%		42. Mobile Home Si
			%		43. Camp Site
			%		44. Lot Improvemen
			%		45. BA SF - Oce
			%		46. SP Meadow Cond
Total Acreage		2.50			

Gray

Map Lot 028-034-008-000

Account 1979

Location 179 MAYALL RD

Card 1

Of 1

8/05/2024

Building Style 1 Conventional	SF Bsmt Living 0	Layout 1 Typical
1.Conv. 5.Garrison 9.NE farm	Fin Bsmt Grade 0 0	1.Typical 4. 7.
2.Ranch 6.Split 10.Colonia	Secondary Heat 2	2.Inadeq 5. 8.
3.R Ranch/ 7.Contemp 11.Cottage	Heat Type 100% 1 Hot Water BB	3. 6. 9.
4.Cape 8.Log 12.Gambrel	1.HWBB 5.FWA 9.None	Attic 9 None
Dwelling Units 1	2.HWCI 6.Monitor 10.UNH2F	1.1/4 Fin 4.Full Fin 7.
Other Units 0	3.HWRF 7.Electric 11.Geother	2.1/2 Fin 5.FI/Stair 8.
Stories 2 Two Story	4.Steam 8.FI/Wall 12.Heat/Co	3.3/4 Fin 6. 9.None
1.1 4.1.5 7.	Cool Type 0% 9 None	Insulation 1 Full
2.2 5.1.75 8.	1.Central 4.W&C Air 7.	1.Full 4.Minimal 7.
3.3 6.2.5 9.	2.Evapor 5. 8.	2.Heavy 5. 8.
Exterior Walls 2 Vinyl/Aluminum	3.H Pump 6. 9.None	3.Capped 6. 9.None
1.Clapboard 5.Stucco 9.B & B	Kitchen Style 2 Typical	Unfinished % 0%
2.Vin/Al 6.Brick 10.Cemplan	1.Modern 4.Obsolete	Grade & Factor 2 Fair 110%
3.Compos./ 7.Stone 11.Concret	2.Typical 5. 8.	1.E Grade 4.B Grade 7.SC Grade
4.Asbestos 8.Wood Shi 12.Wood Bo	3.Old Type 6. 9.None	2.C Grade 5.A Grade 8.
Roof Surface 1 Asphalt Shingles	Bath(s) Style 2 Typical Bath(s)	3.D Grade 6.AA Grade 9.Same
1.Asphalt 4.Composit 7.Other	1.Modern 4.Obsolete 7.	SQFT (Footprint) 648
2.Slate 5.Wood 8.	2.Typical 5. 8.	Condition 4 Average
3.Metal 6.Roll Roo 9.	3.Old Type 6. 9.None	1.Poor Avg 7.V G
SF Masonry Trim 0	# Rooms 6	2.Fair Avg 8.Exc
SOLAR VOLTAIC 0	# Bedrooms 3	3.Avg- Good 9.Same
OPEN-4- 0	# Full Baths 1	Phys. % Good 0%
Year Built 1920	# Half Baths 1	Funct. % Good 100%
Year Remodeled 1999	# Addn Fixtures 0	Functional Code 9 None
Foundation 3 Brick &/or Stone	# Fireplaces 0	1.Incomp 4.Delap 5.Layo
1.Concrete 4.Wood 7.		2.O-Built 5.Bsmt 8.Long term
2.C Block 5.Slab 8.		3.Damage 6.Style None
3.Br/Stone 6.Piers 9.		Econ. % Good 100%
Basement 4 Full Basement		Economic Code None
1.1/4 Bmt 4.Full Bmt 7.		0.None 3.No Power 6.Obsolete
2.1/2 Bmt 5.Crwl 8.		1.Location 4.Generate 9.None
3.3/4 Bmt 6. 9.None		2.Encroach 5.Flood Pl 9.
Bsmt Gar # Cars 0		Entrance Code 5 Estimated
Wet Basement 1 Dry Basement		1.Interior 4.Vacant 7.
1.Dry 4. 7.		2.Refusal 5.Estimate 8.
2.Damp 5. 8.		3.Informed 6. 9.
3.Wet 6. 9.		Information Code 5 Estimate
		1.Owner 4.Agent 7.
		2.Relative 5.Estimate 8.
		3.Tenant 6.Other 9.

Date Inspected 5/15/2024

Additions, Outbuildings & Improvements

Type	Year	Units	Grade	Cond	Phys.	Funct.	Sound Value
4 1 & 1/2 Story Fr	0	342	0 0	0	0	100 %	
68 Wood Deck	0	388	0 0	0	0	100 %	
22 Encl Frame Porch	1988	132	0 0	0	0	100 %	
23 Frame Garage	1993	864	3 100	4	0	100 %	
44 2S Frame Shed	1970	256	4 100	5	0	100 %	
24 Frame Shed	1970	240	2 100	4	0	100 %	
90 Generator	2022	1	3 100	4	0	100 %	
						%	
						%	
						%	

- 1.One Story Fram
- 2.Two Story Fram
- 3.Three Story Fr
- 4.1 & 1/2 Story
- 5.1 & 3/4 Story
- 6.2 & 1/2 Story
- 21.Open Frame Por
- 22.Encl Frame Por
- 23.Frame Garage
- 24.Frame Shed
- 25.Frame Bay Wind
- 26.1SFr Overhang
- 27.Unfin Basement
- 28.Unfinished Att
- 29.Finished Attic

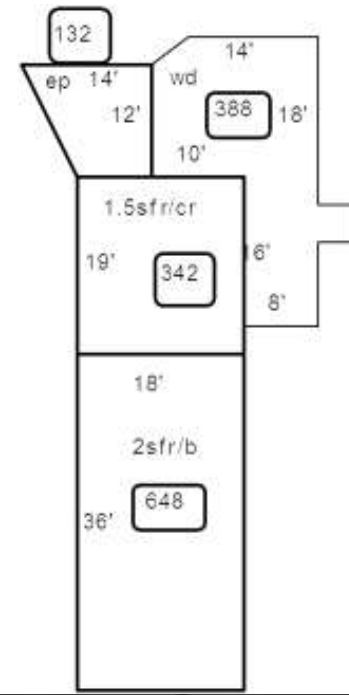

Proposed Value