

CLIFFORD, GALE P
94 LEWISTON ROAD
GRAY ME 04039

B34805P314

Previous Owner
EMERSON ALLEY, FARRAH
ALLEY, COREY L
94 LEWISTON ROAD
GRAY ME 04039
Sale Date: 4/30/2018

Previous Owner
EMERSON, FARRAH L
94 LEWISTON ROAD
UNIT #11
GRAY ME 04039
Sale Date: 6/22/2017

Inspection Witnessed By:

X Date

No./Date	Description	Date Insp.

Notes:

Gray

Property Data			Assessment Record						
Neighborhood 16 Lewiston Commercial			Year	Land	Buildings	Exempt	Total		
Tree Growth Year 0			2011	35,000	72,428	8,500	98,928		
REVIEW 0			2012	35,000	72,428	8,500	98,928		
Building Permit 0			2013	35,000	72,428	8,500	98,928		
Zone/Land Use 13 Commercial			2014	35,000	72,428	8,500	98,928		
Secondary Zone			2015	35,000	72,400	9,000	98,400		
Topography 1 Level			2016	35,000	72,400	9,000	98,400		
1. Well 4. Below St 7.			2017	35,000	72,400	13,500	93,900		
2. Rolling 5. Low 8.			2018	35,000	72,400	18,000	89,400		
3. Above St 6. Swampy 9.			2019	40,000	101,300	20,000	121,300		
Utilities 2 Public Water 6 Septic System			2020	40,000	101,300	0	141,300		
1. Public 4. Dr. Well/Po 7. Cesspool			2021	40,000	101,300	25,000	116,300		
2. Water 5. Dug Well 8. Lake			2022	40,000	101,300	25,000	116,300		
3. Holding Ta 6. Septic 9. None			2023	40,000	124,200	25,000	139,200		
Street 1 Paved			Calc.	80,000	164,100	25,000	219,100		
1. Paved 4. Proposed			Land Data						
2. Semi Imp 5. R/O/W			Front Foot	Type	Effective		Influence		Influence Codes
3. Gravel 6. None					Frontage	Depth	Factor	Code	
GIS Map 28			11. Water (0-200)				%		1. Unimproved
Field Review 1			12. Water (201-400)				%		2. Excess Frtg
Sale Data			13. Water (401-800)				%		3. Topography
Sale Date 4/30/2018			14. Water (801-160)				%		4. Size/Shape
Price 141,000			15. Water (161-32)				%		5. Access
Sale Type 2 Land & Buildings			Square Foot				%		6. Restriction
1. Land 4. Mobile 7. COM			Square Feet				%		7. Open Space
2. L & B 5. Other 8.			16. Water (3201				%		8. Environmental
3. Building 6. Condo 9.			17. Water SF Amen				%		9. Condo
Financing 9 Unknown			18. Water View				%		Acres
1. Convent 4. Seller 7.			19. Water Influen				%		30. Blueberry(1-20
2. FHA/VA 5. Private 8.			20. ShoreFront A				%		31. Blueberry(21 -
3. Assumed 6. Cash 9. Unknown			Fract. Acre				%		32. Crop Land
Validity 1 Arms Length Sale			21. Base Lot	47	1.00	100	%	0	33. Pasture
1. Valid 4. Split 7. Multiple			22. Base Lot Vacan				%		34. Shorefront B
2. Related 5. Partial 8. Other			23. Base Lot Unpav				%		35. Shorefront C
3. Distress 6. Exempt 9. Estate			Acres				%		36. ANTENNA SITE
Verified 5 Public Record			24. Acres to 10				%		37. Softwood TG
1. Buyer 4. Agent 7. Family			25. Acres 11-30				%		38. Mixed Wood TG
2. Seller 5. Pub Rec 8. Other			26. Acres 31-50				%		39. Hardwood TG
3. Lender 6. MLS 9.			27. Acres 51& over				%		40. Wasteland
			28. Acres 71 & Ove				%		41. Woodland
			29. Woods (41+)				%		42. Mobile Home Si
			Total Acreage		0.00				43. Camp Site
									44. Lot Improvemen
									45. BA SF - Oce
									46. SP Meadow Cond

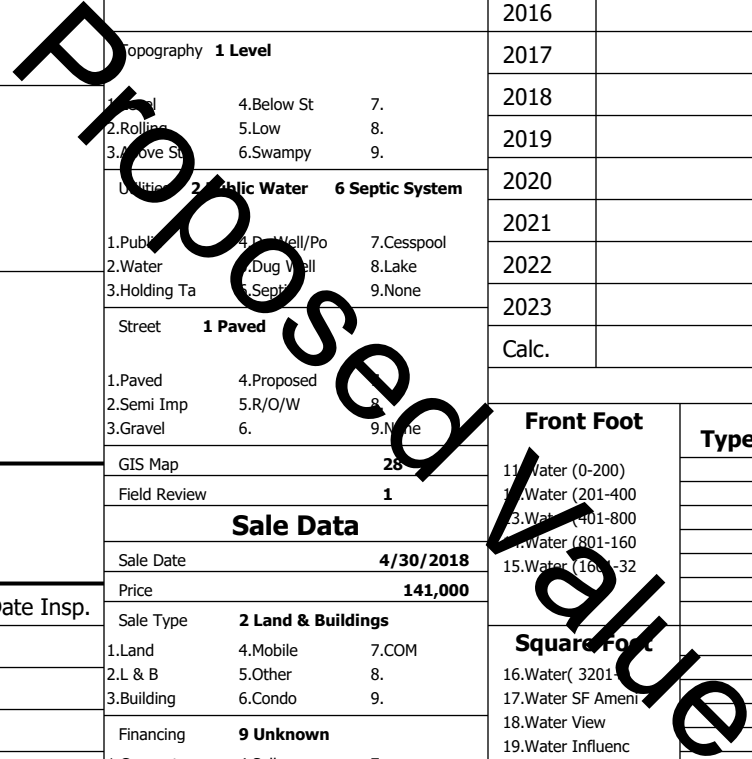

Gray

Map Lot 028-025-029-011

Account 1400

Location 94 LEWISTON RD #11

Card 1 Of 1

8/05/2024

Building Style 18 Dunbar Woods	SF Bsmt Living 0	Layout 1 Typical
1.Conv. 5.Garrison 9.NE farm	Fin Bsmt Grade 0 0	1.Typical 4. 7.
2.Ranch 6.Split 10.Colonia	Secondary Heat 0	2.Inadeq 5. 8.
3.R Ranch/ 7.Contemp 11.Cottage	Heat Type 100% 1 Hot Water BB	3. 6. 9.
4.Cape 8.Log 12.Gambrel	1.HWBB 5.FWA 9.None	Attic 9 None
Dwelling Units 1	2.HWCI 6.Monitor 10.UNH2F	1.1/4 Fin 4.Full Fin 7.
Other Units 0	3.HWRF 7.Electric 11.Geother	2.1/2 Fin 5.FI/Stair 8.
Stories 2 Two Story	4.Steam 8.FI/Wall 12.Heat/Co	3.3/4 Fin 6. 9.None
1.1 4.1.5 7.	Cool Type 0% 9 None	Insulation 1 Full
2.2 5.1.75 8.	1.Central 4.W&C Air 7.	1.Full 4.Minimal 7.
3.3 6.2.5 9.	2.Evapor 5. 8.	2.Heavy 5. 8.
Exterior Walls 2 Vinyl/Aluminum	3.H Pump 6. 9.None	3.Capped 6. 9.None
1.Clapboard 5.Stucco 9.B & B	Kitchen Style 1 Modern	Unfinished % 0%
2.Vin/Al 6.Brick 10.Cemplan	1.Modern 4.Obsolete	Grade & Factor 3 Average 100%
3.Compos./ 7.Stone 11.Concret	2.Typical 5. 8.	1.E Grade 4.B Grade 7.SC Grade
4.Asbestos 8.Wood Shi 12.Wood Bo	3.Old Type 6. 9.None	2.D Grade 5.A Grade 8.
Roof Surface 1 Asphalt Shingles	Bath(s) Style 1 Modern Bath(s)	3.C Grade 6.AA Grade 9.Same
1.Asphalt 4.Composit 7.Other	1.Modern 4.Obsolete 7.	SQFT (Footprint) 504
2.Slate 5.Wood 8.	2.Typical 5. 8.	Foundation 4 Average
3.Metal 6.Roll Roo 9.	3.Old Type 6. 9.None	1.Poor 4.Avg 7.V G
SF Masonry Trim 0	# Rooms 4	2.Fair 5.Avg 8.Exc
SOLAR VOLTAIC 0	# Bedrooms 2	3.Avg- 6.Good 9.Same
OPEN-4- 0	# Full Baths 1	Phys. % Good 0%
Year Built 1992	# Half Baths 1	Funct. % Good 100%
Year Remodeled 0	# Addn Fixtures 0	Functional Code 9 None
Foundation 1 Concrete	# Fireplaces 0	1.Incomp 4.Delap 5.Layoff
1.Concrete 4.Wood 7.		2.O-Built 5.Bsmt 6.Long term
2.C Block 5.Slab 8.		3.Damage 6.Style 9.None
3.Br/Stone 6.Piers 9.		Econ. % Good 100%
Basement 4 Full Basement		Economic Code None
1.1/4 Bmt 4.Full Bmt 7.		0.None 3.No Power 6.Obsolete
2.1/2 Bmt 5.Crwl 8.		1.Location 4.Generate 9.None
3.3/4 Bmt 6. 9.None		2.Encroach 5.Flood Pl 9.
Bsmt Gar # Cars 0		Entrance Code 5 Estimated
Wet Basement 1 Dry Basement		1.Interior 4.Vacant 7.
1.Dry 4. 7.		2.Refusal 5.Estimate 8.
2.Damp 5. 8.		3.Informed 6. 9.
3.Wet 6. 9.		Information Code 5 Estimate
		1.Owner 4.Agent 7.
		2.Relative 5.Estimate 8.
		3.Tenant 6.Other 9.

Date Inspected 11/20/2015

Additions, Outbuildings & Improvements

Type	Year	Units	Grade	Cond	Phys.	Funct.	Sound Value
					%	%	1.One Story Fram
					%	%	2.Two Story Fram
					%	%	3.Three Story Fr
					%	%	4.1 & 1/2 Story
					%	%	5.1 & 3/4 Story
					%	%	6.2 & 1/2 Story
					%	%	21.Open Frame Por
					%	%	22.Encl Frame Por
					%	%	23.Frame Garage
					%	%	24.Frame Shed
					%	%	25.Frame Bay Wind
					%	%	26.1SFr Overhang
					%	%	27.Unfin Basement
					%	%	28.Unfinished Att
					%	%	29.Finished Attic

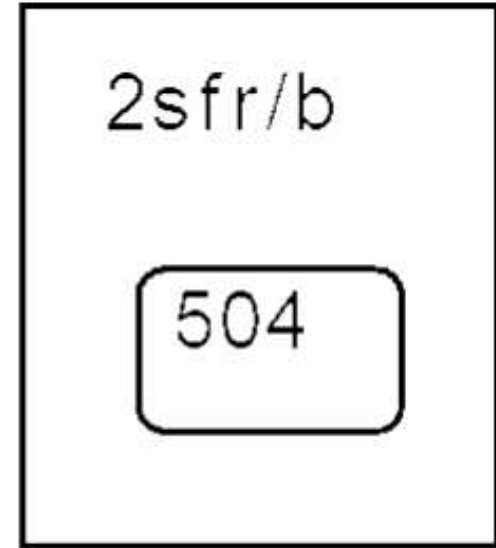

Proposed Value