

SKILLING, KENNETH JR  
SKILLING, LISA  
9 ADLER DRIVE  
GRAY ME 04039

B9561P74

Inspection Witnessed By:

X

No./Date	Description	Date Insp.

Notes:  
5/24 DR FIELD REVIEW

Gray

Property Data			Assessment Record						
Neighborhood <b>83 Avg-Good Location</b>			Year	Land	Buildings	Exempt	Total		
Tree Growth Year <b>0</b>			2011	35,000	86,819	8,500	113,319		
REVIEW <b>0</b>			2012	35,000	86,819	8,500	113,319		
Building Permit <b>0</b>			2013	35,000	86,819	8,500	113,319		
Zone/Land Use <b>11 Rural Residential &amp; Agri</b>			2014	35,000	86,819	8,500	113,319		
Secondary Zone			2015	35,000	86,800	9,000	112,800		
Topography <b>1 Level</b>			2016	35,000	86,800	9,000	112,800		
1. Hill 4. Below St 7.			2017	35,000	86,800	13,500	108,300		
2. Rolling 5. Low 8.			2018	35,000	86,800	18,000	103,800		
3. Above St 6. Swampy 9.			2019	57,100	158,500	20,000	195,600		
Utilities 2. Public Water 6. Septic System			2020	57,100	158,500	20,000	195,600		
1. Public 4. Dr Well/Po 7. Cesspool			2021	57,100	158,500	25,000	190,600		
2. Water 8. Lake			2022	57,100	158,500	25,000	190,600		
3. Holding Ta 9. None			2023	57,100	178,100	25,000	210,200		
Street <b>1 Paved</b>			Calc.	120,700	223,800	25,000	319,500		
1. Paved 4. Proposed			<b>Land Data</b>						
2. Semi Imp 5. R/O/W			<b>Front Foot</b>	<b>Type</b>	<b>Effective</b>		<b>Influence</b>		<b>Influence Codes</b>
3. Gravel 6. None					<b>Frontage</b>	<b>Depth</b>	<b>Factor</b>	<b>Code</b>	
GIS Map <b>27</b>			11. Water (0-200)				%		1. Unimproved
Field Review <b>1</b>			12. Water (201-400)				%		2. Excess Frtg
<b>Sale Data</b>			13. Water (401-800)				%		3. Topography
Sale Date <b>5/17/1991</b>			14. Water (801-160)				%		4. Size/Shape
Price			15. Water (161-32)				%		5. Access
Sale Type							%		6. Restriction
1. Land 4. Mobile 7. COM			<b>Square Foot</b>	<b>Square Feet</b>					7. Open Space
2. L & B 5. Other 8.			16. Water ( 3201-				%		8. Environmental
3. Building 6. Condo 9.			17. Water SF Amen				%		9. Condo
Financing			18. Water View				%		<b>Acres</b>
1. Convent 4. Seller 7.			19. Water Influen				%		30. Blueberry(1-20
2. FHA/VA 5. Private 8.			20. ShoreFront A				%		31. Blueberry(21 -
3. Assumed 6. Cash 9. Unknown							%		32. Crop Land
Validity			<b>Fract. Acre</b>	<b>Acreege/Sites</b>					33. Pasture
1. Valid 4. Split 7. Multiple			21. Base Lot	21	0.50	100	%	0	34. Shorefront B
2. Related 5. Partial 8. Other			22. Base Lot Vacan				%		35. Shorefront C
3. Distress 6. Exempt 9. Estate			23. Base Lot Unpav				%		36. ANTENNA SITE
Verified			<b>Acres</b>				%		37. Softwood TG
1. Buyer 4. Agent 7. Family			24. Acres to 10				%		38. Mixed Wood TG
2. Seller 5. Pub Rec 8. Other			25. Acres 11-30				%		39. Hardwood TG
3. Lender 6. MLS 9.			26. Acres 31-50				%		40. Wasteland
			27. Acres 51& over				%		41. Woodland
			28. Acres 71 & Ove				%		42. Mobile Home Si
			29. Woods (41+)				%		43. Camp Site
			<b>Total Acreage</b>		<b>0.50</b>				44. Lot Improvemen
									45. BA SF - Oce
									46. SP Meadow Cond

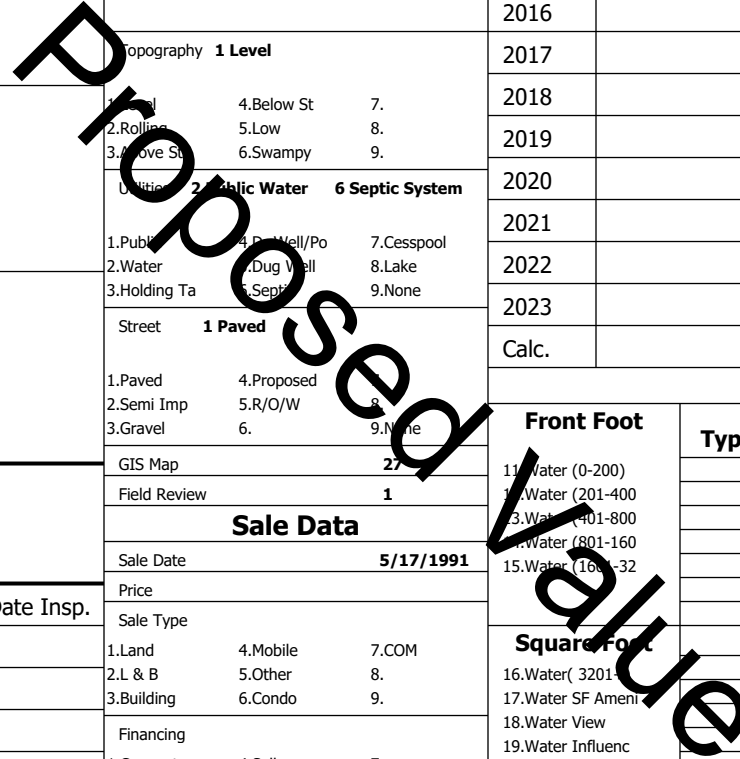

Building Style <b>2 Ranch</b>	SF Bsmt Living <b>500</b>	Layout <b>1 Typical</b>
1.Conv. 5.Garrison 9.NE farm	Fin Bsmt Grade <b>3 100</b>	1.Typical 4. 7.
2.Ranch 6.Split 10.Colonia	Secondary Heat <b>0</b>	2.Inadeq 5. 8.
3.R Ranch/ 7.Contemp 11.Cottage	Heat Type <b>100% 1 Hot Water BB</b>	3. 6. 9.
4.Cape 8.Log 12.Gambrel	1.HWBB 5.FWA 9.None	Attic <b>9 None</b>
Dwelling Units <b>1</b>	2.HWCI 6.Monitor 10.UNH2F	1.1/4 Fin 4.Full Fin 7.
Other Units <b>0</b>	3.HWRF 7.Electric 11.Geother	2.1/2 Fin 5.FI/Stair 8.
Stories <b>1 One Story</b>	4.Steam 8.FI/Wall 12.Heat/Co	3.3/4 Fin 6. 9.None
1.1 4.1.5 7.	Cool Type <b>0% 9 None</b>	Insulation <b>1 Full</b>
2.2 5.1.75 8.	1.Central 4.W&C Air 7.	1.Full 4.Minimal 7.
3.3 6.2.5 9.	2.Evapor 5. 8.	2.Heavy 5. 8.
Exterior Walls <b>8 Wood Shingle</b>	3.H Pump 6. 9.None	3.Capped 6. 9.None
1.Clapboard 5.Stucco 9.B & B	Kitchen Style <b>2 Typical</b>	Unfinished % <b>0%</b>
2.Vin/Al 6.Brick 10.Cemplan	1.Modern 4.Obsolete	Grade & Factor <b>3 Average 110%</b>
3.Compos./ 7.Stone 11.Concret	2.Typical 5. 8.	1.E Grade 4.B Grade 7.SC Grade
4.Asbestos 8.Wood Shi 12.Wood Bo	3.Old Type 6. 9.None	2.D Grade 5.A Grade 8.
Roof Surface <b>1 Asphalt Shingles</b>	Bath(s) Style <b>2 Typical Bath(s)</b>	3.C Grade 6.AA Grade 9.Same
1.Asphalt 4.Composit 7.Other	1.Modern 4.Obsolete 7.	SQFT (Footprint) <b>1196</b>
2.Slate 5.Wood 8.	2.Typical 5. 8.	Foundation <b>4 Average</b>
3.Metal 6.Roll Roo 9.	3.Old Type 6. 9.None	1.Poor 2.Avg 7.V G
SF Masonry Trim <b>0</b>	# Rooms <b>5</b>	2.Fair 3.Good 8.Exc
SOLAR VOLTAIC <b>0</b>	# Bedrooms <b>3</b>	3.Avg- 9.Same
OPEN-4- <b>0</b>	# Full Baths <b>1</b>	Phys. % Good <b>0%</b>
Year Built <b>1967</b>	# Half Baths <b>0</b>	Funct. % Good <b>100%</b>
Year Remodeled <b>0</b>	# Addn Fixtures <b>0</b>	Functional Code <b>9 None</b>
Foundation <b>1 Concrete</b>	# Fireplaces <b>0</b>	1.Incomp 4.Delap 5.Layoff
1.Concrete 4.Wood 7.		2.O-Built 5.Bsmt 6.Long term
2.C Block 5.Slab 8.		3.Damage 6.Style 7.None
3.Br/Stone 6.Piers 9.		Econ. % Good <b>100%</b>
Basement <b>4 Full Basement</b>		Economic Code <b>None</b>
1.1/4 Bmt 4.Full Bmt 7.		0.None 3.No Power 6.Obsolete
2.1/2 Bmt 5.Crwl 8.		1.Location 4.Generate 9.None
3.3/4 Bmt 6. 9.None		2.Encroach 5.Flood Pl 9.
Bsmt Gar # Cars <b>0</b>		Entrance Code <b>5 Estimated</b>
Wet Basement <b>1 Dry Basement</b>		1.Interior 4.Vacant 7.
1.Dry 4. 7.		2.Refusal 5.Estimate 8.
2.Damp 5. 8.		3.Informed 6. 9.
3.Wet 6. 9.		Information Code <b>5 Estimate</b>
		1.Owner 4.Agent 7.
		2.Relative 5.Estimate 8.
		3.Tenant 6.Other 9.

Date Inspected 5/15/2024

**Additions, Outbuildings & Improvements**

Type	Year	Units	Grade	Cond	Phys.	Funct.	Sound Value
23 Frame Garage	1975	576	0 0	0	0	100 %	1.One Story Fram
24 Frame Shed	0	88	0 0	0	0	100 %	2.Two Story Fram
22 Encl Frame Porch	1998	88	0 0	0	0	100 %	3.Three Story Fr
68 Wood Deck	1998	193	3 100	0	0	100 %	4.1 & 1/2 Story
							5.1 & 3/4 Story
							6.2 & 1/2 Story
							21.Open Frame Por
							22.Encl Frame Por
							23.Frame Garage
							24.Frame Shed
							25.Frame Bay Wind
							26.1SFr Overhang
							27.Unfin Basement
							28.Unfinished Att
							29.Finished Attic

