

WG HOMES LLC
324 GRAY ROAD
FALMOUTH ME 04105

B38347P214

Previous Owner
RAND REAL ESTATE, LLC
5 BRAYSLEY WAY

GRAY ME 04039
Sale Date: 6/23/2021

Previous Owner
DYKE, VIRGINIA L
171 SHAKER RD

GRAY ME 04039
Sale Date: 7/07/2009

Inspection Witnessed By:

X	Date	Date Insp.
No./Date	Description	Date Insp.

Notes:
5/24 DR FIELD REVIEW

Gray

Property Data		
Neighborhood	81 Fair-Traffic	
Tree Growth Year	0	
REVIEW	c	
Building Permit	0	
Zone/Land Use	11 Rural Residential & Agri	
Secondary Zone		
Topography	1 Level	
1. Soil	4. Below St	7.
2. Rolling	5. Low	8.
3. Above St	6. Swampy	9.
Utilities	2 Public Water 6 Septic System	
1. Public	4. Dr. Well/Po	7. Cesspool
2. Water	5. Dug Well	8. Lake
3. Holding Ta	6. Septic	9. None
Street	1 Paved	
1. Paved	4. Proposed	8.
2. Semi Imp	5. R/O/W	9.
3. Gravel	6.	9. None
GIS Map	27	
Field Review	1	
Sale Data		
Sale Date	6/23/2021	
Price	311,250	
Sale Type	2 Land & Buildings	
1. Land	4. Mobile	7. COM
2. L & B	5. Other	8.
3. Building	6. Condo	9.
Financing	1 Conventional	
1. Convent	4. Seller	7.
2. FHA/VA	5. Private	8.
3. Assumed	6. Cash	9. Unknown
Validity	1 Arms Length Sale	
1. Valid	4. Split	7. Multiple
2. Related	5. Partial	8. Other
3. Distress	6. Exempt	9. Estate
Verified	5 Public Record	
1. Buyer	4. Agent	7. Family
2. Seller	5. Pub Rec	8. Other
3. Lender	6. MLS	9.

Assessment Record				
Year	Land	Buildings	Exempt	Total
2012	66,833	64,360	0	131,193
2013	66,800	71,500	0	138,300
2014	66,800	71,500	0	138,300
2018	66,800	71,500	0	138,300
2019	78,000	127,200	0	205,200
2021	78,000	127,200	0	205,200
2022	78,000	127,200	0	205,200
2023	78,000	138,300	0	216,300
Calc.	54,600	206,200	0	260,800

Land Data					
Type	Effective		Influence		Influence Codes
	Frontage	Depth	Factor	Code	
1. Water (0-200)			%		1. Unimproved
2. Water (201-400)			%		2. Excess Frtg
3. Water (401-800)			%		3. Topography
4. Water (801-160)			%		4. Size/Shape
5. Water (1601-32)			%		5. Access
			%		6. Restriction
			%		7. Open Space
			%		8. Environmental
			%		9. Condo
Square Foot		Square Feet		Acres	
16. Water (3201-6400)			%		30. Blueberry(1-20
17. Water SF Amen			%		31. Blueberry(21 -
18. Water View			%		32. Crop Land
19. Water Influen			%		33. Pasture
20. ShoreFront A			%		34. Shorefront B
			%		35. Shorefront C
			%		36. ANTENNA SITE
			%		37. Softwood TG
			%		38. Mixed Wood TG
			%		39. Hardwood TG
			%		40. Wasteland
			%		41. Woodland
			%		42. Mobile Home Si
			%		43. Camp Site
			%		44. Lot Improvemen
			%		45. BA SF - Oce
			%		46. SP Meadow Cond
Fract. Acre		Acreage/Sites			
21. Base Lot	76	0.95	100	%	0
22. Base Lot Vacan				%	
23. Base Lot Unpav				%	
Acres					
24. Acres to 10				%	
25. Acres 11-30				%	
26. Acres 31-50				%	
27. Acres 51& over				%	
28. Acres 71 & Ove				%	
29. Woods (41+)				%	
Total Acreage		0.95			

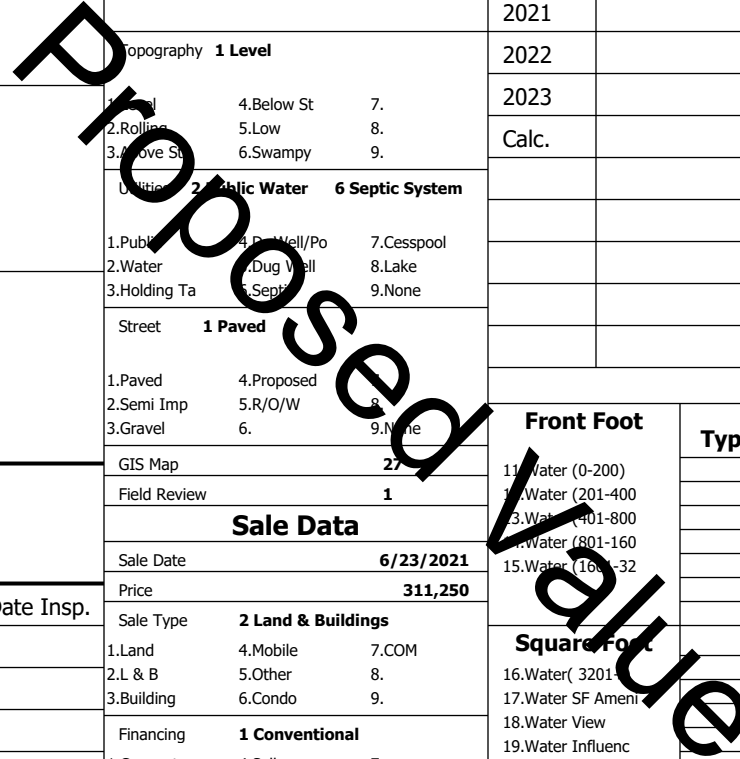

WG HOMES LLC
324 GRAY ROAD
FALMOUTH ME 04105

B38347P214

Previous Owner
RAND REAL ESTATE, LLC
5 BRAYSLEY WAY

GRAY ME 04039
Sale Date: 6/23/2021

Previous Owner
DYKE, VIRGINIA L
171 SHAKER RD

GRAY ME 04039
Sale Date: 7/07/2009

Inspection Witnessed By:

X	Date	Date Insp.
No./Date	Description	Date Insp.

Notes:
5/24 DR FIELD REVIEW

Gray

Property Data		
Neighborhood	81 Fair-Traffic	
Tree Growth Year	0	
REVIEW	0	
Building Permit	0	
Zone/Land Use	11 Rural Residential & Agri	
Secondary Zone		
Topography	1 Level	
1. Soil	4. Below St	7.
2. Rolling	5. Low	8.
3. Above St	6. Swampy	9.
Utilities	2 Public Water 6 Septic System	
1. Public	4. Dr. Well/Po	7. Cesspool
2. Water	5. Dug Well	8. Lake
3. Holding Ta	6. Septic	9. None
Street	1 Paved	
1. Paved	4. Proposed	8.
2. Semi Imp	5. R/O/W	9.
3. Gravel	6.	9. None
GIS Map	27	
Field Review	1	
Sale Data		
Sale Date	6/23/2021	
Price	311,250	
Sale Type	2 Land & Buildings	
1. Land	4. Mobile	7. COM
2. L & B	5. Other	8.
3. Building	6. Condo	9.
Financing	1 Conventional	
1. Convent	4. Seller	7.
2. FHA/VA	5. Private	8.
3. Assumed	6. Cash	9. Unknown
Validity	1 Arms Length Sale	
1. Valid	4. Split	7. Multiple
2. Related	5. Partial	8. Other
3. Distress	6. Exempt	9. Estate
Verified	5 Public Record	
1. Buyer	4. Agent	7. Family
2. Seller	5. Pub Rec	8. Other
3. Lender	6. MLS	9.

Assessment Record				
Year	Land	Buildings	Exempt	Total
2013	0	0	0	0
2014	0	0	0	0
2018	0	0	0	0
2019	0	4,700	0	4,700
2021	0	4,700	0	4,700
2022	0	4,700	0	4,700
2023	0	4,700	0	4,700
Calc.	0	9,000	0	9,000

Land Data					
Type	Effective		Influence		Influence Codes
	Frontage	Depth	Factor	Code	
1. Water (0-200)			%		1. Unimproved
2. Water (201-400)			%		2. Excess Frtg
3. Water (401-800)			%		3. Topography
4. Water (801-160)			%		4. Size/Shape
5. Water (1601-32)			%		5. Access
			%		6. Restriction
			%		7. Open Space
			%		8. Environmental
			%		9. Condo
Square Foot		Square Feet		Acres	
16. Water (3201-6400)			%		30. Blueberry(1-20
17. Water SF Amen			%		31. Blueberry(21 -
18. Water View			%		32. Crop Land
19. Water Influen			%		33. Pasture
20. ShoreFront A			%		34. Shorefront B
			%		35. Shorefront C
			%		36. ANTENNA SITE
			%		37. Softwood TG
			%		38. Mixed Wood TG
			%		39. Hardwood TG
			%		40. Wasteland
			%		41. Woodland
			%		42. Mobile Home Si
			%		43. Camp Site
			%		44. Lot Improvemen
			%		45. BA SF - Oce
			%		46. SP Meadow Cond
Total Acreage		0.00			

