

GALLAGHER, PAUL W  
GALLAGHER, WENDY  
13 LEGROW RD  
GRAY ME 04039

B33165P146

Previous Owner  
MCGRAW, DONNA J  
PO BOX 452

GRAY ME 04039  
Sale Date: 6/03/2016

Property Data			Assessment Record				
Neighborhood	82 Average Location		Year	Land	Buildings	Exempt	Total
Tree Growth Year	0		2017	38,500	0	0	38,500
REVIEW	0		2018	38,500	0	0	38,500
Building Permit	0		2019	50,600	0	0	50,600
Zone/Land Use	11 Rural Residential & Agri		2020	50,600	0	0	50,600
Secondary Zone			2021	2,100	0	0	2,100
			2022	2,100	0	0	2,100
Topography	1 Level		2023	2,100	0	0	2,100
			Calc.	2,300	0	0	2,300

Land Data		Front Foot		Effective		Influence		Influence Codes
Type		Frontage	Depth	Factor	Code			
11. Water (0-200)				%		1.Unimproved		
12. Water (201-400)				%		2.Excess Frtg		
13. Water (401-800)				%		3.Topography		
14. Water (801-160)				%		4.Size/Shape		
15. Water (1601-32)				%		5.Access		
				%		6.Restriction		
				%		7.Open Space		
				%		8.Environmental		
				%		9.Condo		
				%		30.Blueberry(1-20		
				%		31.Blueberry(21 -		
				%		32.Crop Land		
				%		33.Pasture		
				%		34.Shorefront B		
				%		35.Shorefront C		
				%		36.ANTENNA SITE		
				%		37.Softwood TG		
				%		38.Mixed Wood TG		
				%		39.Hardwood TG		
				%		40.Wasteland		
				%		41.Woodland		
				%		42.Mobile Home Si		
				%		43.Camp Site		
				%		44.Lot Improvemen		
				%		45.BA SF - Oce		
				%		46.SP Meadow Cond		

Inspection Witnessed By:

X	Date

Notes:  
5/24 DR FIELD REVIEW

Gray

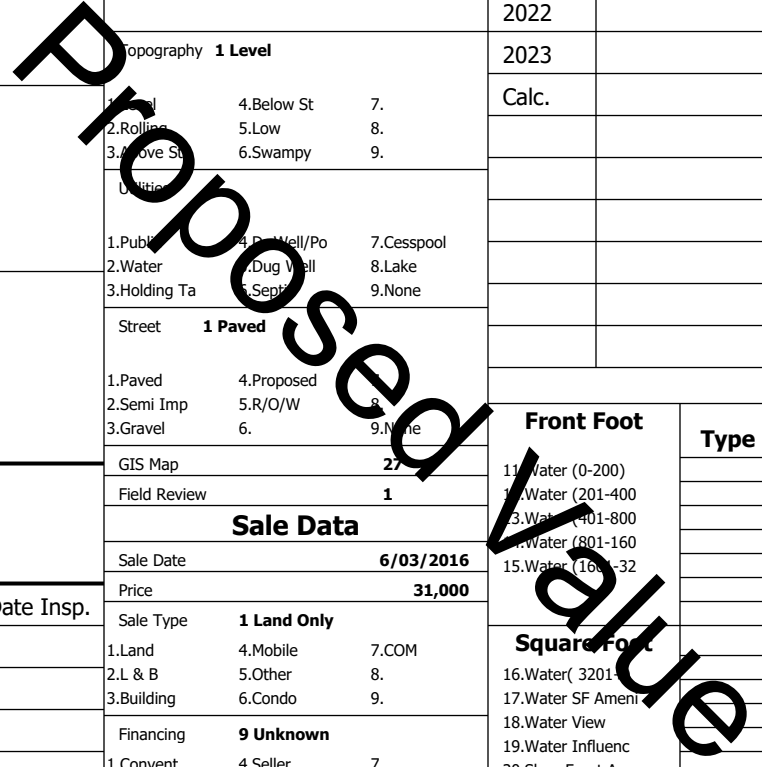

Sale Data		
Sale Date	6/03/2016	
Price	31,000	
Sale Type	1 Land Only	
1.Land	4.Mobile	7.COM
2.L & B	5.Other	8.
3.Building	6.Condo	9.
Financing	9 Unknown	
1.Convent	4.Seller	7.
2.FHA/VA	5.Private	8.
3.Assumed	6.Cash	9.Unknown
Validity	1 Arms Length Sale	
1.Valid	4.Split	7.Multiple
2.Related	5.Partial	8.Other
3.Distress	6.Exempt	9.Estate
Verified	5 Public Record	
1.Buyer	4.Agent	7.Family
2.Seller	5.Pub Rec	8.Other
3.Lender	6.MLS	9.

Front Foot	Square Foot	Fract. Acre
16. Water (3201-3202)		
17. Water SF Amen		
18. Water View		
19. Water Influen		
20. ShoreFront A		
21. Base Lot		
22. Base Lot Vacan		
23. Base Lot Unpav		
24. Acres to 10		
25. Acres 11-30		
26. Acres 31-50		
27. Acres 51& over		
28. Acres 71 & Ove		
29. Woods (41+)		

Total Acreage 5.58

Building Style <b>0</b>	SF Bsmt Living <b>0</b>	Layout <b>0</b>
1.Conv. 5.Garrison 9.NE farm	Fin Bsmt Grade <b>0 0</b>	1.Typical 4. 7.
2.Ranch 6.Split 10.Colonia	Secondary Heat <b>0</b>	2.Inadeq 5. 8.
3.R Ranch/ 7.Contemp 11.Cottage	Heat Type <b>100% 0</b>	3. 6. 9.
4.Cape 8.Log 12.Gambrel	1.HWBB 5.FWA 9.None	Attic <b>0</b>
Dwelling Units <b>0</b>	2.HWCI 6.Monitor 10.UNH2F	1.1/4 Fin 4.Full Fin 7.
Other Units <b>0</b>	3.HWRF 7.Electric 11.Geother	2.1/2 Fin 5.FI/Stair 8.
Stories <b>0</b>	4.Steam 8.FI/Wall 12.Heat/Co	3.3/4 Fin 6. 9.None
1.1 4.1.5 7.	Cool Type <b>0% 9 None</b>	Insulation <b>0</b>
2.2 5.1.75 8.	1.Central 4.W&C Air 7.	1.Full 4.Minimal 7.
3.3 6.2.5 9.	2.Evapor 5. 8.	2.Heavy 5. 8.
Exterior Walls <b>0</b>	3.H Pump 6. 9.None	3.Capped 6. 9.None
1.Clapboar 5.Stucco 9.B & B	Kitchen Style <b>0</b>	Unfinished % <b>0%</b>
2.Vin/Al 6.Brick 10.Cemplan	1.Modern 4.Obsolete	Grade & Factor <b>0 0%</b>
3.Compos./ 7.Stone 11.Concret	2.Typical 5. 8.	1.E Grade 4.B Grade 7.SC Grade
4.Asbestos 8.Wood Shi 12.Wood Bo	3.Old Type 6. 9.None	2.C Grade 5.A Grade 8.
Roof Surface <b>0</b>	Bath(s) Style <b>0</b>	3.D Grade 6.AA Grade 9.Same
1.Asphalt 4.Composit 7.Other	1.Modern 4.Obsolete 7.	SQFT (Footprint) <b>0</b>
2.Slate 5.Wood 8.	2.Typical 5. 8.	1.Poor Avg 7.V G
3.Metal 6.Roll Roo 9.	3.Old Type 6. 9.None	2.Fair Avg 8.Exc
SF Masonry Trim <b>0</b>	# Rooms <b>0</b>	3.Avg- Good 9.Same
SOLAR VOLTAIC <b>0</b>	# Bedrooms <b>0</b>	Phys. % Good <b>0%</b>
OPEN-4- <b>0</b>	# Full Baths <b>0</b>	Funct. % Good <b>100%</b>
Year Built <b>0</b>	# Half Baths <b>0</b>	Functional Code <b>9 None</b>
Year Remodeled <b>0</b>	# Addn Fixtures <b>0</b>	1.Incomp 4.Delap 9.No
Foundation <b>0</b>	# Fireplaces <b>0</b>	2.O-Built 5.Bsmt 8.Long term
1.Concrete 4.Wood 7.		3.Damage 6.Style None
2.C Block 5.Slab 8.		Econ. % Good <b>100%</b>
3.Br/Stone 6.Piers 9.		Economic Code <b>None</b>
Basement <b>0</b>		0.None 3.No Power 6.Obsolete
1.1/4 Bmt 4.Full Bmt 7.		1.Location 4.Generate 9.None
2.1/2 Bmt 5.Crwl 8.		2.Encroach 5.Flood Pl 9.
3.3/4 Bmt 6. 9.None		Entrance Code <b>5 Estimated</b>
Bsmt Gar # Cars <b>0</b>		1.Interior 4.Vacant 7.
Wet Basement <b>0</b>		2.Refusal 5.Estimate 8.
1.Dry 4. 7.		3.Informed 6. 9.
2.Damp 5. 8.		Information Code <b>5 Estimate</b>
3.Wet 6. 9.		1.Owner 4.Agent 7.
		2.Relative 5.Estimate 8.
		3.Tenant 6.Other 9.



Date Inspected 5/10/2024

**Additions, Outbuildings & Improvements**

Type	Year	Units	Grade	Cond	Phys.	Funct.	Sound Value
					%	%	1.One Story Fram
					%	%	2.Two Story Fram
					%	%	3.Three Story Fr
					%	%	4.1 & 1/2 Story
					%	%	5.1 & 3/4 Story
					%	%	6.2 & 1/2 Story
					%	%	21.Open Frame Por
					%	%	22.Encl Frame Por
					%	%	23.Frame Garage
					%	%	24.Frame Shed
					%	%	25.Frame Bay Wind
					%	%	26.1SFr Overhang
					%	%	27.Unfin Basement
					%	%	28.Unfinished Att
					%	%	29.Finished Attic

Proposed Value