

HOBBS, KELLY E
HOBBS, DANIEL L
127 SHAKER RD #56
GRAY ME 04039

			Property Data			Assessment Record						
			Neighborhood	81 Fair-Traffic		Year	Land	Buildings	Exempt	Total		
			Tree Growth Year 0			2011	0	40,009	0	40,009		
			REVIEW 0			2012	0	40,009	0	40,009		
			Building Permit 0			2013	0	40,009	0	40,009		
			Zone/Land Use 22 Wellhead Protection II			2014	0	40,009	0	40,009		
			Secondary Zone			2015	0	40,000	0	40,000		
			Topography 1 Level			2016	0	40,000	0	40,000		
			1. Well 4. Below St 7.			2017	0	35,600	13,500	22,100		
			2. Rolling 5. Low 8.			2018	0	36,500	18,000	18,500		
			3. Above St 6. Swampy 9.			2019	0	28,000	20,000	8,000		
			Utilities 2 Public Water 6 Septic System			2020	0	28,000	20,000	8,000		
			1. Public 4. Dr Well/Po 7. Cesspool			2021	0	28,000	25,000	3,000		
			2. Water 8. Dug Well 8. Lake			2022	0	28,000	25,000	3,000		
			3. Holding Ta 9. None			2023	0	28,000	25,000	3,000		
			Street 1 Paved			Calc.	0	46,900	25,000	21,900		
			1. Paved 4. Proposed			Land Data						
			2. Semi Imp 5. R/O/W			Front Foot	Type	Effective		Influence		Influence Codes
			3. Gravel 6. None			11. Water (0-200)		Frontage	Depth	Factor	Code	1. Unimproved
			GIS Map 27			12. Water (201-400)				%		
			Field Review 0			13. Water (401-800)				%		3. Topography
			Sale Date 12/13/2004			14. Water (801-160)				%		
			Price			15. Water (161-320)				%		5. Access
			Sale Type			16. Water (3201-6400)				%		
			1. Land 4. Mobile 7. COM			Square Foot		Square Feet				7. Open Space
			2. L & B 5. Other 8.			17. Water SF Amen				%		
			3. Building 6. Condo 9.			18. Water View				%		9. Condo
			Financing			19. Water Influen				%		
			1. Convent 4. Seller 7.			20. ShoreFront A				%		30. Blueberry(1-20
			2. FHA/VA 5. Private 8.			Fract. Acre		Acreage/Sites				
			3. Assumed 6. Cash 9. Unknown			21. Base Lot				%		32. Crop Land
			Validity			22. Base Lot Vacan				%		
			1. Valid 4. Split 7. Multiple			23. Base Lot Unpav				%		34. Shorefront B
			2. Related 5. Partial 8. Other			Acres		Acres				
			3. Distress 6. Exempt 9. Estate			24. Acres to 10				%		36. ANTENNA SITE
			Verified			25. Acres 11-30				%		
			1. Buyer 4. Agent 7. Family			26. Acres 31-50				%		38. Mixed Wood TG
			2. Seller 5. Pub Rec 8. Other			27. Acres 51& over				%		
			3. Lender 6. MLS 9.			28. Acres 71 & Ove				%		40. Wasteland
						29. Woods (41+)				%		
						Total Acreage		0.00			42. Mobile Home Si	
											43. Camp Site	
											44. Lot Improvemen	
											45. BA SF - Oce	
											46. SP Meadow Cond	

Inspection Witnessed By:

X	Date	Description	Date Insp.

Notes:
5/24 DR FIELD REVIEW

Gray

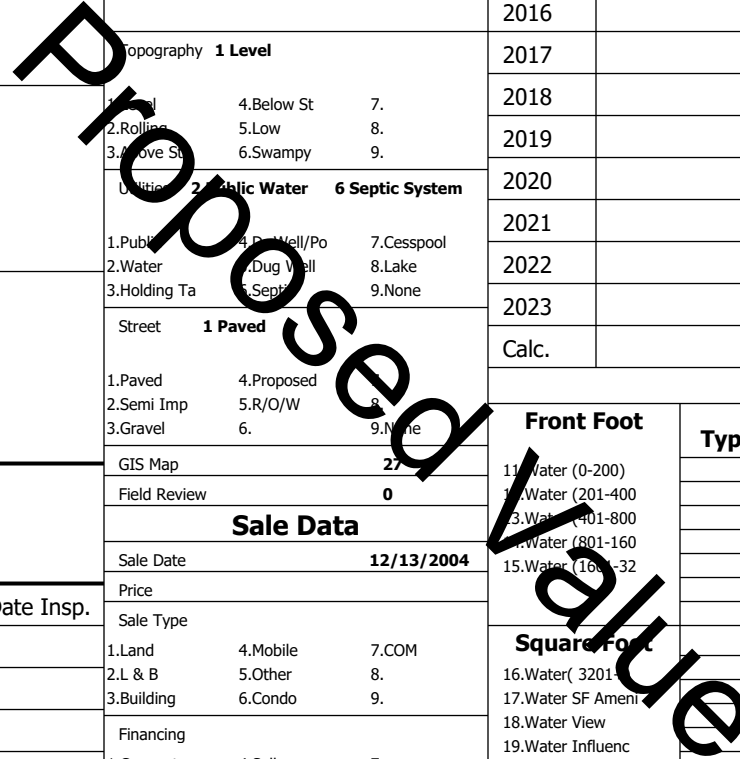

Gray

Map Lot 027-020-011-056

Account 1014

Location 56 MAPLEWOOD PK

Card 1

Of 1

8/05/2024

Building Style 0	SF Bsmt Living 0	Layout 0
1.Conv. 5.Garrison 9.NE farm	Fin Bsmt Grade 0 0	1.Typical 4. 7.
2.Ranch 6.Split 10.Colonia	Secondary Heat 0	2.Inadeq 5. 8.
3.R Ranch/ 7.Contemp 11.Cottage	Heat Type 100% 0	3. 6. 9.
4.Cape 8.Log 12.Gambrel	1.HWBB 5.FWA 9.None	Attic 0
Dwelling Units 0	2.HWCI 6.Monitor 10.UNH2F	1.1/4 Fin 4.Full Fin 7.
Other Units 0	3.HWRF 7.Electric 11.Geother	2.1/2 Fin 5.FI/Stair 8.
Stories 0	4.Steam 8.FI/Wall 12.Heat/Co	3.3/4 Fin 6. 9.None
1.1 4.1.5 7.	Cool Type 0% 9 None	Insulation 0
2.2 5.1.75 8.	1.Central 4.W&C Air 7.	1.Full 4.Minimal 7.
3.3 6.2.5 9.	2.Evapor 5. 8.	2.Heavy 5. 8.
Exterior Walls 0	3.H Pump 6. 9.None	3.Capped 6. 9.None
1.Clapboar 5.Stucco 9.B & B	Kitchen Style 0	Unfinished % 0%
2.Vin/Al 6.Brick 10.Cemplan	1.Modern 4.Obsolete	Grade & Factor 0 0%
3.Compos./ 7.Stone 11.Concret	2.Typical 5. 8.	1.E Grade 4.B Grade 7.SC Grade
4.Asbestos 8.Wood Shi 12.Wood Bo	3.Old Type 6. 9.None	2.D Grade 5.A Grade 8.
Roof Surface 0	Bath(s) Style 0	3.C Grade 6.AA Grade 9.Same
1.Asphalt 4.Composit 7.Other	1.Modern 4.Obsolete 7.	SQFT (Footprint) 0
2.Slate 5.Wood 8.	2.Typical 5. 8.	1.Poor 2.Avg 7.V G
3.Metal 6.Roll Roo 9.	3.Old Type 6. 9.None	2.Fair 3.Avg 8.Exc
SF Masonry Trim 0	# Rooms 0	3.Avg- 4.Good 9.Same
SOLAR VOLTAIC 0	# Bedrooms 0	Phys. % Good 0%
OPEN-4- 0	# Full Baths 0	Funct. % Good 100%
Year Built 0	# Half Baths 0	Functional Code 9 None
Year Remodeled 0	# Addn Fixtures 0	1.Incomp 4.Delap 5.Layoff
Foundation 0	# Fireplaces 0	2.O-Built 5.Bsmt 6.Long term
1.Concrete 4.Wood 7.		3.Damage 6.Style
2.C Block 5.Slab 8.		Econ. % Good 100%
3.Br/Stone 6.Piers 9.		Economic Code None
Basement 0		0.None 3.No Power 6.Obsolete
1.1/4 Bmt 4.Full Bmt 7.		1.Location 4.Generate 9.None
2.1/2 Bmt 5.Crwl 8.		2.Encroach 5.Flood Pl 9.
3.3/4 Bmt 6. 9.None		Entrance Code 5 Estimated
Bsmt Gar # Cars 0		1.Interior 4.Vacant 7.
Wet Basement 0		2.Refusal 5.Estimate 8.
1.Dry 4. 7.		3.Informed 6. 9.
2.Damp 5. 8.		Information Code 5 Estimate
3.Wet 6. 9.		1.Owner 4.Agent 7.
		2.Relative 5.Estimate 8.
		3.Tenant 6.Other 9.

Date Inspected 5/15/2024

Additions, Outbuildings & Improvements

Type	Year	Units	Grade	Cond	Phys.	Funct.	Sound Value
998 14Mobile Home	1999	14x76	4 100	4	0 %	100 %	1.One Story Fram 2.Two Story Fram 3.Three Story Fr
68 Wood Deck	0	120	3 100	4	0 %	100 %	4.1 & 1/2 Story 5.1 & 3/4 Story
24 Frame Shed	2016	96	3 100	4	0 %	100 %	6.2 & 1/2 Story 21.Open Frame Por
68 Wood Deck	2022	160	3 100	4	0 %	100 %	22.Encl Frame Por 23.Frame Garage
					%	%	24.Frame Shed
					%	%	25.Frame Bay Wind
					%	%	26.1SFr Overhang
					%	%	27.Unfin Basement
					%	%	28.Unfinished Att
					%	%	29.Finished Attic

