

ROGERS, CYNTHIA
PO BOX 185
GRAY ME 04039

B37741P45 B37741P50 B37741P55

Previous Owner
DURGIN, DAVID, DENNIS & GEORGE
ROGERS, CYNTHIA
PO BOX 185
GRAY ME 04039
Sale Date: 1/26/2021

Property Data			Assessment Record				
Neighborhood	5 Little Sebago		Year	Land	Buildings	Exempt	Total
Tree Growth Year	0		2012	4,169	0	0	4,169
REVIEW	0		2013	4,169	0	0	4,169
Building Permit	0		2014	4,067	0	0	4,067
Zone/Land Use	23 Lake District		2015	4,300	0	0	4,300
Secondary Zone	12 Limited Res		2016	4,200	0	0	4,200
Topography	2 Rolling		2017	5,700	0	0	5,700
			2018	5,700	0	0	5,700
			2019	6,800	0	0	6,800
			2020	6,800	0	0	6,800
			2021	252,200	0	0	252,200
			2022	197,600	0	0	197,600
			2023	197,600	0	0	197,600
			Calc.	4,700	0	0	4,700

Land Data		Front Foot		Effective		Influence		Influence Codes
Type		Frontage	Depth	Factor	Code			
1. Water (0-200)				%				1.Unimproved
2. Water (201-400)				%				2.Excess Frtg
3. Water (401-800)				%				3.Topography
4. Water (801-160)				%				4.Size/Shape
5. Water (1601-32)				%				5.Access
				%				6.Restriction
				%				7.Open Space
				%				8.Environmental
				%				9.Condo
				%				30.Blueberry(1-20
				%				31.Blueberry(21 -
				%				32.Crop Land
				%				33.Pasture
				%				34.Shorefront B
				%				35.Shorefront C
				%				36.ANTENNA SITE
				%				37.Softwood TG
				%				38.Mixed Wood TG
				%				39.Hardwood TG
				%				40.Wasteland
				%				41.Woodland
				%				42.Mobile Home Si
				%				43.Camp Site
				%				44.Lot Improvemen
				%				45.BA SF - Oce
				%				46.SP Meadow Cond
Total Acreage		10.36						

Inspection Witnessed By:

X	Date

Notes:
11/4/2020 - 1.84 acres to 025-306-016-001 Acct# 5057.
1/26/2021 - 1.84 acres to 025-306-016-002 Acct# 5070.
3/29/2022 - B39297P187 - .02 Acres Transferred to 025-306-017-000.

Gray

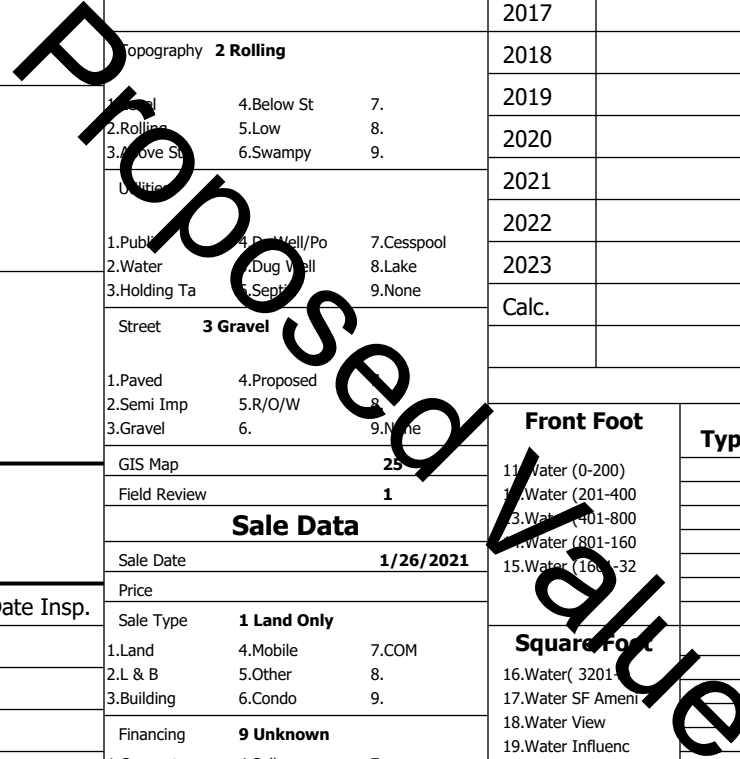

Gray

Map Lot 025-306-016-000

Account 3657

Location LAKE GROVE SPRINGS

Card 1

Of 1

8/05/2024

Building Style 0	SF Bsmt Living 0	Layout 0
1.Conv. 5.Garrison 9.NE farm	Fin Bsmt Grade 0 0	1.Typical 4. 7.
2.Ranch 6.Split 10.Colonia	Secondary Heat 0	2.Inadeq 5. 8.
3.R Ranch/ 7.Contemp 11.Cottage	Heat Type 100% 0	3. 6. 9.
4.Cape 8.Log 12.Gambrel	1.HWBB 5.FWA 9.None	Attic 0
Dwelling Units 0	2.HWCI 6.Monitor 10.UNH2F	1.1/4 Fin 4.Full Fin 7.
Other Units 0	3.HWRF 7.Electric 11.Geother	2.1/2 Fin 5.FI/Stair 8.
Stories 0	4.Steam 8.FI/Wall 12.Heat/Co	3.3/4 Fin 6. 9.None
1.1 4.1.5 7.	Cool Type 0% 9 None	Insulation 0
2.2 5.1.75 8.	1.Central 4.W&C Air 7.	1.Full 4.Minimal 7.
3.3 6.2.5 9.	2.Evapor 5. 8.	2.Heavy 5. 8.
Exterior Walls 0	3.H Pump 6. 9.None	3.Capped 6. 9.None
1.Clapboar 5.Stucco 9.B & B	Kitchen Style 0	Unfinished % 0%
2.Vin/Al 6.Brick 10.Cemplan	1.Modern 4.Obsolete	Grade & Factor 0 0%
3.Compos./ 7.Stone 11.Concret	2.Typical 5. 8.	1.E Grade 4.B Grade 7.SC Grade
4.Asbestos 8.Wood Shi 12.Wood Bo	3.Old Type 6. 9.None	2.C Grade 5.A Grade 8.
Roof Surface 0	Bath(s) Style 0	3.D Grade 6.AA Grade 9.Same
1.Asphalt 4.Composit 7.Other	1.Modern 4.Obsolete 7.	SQFT (Footprint) 0
2.Slate 5.Wood 8.	2.Typical 5. 8.	1.Poor Avg 7.V G
3.Metal 6.Roll Roo 9.	3.Old Type 6. 9.None	2.Fair Avg 8.Exc
SF Masonry Trim 0	# Rooms 0	3.Avg- Good 9.Same
SOLAR VOLTAIC 0	# Bedrooms 0	Phys. % Good 0%
OPEN-4- 0	# Full Baths 0	Funct. % Good 100%
Year Built 0	# Half Baths 0	Functional Code 9 None
Year Remodeled 0	# Addn Fixtures 0	1.Incomp 4.Delap 7.Layoff
Foundation 0	# Fireplaces 0	2.O-Built 5.Bsmt 8.Long term
1.Concrete 4.Wood 7.		3.Damage 6.Style None
2.C Block 5.Slab 8.		Econ. % Good 100%
3.Br/Stone 6.Piers 9.		Economic Code None
Basement 0		0.None 3.No Power 6.Obsolete
1.1/4 Bmt 4.Full Bmt 7.		1.Location 4.Generate 9.None
2.1/2 Bmt 5.Crwl 8.		2.Encroach 5.Flood Pl 9.
3.3/4 Bmt 6. 9.None		Entrance Code 0
Bsmt Gar # Cars 0		1.Interior 4.Vacant 7.
Wet Basement 0		2.Refusal 5.Estimate 8.
1.Dry 4. 7.		3.Informed 6. 9.
2.Damp 5. 8.	Information Code 0	
3.Wet 6. 9.	1.Owner 4.Agent 7.	
	2.Relative 5.Estimate 8.	
	3.Tenant 6.Other 9.	

Date Inspected 8/26/2015

Additions, Outbuildings & Improvements

Type	Year	Units	Grade	Cond	Phys.	Funct.	Sound Value
					%	%	1.One Story Fram
					%	%	2.Two Story Fram
					%	%	3.Three Story Fr
					%	%	4.1 & 1/2 Story
					%	%	5.1 & 3/4 Story
					%	%	6.2 & 1/2 Story
					%	%	21.Open Frame Por
					%	%	22.Encl Frame Por
					%	%	23.Frame Garage
					%	%	24.Frame Shed
					%	%	25.Frame Bay Wind
					%	%	26.1SFr Overhang
					%	%	27.Unfin Basement
					%	%	28.Unfinished Att
					%	%	29.Finished Attic

Proposed Value