

LACLAIRE, LEIGHTON T
DIX, DIANE L
600 BAY ROAD
AMHERST MA 01002

B33795P135

Previous Owner
HUTCHISON, JOANNE B
PO BOX 104

NEW GLOUCESTER ME 04260
Sale Date: 1/31/2017

Property Data			Assessment Record				
Neighborhood	5 Little Sebago		Year	Land	Buildings	Exempt	Total
Tree Growth Year	0		2011	124,230	14,748	0	138,978
REVIEW	0		2012	124,230	14,748	0	138,978
Building Permit	0		2013	124,230	14,748	0	138,978
Zone/Land Use	12 Limited Residential		2014	124,230	14,748	0	138,978
Secondary Zone			2015	124,200	14,700	0	138,900
			2016	124,200	14,700	0	138,900
Topography	2 Rolling		2017	124,200	14,700	0	138,900
			2018	124,200	14,700	0	138,900
			2019	243,700	34,600	0	278,300
			2020	243,700	34,600	0	278,300
			2021	243,700	34,600	0	278,300
			2022	243,700	34,600	0	278,300
			2023	243,700	44,200	0	287,900
			Calc.	487,300	50,800	0	538,100

Land Data		Front Foot		Effective		Influence		Influence Codes
Type	Code	Frontage	Depth	Factor	Code	Factor	Code	
11	100	100	000	100	%	0	0	1.Unimproved
					%			2.Excess Frtg
					%			3.Topography
					%			4.Size/Shape
					%			5.Access
					%			6.Restriction
					%			7.Open Space
					%			8.Environmental
					%			9.Condo
					%			30.Blueberry(1-20
					%			31.Blueberry(21 -
					%			32.Crop Land
					%			33.Pasture
					%			34.Shorefront B
					%			35.Shorefront C
					%			36.ANTENNA SITE
					%			37.Softwood TG
					%			38.Mixed Wood TG
					%			39.Hardwood TG
					%			40.Wasteland
					%			41.Woodland
					%			42.Mobile Home Si
					%			43.Camp Site
					%			44.Lot Improvemen
					%			45.BA SF - Oce
					%			46.SP Meadow Cond
Total Acreage		0.26						

Inspection Witnessed By:

X	Date
No./Date	Description
	Date Insp.

Notes:

Gray

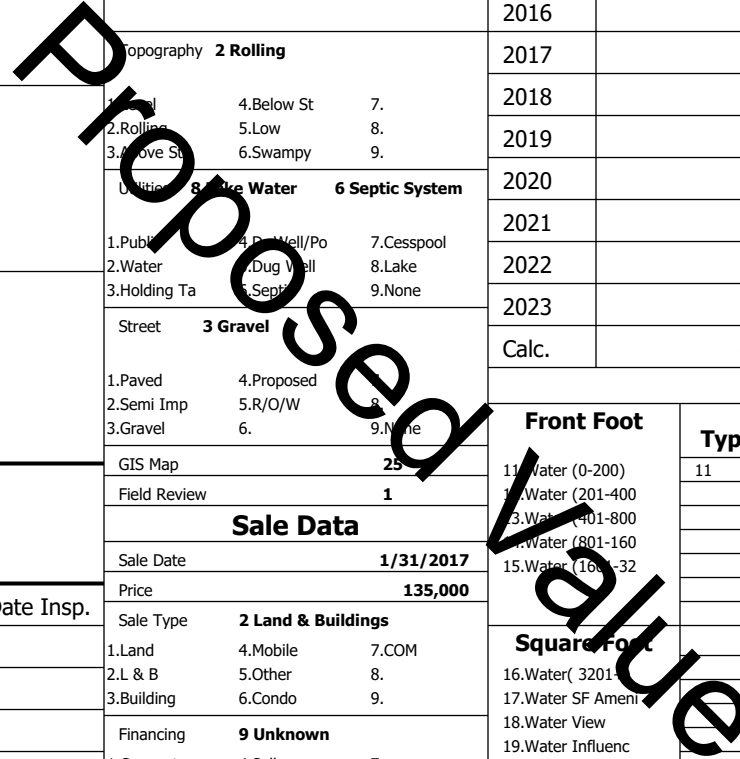

Gray

Map Lot 025-306-009-000

Account 3652

Location 26 LOON LN

Card 1

Of 1

8/05/2024

Building Style 11 Cottage/Camp	SF Bsmt Living 0	Layout 1 Typical
1.Conv. 5.Garrison 9.NE farm	Fin Bsmt Grade 0 0	1.Typical 4. 7.
2.Ranch 6.Split 10.Colonia	Secondary Heat 0	2.Inadeq 5. 8.
3.R Ranch/ 7.Contemp 11.Cottage	Heat Type 100% 9 Not Heated - Entire	3. 6. 9.
4.Cape 8.Log 12.Gambrel	1.HWBB 5.FWA Dwelling 9.None	Attic 5 Floor & Stairs
Dwelling Units 1	2.HWCI 6.Monitor 10.UNH2F	1.1/4 Fin 4.Full Fin 7.
Other Units 0	3.HWRF 7.Electric 11.Geother	2.1/2 Fin 5.FI/Stair 8.
Stories 1 One Story	4.Steam 8.FI/Wall 12.Heat/Co	3.3/4 Fin 6. 9.None
1.1 4.1.5 7.	Cool Type 0% 9 None	Insulation 9 None
2.2 5.1.75 8.	1.Central 4.W&C Air 7.	1.Full 4.Minimal 7.
3.3 6.2.5 9.	2.Evapor 5. 8.	2.Heavy 5. 8.
Exterior Walls 3 Composition/	3.H Pump 6. 9.None	3.Capped 6. 9.None
1.Clapboar 5.Stucco 9.B & B	Kitchen Style 3 Old Style	Unfinished % 0%
2.Vin/Al 6.Brick 10.Cemplan	1.Modern 4.Obsolete	Grade & Factor 2 Fair 100%
3.Compos./ 7.Stone 11.Concret	2.Typical 5. 8.	1.E Grade 4.B Grade 7.SC Grade
4.Asbestos 8.Wood Shi 12.Wood Bo	3.Old Type 6. 9.None	2.C Grade 5.A Grade 8.
Roof Surface 3 Metal	Bath(s) Style 3 Old Style	3.Grade 6.AA Grade 9.Same
1.Asphalt 4.Composit 7.Other	1.Modern 4.Obsolete 7.	SQFT (Footprint) 398
2.Slate 5.Wood 8.	2.Typical 5. 8.	Condition Average
3.Metal 6.Roll Roo 9.	3.Old Type 6. 9.None	1.Poor 2.Avg 7.V G
SF Masonry Trim 0	# Rooms 3	2.Fair 3.Avg 8.Exc
SOLAR VOLTAIC 0	# Bedrooms 1	3.Avg- 4.Good 9.Same
OPEN-4- 0	# Full Baths 1	Phys. % Good 0%
Year Built 1960	# Half Baths 0	Funct. % Good 100%
Year Remodeled 0	# Addn Fixtures 0	Functional Code 9 None
Foundation 6 Piers	# Fireplaces 0	1.Incomp 4.Delap 5.Delay
1.Concrete 4.Wood 7.		2.O-Built 5.Bsmt 6.Long term
2.C Block 5.Slab 8.		3.Damage 6.Style 9.None
3.Br/Stone 6.Piers 9.		Econ. % Good 100%
Basement 9 No Basement		Economic Code None
1.1/4 Bmt 4.Full Bmt 7.		0.None 3.No Power 6.Obsolete
2.1/2 Bmt 5.Crwl 8.		1.Location 4.Generate 9.None
3.3/4 Bmt 6. 9.None		2.Encroach 5.Flood Pl 9.
Bsmt Gar # Cars 0		Entrance Code 0
Wet Basement 9 No Basement		1.Interior 4.Vacant 7.
1.Dry 4. 7.		2.Refusal 5.Estimate 8.
2.Damp 5. 8.	3.Informed 6. 9.	
3.Wet 6. 9.	Information Code 0	
	1.Owner 4.Agent 7.	
	2.Relative 5.Estimate 8.	
	3.Tenant 6.Other 9.	

Date Inspected 8/26/2015

Additions, Outbuildings & Improvements

Type	Year	Units	Grade	Cond	Phys.	Funct.	Sound Value
					%	%	1.One Story Fram
					%	%	2.Two Story Fram
					%	%	3.Three Story Fr
					%	%	4.1 & 1/2 Story
					%	%	5.1 & 3/4 Story
					%	%	6.2 & 1/2 Story
					%	%	21.Open Frame Por
					%	%	22.Encl Frame Por
					%	%	23.Frame Garage
					%	%	24.Frame Shed
					%	%	25.Frame Bay Wind
					%	%	26.1SFr Overhang
					%	%	27.Unfin Basement
					%	%	28.Unfinished Att
					%	%	29.Finished Attic

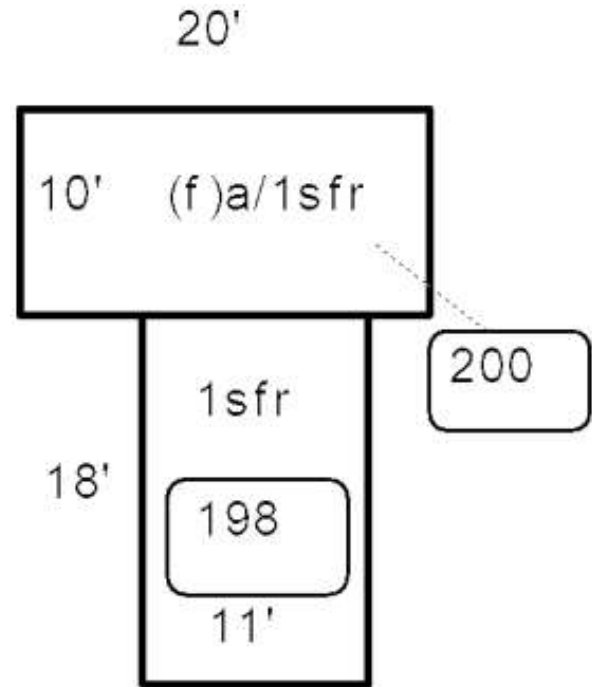

Value