

ASTLE, FREDRIC J
2 LANTERN LANE
CUMBERLAND FRSD ME 04110

B3129P26

| Property Data | | | Assessment Record | | | | |
|----------------------|-------------------------|-------------|---------------------------|----------------------|------------------|------------------|------------------|
| Neighborhood | 58 Little Sebago Lodges | | Year | Land | Buildings | Exempt | Total |
| Tree Growth Year | 0 | | 2011 | 125,984 | 59,048 | 0 | 185,032 |
| REVIEW | 0 | | 2012 | 125,984 | 59,048 | 0 | 185,032 |
| Building Permit | 0 | | 2013 | 125,984 | 59,048 | 0 | 185,032 |
| Zone/Land Use | 12 Limited Residential | | 2014 | 125,984 | 59,048 | 0 | 185,032 |
| Secondary Zone | | | 2015 | 126,000 | 59,000 | 0 | 185,000 |
| Topography | 1 Level | | 2016 | 126,000 | 59,000 | 0 | 185,000 |
| 1. Hill | 4. Below St | 7. | 2017 | 126,000 | 142,000 | 0 | 268,000 |
| 2. Rolling | 5. Low | 8. | 2018 | 194,000 | 203,500 | 0 | 397,500 |
| 3. Above St | 6. Swampy | 9. | 2019 | 194,000 | 203,500 | 0 | 397,500 |
| 1. Public Well/Point | 6 Septic System | | 2020 | 194,000 | 203,500 | 0 | 397,500 |
| 2. Water | 4. Dug Well/Po | 7. Cesspool | 2021 | 194,000 | 203,500 | 0 | 397,500 |
| 3. Holding Ta | 5. Septic | 8. Lake | 2022 | 194,000 | 203,500 | 0 | 397,500 |
| Street | 1 Paved | | 2023 | 194,000 | 243,000 | 0 | 437,000 |
| 1. Paved | 4. Proposed | 8. | Calc. | 388,000 | 399,300 | 0 | 787,300 |
| 2. Semi Imp | 5. R/O/W | 9. | Land Data | | | | |
| 3. Gravel | 6. | 9. None | Front Foot | Type | Effective | Influence | Influence |
| GIS Map | 24 | | 11. Water (0-200) | 11 | 075 | 000 | 95 % 6 |
| Field Review | 50 | | 12. Water (201-400) | | | | % |
| Sale Data | | | 13. Water (401-800) | | | | % |
| Sale Date | | | 14. Water (801-160) | | | | % |
| Price | | | 15. Water (161-32) | | | | % |
| Sale Type | | | Square Foot | Square Feet | | | |
| 1. Land | 4. Mobile | 7.COM | 16. Water (3201- | | | | % |
| 2. L & B | 5. Other | 8. | 17. Water SF Amen | | | | % |
| 3. Building | 6. Condo | 9. | 18. Water View | | | | % |
| Financing | | | 19. Water Influen | | | | % |
| 1. Convent | 4. Seller | 7. | 20. ShoreFront A | | | | % |
| 2. FHA/VA | 5. Private | 8. | Fract. Acre | Acreege/Sites | | | |
| 3. Assumed | 6. Cash | 9. Unknown | 21. Base Lot | 20 | | 0.21 | 95 % 6 |
| Validity | | | 22. Base Lot Vacan | | | | % |
| 1. Valid | 4. Split | 7. Multiple | 23. Base Lot Unpav | | | | % |
| 2. Related | 5. Partial | 8. Other | Acres | | | | % |
| 3. Distress | 6. Exempt | 9. Estate | 24. Acres to 10 | | | | % |
| Verified | | | 25. Acres 11-30 | | | | % |
| 1. Buyer | 4. Agent | 7. Family | 26. Acres 31-50 | | | | % |
| 2. Seller | 5. Pub Rec | 8. Other | 27. Acres 51& over | | | | % |
| 3. Lender | 6. MLS | 9. | 28. Acres 71 & Ove | | | | % |
| | | | 29. Woods (41+) | | | | % |
| | | | Total Acreege 0.21 | | | | |

Inspection Witnessed By:

| No./Date | Description | Date Insp. |
|----------|-------------|------------|
| X | | |

Notes:

Gray

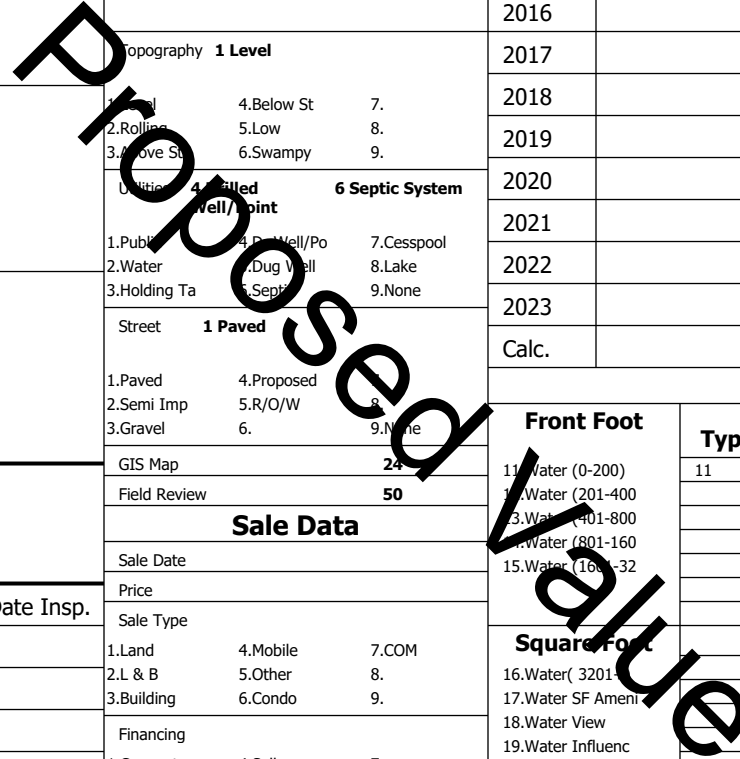

- 1. Unimproved
- 2. Excess Frtg
- 3. Topography
- 4. Size/Shape
- 5. Access
- 6. Restriction
- 7. Open Space
- 8. Environmental
- 9. Condo
- Acres**
- 30. Blueberry(1-20
- 31. Blueberry(21 -
- 32. Crop Land
- 33. Pasture
- 34. Shorefront B
- 35. Shorefront C
- 36. ANTENNA SITE
- 37. Softwood TG
- 38. Mixed Wood TG
- 39. Hardwood TG
- 40. Wasteland
- 41. Woodland
- 42. Mobile Home Si
- 43. Camp Site
- 44. Lot Improvemen
- 45. BA SF - Oce
- 46. SP Meadow Cond

