

CRAVER, DAVID A
CRAVER, JUDITH C
222 NORTH LASALLE ST
CHICAGO IL 60601

B23172P196

Property Data			Assessment Record						
Neighborhood 5 Little Sebago			Year	Land	Buildings	Exempt	Total		
Tree Growth Year 0			2011	140,792	322,670	0	463,462		
REVIEW 0			2012	140,792	322,670	0	463,462		
Building Permit 0			2013	140,792	322,670	0	463,462		
Zone/Land Use 12 Limited Residential			2014	140,792	322,670	0	463,462		
Secondary Zone			2015	140,800	322,700	0	463,500		
Topography 1 Level			2016	140,800	326,100	0	466,900		
1. Hill 4. Below St 7.			2017	140,800	326,100	0	466,900		
2. Rolling 5. Low 8.			2018	140,800	326,100	0	466,900		
3. Above St 6. Swampy 9.			2019	208,700	478,800	0	687,500		
4. Filled Well/Point 6 Septic System			2020	208,700	478,800	0	687,500		
1. Public 4. Dug Well/Po 7. Cesspool			2021	208,700	478,800	0	687,500		
2. Water 8. Lake			2022	208,700	488,000	0	696,700		
3. Holding Ta 9. None			2023	208,700	533,000	0	741,700		
Street 1 Paved			Calc.	417,400	803,100	0	1,220,500		
1. Paved 4. Proposed			Land Data						
2. Semi Imp 5. R/O/W			Front Foot	Type	Effective		Influence		Influence Codes
3. Gravel 6. None			11. Water (0-200)	11	Frontage	Depth	Factor	Code	
GIS Map 24			12. Water (201-400)				100 %	0	1. Unimproved
Field Review 50			13. Water (401-800)				%		2. Excess Frtg
Sale Data			14. Water (801-160)				%		3. Topography
Sale Date 9/19/2005			15. Water (161-32)				%		4. Size/Shape
Price 400,000			Square Foot				%		5. Access
Sale Type			16. Water (3201-)				%		6. Restriction
1. Land 4. Mobile 7. COM			17. Water SF Amen				%		7. Open Space
2. L & B 5. Other 8.			18. Water View				%		8. Environmental
3. Building 6. Condo 9.			19. Water Influen				%		9. Condo
Financing			20. ShoreFront A				%		Acres
1. Convent 4. Seller 7.			Fract. Acre				%		30. Blueberry(1-20
2. FHA/VA 5. Private 8.			21. Base Lot	20		0.34	100 %	0	31. Blueberry(21 -
3. Assumed 6. Cash 9. Unknown			22. Base Lot Vacan				%		32. Crop Land
Validity			23. Base Lot Unpav				%		33. Pasture
1. Valid 4. Split 7. Multiple			Acres				%		34. Shorefront B
2. Related 5. Partial 8. Other			24. Acres to 10				%		35. Shorefront C
3. Distress 6. Exempt 9. Estate			25. Acres 11-30				%		36. ANTENNA SITE
Verified			26. Acres 31-50				%		37. Softwood TG
1. Buyer 4. Agent 7. Family			27. Acres 51& over				%		38. Mixed Wood TG
2. Seller 5. Pub Rec 8. Other			28. Acres 71 & Ove				%		39. Hardwood TG
3. Lender 6. MLS 9.			29. Woods (41+)				%		40. Wasteland
			Total Acreage		0.34				41. Woodland

Inspection Witnessed By:

No./Date	Description	Date Insp.
X		

Notes:

Gray

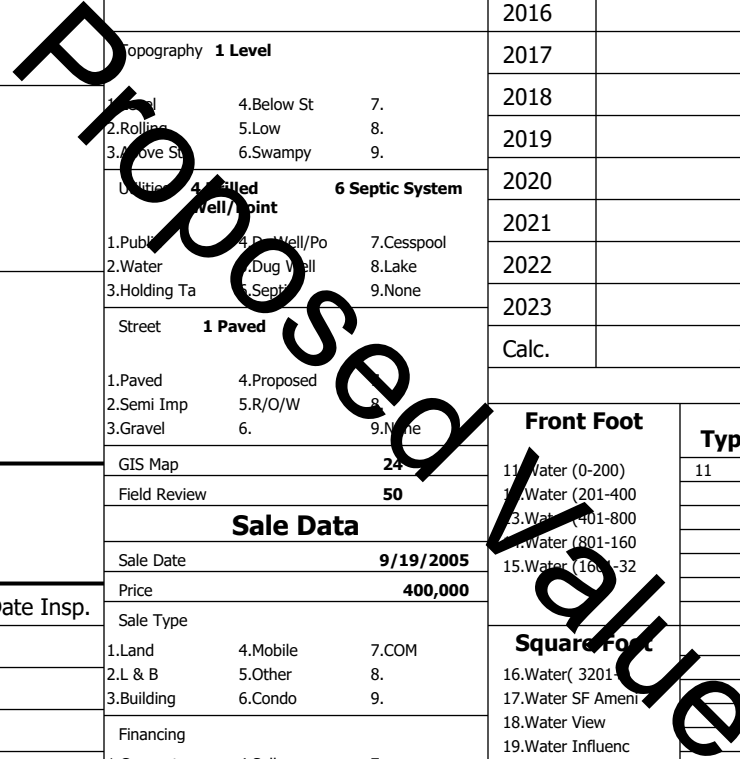

Gray

Map Lot 024-312-027-000

Account 3924

Location 5 HAYDEN LN

Card 1

Of 1

8/05/2024

Building Style 1 Conventional	SF Bsmt Living 1388	Layout 1 Typical
1.Conv. 5.Garrison 9.NE farm	Fin Bsmt Grade 4 100	1.Typical 4. 7.
2.Ranch 6.Split 10.Colonia	Secondary Heat 0	2.Inadeq 5. 8.
3.R Ranch/ 7.Contemp 11.Cottage	Heat Type 100% 3 Hot Water Radiant	3. 6. 9.
4.Cape 8.Log 12.Gambrel	1.HWBB 5.FWA Floor 9.None	Attic 9 None
Dwelling Units 1	2.HWCI 6.Monitor 10.UNH2F	1.1/4 Fin 4.Full Fin 7.
Other Units 0	3.HWRF 7.Electric 11.Geother	2.1/2 Fin 5.FI/Stair 8.
Stories 5 One & 3/4 Story	4.Steam 8.FI/Wall 12.Heat/Co	3.3/4 Fin 6. 9.None
1.1 4.1.5 7.	Cool Type 0% 4 Warm & Cool Air	Insulation 1 Full
2.2 5.1.75 8.	1.Central 4.W&C Air 7.	1.Full 4.Minimal 7.
3.3 6.2.5 9.	2.Evapor 5. 8.	2.Heavy 5. 8.
Exterior Walls 8 Wood Shingle	3.H Pump 6. 9.None	3.Capped 6. 9.None
1.Clapboar 5.Stucco 9.B & B	Kitchen Style 2 Typical	Unfinished % 0%
2.Vin/Al 6.Brick 10.Cemplan	1.Modern 4.Obsolete	Grade & Factor 5 Very Good 100%
3.Compos./ 7.Stone 11.Concret	2.Typical 5. 8.	1.E Grade 4.B Grade 7.SC Grade
4.Asbestos 8.Wood Shi 12.Wood Bo	3.Old Type 6. 9.None	2.O Grade 5.A Grade 8.
Roof Surface 1 Asphalt Shingles	Bath(s) Style 2 Typical Bath(s)	3.O Grade 6.AA Grade 9.Same
1.Asphalt 4.Composit 7.Other	1.Modern 4.Obsolete 7.	SQFT (Footprint) 1664
2.Slate 5.Wood 8.	2.Typical 5. 8.	Condition 5 Good
3.Metal 6.Roll Roo 9.	3.Old Type 6. 9.None	1.Poor 2.Avg 7.V G
SF Masonry Trim 0	# Rooms 8	2.Fair 3.Good 8.Exc
SOLAR VOLTAIC 0	# Bedrooms 4	3.Avg- 4.Good 9.Same
OPEN-4- 0	# Full Baths 4	Phys. % Good 0%
Year Built 2007	# Half Baths 1	Funct. % Good 100%
Year Remodeled 0	# Addn Fixtures 2	Functional Code 9 None
Foundation 1 Concrete	# Fireplaces 2	1.Incomp 4.Delap 5.Playo
1.Concrete 4.Wood 7.		2.O-Built 5.Bsmt 6.Long term
2.C Block 5.Slab 8.		3.Damage 6.Style 7.None
3.Br/Stone 6.Piers 9.		Econ. % Good 100%
Basement 4 Full Basement		Economic Code None
1.1/4 Bmt 4.Full Bmt 7.		0.None 3.No Power 6.Obsolete
2.1/2 Bmt 5.Crw1 8.		1.Location 4.Generate 9.None
3.3/4 Bmt 6. 9.None		2.Encroach 5.Flood Pl 9.
Bsmt Gar # Cars 0		Entrance Code 3 Information Only
Wet Basement 1 Dry Basement		1.Interior 4.Vacant 7.
1.Dry 4. 7.		2.Refusal 5.Estimate 8.
2.Damp 5. 8.		3.Informed 6. 9.
3.Wet 6. 9.		Information Code 1 Owner
		1.Owner 4.Agent 7.
		2.Relative 5.Estimate 8.
		3.Tenant 6.Other 9.

Date Inspected 8/04/2015

Additions, Outbuildings & Improvements

Type	Year	Units	Grade	Cond	Phys.	Funct.	Sound Value
23 Frame Garage	0	140	0 0	0	0	100 %	
21 Open Frame	0	60	0 0	0	0	100 %	
68 Wood Deck	0	492	0 0	0	0	100 %	
21 Open Frame	0	216	0 0	0	0	100 %	
62 Patio	0	708	0 0	0	0	100 %	
90 Generator	0	1	0 0	0	0	100 %	
68 Wood Deck	0	24	0 0	0	0	100 %	
23 Frame Garage	0	224	0 0	0	0	100 %	
81 1 St/Garage	0	224	0 0	0	0	100 %	

