

BURKE, J DOUGLAS  
51 BIRDSONG WAY, APT 208A  
HILTON HEAD SC 29926

B35095P25  
Previous Owner  
BURKE, JANICE F  
PERSONAL RESIDENCE TRUST  
51 BIRDSONG WAY, APT A208  
HILTON HEAD ISLAND SC 29926  
Sale Date: 8/24/2018

Inspection Witnessed By:

No./Date	Description	Date Insp.
X		

Notes:

Gray

Property Data			Assessment Record						
Neighborhood <b>5 Little Sebago</b>			Year	Land	Buildings	Exempt	Total		
Tree Growth Year <b>0</b>			2011	100	500	0	600		
REVIEW <b>0</b>			2012	100	500	0	600		
Building Permit <b>0</b>			2013	100	500	0	600		
Zone/Land Use <b>12 Limited Residential</b>			2014	100	500	0	600		
Secondary Zone			2015	100	500	0	600		
Topography <b>1 Level</b>			2016	100	500	0	600		
1. Above St 2. Rolling 3. Above St			2017	100	500	0	600		
4. Below St 5. Low 6. Swampy			2018	100	500	0	600		
7. Ditch			2019	200	1,000	0	1,200		
1. Public 2. Water 3. Holding Ta			2020	200	1,000	0	1,200		
4. Drilling/Po 5. Dug Well 6. Septic			2021	200	1,000	0	1,200		
7. Cesspool 8. Lake 9. None			2022	200	1,000	0	1,200		
Street <b>3 Gravel</b>			2023	200	1,000	0	1,200		
1. Paved 2. Semi Imp 3. Gravel			Calc.	500	1,600	0	2,100		
4. Proposed 5. R/O/W 6. None			<b>Land Data</b>						
GIS Map <b>24</b>			<b>Front Foot</b>	<b>Type</b>	<b>Effective</b>		<b>Influence</b>		<b>Influence Codes</b>
Field Review <b>0</b>					<b>Frontage</b>	<b>Depth</b>	<b>Factor</b>	<b>Code</b>	
<b>Sale Data</b>			11. Water (0-200)			%		1. Unimproved	
Sale Date <b>8/24/2018</b>			12. Water (201-400)			%		2. Excess Frtg	
Price			13. Water (401-800)			%		3. Topography	
Sale Type <b>2 Land &amp; Buildings</b>			14. Water (801-160)			%		4. Size/Shape	
1. Land 2. L & B 3. Building			15. Water (161-320)			%		5. Access	
4. Mobile 5. Other 6. Condo 7. COM 8. 9.			<b>Square Foot</b>			%		6. Restriction	
Financing <b>9 Unknown</b>			<b>Square Feet</b>			%		7. Open Space	
1. Convent 2. FHA/VA 3. Assumed			16. Water ( 3201-6400)			%		8. Environmental	
4. Seller 5. Private 6. Cash 7. 8. 9. Unknown			17. Water SF Amen			%		9. Condo	
Validity <b>2 Related Parties</b>			18. Water View			%		<b>Acres</b>	
1. Valid 2. Related 3. Distress			19. Water Influen			%		30. Blueberry(1-20	
4. Split 5. Partial 6. Exempt 7. Multiple 8. Other 9. Estate			20. ShoreFront A			%		31. Blueberry(21 -	
Verified <b>5 Public Record</b>			<b>Fract. Acre</b>			%		32. Crop Land	
1. Buyer 2. Seller 3. Lender			21. Base Lot	24	0.08	100	0	33. Pasture	
4. Agent 5. Pub Rec 6. MLS 7. Family 8. Other 9.			22. Base Lot Vacan			%		34. Shorefront B	
			23. Base Lot Unpav			%		35. Shorefront C	
			<b>Acres</b>			%		36. ANTENNA SITE	
			24. Acres to 10			%		37. Softwood TG	
			25. Acres 11-30			%		38. Mixed Wood TG	
			26. Acres 31-50			%		39. Hardwood TG	
			27. Acres 51& over			%		40. Wasteland	
			28. Acres 71 & Ove			%		41. Woodland	
			29. Woods (41+)			%		42. Mobile Home Si	
			<b>Total Acreage</b>	<b>0.08</b>				43. Camp Site	
								44. Lot Improvemen	
								45. BA SF - Oce	
								46. SP Meadow Cond	

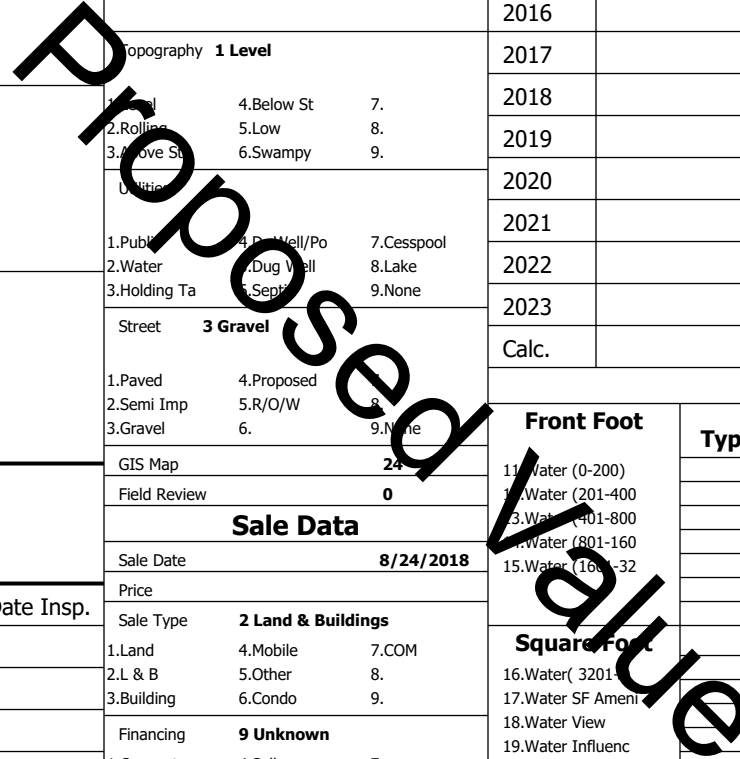

**Gray**

Map Lot 024-311-007-000

Account 3867

Location WESTWOOD RD

Card 1

Of 1

8/05/2024

Building Style <b>0</b>	SF Bsmt Living <b>0</b>	Layout <b>0</b>
1.Conv. 5.Garrison 9.NE farm	Fin Bsmt Grade <b>0 0</b>	1.Typical 4. 7.
2.Ranch 6.Split 10.Colonia	Secondary Heat <b>0</b>	2.Inadeq 5. 8.
3.R Ranch/ 7.Contemp 11.Cottage	Heat Type <b>100% 0</b>	3. 6. 9.
4.Cape 8.Log 12.Gambrel	1.HWBB 5.FWA 9.None	Attic <b>0</b>
Dwelling Units <b>0</b>	2.HWCI 6.Monitor 10.UNH2F	1.1/4 Fin 4.Full Fin 7.
Other Units <b>0</b>	3.HWRF 7.Electric 11.Geother	2.1/2 Fin 5.FI/Stair 8.
Stories <b>0</b>	4.Steam 8.FI/Wall 12.Heat/Co	3.3/4 Fin 6. 9.None
1.1 4.1.5 7.	Cool Type <b>0% 9 None</b>	Insulation <b>0</b>
2.2 5.1.75 8.	1.Central 4.W&C Air 7.	1.Full 4.Minimal 7.
3.3 6.2.5 9.	2.Evapor 5. 8.	2.Heavy 5. 8.
Exterior Walls <b>0</b>	3.H Pump 6. 9.None	3.Capped 6. 9.None
1.Clapboar 5.Stucco 9.B & B	Kitchen Style <b>0</b>	Unfinished % <b>0%</b>
2.Vin/Al 6.Brick 10.Cemplan	1.Modern 4.Obsolete	Grade & Factor <b>0 0%</b>
3.Compos./ 7.Stone 11.Concret	2.Typical 5. 8.	1.E Grade 4.B Grade 7.SC Grade
4.Asbestos 8.Wood Shi 12.Wood Bo	3.Old Type 6. 9.None	2.C Grade 5.A Grade 8.
Roof Surface <b>0</b>	Bath(s) Style <b>0</b>	3.D Grade 6.AA Grade 9.Same
1.Asphalt 4.Composit 7.Other	1.Modern 4.Obsolete 7.	SQFT (Footprint) <b>0</b>
2.Slate 5.Wood 8.	2.Typical 5. 8.	1.Poor Avg 7.V G
3.Metal 6.Roll Roo 9.	3.Old Type 6. 9.None	2.Fair Avg 8.Exc
SF Masonry Trim <b>0</b>	# Rooms <b>0</b>	3.Avg- Good 9.Same
SOLAR VOLTAIC <b>0</b>	# Bedrooms <b>0</b>	Phys. % Good <b>0%</b>
OPEN-4- <b>0</b>	# Full Baths <b>0</b>	Funct. % Good <b>100%</b>
Year Built <b>0</b>	# Half Baths <b>0</b>	Functional Code <b>9 None</b>
Year Remodeled <b>0</b>	# Addn Fixtures <b>0</b>	1.Incomp 4.Delap 5.Layoff
Foundation <b>0</b>	# Fireplaces <b>0</b>	2.O-Built 5.Bsmt 6.Long term
1.Concrete 4.Wood 7.		3.Damage 6.Style None
2.C Block 5.Slab 8.		Econ. % Good <b>100%</b>
3.Br/Stone 6.Piers 9.		Economic Code <b>None</b>
Basement <b>0</b>		0.None 3.No Power 6.Obsolete
1.1/4 Bmt 4.Full Bmt 7.		1.Location 4.Generate 9.None
2.1/2 Bmt 5.Crwl 8.		2.Encroach 5.Flood Pl 9.
3.3/4 Bmt 6. 9.None		Entrance Code <b>5 Estimated</b>
Bsmt Gar # Cars <b>0</b>		1.Interior 4.Vacant 7.
Wet Basement <b>0</b>		2.Refusal 5.Estimate 8.
1.Dry 4. 7.		3.Informed 6. 9.
2.Damp 5. 8.	Information Code <b>5 Estimate</b>	
3.Wet 6. 9.	1.Owner 4.Agent 7.	
	2.Relative 5.Estimate 8.	
	3.Tenant 6.Other 9.	

Date Inspected 7/30/2015

**Additions, Outbuildings & Improvements**

Type	Year	Units	Grade	Cond	Phys.	Funct.	Sound Value
24 Frame Shed	1970	180	2 100	4	0 %	100 %	
					%	%	1.One Story Fram
					%	%	2.Two Story Fram
					%	%	3.Three Story Fr
					%	%	4.1 & 1/2 Story
					%	%	5.1 & 3/4 Story
					%	%	6.2 & 1/2 Story
					%	%	21.Open Frame Por
					%	%	22.Encl Frame Por
					%	%	23.Frame Garage
					%	%	24.Frame Shed
					%	%	25.Frame Bay Wind
					%	%	26.1SFr Overhang
					%	%	27.Unfin Basement
					%	%	28.Unfinished Att
					%	%	29.Finished Attic

