

RICHARD, MELANIE L  
112 GORE RD.  
RAYMOND ME 04071

B32241P69

Property Data			Assessment Record					
Neighborhood	82 Average Location		Year	Land	Buildings	Exempt	Total	
Tree Growth Year	0		2011	56,500	144,394	8,500	192,394	
REVIEW	0		2012	56,500	144,394	8,500	192,394	
Building Permit	0		2013	56,500	144,394	8,500	192,394	
Zone/Land Use	23 Lake District		2014	56,500	144,394	8,500	192,394	
Secondary Zone			2015	56,500	144,400	9,000	191,900	
Topography			2016	56,500	144,400	9,000	191,900	
1. Hill	4. Below St	7.	2017	56,500	144,400	0	200,900	
2. Rolling	5. Low	8.	2018	56,500	144,400	0	200,900	
3. Above St	6. Swampy	9.	2019	70,200	185,000	0	255,200	
Utilities	4. Filled Well/Point 6 Septic System		2020	70,200	185,000	0	255,200	
1. Public	4. Dug Well/Po	7. Cesspool	2021	70,200	185,000	0	255,200	
2. Water	8. Lake	8. Lake	2022	70,200	185,000	0	255,200	
3. Holding Ta	9. None	9. None	2023	70,200	210,900	0	281,100	
Street	1 Paved		Calc.	125,400	319,600	25,000	420,000	
1. Paved	4. Proposed	8.	<b>Land Data</b>					
2. Semi Imp	5. R/O/W	9.	<b>Front Foot</b>	<b>Type</b>	<b>Effective</b>	<b>Influence</b>	<b>Influence Codes</b>	
3. Gravel	6.	9. None	11. Water (0-200)		<b>Frontage</b>	<b>Depth</b>	<b>Factor</b>	<b>Code</b>
GIS Map	24		12. Water (201-400)				%	1. Unimproved
Field Review	50		13. Water (401-800)				%	2. Excess Frtg
<b>Sale Data</b>			14. Water (801-160)				%	3. Topography
Sale Date	1/14/2008		15. Water (161-32)				%	4. Size/Shape
Price			16. Water (3201-)				%	5. Access
Sale Type			17. Water SF Amen				%	6. Restriction
1. Land	4. Mobile	7. COM	18. Water View				%	7. Open Space
2. L & B	5. Other	8.	19. Water Influen				%	8. Environmental
3. Building	6. Condo	9.	20. ShoreFront A				%	9. Condo
Financing			<b>Square Foot</b>	<b>Square Feet</b>			%	<b>Acres</b>
1. Convent	4. Seller	7.	16. Water (3201-)				%	30. Blueberry(1-20
2. FHA/VA	5. Private	8.	17. Water SF Amen				%	31. Blueberry(21 -
3. Assumed	6. Cash	9. Unknown	18. Water View				%	32. Crop Land
Validity			19. Water Influen				%	33. Pasture
1. Valid	4. Split	7. Multiple	20. ShoreFront A				%	34. Shorefront B
2. Related	5. Partial	8. Other	<b>Fract. Acre</b>				%	35. Shorefront C
3. Distress	6. Exempt	9. Estate	21. Base Lot	21	1.84	100	%	0
Verified			22. Base Lot Vacan	24	0.06	100	%	0
1. Buyer	4. Agent	7. Family	23. Base Lot Unpav				%	
2. Seller	5. Pub Rec	8. Other	<b>Acres</b>				%	
3. Lender	6. MLS	9.	24. Acres to 10				%	
			25. Acres 11-30				%	
			26. Acres 31-50				%	
			27. Acres 51& over				%	
			28. Acres 71 & Ove				%	
			29. Woods (41+)				%	
				<b>Total Acreage</b>	1.90			

Inspection Witnessed By:

X	Date	Date Insp.
No./Date	Description	Date Insp.

Notes:  
2/14/2023 - Owner's name changed from Melanie Feigofsky to Melanie Richard per Divorce Decree.

Gray

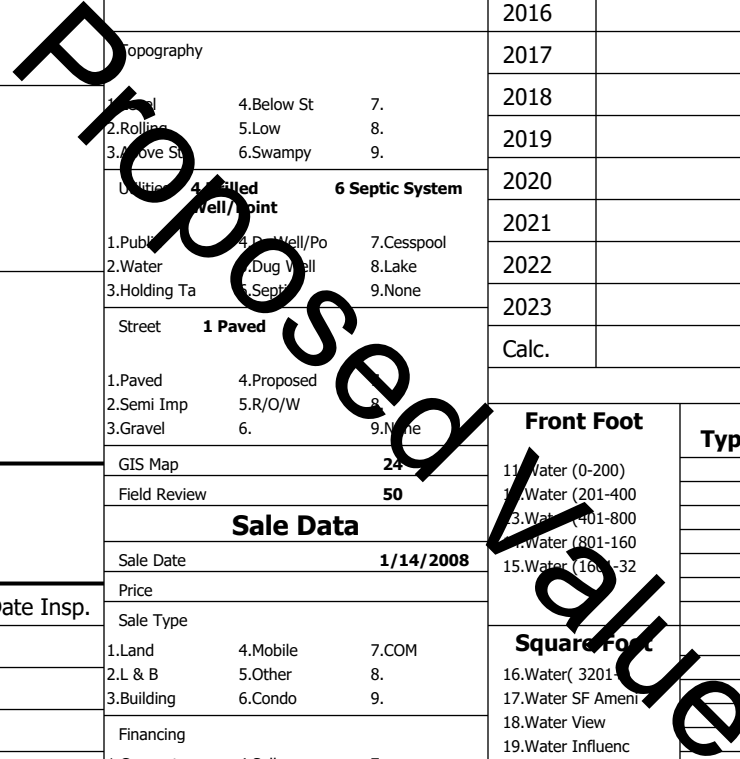

46.SP Meadow Cond

**Gray**

Map Lot 024-002-015-000

Account 23

Location 112 GORE RD

Card 1

Of 1

8/05/2024

Building Style <b>4 Cape Cod</b>	SF Bsmt Living <b>0</b>	Layout <b>1 Typical</b>
1.Conv. 5.Garrison 9.NE farm	Fin Bsmt Grade <b>0 0</b>	1.Typical 4. 7.
2.Ranch 6.Split 10.Colonia	Secondary Heat <b>0</b>	2.Inadeq 5. 8.
3.R Ranch/ 7.Contemp 11.Cottage	Heat Type <b>100% 1 Hot Water BB</b>	3. 6. 9.
4.Cape 8.Log 12.Gambrel	1.HWBB 5.FWA 9.None	Attic <b>9 None</b>
Dwelling Units <b>1</b>	2.HWCI 6.Monitor 10.UNH2F	1.1/4 Fin 4.Full Fin 7.
Other Units <b>0</b>	3.HWRF 7.Electric 11.Geother	2.1/2 Fin 5.FI/Stair 8.
Stories <b>5 One &amp; 3/4 Story</b>	4.Steam 8.FI/Wall 12.Heat/Co	3.3/4 Fin 6. 9.None
1.1 4.1.5 7.	Cool Type <b>0% 9 None</b>	Insulation <b>1 Full</b>
2.2 5.1.75 8.	1.Central 4.W&C Air 7.	1.Full 4.Minimal 7.
3.3 6.2.5 9.	2.Evapor 5. 8.	2.Heavy 5. 8.
Exterior Walls <b>8 Wood Shingle</b>	3.H Pump 6. 9.None	3.Capped 6. 9.None
1.Clapboar 5.Stucco 9.B & B	Kitchen Style <b>2 Typical</b>	Unfinished % <b>0%</b>
2.Vin/Al 6.Brick 10.Cemplan	1.Modern 4.Obsolete	Grade & Factor <b>3 Average 100%</b>
3.Compos./ 7.Stone 11.Concret	2.Typical 5. 8.	1.E Grade 4.B Grade 7.SC Grade
4.Asbestos 8.Wood Shi 12.Wood Bo	3.Old Type 6. 9.None	2.D Grade 5.A Grade 8.
Roof Surface <b>1 Asphalt Shingles</b>	Bath(s) Style <b>2 Typical Bath(s)</b>	3.Grade 6.AA Grade 9.Same
1.Asphalt 4.Composit 7.Other	1.Modern 4.Obsolete 7.	SQFT (Footprint) <b>936</b>
2.Slate 5.Wood 8.	2.Typical 5. 8.	Condition <b>4 Average</b>
3.Metal 6.Roll Roo 9.	3.Old Type 6. 9.None	1.Poor 2.Avg 7.V G
SF Masonry Trim <b>0</b>	# Rooms <b>6</b>	2.Fair 3.Avg 8.Exc
SOLAR VOLTAIC <b>0</b>	# Bedrooms <b>3</b>	3.Avg- 4.Good 9.Same
OPEN-4- <b>0</b>	# Full Baths <b>2</b>	Phys. % Good <b>0%</b>
Year Built <b>1987</b>	# Half Baths <b>0</b>	Funct. % Good <b>100%</b>
Year Remodeled <b>0</b>	# Addn Fixtures <b>0</b>	Functional Code <b>9 None</b>
Foundation <b>1 Concrete</b>	# Fireplaces <b>0</b>	1.Incomp 4.Delap 5.Delay
1.Concrete 4.Wood 7.		2.O-Built 5.Bsmt 6.Landform
2.C Block 5.Slab 8.		3.Damage 6.Style 7.None
3.Br/Stone 6.Piers 9.		Econ. % Good <b>100%</b>
Basement <b>4 Full Basement</b>		Economic Code <b>None</b>
1.1/4 Bmt 4.Full Bmt 7.		0.None 3.No Power 6.Obsolete
2.1/2 Bmt 5.CrwI 8.		1.Location 4.Generate 9.None
3.3/4 Bmt 6. 9.None		2.Encroach 5.Flood Pl 9.
Bsmt Gar # Cars <b>0</b>		Entrance Code <b>5 Estimated</b>
Wet Basement <b>1 Dry Basement</b>		1.Interior 4.Vacant 7.
1.Dry 4. 7.		2.Refusal 5.Estimate 8.
2.Damp 5. 8.		3.Informed 6. 9.
3.Wet 6. 9.		Information Code <b>5 Estimate</b>
		1.Owner 4.Agent 7.
		2.Relative 5.Estimate 8.
		3.Tenant 6.Other 9.

Date Inspected 7/31/2015

**Additions, Outbuildings & Improvements**

Type	Year	Units	Grade	Cond	Phys.	Funct.	Sound Value
1 One Story Frame	0	408	0 0	0	0	% 100 %	
68 Wood Deck	0	372	0 0	0	0	% 100 %	
68 Wood Deck	0	520	0 0	0	0	% 100 %	
68 Wood Deck	0	64	2 100	0	0	% 100 %	
21 Open Frame	0	64	2 100	0	0	% 100 %	
21 Open Frame	0	64	2 100	0	0	% 100 %	
24 Frame Shed	0	48	2 100	4	0	% 100 %	
24 Frame Shed	0	96	2 100	4	0	% 100 %	
68 Wood Deck	0	24	0 0	0	0	% 100 %	

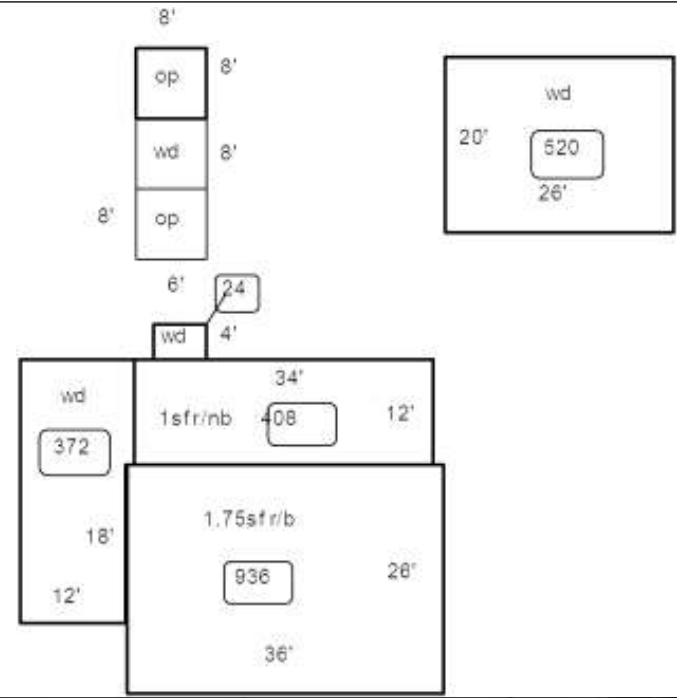

Proposed Value