

BAZINET, GREGORY P  
BAZINET, SAMANTHA P  
119 MERRILL RD  
GRAY ME 04039

B31559P231

Inspection Witnessed By:

X	Date	Date Insp.
No./Date	Description	Date Insp.

Notes:  
5/24 DR FIELD REVIEW

Gray

Property Data		
Neighborhood	82 Average Location	
Tree Growth Year	0	
REVIEW	0	
Building Permit	0	
Zone/Land Use	11 Rural Residential & Agri	
Secondary Zone		
Topography	1 Level	
1. Well	4. Below St	7.
2. Rolling	5. Low	8.
3. Above St	6. Swampy	9.
Utilities	4. Filled Well/Point 6 Septic System	
1. Public	4. Dr. Well/Po	7. Cesspool
2. Water	5. Dug Well	8. Lake
3. Holding Ta	6. Septic	9. None
Street	1 Paved	
1. Paved	4. Proposed	8.
2. Semi Imp	5. R/O/W	9.
3. Gravel	6.	9. None
GIS Map	22	
Field Review	1	
Sale Data		
Sale Date	6/11/2014	
Price	272,000	
Sale Type	2 Land & Buildings	
1. Land	4. Mobile	7. COM
2. L & B	5. Other	8.
3. Building	6. Condo	9.
Financing	9 Unknown	
1. Convent	4. Seller	7.
2. FHA/VA	5. Private	8.
3. Assumed	6. Cash	9. Unknown
Validity	1 Arms Length Sale	
1. Valid	4. Split	7. Multiple
2. Related	5. Partial	8. Other
3. Distress	6. Exempt	9. Estate
Verified	5 Public Record	
1. Buyer	4. Agent	7. Family
2. Seller	5. Pub Rec	8. Other
3. Lender	6. MLS	9.

Assessment Record				
Year	Land	Buildings	Exempt	Total
2011	46,800	165,762	8,500	204,062
2012	46,800	165,762	8,500	204,062
2013	46,800	165,762	8,500	204,062
2014	46,800	165,762	8,500	204,062
2015	46,800	165,800	9,000	203,600
2016	46,800	158,100	0	204,900
2017	46,800	164,800	0	211,600
2018	46,800	164,800	0	211,600
2019	63,300	216,200	0	279,500
2020	63,300	216,200	0	279,500
2021	63,300	216,200	0	279,500
2022	63,300	236,500	0	299,800
2023	63,300	264,600	0	327,900
Calc.	125,700	461,200	25,000	561,900

Land Data					
Type	Effective		Influence		Influence Codes
	Frontage	Depth	Factor	Code	
1. Water (0-200)			%		1. Unimproved
2. Water (201-400)			%		2. Excess Frtg
3. Water (401-800)			%		3. Topography
4. Water (801-1600)			%		4. Size/Shape
5. Water (1601-3200)			%		5. Access
6. Water (3201-6400)			%		6. Restriction
7. Water (6401-12800)			%		7. Open Space
8. Water (12801-25600)			%		8. Environmental
9. Water (25601-51200)			%		9. Condo
10. Water (51201-102400)			%		30. Blueberry(11-20
11. Water (102401-204800)			%		31. Blueberry(21 -
12. Water (204801-409600)			%		32. Crop Land
13. Water (409601-819200)			%		33. Pasture
14. Water (819201-1638400)			%		34. Shorefront B
15. Water (1638401-3276800)			%		35. Shorefront C
16. Water (3276801-6553600)			%		36. ANTENNA SITE
17. Water (6553601-13107200)			%		37. Softwood TG
18. Water (13107201-26214400)			%		38. Mixed Wood TG
19. Water (26214401-52428800)			%		39. Hardwood TG
20. ShoreFront A			%		40. Wasteland
21. Base Lot			%		41. Woodland
22. Base Lot Vacant			%		42. Mobile Home Si
23. Base Lot Unpaved			%		43. Camp Site
24. Acres to 10			%		44. Lot Improvemen
25. Acres 11-30			%		45. BA SF - Oce
26. Acres 31-50			%		46. SP Meadow Cond
27. Acres 51& over			%		
28. Acres 71 & Ove			%		
29. Woods (41+)			%		
<b>Total Acreage</b>			1.96		

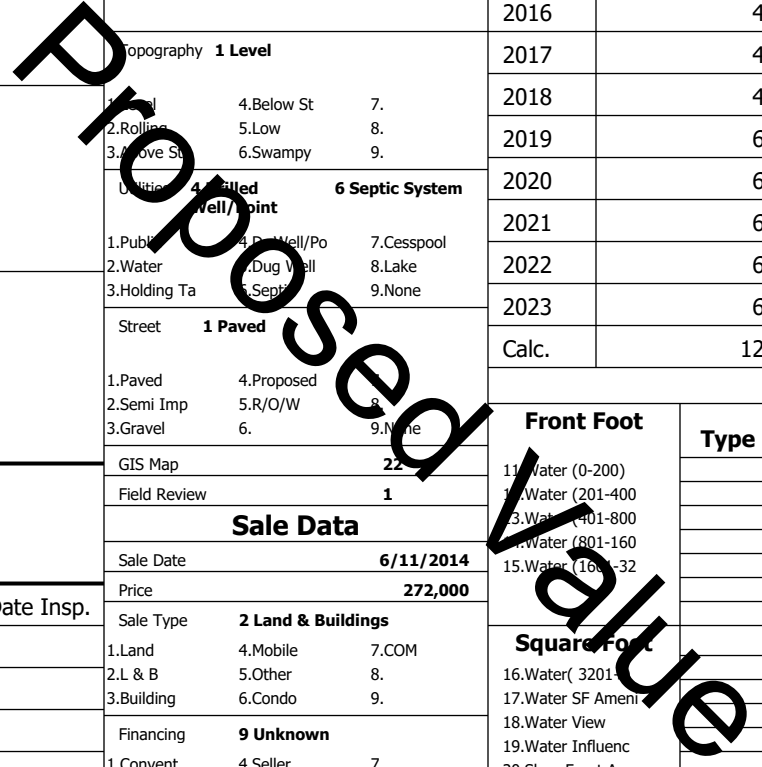

**Gray**

Map Lot 022-034-003-007

Account 2011

Location 119 MERRILL RD

Card 1

Of 1

8/05/2024

Building Style <b>4 Cape Cod</b>	SF Bsmt Living <b>0</b>	Layout <b>1 Typical</b>
1.Conv. 5.Garrison 9.NE farm	Fin Bsmt Grade <b>0 0</b>	1.Typical 4. 7.
2.Ranch 6.Split 10.Colonia	Secondary Heat <b>0</b>	2.Inadeq 5. 8.
3.R Ranch/ 7.Contemp 11.Cottage	Heat Type <b>100% 1 Hot Water BB</b>	3. 6. 9.
4.Cape 8.Log 12.Gambrel	1.HWBB 5.FWA 9.None	Attic <b>9 None</b>
Dwelling Units <b>1</b>	2.HWCI 6.Monitor 10.UNH2F	1.1/4 Fin 4.Full Fin 7.
Other Units <b>0</b>	3.HWRF 7.Electric 11.Geother	2.1/2 Fin 5.FI/Stair 8.
Stories <b>5 One &amp; 3/4 Story</b>	4.Steam 8.FI/Wall 12.Heat/Co	3.3/4 Fin 6. 9.None
1.1 4.1.5 7.	Cool Type <b>0% 9 None</b>	Insulation <b>1 Full</b>
2.2 5.1.75 8.	1.Central 4.W&C Air 7.	1.Full 4.Minimal 7.
3.3 6.2.5 9.	2.Evapor 5. 8.	2.Heavy 5. 8.
Exterior Walls <b>1 Clapboard</b>	3.H Pump 6. 9.None	3.Capped 6. 9.None
1.Clapboar 5.Stucco 9.B & B	Kitchen Style <b>2 Typical</b>	Unfinished % <b>0%</b>
2.Vin/Al 6.Brick 10.Cemplan	1.Modern 4.Obsolete	Grade & Factor <b>3 Average 110%</b>
3.Compos./ 7.Stone 11.Concret	2.Typical 5. 8.	1.E Grade 4.B Grade 7.SC Grade
4.Asbestos 8.Wood Shi 12.Wood Bo	3.Old Type 6. 9.None	2.D Grade 5.A Grade 8.
Roof Surface <b>1 Asphalt Shingles</b>	Bath(s) Style <b>2 Typical Bath(s)</b>	3.C Grade 6.AA Grade 9.Same
1.Asphalt 4.Composit 7.Other	1.Modern 4.Obsolete 7.	SQFT (Footprint) <b>1008</b>
2.Slate 5.Wood 8.	2.Typical 5. 8.	Condition <b>5 Above Average</b>
3.Metal 6.Roll Roo 9.	3.Old Type 6. 9.None	1.Poor 4.Avg 7.V G
SF Masonry Trim <b>0</b>	# Rooms <b>5</b>	2.Fair 3.Avg 8.Exc
SOLAR VOLTAIC <b>0</b>	# Bedrooms <b>3</b>	3.Avg- 4.Good 9.Same
OPEN-4- <b>0</b>	# Full Baths <b>1</b>	Phys. % Good <b>0%</b>
Year Built <b>1993</b>	# Half Baths <b>1</b>	Funct. % Good <b>100%</b>
Year Remodeled <b>0</b>	# Addn Fixtures <b>0</b>	Functional Code <b>9 None</b>
Foundation <b>1 Concrete</b>	# Fireplaces <b>1</b>	1.Incomp 4.Delap 5.Delay
1.Concrete 4.Wood 7.		2.O-Built 5.Bsmt 6.Long term
2.C Block 5.Slab 8.		3.Damage 6.Style 7.None
3.Br/Stone 6.Piers 9.		Econ. % Good <b>100%</b>
Basement <b>4 Full Basement</b>		Economic Code <b>None</b>
1.1/4 Bmt 4.Full Bmt 7.		0.None 3.No Power 6.Obsolete
2.1/2 Bmt 5.Crwl 8.		1.Location 4.Generate 9.None
3.3/4 Bmt 6. 9.None		2.Encroach 5.Flood Pl 9.
Bsmt Gar # Cars <b>0</b>		Entrance Code <b>5 Estimated</b>
Wet Basement <b>1 Dry Basement</b>		1.Interior 4.Vacant 7.
1.Dry 4. 7.		2.Refusal 5.Estimate 8.
2.Damp 5. 8.		3.Informed 6. 9.
3.Wet 6. 9.		Information Code <b>5 Estimate</b>
		1.Owner 4.Agent 7.
		2.Relative 5.Estimate 8.
		3.Tenant 6.Other 9.

Date Inspected 5/10/2024

**Additions, Outbuildings & Improvements**

Type	Year	Units	Grade	Cond	Phys.	Funct.	Sound Value
24 Frame Shed	1999	120	3 100	4	0 %	100 %	
14 1.5	0	256	0 0	0	0 %	100 %	
68 Wood Deck	0	224	0 0	0	0 %	100 %	
61 Canopy	2010	100	3 100	4	0 %	100 %	
23 Frame Garage	1995	864	3 100	4	0 %	100 %	
81 1 St/Garage	1995	864	2 100	4	0 %	100 %	
					%	%	
					%	%	
					%	%	
					%	%	
					%	%	

