

FOSTER, GEOFFREY J
FOSTER, NADINE
38 SHAKER ROAD
GRAY ME 04039

B39309P273 B39897P155

Previous Owner
FOSTER, GEOFFREY
38 SHAKER ROAD

GRAY ME 04039
Sale Date: 6/04/2011

Property Data			Assessment Record				
Neighborhood	82 Average Location		Year	Land	Buildings	Exempt	Total
Tree Growth Year	0		2011	65,500	279,829	0	345,329
REVIEW	0		2012	65,500	279,829	0	345,329
Building Permit	0		2013	65,500	167,400	0	232,900
Zone/Land Use	15 Business Development		2014	65,500	287,900	0	353,400
Secondary Zone			2015	65,500	167,400	0	232,900
Topography	1 Level		2016	65,500	287,900	0	353,400
			2017	65,500	323,000	0	388,500
			2018	63,700	283,500	0	347,200
			2019	82,100	198,100	0	280,200
			2020	82,100	435,200	0	517,300
			2021	82,100	198,100	0	280,200
			2022	82,100	198,100	0	280,200
			2023	70,000	229,100	0	299,100
			Calc.	125,000	356,400	0	481,400

Land Data					
Type	Effective		Influence		Influence Codes
	Frontage	Depth	Factor	Code	
1. Water (0-200)			%		1.Unimproved
2. Water (201-400)			%		2.Excess Frtg
3. Water (401-800)			%		3.Topography
4. Water (801-160)			%		4.Size/Shape
5. Water (1601-32)			%		5.Access
			%		6.Restriction
			%		7.Open Space
			%		8.Environmental
			%		9.Condo
Acres					
			%		30.Blueberry(1-20
			%		31.Blueberry(21 -
			%		32.Crop Land
			%		33.Pasture
			%		34.Shorefront B
			%		35.Shorefront C
			%	0	36.ANTENNA SITE
			%		37.Softwood TG
			%		38.Mixed Wood TG
			%		39.Hardwood TG
			%		40.Wasteland
			%		41.Woodland
			%		42.Mobile Home Si
			%		43.Camp Site
			%		44.Lot Improvemen
			%		45.BA SF - Oce
			%		46.SP Meadow Cond
Total Acreage 1.84					

Inspection Witnessed By:

X	Date

Notes:
1/26/2022 - Acreage changed to 7.00 based on property survey.
4/1/2022 - B39309P269 - 1.84 Acres split from this lot to create 021-026-017-002 - 22 Weymouth Road.
4/1/2022 - B39309P271 - 3.30 Acres split from this lot to create 021-026-017-003.
5/24 DR FIELD REVIEW . 480 SQ FT SHED CONVERTED TO LIVING SPACE

Gray

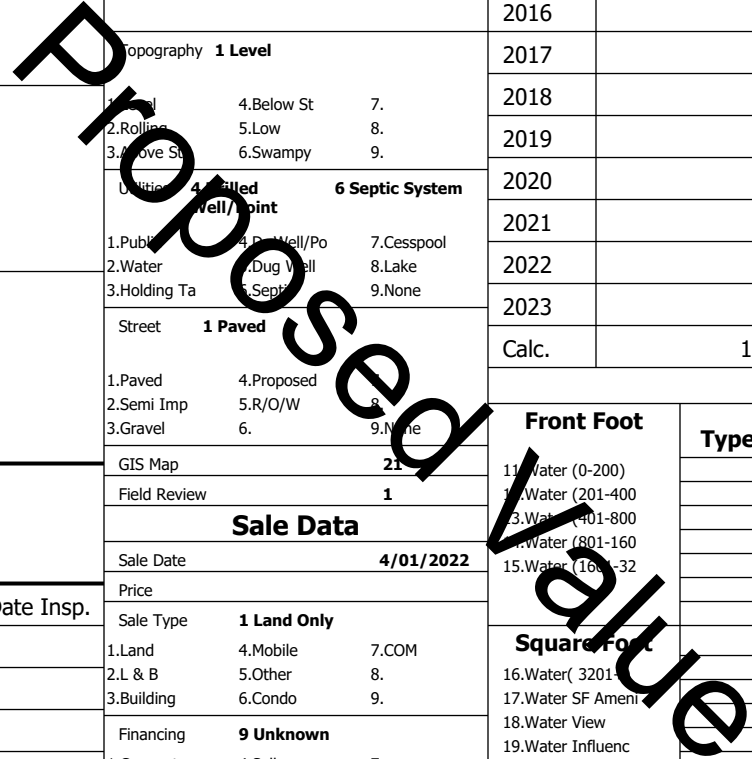

Gray

Map Lot 021-026-017-000

Account 1502

Location 16 WEYMOUTH RD

Card 1 Of 1 8/05/2024

Building Style 30 Two Unit Apt	SF Bsmt Living 0	Layout 1 Typical
1.Conv. 5.Garrison 9.NE farm	Fin Bsmt Grade 0 0	1.Typical 4. 7.
2.Ranch 6.Split 10.Colonia	Secondary Heat 0	2.Inadeq 5. 8.
3.R Ranch/ 7.Contemp 11.Cottage	Heat Type 100% 3 Hot Water Radiant	3. 6. 9.
4.Cape 8.Log 12.Gambrel	1.HWBB 5.FWA Floor 9.None	Attic 9 None
Dwelling Units 2	2.HWCI 6.Monitor 10.UNH2F	1.1/4 Fin 4.Full Fin 7.
Other Units 0	3.HWRF 7.Electric 11.Geother	2.1/2 Fin 5.FI/Stair 8.
Stories 2 Two Story	4.Steam 8.FI/Wall 12.Heat/Co	3.3/4 Fin 6. 9.None
1.1 4.1.5 7.	Cool Type 0% 9 None	Insulation 1 Full
2.2 5.1.75 8.	1.Central 4.W&C Air 7.	1.Full 4.Minimal 7.
3.3 6.2.5 9.	2.Evapor 5. 8.	2.Heavy 5. 8.
Exterior Walls 2 Vinyl/Aluminum	3.H Pump 6. 9.None	3.Capped 6. 9.None
1.Clapboard 5.Stucco 9.B & B	Kitchen Style 2 Typical	Unfinished % 0%
2.Vin/Al 6.Brick 10.Cemplan	1.Modern 4.Obsolete	Grade & Factor 3 Average 100%
3.Compos./ 7.Stone 11.Concret	2.Typical 5. 8.	1.E Grade 4.B Grade 7.SC Grade
4.Asbestos 8.Wood Shi 12.Wood Bo	3.Old Type 6. 9.None	2.C Grade 5.A Grade 8.
Roof Surface 3 Metal	Bath(s) Style 2 Typical Bath(s)	3.E Grade 6.AA Grade 9.Same
1.Asphalt 4.Composit 7.Other	1.Modern 4.Obsolete 7.	SQFT (Footprint) 1040
2.Slate 5.Wood 8.	2.Typical 5. 8.	Foundation 4 Average
3.Metal 6.Roll Roo 9.	3.Old Type 6. 9.None	1.Poor Avg 7.V G
SF Masonry Trim 0	# Rooms 8	2.Fair Avg 8.Exc
SOLAR VOLTAIC 0	# Bedrooms 4	3.Avg- Good 9.Same
OPEN-4- 0	# Full Baths 2	Phys. % Good 0%
Year Built 2008	# Half Baths 0	Funct. % Good 100%
Year Remodeled 0	# Addn Fixtures 0	Functional Code 9 None
Foundation 1 Concrete	# Fireplaces 0	1.Incomp 4.Delap 5.Playo
1.Concrete 4.Wood 7.		2.O-Built 5.Bsmt 8.Long term
2.C Block 5.Slab 8.		3.Damage 6.Style None
3.Br/Stone 6.Piers 9.		Econ. % Good 100%
Basement 5 Crawl Space		Economic Code None
1.1/4 Bmt 4.Full Bmt 7.		0.None 3.No Power 6.Obsolete
2.1/2 Bmt 5.Crw 8.		1.Location 4.Generate 9.None
3.3/4 Bmt 6. 9.None		2.Encroach 5.Flood Pl 9.
Bsmt Gar # Cars 0		Entrance Code 5 Estimated
Wet Basement 9 No Basement		1.Interior 4.Vacant 7.
1.Dry 4. 7.		2.Refusal 5.Estimate 8.
2.Damp 5. 8.		3.Informed 6. 9.
3.Wet 6. 9.		Information Code 5 Estimate
		1.Owner 4.Agent 7.
		2.Relative 5.Estimate 8.
		3.Tenant 6.Other 9.

Date Inspected 5/10/2024

Additions, Outbuildings & Improvements

Type	Year	Units	Grade	Cond	Phys.	Funct.	Sound Value
1 One Story Frame	1980	480	2 100	4	0 %	100 %	1.One Story Fram
24 Frame Shed	0	24	3 100	4	0 %	100 %	2.Two Story Fram
					%	%	3.Three Story Fr
					%	%	4.1 & 1/2 Story
					%	%	5.1 & 3/4 Story
					%	%	6.2 & 1/2 Story
					%	%	21.Open Frame Por
					%	%	22.Encl Frame Por
					%	%	23.Frame Garage
					%	%	24.Frame Shed
					%	%	25.Frame Bay Wind
					%	%	26.1SFr Overhang
					%	%	27.Unfin Basement
					%	%	28.Unfinished Att
					%	%	29.Finished Attic

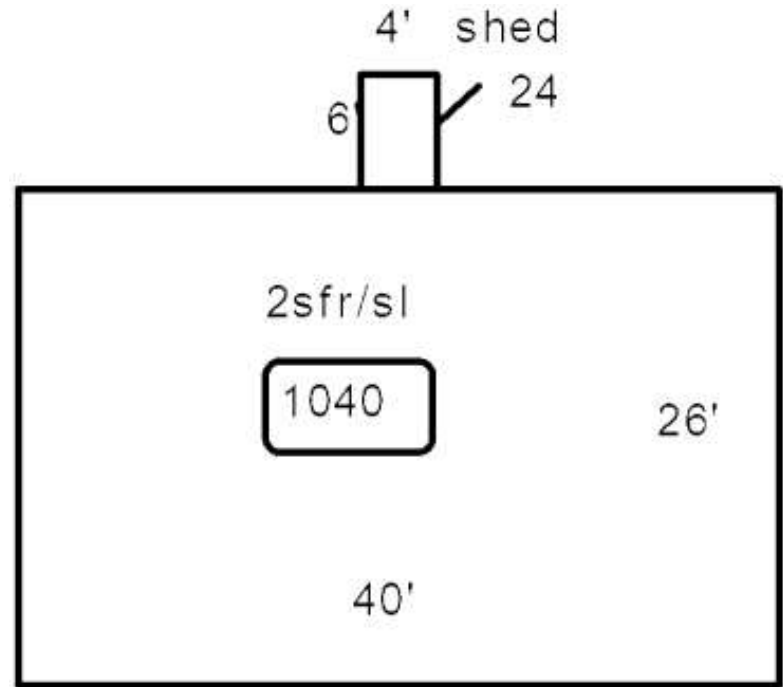

Proposed Value