

SHAW, JOSEPH W III  
SHAW, PAULA L  
15 TRIPP LANE  
GRAY ME 04039

B13711P14

Inspection Witnessed By:

X	Date	Description	Date Insp.

Notes:  
5/24 DR FIELD REVIEW

Gray

Property Data			Assessment Record						
Neighborhood <b>82 Average Location</b>			Year	Land	Buildings	Exempt	Total		
Tree Growth Year <b>0</b>			2011	48,280	98,477	8,500	138,257		
REVIEW <b>0</b>			2012	48,280	173,157	8,500	212,937		
Building Permit <b>0</b>			2013	48,280	173,157	8,500	212,937		
Zone/Land Use <b>15 Business Development</b>			2014	48,280	173,157	8,500	212,937		
Secondary Zone <b>13 Commercial</b>			2015	48,300	173,200	9,000	212,500		
Topography <b>2 Rolling</b>			2016	48,300	173,200	9,000	212,500		
1. Hill 4. Below St 7.			2017	48,300	173,200	13,500	208,000		
2. Rolling 5. Low 8.			2018	48,300	173,200	18,000	203,500		
3. Above St 6. Swampy 9.			2019	49,300	110,100	20,000	139,400		
Utilities <b>4 Filled Well/Point</b> <b>6 Septic System</b>			2020	49,300	110,100	20,000	139,400		
1. Public 4. Dug Well/Po 7. Cesspool			2021	49,300	110,100	25,000	134,400		
2. Water 8. Lake			2022	49,300	110,100	25,000	134,400		
3. Holding Ta 9. None			2023	49,300	136,500	25,000	160,800		
Street <b>3 Gravel</b>			Calc.	128,600	165,700	25,000	269,300		
1. Paved 4. Proposed			<b>Land Data</b>						
2. Semi Imp 5. R/O/W			<b>Front Foot</b>	<b>Type</b>	<b>Effective</b>		<b>Influence</b>		<b>Influence Codes</b>
3. Gravel 6. None					<b>Frontage</b>	<b>Depth</b>	<b>Factor</b>	<b>Code</b>	
GIS Map <b>21</b>			11. Water (0-200)				%		1. Unimproved
Field Review <b>1</b>			12. Water (201-400)				%		2. Excess Frtg
<b>Sale Data</b>			13. Water (401-800)				%		3. Topography
Sale Date <b>4/01/1998</b>			14. Water (801-160)				%		4. Size/Shape
Price			15. Water (161-32)				%		5. Access
Sale Type							%		6. Restriction
1. Land 4. Mobile 7.COM			<b>Square Foot</b>	<b>Square Feet</b>					7. Open Space
2. L & B 5. Other 8.			16. Water ( 3201-				%		8. Environmental
3. Building 6. Condo 9.			17. Water SF Amen				%		9. Condo
Financing			18. Water View				%		<b>Acres</b>
1. Convent 4. Seller 7.			19. Water Influen				%		30. Blueberry(1-20
2. FHA/VA 5. Private 8.			20. ShoreFront A				%		31. Blueberry(21 -
3. Assumed 6. Cash 9.Unknown							%		32. Crop Land
Validity			<b>Fract. Acre</b>	<b>Acres/Sites</b>					33. Pasture
1. Valid 4. Split 7. Multiple			21. Base Lot	23	1.84	100	%	0	34. Shorefront B
2. Related 5. Partial 8. Other			22. Base Lot Vacan	24	1.44	100	%	0	35. Shorefront C
3. Distress 6. Exempt 9. Estate			23. Base Lot Unpav				%		36. ANTENNA SITE
Verified			<b>Acres</b>				%		37. Softwood TG
1. Buyer 4. Agent 7. Family			24. Acres to 10				%		38. Mixed Wood TG
2. Seller 5. Pub Rec 8. Other			25. Acres 11-30				%		39. Hardwood TG
3. Lender 6. MLS 9.			26. Acres 31-50				%		40. Wasteland
			27. Acres 51& over				%		41. Woodland
			28. Acres 71 & Ove				%		42. Mobile Home Si
			29. Woods (41+)				%		43. Camp Site
			<b>Total Acreage</b>		<b>3.28</b>				44. Lot Improvemen
									45. BA SF - Oce
									46. SP Meadow Cond

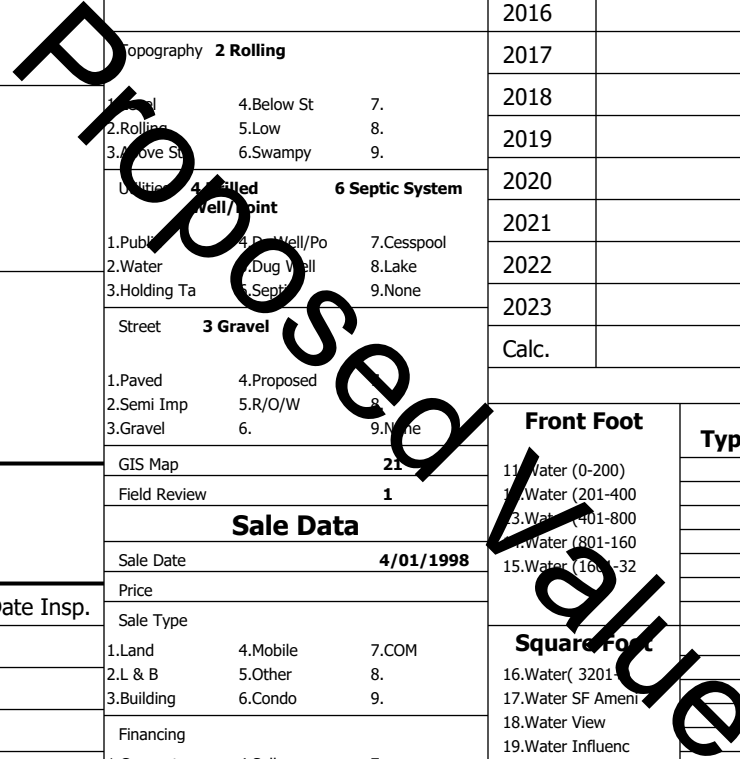

**Gray**

Map Lot 021-026-009-005

Account 1580

Location 15 TRIPP LN

Card 1

Of 1

8/05/2024

Building Style <b>4 Cape Cod</b>	SF Bsmt Living <b>0</b>	Layout <b>1 Typical</b>
1.Conv. 5.Garrison 9.NE farm	Fin Bsmt Grade <b>0 0</b>	1.Typical 4. 7.
2.Ranch 6.Split 10.Colonia	Secondary Heat <b>0</b>	2.Inadeq 5. 8.
3.R Ranch/ 7.Contemp 11.Cottage	Heat Type <b>100% 1 Hot Water BB</b>	3. 6. 9.
4.Cape 8.Log 12.Gambrel	1.HWBB 5.FWA 9.None	Attic <b>9 None</b>
Dwelling Units <b>1</b>	2.HWCI 6.Monitor 10.UNH2F	1.1/4 Fin 4.Full Fin 7.
Other Units <b>0</b>	3.HWRF 7.Electric 11.Geoether	2.1/2 Fin 5.F/Stair 8.
Stories <b>4 One &amp; 1/2 Story</b>	4.Steam 8.F/Wall 12.Heat/Co	3.3/4 Fin 6. 9.None
1.1 4.1.5 7.	Cool Type <b>0% 9 None</b>	Insulation <b>1 Full</b>
2.2 5.1.75 8.	1.Central 4.W&C Air 7.	1.Full 4.Minimal 7.
3.3 6.2.5 9.	2.Evapor 5. 8.	2.Heavy 5. 8.
Exterior Walls <b>2 Vinyl/Aluminum</b>	3.H Pump 6. 9.None	3.Capped 6. 9.None
1.Clapboard 5.Stucco 9.B & B	Kitchen Style <b>2 Typical</b>	Unfinished % <b>0%</b>
2.Vin/Al 6.Brick 10.Cemplan	1.Modern 4.Obsolete	Grade & Factor <b>3 Average 110%</b>
3.Compos./ 7.Stone 11.Concret	2.Typical 5. 8.	1.E Grade 4.B Grade 7.SC Grade
4.Asbestos 8.Wood Shi 12.Wood Bo	3.Old Type 6. 9.None	2.C Grade 5.A Grade 8.
Roof Surface <b>1 Asphalt Shingles</b>	Bath(s) Style <b>2 Typical Bath(s)</b>	3.D Grade 6.AA Grade 9.Same
1.Asphalt 4.Composit 7.Other	1.Modern 4.Obsolete 7.	SQFT (Footprint) <b>0</b>
2.Slate 5.Wood 8.	2.Typical 5. 8.	Foundation <b>4 Average</b>
3.Metal 6.Roll Roo 9.	3.Old Type 6. 9.None	1.Pool 2.Avg 7.V G
SF Masonry Trim <b>0</b>	# Rooms <b>5</b>	2.Finish 3.Avg 8.Exc
SOLAR VOLTAIC <b>0</b>	# Bedrooms <b>3</b>	3.Avg- 4.Good 9.Same
OPEN-4- <b>0</b>	# Full Baths <b>1</b>	Phys. % Good <b>0%</b>
Year Built <b>1998</b>	# Half Baths <b>0</b>	Funct. % Good <b>100%</b>
Year Remodeled <b>0</b>	# Addn Fixtures <b>0</b>	Functional Code <b>9 None</b>
Foundation <b>1 Concrete</b>	# Fireplaces <b>0</b>	1.Incomp 4.Delap 5.Layoff
1.Concrete 4.Wood 7.		2.O-Built 5.Bsmt 6.Long term
2.C Block 5.Slab 8.		3.Damage 6.Style 7.None
3.Br/Stone 6.Piers 9.		Econ. % Good <b>100%</b>
Basement <b>4 Full Basement</b>		Economic Code <b>None</b>
1.1/4 Bmt 4.Full Bmt 7.		0.None 3.No Power 6.Obsolete
2.1/2 Bmt 5.Crwl 8.		1.Location 4.Generate 9.None
3.3/4 Bmt 6. 9.None		2.Encroach 5.Flood Pl 9.
Bsmt Gar # Cars <b>0</b>		Entrance Code <b>5 Estimated</b>
Wet Basement <b>1 Dry Basement</b>		1.Interior 4.Vacant 7.
1.Dry 4. 7.		2.Refusal 5.Estimate 8.
2.Damp 5. 8.		3.Informed 6. 9.
3.Wet 6. 9.		Information Code <b>5 Estimate</b>
		1.Owner 4.Agent 7.
		2.Relative 5.Estimate 8.
		3.Tenant 6.Other 9.

Date Inspected 5/10/2024

**Additions, Outbuildings & Improvements**

Type	Year	Units	Grade	Cond	Phys.	Funct.	Sound Value
11 1 Story/Basement	2010	624	0 0	0	0	% 100 %	1.One Story Fram 2.Two Story Fram 3.Three Story Fr
68 Wood Deck	0	164	0 0	0	0	% 100 %	4.1 & 1/2 Story 5.1 & 3/4 Story
24 Frame Shed	0	169	2 100	4	0	% 100 %	6.2 & 1/2 Story 21.Open Frame Por
						% %	22.Encl Frame Por
						% %	23.Frame Garage
						% %	24.Frame Shed
						% %	25.Frame Bay Wind
						% %	26.1SFr Overhang
						% %	27.Unfin Basement
						% %	28.Unfinished Att
						% %	29.Finished Attic

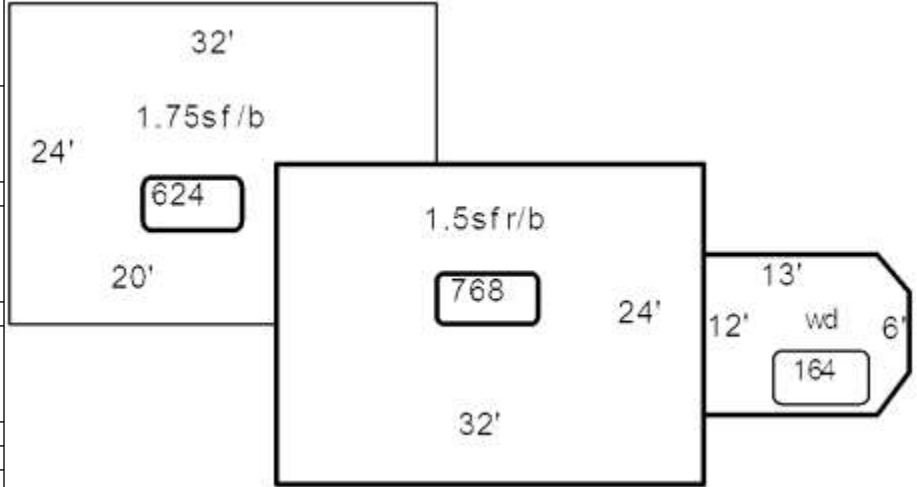

Proposed Value