

CARDER, JAMES C  
CARDER, SANDRA M  
186 SHAKER RD  
GRAY ME 04039

B9547P15

<b>Property Data</b>		
Neighborhood	<b>81 Fair-Traffic</b>	
Tree Growth Year	<b>0</b>	
REVIEW	<b>0</b>	
Building Permit	<b>0</b>	
Zone/Land Use	<b>11 Rural Residential &amp; Agri</b>	
Secondary Zone		
Topography	<b>1 Level</b>	
1. Hill	4. Below St	7.
2. Rolling	5. Low	8.
3. Above St	6. Swampy	9.
Utilities	<b>2 Public Water 6 Septic System</b>	
1. Public	4. Dr. Well/Po	7. Cesspool
2. Water	5. Dug Well	8. Lake
3. Holding Ta	6. Septic	9. None
Street	<b>1 Paved</b>	
1. Paved	4. Proposed	8.
2. Semi Imp	5. R/O/W	9.
3. Gravel	6.	
GIS Map	<b>20</b>	
Field Review	<b>1</b>	

Inspection Witnessed By:

X		Date
No./Date	Description	Date Insp.

Notes:  
5/24 DR FIELD REVIEW

Gray

<b>Assessment Record</b>				
Year	Land	Buildings	Exempt	Total
2011	47,000	149,065	8,500	187,565
2012	47,000	149,065	8,500	187,565
2013	47,000	149,065	8,500	187,565
2014	47,000	156,087	8,500	194,587
2015	47,000	156,100	9,000	194,100
2016	47,000	156,100	9,000	194,100
2017	47,000	156,100	13,500	189,600
2018	47,000	156,100	18,000	185,100
2019	70,500	208,600	20,000	259,100
2020	70,500	208,600	20,000	259,100
2021	70,500	208,600	25,000	254,100
2022	70,500	208,600	25,000	254,100
2023	70,500	234,700	25,000	280,200
Calc.	119,700	347,300	25,000	442,000

<b>Land Data</b>						
<b>Front Foot</b>	<b>Type</b>	<b>Effective</b>		<b>Influence</b>		<b>Influence Codes</b>
		<b>Frontage</b>	<b>Depth</b>	<b>Factor</b>	<b>Code</b>	
11. Water (0-200)				%		1. Unimproved
12. Water (201-400)				%		2. Excess Frtg
13. Water (401-800)				%		3. Topography
14. Water (801-160)				%		4. Size/Shape
15. Water (1601-32)				%		5. Access
				%		6. Restriction
				%		7. Open Space
				%		8. Environmental
				%		9. Condo
<b>Square Foot</b>		<b>Square Feet</b>				<b>Acres</b>
16. Water( 3201-				%		30. Blueberry(1-20
17. Water SF Amen				%		31. Blueberry(21 -
18. Water View				%		32. Crop Land
19. Water Influen				%		33. Pasture
20. ShoreFront A				%		34. Shorefront B
				%		35. Shorefront C
<b>Fract. Acre</b>		<b>Acreege/Sites</b>				36. ANTENNA SITE
21. Base Lot	21	1.84	100	%	0	37. Softwood TG
22. Base Lot Vacan	24	0.16	100	%	0	38. Mixed Wood TG
23. Base Lot Unpav				%		39. Hardwood TG
<b>Acres</b>				%		40. Wasteland
24. Acres to 10				%		41. Woodland
25. Acres 11-30				%		42. Mobile Home Si
26. Acres 31-50				%		43. Camp Site
27. Acres 51& over				%		44. Lot Improvemen
28. Acres 71 & Ove				%		45. BA SF - Oce
29. Woods (41+)				%		46. SP Meadow Cond
<b>Total Acreege</b>				<b>2.00</b>		

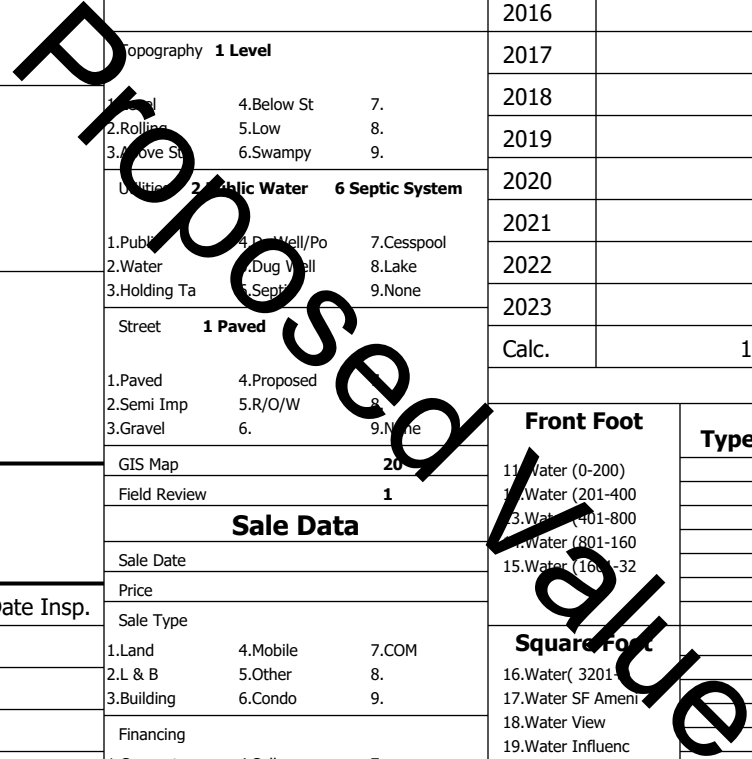

**Gray**

Map Lot 020-045-038-000

Account 2809

Location 186 SHAKER RD

Card 1

Of 1

8/05/2024

Building Style <b>4 Cape Cod</b>	SF Bsmt Living <b>0</b>	Layout <b>1 Typical</b>
1.Conv. 5.Garrison 9.NE farm	Fin Bsmt Grade <b>0 0</b>	1.Typical 4. 7.
2.Ranch 6.Split 10.Colonia	Secondary Heat <b>0</b>	2.Inadeq 5. 8.
3.R Ranch/ 7.Contemp 11.Cottage	Heat Type <b>100% 1 Hot Water BB</b>	3. 6. 9.
4.Cape 8.Log 12.Gambrel	1.HWBB 5.FWA 9.None	Attic <b>9 None</b>
Dwelling Units <b>1</b>	2.HWCI 6.Monitor 10.UNH2F	1.1/4 Fin 4.Full Fin 7.
Other Units <b>0</b>	3.HWRF 7.Electric 11.Geother	2.1/2 Fin 5.FI/Stair 8.
Stories <b>4 One &amp; 1/2 Story</b>	4.Steam 8.FI/Wall 12.Heat/Co	3.3/4 Fin 6. 9.None
1.1 4.1.5 7.	Cool Type <b>0% 9 None</b>	Insulation <b>1 Full</b>
2.2 5.1.75 8.	1.Central 4.W&C Air 7.	1.Full 4.Minimal 7.
3.3 6.2.5 9.	2.Evapor 5. 8.	2.Heavy 5. 8.
Exterior Walls <b>2 Vinyl/Aluminum</b>	3.H Pump 6. 9.None	3.Capped 6. 9.None
1.Clapboar 5.Stucco 9.B & B	Kitchen Style <b>2 Typical</b>	Unfinished % <b>0%</b>
2.Vin/Al 6.Brick 10.Cemplan	1.Modern 4.Obsolete	Grade & Factor <b>3 Average 110%</b>
3.Compos./ 7.Stone 11.Concret	2.Typical 5. 8.	1.E Grade 4.B Grade 7.SC Grade
4.Asbestos 8.Wood Shi 12.Wood Bo	3.Old Type 6. 9.None	2.C Grade 5.A Grade 8.
Roof Surface <b>1 Asphalt Shingles</b>	Bath(s) Style <b>2 Typical Bath(s)</b>	3.Grade 6.AA Grade 9.Same
1.Asphalt 4.Composit 7.Other	1.Modern 4.Obsolete 7.	SQFT (Footprint) <b>936</b>
2.Slate 5.Wood 8.	2.Typical 5. 8.	Condition <b>5 Above Average</b>
3.Metal 6.Roll Roo 9.	3.Old Type 6. 9.None	1.Poor Avg 7.V G
SF Masonry Trim <b>0</b>	# Rooms <b>6</b>	2.Fair Avg 8.Exc
SOLAR VOLTAIC <b>0</b>	# Bedrooms <b>4</b>	3.Avg- Good 9.Same
OPEN-4- <b>0</b>	# Full Baths <b>2</b>	Phys. % Good <b>0%</b>
Year Built <b>1988</b>	# Half Baths <b>0</b>	Funct. % Good <b>100%</b>
Year Remodeled <b>0</b>	# Addn Fixtures <b>0</b>	Functional Code <b>9 None</b>
Foundation <b>1 Concrete</b>	# Fireplaces <b>0</b>	1.Incomp 4.Delap 5.Layoff
1.Concrete 4.Wood 7.		2.O-Built 5.Bsmt 8.Long term
2.C Block 5.Slab 8.		3.Damage 6.Style None
3.Br/Stone 6.Piers 9.		Econ. % Good <b>100%</b>
Basement <b>4 Full Basement</b>		Economic Code <b>None</b>
1.1/4 Bmt 4.Full Bmt 7.		0.None 3.No Power 6.Obsolete
2.1/2 Bmt 5.Crwl 8.		1.Location 4.Generate 9.None
3.3/4 Bmt 6. 9.None		2.Encroach 5.Flood Pl 9.
Bsmt Gar # Cars <b>0</b>		Entrance Code <b>5 Estimated</b>
Wet Basement <b>1 Dry Basement</b>		1.Interior 4.Vacant 7.
1.Dry 4. 7.		2.Refusal 5.Estimate 8.
2.Damp 5. 8.		3.Informed 6. 9.
3.Wet 6. 9.		Information Code <b>5 Estimate</b>
		1.Owner 4.Agent 7.
		2.Relative 5.Estimate 8.
		3.Tenant 6.Other 9.

Date Inspected 5/10/2024

**Additions, Outbuildings & Improvements**

Type	Year	Units	Grade	Cond	Phys.	Funct.	Sound Value
1 One Story Frame	1997	224	0 0	0	0 %	100 %	
21 Open Frame	1997	96	0 0	0	0 %	100 %	
68 Wood Deck	1997	308	0 0	0	0 %	100 %	
63 Swimming Pool	2006	648	3 100	4	0 %	50 %	
24 Frame Shed	2006	96	3 100	4	0 %	100 %	
74 1.5 St Garage	1997	900	0 0	0	0 %	100 %	
24 Frame Shed	2006	192	3 100	4	0 %	100 %	
24 Frame Shed	2006	30	3 100	4	0 %	100 %	
					%	%	
					%	%	

