

SULLIVAN, DANIEL W; JAMES J & PUNDT, MAUREEN
87 BIRCHWOOD ROAD
GRAY ME 04039

B31351P152

| Property Data | | | Assessment Record | | | | |
|------------------|------------------------|--|-------------------|------|-----------|--------|-------|
| Neighborhood | 5 Little Sebago | | Year | Land | Buildings | Exempt | Total |
| Tree Growth Year | 0 | | 2012 | 0 | 0 | 0 | 0 |
| REVIEW | 0 | | 2013 | 0 | 0 | 0 | 0 |
| Building Permit | 0 | | 2014 | 0 | 0 | 0 | 0 |
| Zone/Land Use | 12 Limited Residential | | 2016 | 0 | 0 | 0 | 0 |
| Secondary Zone | | | 2017 | 0 | 0 | 0 | 0 |
| Topography | | | 2018 | 0 | 0 | 0 | 0 |
| | | | 2019 | 0 | 0 | 0 | 0 |
| | | | 2020 | 0 | 0 | 0 | 0 |
| | | | 2021 | 0 | 0 | 0 | 0 |
| | | | 2022 | 0 | 0 | 0 | 0 |
| | | | 2023 | 0 | 0 | 0 | 0 |
| | | | Calc. | 0 | 0 | 0 | 0 |

| Land Data | | Front Foot | | Effective | | Influence | | Influence Codes |
|--------------------|--|----------------------|-------|-----------|------|-------------------|--|-----------------|
| Type | | Frontage | Depth | Factor | Code | | | |
| 1. Water (0-200) | | | | % | | 1.Unimproved | | |
| 2. Water (201-400) | | | | % | | 2.Excess Frtg | | |
| 3. Water (401-800) | | | | % | | 3.Topography | | |
| 4. Water (801-160) | | | | % | | 4.Size/Shape | | |
| 5. Water (1601-32) | | | | % | | 5.Access | | |
| | | | | % | | 6.Restriction | | |
| | | | | % | | 7.Open Space | | |
| | | | | % | | 8.Environmental | | |
| | | | | % | | 9.Condo | | |
| Square Foot | | Square Feet | | | | Acres | | |
| 16. Water (3201- | | | | % | | 30.Blueberry(1-20 | | |
| 17. Water SF Amen | | | | % | | 31.Blueberry(21 - | | |
| 18. Water View | | | | % | | 32.Crop Land | | |
| 19. Water Influen | | | | % | | 33.Pasture | | |
| 20. ShoreFront A | | | | % | | 34.Shorefront B | | |
| | | | | % | | 35.Shorefront C | | |
| | | | | % | | 36.ANTENNA SITE | | |
| | | | | % | | 37.Softwood TG | | |
| | | | | % | | 38.Mixed Wood TG | | |
| | | | | % | | 39.Hardwood TG | | |
| | | | | % | | 40.Wasteland | | |
| | | | | % | | 41.Woodland | | |
| | | | | % | | 42.Mobile Home Si | | |
| | | | | % | | 43.Camp Site | | |
| | | | | % | | 44.Lot Improvemen | | |
| | | | | % | | 45.BA SF - Oce | | |
| | | | | % | | 46.SP Meadow Cond | | |
| | | Total Acreage | | 0.00 | | | | |

Inspection Witnessed By:

| X | Date | Date Insp. |
|----------|-------------|------------|
| No./Date | Description | Date Insp. |
| | | |
| | | |
| | | |

Notes:
INCLUDED WITH 307-49

Gray

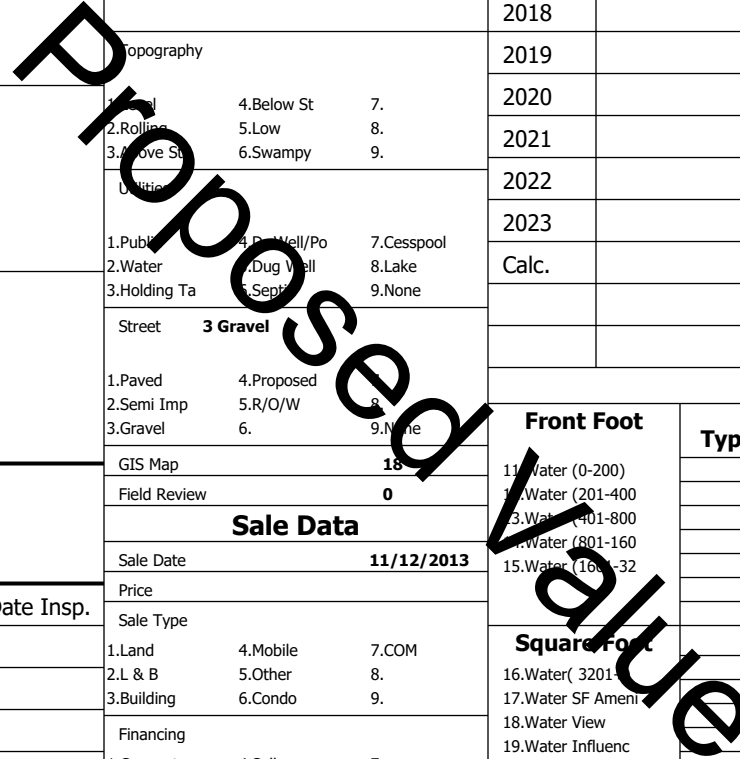

| | | |
|----------------------------------|------------------------------|--------------------------------|
| Building Style 0 | SF Bsmt Living 0 | Layout 0 |
| 1.Conv. 5.Garrison 9.NE farm | Fin Bsmt Grade 0 0 | 1.Typical 4. 7. |
| 2.Ranch 6.Split 10.Colonia | Secondary Heat 0 | 2.Inadeq 5. 8. |
| 3.R Ranch/ 7.Contemp 11.Cottage | Heat Type 100% 0 | 3. 6. 9. |
| 4.Cape 8.Log 12.Gambrel | 1.HWBB 5.FWA 9.None | Attic 0 |
| Dwelling Units 0 | 2.HWCI 6.Monitor 10.UNH2F | 1.1/4 Fin 4.Full Fin 7. |
| Other Units 0 | 3.HWRF 7.Electric 11.Geother | 2.1/2 Fin 5.FI/Stair 8. |
| Stories 0 | 4.Steam 8.FI/Wall 12.Heat/Co | 3.3/4 Fin 6. 9.None |
| 1.1 4.1.5 7. | Cool Type 0% 9 None | Insulation 0 |
| 2.2 5.1.75 8. | 1.Central 4.W&C Air 7. | 1.Full 4.Minimal 7. |
| 3.3 6.2.5 9. | 2.Evapor 5. 8. | 2.Heavy 5. 8. |
| Exterior Walls 0 | 3.H Pump 6. 9.None | 3.Capped 6. 9.None |
| 1.Clapboar 5.Stucco 9.B & B | Kitchen Style 0 | Unfinished % 0% |
| 2.Vin/Al 6.Brick 10.Cemplan | 1.Modern 4.Obsolete | Grade & Factor 0 0% |
| 3.Compos./ 7.Stone 11.Concret | 2.Typical 5. 8. | 1.E Grade 4.B Grade 7.SC Grade |
| 4.Asbestos 8.Wood Shi 12.Wood Bo | 3.Old Type 6. 9.None | 2.C Grade 5.A Grade 8. |
| Roof Surface 0 | Bath(s) Style 0 | 3.D Grade 6.AA Grade 9.Same |
| 1.Asphalt 4.Composit 7.Other | 1.Modern 4.Obsolete 7. | SQFT (Footprint) 0 |
| 2.Slate 5.Wood 8. | 2.Typical 5. 8. | 1.Poor Avg 7.V G |
| 3.Metal 6.Roll Roo 9. | 3.Old Type 6. 9.None | 2.Fair Avg 8.Exc |
| SF Masonry Trim 0 | # Rooms 0 | 3.Avg- Good 9.Same |
| SOLAR VOLTAIC 0 | # Bedrooms 0 | Phys. % Good 0% |
| OPEN-4- 0 | # Full Baths 0 | Funct. % Good 100% |
| Year Built 0 | # Half Baths 0 | Functional Code 9 None |
| Year Remodeled 0 | # Addn Fixtures 0 | 1.Incomp 4.Delap 5.Layoff |
| Foundation 0 | # Fireplaces 0 | 2.O-Built 5.Bsmt 8.Long term |
| 1.Concrete 4.Wood 7. | | 3.Damage 6.Style None |
| 2.C Block 5.Slab 8. | | Econ. % Good 100% |
| 3.Br/Stone 6.Piers 9. | | Economic Code None |
| Basement 0 | | 0.None 3.No Power 6.Obsolete |
| 1.1/4 Bmt 4.Full Bmt 7. | | 1.Location 4.Generate 9.None |
| 2.1/2 Bmt 5.Crwl 8. | | 2.Encroach 5.Flood Pl 9. |
| 3.3/4 Bmt 6. 9.None | | Entrance Code 0 |
| Bsmt Gar # Cars 0 | | 1.Interior 4.Vacant 7. |
| Wet Basement 0 | | 2.Refusal 5.Estimate 8. |
| 1.Dry 4. 7. | | 3.Informed 6. 9. |
| 2.Damp 5. 8. | | Information Code 0 |
| 3.Wet 6. 9. | | 1.Owner 4.Agent 7. |
| | | 2.Relative 5.Estimate 8. |
| | | 3.Tenant 6.Other 9. |



Date Inspected 9/11/2015

| Additions, Outbuildings & Improvements | | | | | | | |
|--|------|-------|-------|------|-------|--------|-------------------|
| Type | Year | Units | Grade | Cond | Phys. | Funct. | Sound Value |
| | | | | | % | % | 1.One Story Fram |
| | | | | | % | % | 2.Two Story Fram |
| | | | | | % | % | 3.Three Story Fr |
| | | | | | % | % | 4.1 & 1/2 Story |
| | | | | | % | % | 5.1 & 3/4 Story |
| | | | | | % | % | 6.2 & 1/2 Story |
| | | | | | % | % | 21.Open Frame Por |
| | | | | | % | % | 22.Encl Frame Por |
| | | | | | % | % | 23.Frame Garage |
| | | | | | % | % | 24.Frame Shed |
| | | | | | % | % | 25.Frame Bay Wind |
| | | | | | % | % | 26.1SFr Overhang |
| | | | | | % | % | 27.Unfin Basement |
| | | | | | % | % | 28.Unfinished Att |
| | | | | | % | % | 29.Finished Attic |



Proposed Value