

LAKE PROPERTY LLC - TENANT IN COMMON
 JOHNSON, EVERETT F JR - TENANT IN COMMON
 621 PRINCESS POINT ROAD
 YARMOUTH ME 04096

B35309P292

Previous Owner
 JOHNSON, EVERETT F

621 PRINCES POINT ROAD
 YARMOUTH ME 04096
 Sale Date: 11/26/2018

Previous Owner
 REDLON, RACHAEL A
 8014 SHARON DR

TAMPA FL 33617
 Sale Date: 3/30/2018

Inspection Witnessed By:

X _____ Date _____

No./Date	Description	Date Insp.

Notes:

Gray

Property Data		
Neighborhood	5 Little Sebago	
Tree Growth Year	0	
REVIEW	0	
Building Permit	0	
Zone/Land Use	12 Limited Residential	
Secondary Zone		
Topography	2 Rolling	4 Below Street
1. Hill	4. Below St	7.
2. Rolling	5. Low	8.
3. Above St	6. Swampy	9.
Utilities		
1. Public	4. Driv Well/Po	7. Cesspool
2. Water	5. Dug Well	8. Lake
3. Holding Ta	6. Septic	9. None
Street	3 Gravel	
1. Paved	4. Proposed	8.
2. Semi Imp	5. R/O/W	9.
3. Gravel	6.	
GIS Map	18	
Field Review	0	
Sale Data		
Sale Date	11/26/2018	
Price		
Sale Type	1 Land Only	
1. Land	4. Mobile	7. COM
2. L & B	5. Other	8.
3. Building	6. Condo	9.
Financing	9 Unknown	
1. Convent	4. Seller	7.
2. FHA/VA	5. Private	8.
3. Assumed	6. Cash	9. Unknown
Validity	2 Related Parties	
1. Valid	4. Split	7. Multiple
2. Related	5. Partial	8. Other
3. Distress	6. Exempt	9. Estate
Verified	5 Public Record	
1. Buyer	4. Agent	7. Family
2. Seller	5. Pub Rec	8. Other
3. Lender	6. MLS	9.

Assessment Record				
Year	Land	Buildings	Exempt	Total
2019	117,500	0	0	117,500
2020	117,500	0	0	117,500
2021	117,500	0	0	117,500
2022	117,500	0	0	117,500
2023	117,500	0	0	117,500
Calc.	243,700	0	0	243,700

Land Data					
Type	Effective		Influence		Influence Codes
	Frontage	Depth	Factor	Code	
11	110	000	50 %	6	1. Unimproved
			%		2. Excess Frtg
			%		3. Topography
			%		4. Size/Shape
			%		5. Access
			%		6. Restriction
			%		7. Open Space
			%		8. Environmental
			%		9. Condo
			%		30. Blueberry(1-20
			%		31. Blueberry(21 -
			%		32. Crop Land
			%		33. Pasture
			%		34. Shorefront B
			%		35. Shorefront C
35		0.13	50 %	6	36. ANTENNA SITE
			%		37. Softwood TG
			%		38. Mixed Wood TG
			%		39. Hardwood TG
			%		40. Wasteland
			%		41. Woodland
			%		42. Mobile Home Si
			%		43. Camp Site
			%		44. Lot Improvemen
			%		45. BA SF - Oce
			%		46. SP Meadow Cond
Total Acreage				0.13	

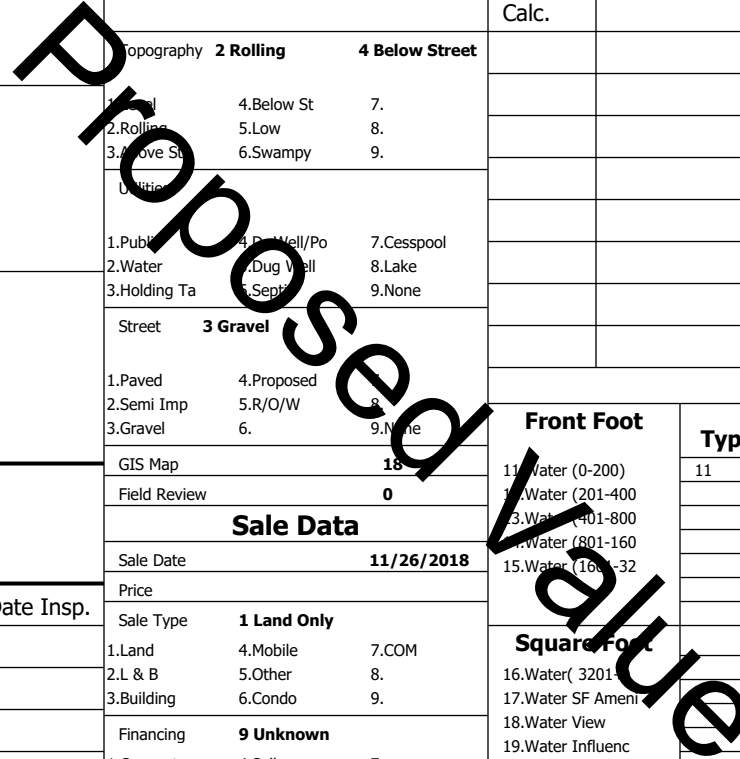

Gray

Map Lot 018-307-037-002

Account 4854

Location BIRCHWOOD RD

Card 1

Of 1

8/05/2024

Building Style	SF Bsmt Living						Layout
1.Conv.	5.Garrison	9.NE farm	Fin Bsmt Grade			1.Typical	4. 7.
2.Ranch	6.Split	10.Colonia	Secondary Heat			2.Inadeq	5. 8.
3.R Ranch/	7.Contemp	11.Cottage	Heat Type			3.	6. 9.
4.Cape	8.Log	12.Gambrel	1.HWBB	5.FWA	9.None	Attic	
Dwelling Units			2.HWCI	6.Monitor	10.UNH2F	1.1/4 Fin	4.Full Fin 7.
Other Units			3.HWRF	7.Electric	11.Geother	2.1/2 Fin	5.F/Stair 8.
Stories			4.Steam	8.F/Wall	12.Heat/Co	3.3/4 Fin	6. 9.None
1.1	4.1.5	7.	Cool Type			Insulation	
2.2	5.1.75	8.	1.Central	4.W&C Air	7.	1.Full	4.Minimal 7.
3.3	6.2.5	9.	2.Evapor	5.	8.	2.Heavy	5. 8.
Exterior Walls			3.H Pump	6.	9.None	3.Capped	6. 9.None
1.Clapboar	5.Stucco	9.B & B	Kitchen Style			Unfinished %	
2.Vin/Al	6.Brick	10.Cemplan	1.Modern	4.Obsolete	7.	Grade & Factor	
3.Compos./	7.Stone	11.Concret	2.Typical	5.	8.	1.E Grade	4.B Grade 7.SC Grade
4.Asbestos	8.Wood Shi	12.Wood Bo	3.Old Type	6.	9.None	2.D Grade	5.A Grade 8.
Roof Surface			Bath(s) Style			3.C Grade	6.AA Grade 9.Same
1.Asphalt	4.Composit	7.Other	1.Modern	4.Obsolete	7.	SQFT (Footprint)	
2.Slate	5.Wood	8.	2.Typical	5.	8.	Condition	
3.Metal	6.Roll Roo	9.	3.Old Type	6.	9.None	1.Poor	Avg 7.V G
SF Masonry Trim			# Rooms			2.Fair	3.Avg 8.Exc
SOLAR VOLTAIC			# Bedrooms			3.Avg-	4.Good 9.Same
OPEN-4-			# Full Baths			Phys. % Good	
Year Built			# Half Baths			Funct. % Good	
Year Remodeled			# Addn Fixtures			Functional Code	
Foundation			# Fireplaces			1.Incomp	4.Delap 5.Layoff
1.Concrete	4.Wood	7.				2.O-Built	5.Bsmt 8.Long term
2.C Block	5.Slab	8.				3.Damage	6.Style 9.None
3.Br/Stone	6.Piers	9.				Econ. % Good	
Basement						Economic Code	
1.1/4 Bmt	4.Full Bmt	7.				0.None	3.No Power 6.Obsolete
2.1/2 Bmt	5.Crwl	8.				1.Location	4.Generate 9.None
3.3/4 Bmt	6.	9.None				2.Encroach	5.Flood Pl 9.
Bsmt Gar # Cars						Entrance Code 0	
Wet Basement						Information Code 0	
1.Dry	4.	7.				1.Interior	4.Vacant 7.
2.Damp	5.	8.	2.Refusal	5.Estimate 8.			
3.Wet	6.	9.	3.Informed	6. 9.			
Date Inspected			Information Code 0				
			1.Owner	4.Agent 7.			
			2.Relative	5.Estimate 8.			
			3.Tenant	6.Other 9.			

Additions, Outbuildings & Improvements

Type	Year	Units	Grade	Cond	Phys.	Funct.	Sound Value
					%	%	1.One Story Fram
					%	%	2.Two Story Fram
					%	%	3.Three Story Fr
					%	%	4.1 & 1/2 Story
					%	%	5.1 & 3/4 Story
					%	%	6.2 & 1/2 Story
					%	%	21.Open Frame Por
					%	%	22.Encl Frame Por
					%	%	23.Frame Garage
					%	%	24.Frame Shed
					%	%	25.Frame Bay Wind
					%	%	26.1SFr Overhang
					%	%	27.Unfin Basement
					%	%	28.Unfinished Att
					%	%	29.Finished Attic

Proposed Value