

PHINNEY, HEATHER J  
309 MAYALL RD  
GRAY ME 04039

B16988P59

Inspection Witnessed By:

X

No./Date	Description	Date Insp.

Notes:  
5/24 DR FIELD REVIEW

Gray

Property Data		
Neighborhood	82 Average Location	
Tree Growth Year	0	
REVIEW	0	
Building Permit	0	
Zone/Land Use	15 Business Development	
Secondary Zone		
Topography	1 Level	3 Above Street
1. Level	4. Below St	7.
2. Rolling	5. Low	8.
3. Above St	6. Swampy	9.
Utilities	4. Filled Well/Point	6 Septic System
1. Public	4. Dry Well/Po	7. Cesspool
2. Water	5. Dug Well	8. Lake
3. Holding Ta	6. Septic	9. None
Street	1 Paved	
1. Paved	4. Proposed	8.
2. Semi Imp	5. R/O/W	9.
3. Gravel	6.	9. None
GIS Map	15	
Field Review	1	
Sale Data		
Sale Date	11/21/2001	
Price		
Sale Type		
1. Land	4. Mobile	7.COM
2. L & B	5. Other	8.
3. Building	6. Condo	9.
Financing		
1. Convent	4. Seller	7.
2. FHA/VA	5. Private	8.
3. Assumed	6. Cash	9. Unknown
Validity		
1. Valid	4. Split	7. Multiple
2. Related	5. Partial	8. Other
3. Distress	6. Exempt	9. Estate
Verified		
1. Buyer	4. Agent	7. Family
2. Seller	5. Pub Rec	8. Other
3. Lender	6. MLS	9.

Assessment Record				
Year	Land	Buildings	Exempt	Total
2012	49,200	124,336	8,500	165,036
2013	49,200	124,300	9,000	164,500
2014	49,200	124,300	9,000	164,500
2018	49,200	149,500	18,000	180,700
2019	68,300	108,000	20,000	156,300
2021	68,300	108,000	25,000	151,300
2022	68,300	126,100	25,000	169,400
2023	68,300	142,000	25,000	185,300
Calc.	139,200	265,700	25,000	379,900

Land Data					
Type	Effective		Influence		Influence Codes
	Frontage	Depth	Factor	Code	
11. Water (0-200)			%		1. Unimproved
12. Water (201-400)			%		2. Excess Frtg
13. Water (401-800)			%		3. Topography
14. Water (801-160)			%		4. Size/Shape
15. Water (1601-32)			%		5. Access
			%		6. Restriction
			%		7. Open Space
			%		8. Environmental
			%		9. Condo
Square Foot		Square Feet		Acres	
16. Water( 3201-			%		30. Blueberry(1-20
17. Water SF Amen			%		31. Blueberry(21 -
18. Water View			%		32. Crop Land
19. Water Influen			%		33. Pasture
20. ShoreFront A			%		34. Shorefront B
			%		35. Shorefront C
			%		36. ANTENNA SITE
21. Base Lot	21	1.84	100 %	0	37. Softwood TG
22. Base Lot Vacan	24	2.36	100 %	0	38. Mixed Wood TG
23. Base Lot Unpav			%		39. Hardwood TG
			%		40. Wasteland
			%		41. Woodland
			%		42. Mobile Home Si
			%		43. Camp Site
			%		44. Lot Improvemen
			%		45. BA SF - Oce
			%		46. SP Meadow Cond
<b>Total Acreage</b>		4.20			

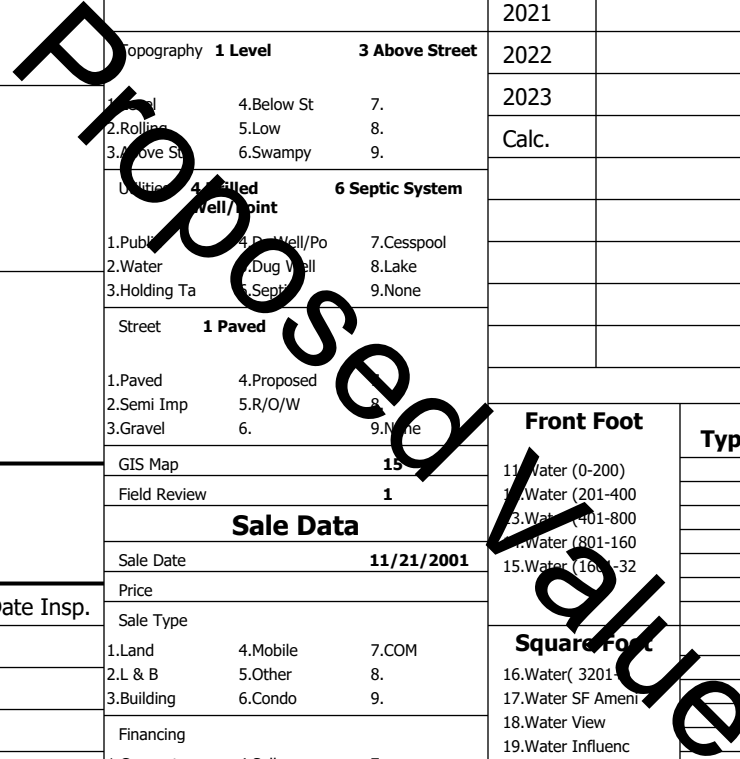

**Gray**

Map Lot 015-026-037-000

Account 1530

Location 309 MAYALL RD

Card 1 Of 2 8/05/2024

Building Style <b>1 Conventional</b>	SF Bsmt Living <b>0</b>	Layout <b>1 Typical</b>
1.Conv. 5.Garrison 9.NE farm	Fin Bsmt Grade <b>0 0</b>	1.Typical 4. 7.
2.Ranch 6.Split 10.Colonia	Secondary Heat <b>0</b>	2.Inadeq 5. 8.
3.R Ranch/ 7.Contemp 11.Cottage	Heat Type <b>100% 5 Forced Warm Air</b>	3. 6. 9.
4.Cape 8.Log 12.Gambrel	1.HWBB 5.FWA 9.None	Attic <b>9 None</b>
Dwelling Units <b>1</b>	2.HWCI 6.Monitor 10.UNH2F	1.1/4 Fin 4.Full Fin 7.
Other Units <b>0</b>	3.HWRF 7.Electric 11.Geother	2.1/2 Fin 5.FI/Stair 8.
Stories <b>4 One &amp; 1/2 Story</b>	4.Steam 8.FI/Wall 12.Heat/Co	3.3/4 Fin 6. 9.None
1.1 4.1.5 7.	Cool Type <b>0% 9 None</b>	Insulation <b>1 Full</b>
2.2 5.1.75 8.	1.Central 4.W&C Air 7.	1.Full 4.Minimal 7.
3.3 6.2.5 9.	2.Evapor 5. 8.	2.Heavy 5. 8.
Exterior Walls <b>2 Vinyl/Aluminum</b>	3.H Pump 6. 9.None	3.Capped 6. 9.None
1.Clapboard 5.Stucco 9.B & B	Kitchen Style <b>2 Typical</b>	Unfinished % <b>0%</b>
2.Vin/Al 6.Brick 10.Cemplan	1.Modern 4.Obsolete	Grade & Factor <b>2 Fair 110%</b>
3.Compos./ 7.Stone 11.Concret	2.Typical 5. 8.	1.E Grade 4.B Grade 7.SC Grade
4.Asbestos 8.Wood Shi 12.Wood Bo	3.Old Type 6. 9.None	2.C Grade 5.A Grade 8.
Roof Surface <b>1 Asphalt Shingles</b>	Bath(s) Style <b>2 Typical Bath(s)</b>	3.E Grade 6.AA Grade 9.Same
1.Asphalt 4.Composit 7.Other	1.Modern 4.Obsolete 7.	SQFT (Footprint) <b>420</b>
2.Slate 5.Wood 8.	2.Typical 5. 8.	Foundation <b>5 Good</b>
3.Metal 6.Roll Roo 9.	3.Old Type 6. 9.None	1.Poor 2.Avg 7.V G
SF Masonry Trim <b>0</b>	# Rooms <b>5</b>	2.Fair 3.Avg 8.Exc
SOLAR VOLTAIC <b>0</b>	# Bedrooms <b>2</b>	3.Avg- 9.Same
OPEN-4- <b>0</b>	# Full Baths <b>1</b>	Phys. % Good <b>0%</b>
Year Built <b>1920</b>	# Half Baths <b>0</b>	Funct. % Good <b>100%</b>
Year Remodeled <b>0</b>	# Addn Fixtures <b>0</b>	Functional Code <b>9 None</b>
Foundation <b>1 Concrete</b>	# Fireplaces <b>0</b>	1.Incomp 4.Delap 5.Delay
1.Concrete 4.Wood 7.		2.O-Built 5.Bsmt 6.Long term
2.C Block 5.Slab 8.		3.Damage 6.Style 9.None
3.Br/Stone 6.Piers 9.		Econ. % Good <b>100%</b>
Basement <b>4 Full Basement</b>		Economic Code <b>None</b>
1.1/4 Bmt 4.Full Bmt 7.		0.None 3.No Power 6.Obsolete
2.1/2 Bmt 5.Crw1 8.		1.Location 4.Generate 9.None
3.3/4 Bmt 6. 9.None		2.Encroach 5.Flood Pl 9.
Bsmt Gar # Cars <b>0</b>		Entrance Code <b>5 Estimated</b>
Wet Basement <b>1 Dry Basement</b>		1.Interior 4.Vacant 7.
1.Dry 4. 7.		2.Refusal 5.Estimate 8.
2.Damp 5. 8.		3.Informed 6. 9.
3.Wet 6. 9.		Information Code <b>5 Estimate</b>
		1.Owner 4.Agent 7.
		2.Relative 5.Estimate 8.
		3.Tenant 6.Other 9.

Date Inspected 5/10/2024

**Additions, Outbuildings & Improvements**

Type	Year	Units	Grade	Cond	Phys.	Funct.	Sound Value
11 1 Story/Basement	0	280	0 0	0	0 %	100 %	
1 One Story Frame	0	28	0 0	0	0 %	100 %	
22 Encl Frame Porch	0	72	0 0	0	0 %	100 %	
24 Frame Shed	0	330	0 0	0	0 %	100 %	
24 Frame Shed	0	240	3 100	4	0 %	100 %	
1 One Story Frame	0	280	0 0	0	0 %	100 %	
23 Frame Garage	2020	832	3 100	4	0 %	100 %	
43 2S Frame Garage	2023	896	3 100	4	0 %	100 %	
					%	%	
					%	%	

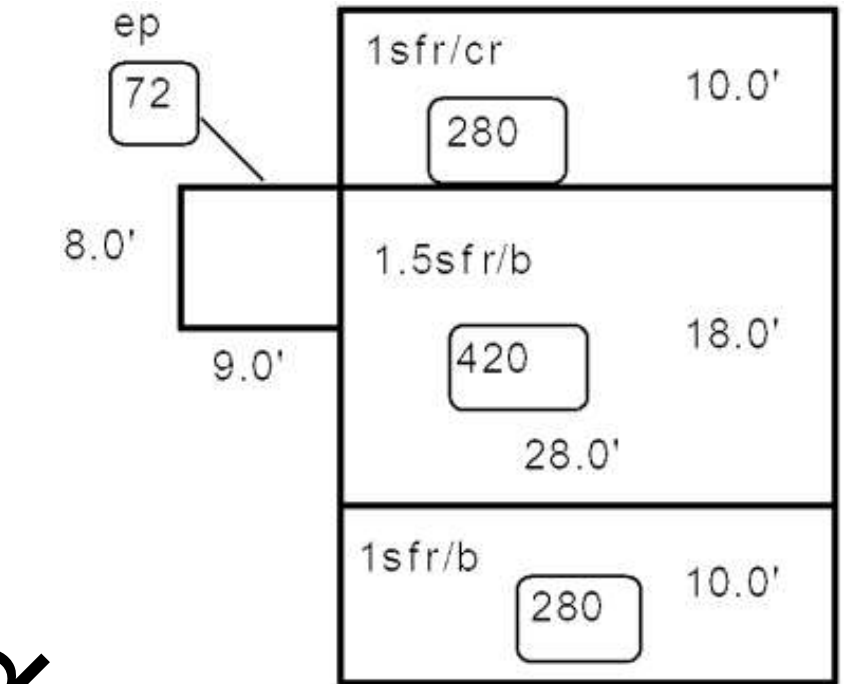

PHINNEY, HEATHER J  
309 MAYALL RD  
GRAY ME 04039

B16988P59

Property Data			Assessment Record				
Neighborhood	82 Average Location		Year	Land	Buildings	Exempt	Total
Tree Growth Year	0		2013	0	0	0	0
REVIEW	0		2014	0	0	0	0
Building Permit	0		2018	0	0	0	0
Zone/Land Use	15 Business Development		2019	0	118,200	0	118,200
Secondary Zone			2021	0	118,200	0	118,200
Topography	1 Level	3 Above Street	2022	0	118,200	0	118,200
			2023	0	134,200	0	134,200
			Calc.	0	231,300	0	231,300

Land Data		Front Foot		Effective		Influence		Influence Codes
Type		Frontage	Depth	Factor	Code			
11. Water (0-200)				%		1.Unimproved		
12. Water (201-400)				%		2.Excess Frtg		
13. Water (401-800)				%		3.Topography		
14. Water (801-160)				%		4.Size/Shape		
15. Water (1601-32)				%		5.Access		
				%		6.Restriction		
				%		7.Open Space		
				%		8.Environmental		
				%		9.Condo		
				%		30.Blueberry(1-20		
				%		31.Blueberry(21 -		
				%		32.Crop Land		
				%		33.Pasture		
				%		34.Shorefront B		
				%		35.Shorefront C		
				%		36.ANTENNA SITE		
				%		37.Softwood TG		
				%		38.Mixed Wood TG		
				%		39.Hardwood TG		
				%		40.Wasteland		
				%		41.Woodland		
				%		42.Mobile Home Si		
				%		43.Camp Site		
				%		44.Lot Improvemen		
				%		45.BA SF - Oce		
				%		46.SP Meadow Cond		
<b>Total Acreage</b>		0.00						

Inspection Witnessed By:

X	Date	Date Insp.
No./Date	Description	Date Insp.

Notes:  
5/24 DR FIELD REVIEW

Gray

