

WOOD, RICHARD C
WOOD, WAYNE T
C/O WAYNE T WOOD
GRAY ME 04039

B35398P112

Previous Owner
MITCHELL, JULIE E (DEWISEES)
ELLIOTT, KATHY (DEWISEES)
C/O MCRAE AND ASSOCIATES
PORTLAND ME 04103
Sale Date: 1/08/2019

Property Data			Assessment Record					
Neighborhood	82 Average Location		Year	Land	Buildings	Exempt	Total	
Tree Growth Year	0		2011	44,000	0	0	44,000	
REVIEW	0		2012	44,000	0	0	44,000	
Building Permit	0		2013	44,000	0	0	44,000	
Zone/Land Use	11 Rural Residential & Agri		2014	44,000	0	0	44,000	
Secondary Zone	25 Stream Protection		2015	44,000	0	0	44,000	
Topography	2 Rolling		2016	44,000	0	0	44,000	
1. Above St	4. Below St	7.	2017	44,000	0	0	44,000	
2. Rolling	5. Low	8.	2018	44,000	0	0	44,000	
3. Above St	6. Swampy	9.	2019	65,200	0	0	65,200	
4. Dug Well	7. Cesspool		2020	73,200	0	0	73,200	
1. Public	4. Dug Well/Po	7. Cesspool	2021	44,600	0	0	44,600	
2. Water	5. Dug Well	8. Lake	2022	44,600	0	0	44,600	
3. Holding Ta	6. Septic	9. None	2023	49,100	0	0	49,100	
Street	1 Paved		Calc.	105,000	0	0	105,000	
1. Paved	4. Proposed		Land Data					
2. Semi Imp	5. R/O/W	8.	Front Foot	Type	Effective	Influence	Influence	
3. Gravel	6.	9. None	11. Water (0-200)		Frontage	Depth	Factor	Code
GIS Map	15		12. Water (201-400)				%	1. Unimproved
Field Review	1		13. Water (401-800)				%	2. Excess Frtg
Sale Data			14. Water (801-160)				%	3. Topography
Sale Date	1/08/2019		15. Water (161-32)				%	4. Size/Shape
Price	84,000		16. Water (321-3200)				%	5. Access
Sale Type	1 Land Only		17. Water SF Amen				%	6. Restriction
1. Land	4. Mobile	7.COM	18. Water View				%	7. Open Space
2. L & B	5. Other	8.	19. Water Influen				%	8. Environmental
3. Building	6. Condo	9.	20. ShoreFront A				%	9. Condo
Financing			Square Foot		Square Feet			Acres
9 Unknown			16. Water (3201-3200)				%	30. Blueberry(1-20
1. Convent	4. Seller	7.	17. Water SF Amen				%	31. Blueberry(21 -
2. FHA/VA	5. Private	8.	18. Water View				%	32. Crop Land
3. Assumed	6. Cash	9.Unknown	19. Water Influen				%	33. Pasture
Validity			Fract. Acre		Acres/Sites			34. Shorefront B
1 Arms Length Sale			21. Base Lot	22	1.84	100	%	35. Shorefront C
1. Valid	4. Split	7. Multiple	22. Base Lot Vacan	24	0.16	100	%	36. ANTENNA SITE
2. Related	5. Partial	8. Other	23. Base Lot Unpav	33	11.67	100	%	37. Softwood TG
3. Distress	6. Exempt	9. Estate	Acres				%	38. Mixed Wood TG
Verified			24. Acres to 10				%	39. Hardwood TG
5 Public Record			25. Acres 11-30				%	40. Wasteland
1. Buyer	4. Agent	7. Family	26. Acres 31-50				%	41. Woodland
2. Seller	5. Pub Rec	8. Other	27. Acres 51& over				%	42. Mobile Home Si
3. Lender	6. MLS	9.	28. Acres 71 & Ove				%	43. Camp Site
			29. Woods (41+)				%	44. Lot Improvemen
			Total Acreage		13.67			45. BA SF - Oce
								46. SP Meadow Cond

Inspection Witnessed By:

X	Date	Description	Date Insp.

Notes:
5/24 DR FIELD REVIEW

Gray

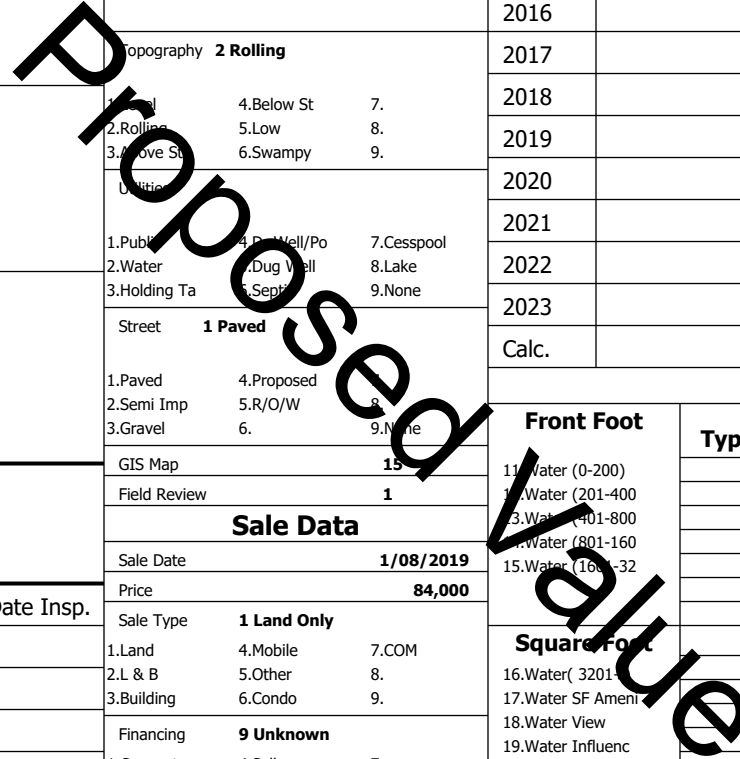

Gray

Map Lot 015-021-004-000

Account 1094

Location 343 MAYALL RD

Card 1

Of 1

8/05/2024

Building Style 0	SF Bsmt Living 0	Layout 0
1.Conv. 5.Garrison 9.NE farm	Fin Bsmt Grade 0 0	1.Typical 4. 7.
2.Ranch 6.Split 10.Colonia	Secondary Heat 0	2.Inadeq 5. 8.
3.R Ranch/ 7.Contemp 11.Cottage	Heat Type 100% 0	3. 6. 9.
4.Cape 8.Log 12.Gambrel	1.HWBB 5.FWA 9.None	Attic 0
Dwelling Units 0	2.HWCI 6.Monitor 10.UNH2F	1.1/4 Fin 4.Full Fin 7.
Other Units 0	3.HWRF 7.Electric 11.Geother	2.1/2 Fin 5.FI/Stair 8.
Stories 0	4.Steam 8.FI/Wall 12.Heat/Co	3.3/4 Fin 6. 9.None
1.1 4.1.5 7.	Cool Type 0% 9 None	Insulation 0
2.2 5.1.75 8.	1.Central 4.W&C Air 7.	1.Full 4.Minimal 7.
3.3 6.2.5 9.	2.Evapor 5. 8.	2.Heavy 5. 8.
Exterior Walls 0	3.H Pump 6. 9.None	3.Capped 6. 9.None
1.Clapboar 5.Stucco 9.B & B	Kitchen Style 0	Unfinished % 0%
2.Vin/Al 6.Brick 10.Cemplan	1.Modern 4.Obsolete	Grade & Factor 0 0%
3.Compos./ 7.Stone 11.Concret	2.Typical 5. 8.	1.E Grade 4.B Grade 7.SC Grade
4.Asbestos 8.Wood Shi 12.Wood Bo	3.Old Type 6. 9.None	2.C Grade 5.A Grade 8.
Roof Surface 0	Bath(s) Style 0	3.C Grade 6.AA Grade 9.Same
1.Asphalt 4.Composit 7.Other	1.Modern 4.Obsolete 7.	SQFT (Footprint) 0
2.Slate 5.Wood 8.	2.Typical 5. 8.	1.Poor Avg 7.V G
3.Metal 6.Roll Roo 9.	3.Old Type 6. 9.None	2.Fair Avg 8.Exc
SF Masonry Trim 0	# Rooms 0	3.Avg- Good 9.Same
SOLAR VOLTAIC 0	# Bedrooms 0	Phys. % Good 0%
OPEN-4- 0	# Full Baths 0	Funct. % Good 0%
Year Built 0	# Half Baths 0	Functional Code 9 None
Year Remodeled 0	# Addn Fixtures 0	1.Incomp 4.Delap 9.No Plan
Foundation 0	# Fireplaces 0	2.O-Built 5.Bsmt 8.Long term
1.Concrete 4.Wood 7.		3.Damage 6.Style None
2.C Block 5.Slab 8.		Econ. % Good 100%
3.Br/Stone 6.Piers 9.		Economic Code None
Basement 0		0.None 3.No Power 6.Obsolete
1.1/4 Bmt 4.Full Bmt 7.		1.Location 4.Generate 9.None
2.1/2 Bmt 5.Crwl 8.		2.Encroach 5.Flood Pl 9.
3.3/4 Bmt 6. 9.None		Entrance Code 5 Estimated
Bsmt Gar # Cars 0		1.Interior 4.Vacant 7.
Wet Basement 0		2.Refusal 5.Estimate 8.
1.Dry 4. 7.		3.Informed 6. 9.
2.Damp 5. 8.		Information Code 5 Estimate
3.Wet 6. 9.		1.Owner 4.Agent 7.
		2.Relative 5.Estimate 8.
		3.Tenant 6.Other 9.



Date Inspected 5/10/2024

Additions, Outbuildings & Improvements							
Type	Year	Units	Grade	Cond	Phys.	Funct.	Sound Value
					%	%	1.One Story Fram
					%	%	2.Two Story Fram
					%	%	3.Three Story Fr
					%	%	4.1 & 1/2 Story
					%	%	5.1 & 3/4 Story
					%	%	6.2 & 1/2 Story
					%	%	21.Open Frame Por
					%	%	22.Encl Frame Por
					%	%	23.Frame Garage
					%	%	24.Frame Shed
					%	%	25.Frame Bay Wind
					%	%	26.1SFr Overhang
					%	%	27.Unfin Basement
					%	%	28.Unfinished Att
					%	%	29.Finished Attic

Proposed Value