

HILT, JORDAN TAYLOR
PRISCILLA, CHARITY WISDOM
177 WEYMOUTH ROAD
GRAY ME 04039

B40419P4

Previous Owner
BEAL, HANNAH A
FAUST, TIMOTHY
177 WEYMOUTH ROAD
GRAY ME 04039
Sale Date: 10/13/2023

Previous Owner
SMITH, JEAN D
177 WEYMOUTH ROAD
GRAY ME 04039
Sale Date: 8/06/2020

Inspection Witnessed By:

X	Date	Description	Date Insp.

Notes:
5/24- DR FIELD REVIEW

Gray

Property Data		
Neighborhood	82 Average Location	
Tree Growth Year	0	
REVIEW	0	
Building Permit	0	
Zone/Land Use	11 Rural Residential & Agri	
Secondary Zone		
Topography	1 Level	
1. Hill	4. Below St	7.
2. Rolling	5. Low	8.
3. Above St	6. Swampy	9.
Utilities	2 Public Water 6 Septic System	
1. Public	4. Dr. Well/Po	7. Cesspool
2. Water	5. Dug Well	8. Lake
3. Holding Ta	6. Septic	9. None
Street	1 Paved	
1. Paved	4. Proposed	8.
2. Semi Imp	5. R/O/W	9.
3. Gravel	6.	
GIS Map	14	
Field Review	1	
Sale Data		
Sale Date	10/13/2023	
Price	355,000	
Sale Type	2 Land & Buildings	
1. Land	4. Mobile	7. COM
2. L & B	5. Other	8.
3. Building	6. Condo	9.
Financing	1 Conventional	
1. Convent	4. Seller	7.
2. FHA/VA	5. Private	8.
3. Assumed	6. Cash	9. Unknown
Validity	1 Arms Length Sale	
1. Valid	4. Split	7. Multiple
2. Related	5. Partial	8. Other
3. Distress	6. Exempt	9. Estate
Verified	5 Public Record	
1. Buyer	4. Agent	7. Family
2. Seller	5. Pub Rec	8. Other
3. Lender	6. MLS	9.

Assessment Record				
Year	Land	Buildings	Exempt	Total
2011	42,000	81,406	13,600	109,806
2012	42,000	81,406	13,600	109,806
2013	42,000	81,406	13,600	109,806
2014	42,000	83,465	13,600	111,865
2015	42,000	103,800	14,400	131,400
2016	42,000	103,800	14,400	131,400
2017	42,000	106,100	18,900	129,200
2018	42,000	106,100	23,400	124,700
2019	60,100	131,900	26,000	166,000
2020	60,100	131,900	26,000	166,000
2021	60,100	131,900	31,000	161,000
2022	60,100	146,700	0	206,800
2023	60,100	163,000	0	223,100
Calc.	117,600	232,300	0	349,900

Land Data					
Type	Effective		Influence		Influence Codes
	Frontage	Depth	Factor	Code	
1. Water (0-200)			%		1. Unimproved
2. Water (201-400)			%		2. Excess Frtg
3. Water (401-800)			%		3. Topography
4. Water (801-160)			%		4. Size/Shape
5. Water (1601-32)			%		5. Access
			%		6. Restriction
			%		7. Open Space
			%		8. Environmental
			%		9. Condo
Square Foot		Square Feet		Acres	
16. Water (3201			%		30. Blueberry(1-20
17. Water SF Amen			%		31. Blueberry(21 -
18. Water View			%		32. Crop Land
19. Water Influen			%		33. Pasture
20. ShoreFront A			%		34. Shorefront B
			%		35. Shorefront C
			%		36. ANTENNA SITE
			%		37. Softwood TG
			%		38. Mixed Wood TG
			%		39. Hardwood TG
			%		40. Wasteland
			%		41. Woodland
			%		42. Mobile Home Si
			%		43. Camp Site
			%		44. Lot Improvemen
			%		45. BA SF - Oce
			%		46. SP Meadow Cond
Total Acreage		1.00			

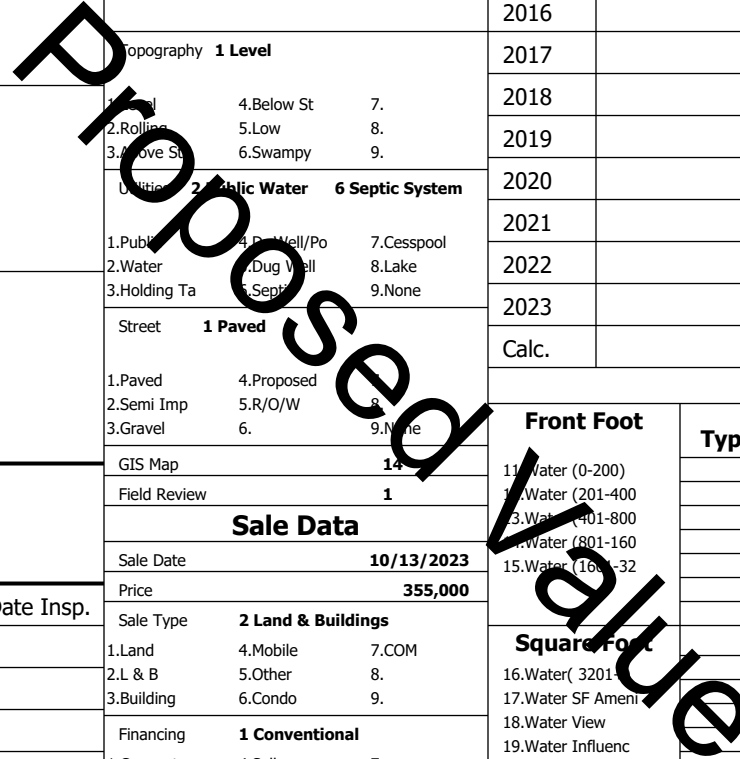

Gray

Map Lot 014-102-088-000

Account 3029

Location 177 WEYMOUTH RD

Card 1

Of 1

8/05/2024

Building Style 1 Conventional	SF Bsmt Living 400	Layout 1 Typical
1.Conv. 5.Garrison 9.NE farm	Fin Bsmt Grade 3 100	1.Typical 4. 7.
2.Ranch 6.Split 10.Colonia	Secondary Heat 8	2.Inadeq 5. 8.
3.R Ranch/ 7.Contemp 11.Cottage	Heat Type 100% 5 Forced Warm Air	3. 6. 9.
4.Cape 8.Log 12.Gambrel	1.HWBB 5.FWA 9.None	Attic 4 Full Finished
Dwelling Units 1	2.HWCI 6.Monitor 10.UNH2F	1.1/4 Fin 4.Full Fin 7.
Other Units 0	3.HWRF 7.Electric 11.Geother	2.1/2 Fin 5.FI/Stair 8.
Stories 1 One Story	4.Steam 8.FI/Wall 12.Heat/Co	3.3/4 Fin 6. 9.None
1.1 4.1.5 7.	Cool Type 50% 4 Warm & Cool Air	Insulation 1 Full
2.2 5.1.75 8.	1.Central 4.W&C Air 7.	1.Full 4.Minimal 7.
3.3 6.2.5 9.	2.Evapor 5. 8.	2.Heavy 5. 8.
Exterior Walls 2 Vinyl/Aluminum	3.H Pump 6. 9.None	3.Capped 6. 9.None
1.Clapboar 5.Stucco 9.B & B	Kitchen Style 1 Modern	Unfinished % 0%
2.Vin/Al 6.Brick 10.Cemplan	1.Modern 4.Obsolete	Grade & Factor 3 Average 100%
3.Compos./ 7.Stone 11.Concret	2.Typical 5. 8.	1.E Grade 4.B Grade 7.SC Grade
4.Asbestos 8.Wood Shi 12.Wood Bo	3.Old Type 6. 9.None	2.O Grade 5.A Grade 8.
Roof Surface 3 Metal	Bath(s) Style 2 Typical Bath(s)	3.O Grade 6.AA Grade 9.Same
1.Asphalt 4.Composit 7.Other	1.Modern 4.Obsolete 7.	SQFT (Footprint) 768
2.Slate 5.Wood 8.	2.Typical 5. 8.	Condition 4 Average
3.Metal 6.Roll Roo 9.	3.Old Type 6. 9.None	1.Poor 2.Avg 7.V G
SF Masonry Trim 0	# Rooms 8	2.Fair 3.Avg 8.Exc
SOLAR VOLTAIC 0	# Bedrooms 3	3.Avg- 4.Good 9.Same
OPEN-4- 0	# Full Baths 1	Phys. % Good 0%
Year Built 1945	# Half Baths 1	Funct. % Good 100%
Year Remodeled 0	# Addn Fixtures 0	Functional Code 9 None
Foundation 2 Concrete Block	# Fireplaces 1	1.Incomp 4.Delap 5.Playoff
1.Concrete 4.Wood 7.		2.O-Built 5.Bsmt 6.Long term
2.C Block 5.Slab 8.		3.Damage 6.Style 7.None
3.Br/Stone 6.Piers 9.		Econ. % Good 100%
Basement 4 Full Basement		Economic Code None
1.1/4 Bmt 4.Full Bmt 7.		0.None 3.No Power 6.Obsolete
2.1/2 Bmt 5.Crwl 8.		1.Location 4.Generate 9.None
3.3/4 Bmt 6. 9.None		2.Encroach 5.Flood Pl 9.
Bsmt Gar # Cars 0		Entrance Code 5 Estimated
Wet Basement 1 Dry Basement		1.Interior 4.Vacant 7.
1.Dry 4. 7.		2.Refusal 5.Estimate 8.
2.Damp 5. 8.		3.Informed 6. 9.
3.Wet 6. 9.		Information Code 5 Estimate
		1.Owner 4.Agent 7.
		2.Relative 5.Estimate 8.
		3.Tenant 6.Other 9.

Date Inspected 5/16/2024

Additions, Outbuildings & Improvements

Type	Year	Units	Grade	Cond	Phys.	Funct.	Sound Value
1 One Story Frame	1998	280	0 0	0	0	100 %	1.One Story Fram
1 One Story Frame	0	192	0 0	0	0	100 %	2.Two Story Fram
73 1.25 St Garage	2013	960	0 0	0	0	100 %	3.Three Story Fr
71 Carport	2013	300	3 100	4	0	100 %	4.1 & 1/2 Story
68 Wood Deck	2013	322	3 100	4	0	100 %	5.1 & 3/4 Story
21 Open Frame	2013	102	3 100	4	0	100 %	6.2 & 1/2 Story
21 Open Frame	0	40	0 0	0	0	100 %	21.Open Frame Por
71 Carport	2014	322	3 100	4	0	100 %	22.Encl Frame Por
90 Generator	2020	1	0 0	0	0	100 %	23.Frame Garage
							24.Frame Shed
							25.Frame Bay Wind
							26.1SFr Overhang
							27.Unfin Basement
							28.Unfinished Att
							29.Finished Attic

