

CORCORAN, BRUCE B
CORCORAN, JACQUELINE MARIE
87 WEYMOUTH RD
GRAY ME 04039

B11332P234

Property Data			Assessment Record						
Neighborhood 82 Average Location			Year	Land	Buildings	Exempt	Total		
Tree Growth Year 0			2011	47,000	79,999	8,500	118,499		
REVIEW 0			2012	47,000	79,999	8,500	118,499		
Building Permit 0			2013	47,000	79,999	8,500	118,499		
Zone/Land Use 11 Rural Residential & Agri			2014	47,000	87,410	8,500	125,910		
Secondary Zone			2015	47,000	87,400	9,000	125,400		
Topography 1 Level			2016	47,000	87,400	9,000	125,400		
1. Hill 4. Below St 7.			2017	47,000	84,800	13,500	118,300		
2. Rolling 5. Low 8.			2018	47,000	84,800	18,000	113,800		
3. Above St 6. Swampy 9.			2019	70,500	124,700	20,000	175,200		
Utilities 4. Filled Well/Point 6 Septic System			2020	70,500	124,700	20,000	175,200		
1. Public 4. Dug Well/Po 7. Cesspool			2021	70,500	124,700	25,000	170,200		
2. Water 8. Lake			2022	70,500	124,700	25,000	170,200		
3. Holding Ta 9. None			2023	70,500	140,900	25,000	186,400		
Street 1 Paved			Calc.	126,000	207,100	25,000	308,100		
1. Paved 4. Proposed			Land Data						
2. Semi Imp 5. R/O/W			Front Foot	Type	Effective		Influence		Influence Codes
3. Gravel 6. None					Frontage	Depth	Factor	Code	
GIS Map 14			11. Water (0-200)				%		1. Unimproved
Field Review 1			12. Water (201-400)				%		2. Excess Frtg
Sale Data			13. Water (401-800)				%		3. Topography
Sale Date 3/15/1994			14. Water (801-160)				%		4. Size/Shape
Price			15. Water (161-32)				%		5. Access
Sale Type			Square Foot				%		6. Restriction
1. Land 4. Mobile 7.COM			Square Feet				%		7. Open Space
2. L & B 5. Other 8.			16. Water (3201-				%		8. Environmental
3. Building 6. Condo 9.			17. Water SF Amen				%		9. Condo
Financing			18. Water View				%		Acres
1. Convent 4. Seller 7.			19. Water Influen				%		30. Blueberry(1-20
2. FHA/VA 5. Private 8.			20. ShoreFront A				%		31. Blueberry(21 -
3. Assumed 6. Cash 9.Unknown			Fract. Acre				%		32. Crop Land
Validity			21. Base Lot	21	1.84	100	%	0	33. Pasture
1. Valid 4. Split 7. Multiple			22. Base Lot Vacan	24	0.16	100	%	0	34. Shorefront B
2. Related 5. Partial 8. Other			23. Base Lot Unpav				%		35. Shorefront C
3. Distress 6. Exempt 9. Estate			Acres				%		36. ANTENNA SITE
Verified			24. Acres to 10				%		37. Softwood TG
1. Buyer 4. Agent 7. Family			25. Acres 11-30				%		38. Mixed Wood TG
2. Seller 5. Pub Rec 8. Other			26. Acres 31-50				%		39. Hardwood TG
3. Lender 6. MLS 9.			27. Acres 51& over				%		40. Wasteland
			28. Acres 71 & Ove				%		41. Woodland
			29. Woods (41+)				%		42. Mobile Home Si
			Total Acreage		2.00				43. Camp Site

Inspection Witnessed By:

X	Date	Date Insp.
No./Date	Description	Date Insp.

Notes:
5/24- DR FIELD REVIEW

Gray

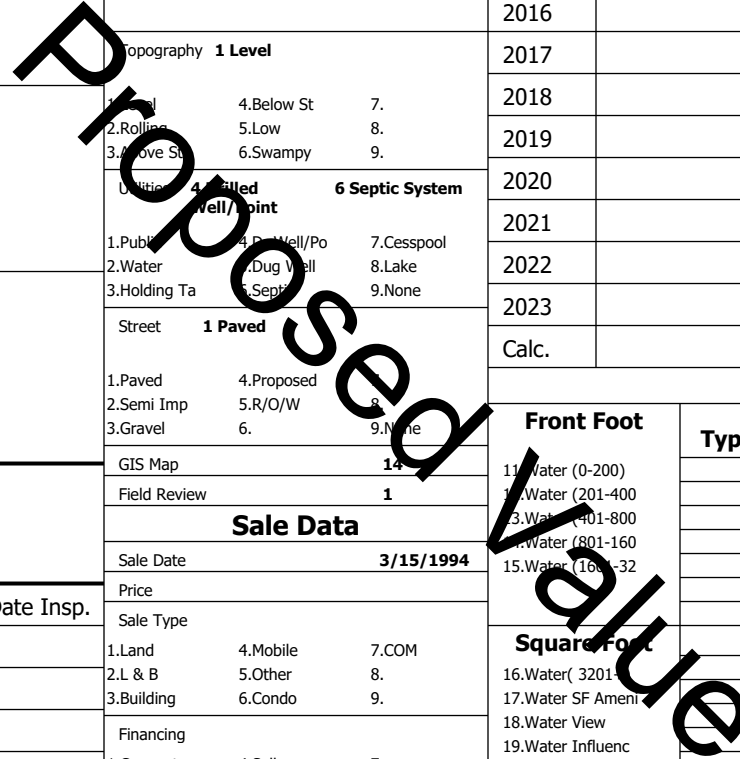

Gray

Map Lot 014-021-026-002

Account 1133

Location 87 WEYMOUTH RD

Card 1

Of 1

8/05/2024

Building Style 2 Ranch	SF Bsmt Living 800	Layout 1 Typical
1.Conv. 5.Garrison 9.NE farm	Fin Bsmt Grade 3 100	1.Typical 4. 7.
2.Ranch 6.Split 10.Colonia	Secondary Heat 0	2.Inadeq 5. 8.
3.R Ranch/ 7.Contemp 11.Cottage	Heat Type 100% 1 Hot Water BB	3. 6. 9.
4.Cape 8.Log 12.Gambrel	1.HWBB 5.FWA 9.None	Attic 9 None
Dwelling Units 1	2.HWCI 6.Monitor 10.UNH2F	1.1/4 Fin 4.Full Fin 7.
Other Units 0	3.HWRF 7.Electric 11.Geother	2.1/2 Fin 5.F/Stair 8.
Stories 1 One Story	4.Steam 8.F/Wall 12.Heat/Co	3.3/4 Fin 6. 9.None
1.1 4.1.5 7.	Cool Type 0% 9 None	Insulation 1 Full
2.2 5.1.75 8.	1.Central 4.W&C Air 7.	1.Full 4.Minimal 7.
3.3 6.2.5 9.	2.Evapor 5. 8.	2.Heavy 5. 8.
Exterior Walls 1 Clapboard	3.H Pump 6. 9.None	3.Capped 6. 9.None
1.Clapboar 5.Stucco 9.B & B	Kitchen Style 2 Typical	Unfinished % 0%
2.Vin/Al 6.Brick 10.Cemplan	1.Modern 4.Obsolete	Grade & Factor 3 Average 100%
3.Compos./ 7.Stone 11.Concret	2.Typical 5. 8.	1.E Grade 4.B Grade 7.SC Grade
4.Asbestos 8.Wood Shi 12.Wood Bo	3.Old Type 6. 9.None	2.O Grade 5.A Grade 8.
Roof Surface 1 Asphalt Shingles	Bath(s) Style 2 Typical Bath(s)	3.O Grade 6.AA Grade 9.Same
1.Asphalt 4.Composit 7.Other	1.Modern 4.Obsolete 7.	SQFT (Footprint) 864
2.Slate 5.Wood 8.	2.Typical 5. 8.	Condition 2 Average
3.Metal 6.Roll Roo 9.	3.Old Type 6. 9.None	1.Poor 2.Avg 7.V G
SF Masonry Trim 0	# Rooms 6	2.Fair 3.Good 8.Exc
SOLAR VOLTAIC 0	# Bedrooms 3	3.Avg- 4.Good 9.Same
OPEN-4- 0	# Full Baths 1	Phys. % Good 0%
Year Built 1984	# Half Baths 1	Funct. % Good 100%
Year Remodeled 0	# Addn Fixtures 0	Functional Code 9 None
Foundation 1 Concrete	# Fireplaces 0	1.Incomp 4.Delap 5.Damage 6.None
1.Concrete 4.Wood 7.		2.O-Built 5.Bsmt 6.Long Term
2.C Block 5.Slab 8.		3.Damage 6.Style
3.Br/Stone 6.Piers 9.		Econ. % Good 100%
Basement 4 Full Basement		Economic Code None
1.1/4 Bmt 4.Full Bmt 7.		0.None 3.No Power 6.Obsolete
2.1/2 Bmt 5.Crwl 8.		1.Location 4.Generate 9.None
3.3/4 Bmt 6. 9.None		2.Encroach 5.Flood Pl 9.
Bsmt Gar # Cars 0		Entrance Code 5 Estimated
Wet Basement 1 Dry Basement		1.Interior 4.Vacant 7.
1.Dry 4. 7.		2.Refusal 5.Estimate 8.
2.Damp 5. 8.	3.Informed 6. 9.	
3.Wet 6. 9.	Information Code 5 Estimate	
	1.Owner 4.Agent 7.	
	2.Relative 5.Estimate 8.	
	3.Tenant 6.Other 9.	

Date Inspected 5/16/2024

Additions, Outbuildings & Improvements

Type	Year	Units	Grade	Cond	Phys.	Funct.	Sound Value
22 Encl Frame Porch	1984	140	0 0	0	0	100 %	1.One Story Fram
62 Patio	0	216	0 0	0	0	100 %	2.Two Story Fram
73 1.25 St Garage	0	832	3 100	4	0	100 %	3.Three Story Fr
24 Frame Shed	0	80	2 100	2	0	100 %	4.1 & 1/2 Story
68 Wood Deck	1984	48	0 0	0	0	100 %	5.1 & 3/4 Story
68 Wood Deck	1984	37	0 0	0	0	100 %	6.2 & 1/2 Story
						%	21.Open Frame Por
						%	22.Encl Frame Por
						%	23.Frame Garage
						%	24.Frame Shed
						%	25.Frame Bay Wind
						%	26.1SFr Overhang
						%	27.Unfin Basement
						%	28.Unfinished Att
						%	29.Finished Attic

