

MAINE TURNPIKE AUTHORITY
2360 CONGRESS ST
PORTLAND ME 04102

B38463P214

Previous Owner
CORCORAN (DEVISEES), PHYLLIS I
C/O EARLE M. CUMMINGS PERS REP
44 NASH ROAD
WINDHAM ME 04062
Sale Date: 7/26/2021

Previous Owner
CORCORAN, PHYLLIS I
93 WEYMOUTH RD

GRAY ME 04039
Sale Date: 12/26/2019

Inspection Witnessed By:

| X | Date | Description | Date Insp. |
|---|------|-------------|------------|
| | | | |
| | | | |
| | | | |

Notes:

Gray

| Property Data | | |
|------------------|-----------------------------|-------------|
| Neighborhood | 82 Average Location | |
| Tree Growth Year | 0 | |
| REVIEW | 0 | |
| Building Permit | 0 | |
| Zone/Land Use | 11 Rural Residential & Agri | |
| Secondary Zone | 24 Resource Protection | |
| Topography | 2 Rolling | |
| 1. Soil | 4. Below St | 7. |
| 2. Rolling | 5. Low | 8. |
| 3. Above St | 6. Swampy | 9. |
| 1. Public | 4. Dug Well/Po | 7. Cesspool |
| 2. Water | 5. Dug Well | 8. Lake |
| 3. Holding Ta | 6. Septic | 9. None |
| Street | 9 None | |
| 1. Paved | 4. Proposed | 8. |
| 2. Semi Imp | 5. R/O/W | 9. |
| 3. Gravel | 6. | 9. None |
| GIS Map | 14 | |
| Field Review | 1 | |
| Sale Data | | |
| Sale Date | 7/26/2021 | |
| Price | 3,500 | |
| Sale Type | 1 Land Only | |
| 1. Land | 4. Mobile | 7. COM |
| 2. L & B | 5. Other | 8. |
| 3. Building | 6. Condo | 9. |
| Financing | 9 Unknown | |
| 1. Convent | 4. Seller | 7. |
| 2. FHA/VA | 5. Private | 8. |
| 3. Assumed | 6. Cash | 9. Unknown |
| Validity | 6 Exempt Property | |
| 1. Valid | 4. Split | 7. Multiple |
| 2. Related | 5. Partial | 8. Other |
| 3. Distress | 6. Exempt | 9. Estate |
| Verified | 5 Public Record | |
| 1. Buyer | 4. Agent | 7. Family |
| 2. Seller | 5. Pub Rec | 8. Other |
| 3. Lender | 6. MLS | 9. |

| Assessment Record | | | | |
|-------------------|--------|-----------|--------|-------|
| Year | Land | Buildings | Exempt | Total |
| 2011 | 6,500 | 0 | 0 | 6,500 |
| 2012 | 6,500 | 0 | 0 | 6,500 |
| 2013 | 6,500 | 0 | 0 | 6,500 |
| 2014 | 6,500 | 0 | 0 | 6,500 |
| 2015 | 6,500 | 0 | 0 | 6,500 |
| 2016 | 6,500 | 0 | 0 | 6,500 |
| 2017 | 6,500 | 0 | 0 | 6,500 |
| 2018 | 6,500 | 0 | 0 | 6,500 |
| 2019 | 7,500 | 0 | 0 | 7,500 |
| 2020 | 7,500 | 0 | 0 | 7,500 |
| 2021 | 7,500 | 0 | 0 | 7,500 |
| 2022 | 7,500 | 0 | 0 | 7,500 |
| 2023 | 7,500 | 0 | 7,500 | 0 |
| Calc. | 15,000 | 0 | 15,000 | 0 |

| Land Data | | | | | |
|--------------------|-----------|-------|-----------|------|--------------------|
| Type | Effective | | Influence | | Influence Codes |
| | Frontage | Depth | Factor | Code | |
| 1. Water (0-200) | | | % | | 1. Unimproved |
| 2. Water (201-400) | | | % | | 2. Excess Frtg |
| 3. Water (401-800) | | | % | | 3. Topography |
| 4. Water (801-160) | | | % | | 4. Size/Shape |
| 5. Water (1601-32) | | | % | | 5. Access |
| | | | % | | 6. Restriction |
| | | | % | | 7. Open Space |
| | | | % | | 8. Environmental |
| | | | % | | 9. Condo |
| Acres | | | | | |
| | | | % | | 30. Blueberry(1-20 |
| | | | % | | 31. Blueberry(21 - |
| | | | % | | 32. Crop Land |
| | | | % | | 33. Pasture |
| | | | % | | 34. Shorefront B |
| | | | % | | 35. Shorefront C |
| | | | % | | 36. ANTENNA SITE |
| | | | % | | 37. Softwood TG |
| | | | % | | 38. Mixed Wood TG |
| | | | % | | 39. Hardwood TG |
| | | | % | | 40. Wasteland |
| | | | % | | 41. Woodland |
| | | | % | | 42. Mobile Home Si |
| | | | % | | 43. Camp Site |
| | | | % | | 44. Lot Improvemen |
| | | | % | | 45. BA SF - Oce |
| | | | % | | 46. SP Meadow Cond |
| Total Acreage | | 2.50 | | | |

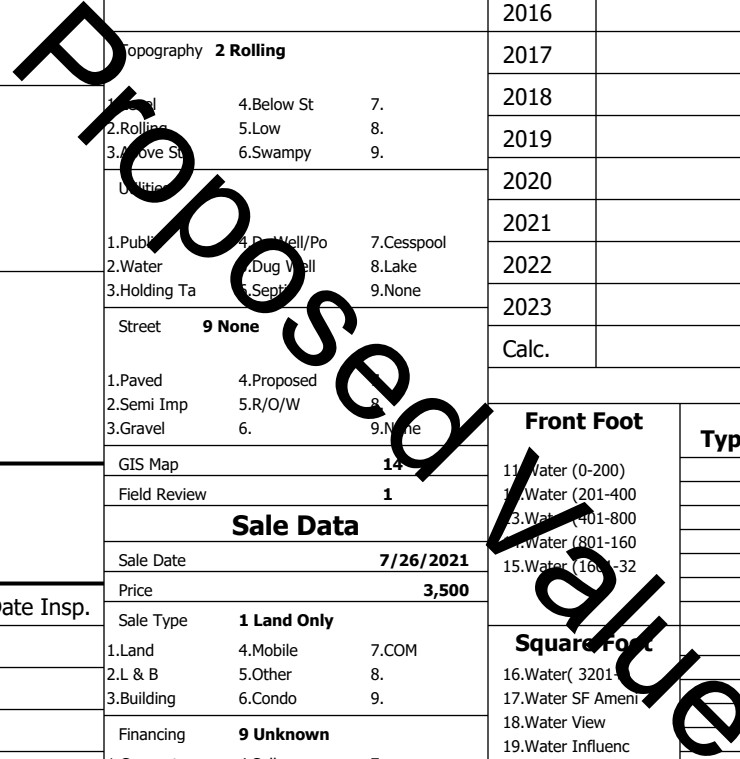

Gray

Map Lot 014-021-026-001

Account 1132

Location WEYMOUTH RD

Card 1

Of 1

8/05/2024

| | | |
|----------------------------------|---|--------------------------------|
| Building Style 0 | SF Bsmt Living 0 | Layout 0 |
| 1.Conv. 5.Garrison 9.NE farm | Fin Bsmt Grade 0 0 | 1.Typical 4. 7. |
| 2.Ranch 6.Split 10.Colonia | Secondary Heat 0 | 2.Inadeq 5. 8. |
| 3.R Ranch/ 7.Contemp 11.Cottage | Heat Type 100% 0 | 3. 6. 9. |
| 4.Cape 8.Log 12.Gambrel | 1.HWBB 5.FWA 9.None | Attic 0 |
| Dwelling Units 0 | 2.HWCI 6.Monitor 10.UNH2F | 1.1/4 Fin 4.Full Fin 7. |
| Other Units 0 | 3.HWRF 7.Electric 11.Geother | 2.1/2 Fin 5.FI/Stair 8. |
| Stories 0 | 4.Steam 8.FI/Wall 12.Heat/Co | 3.3/4 Fin 6. 9.None |
| 1.1 4.1.5 7. | Cool Type 0% 9 None | Insulation 0 |
| 2.2 5.1.75 8. | 1.Central 4.W&C Air 7. | 1.Full 4.Minimal 7. |
| 3.3 6.2.5 9. | 2.Evapor 5. 8. | 2.Heavy 5. 8. |
| Exterior Walls 0 | 3.H Pump 6. 9.None | 3.Capped 6. 9.None |
| 1.Clapboar 5.Stucco 9.B & B | Kitchen Style 0 | Unfinished % 0% |
| 2.Vin/Al 6.Brick 10.Cemplan | 1.Modern 4.Obsolete | Grade & Factor 0 0% |
| 3.Compos./ 7.Stone 11.Concret | 2.Typical 5. 8. | 1.E Grade 4.B Grade 7.SC Grade |
| 4.Asbestos 8.Wood Shi 12.Wood Bo | 3.Old Type 6. 9.None | 2.C Grade 5.A Grade 8. |
| Roof Surface 0 | Bath(s) Style 0 | 3.D Grade 6.AA Grade 9.Same |
| 1.Asphalt 4.Composit 7.Other | 1.Modern 4.Obsolete 7. | SQFT (Footprint) 0 |
| 2.Slate 5.Wood 8. | 2.Typical 5. 8. | 1.Poor Avg 7.V G |
| 3.Metal 6.Roll Roo 9. | 3.Old Type 6. 9.None | 2.Fair Avg 8.Exc |
| SF Masonry Trim 0 | # Rooms 0 | 3.Avg- Good 9.Same |
| SOLAR VOLTAIC 0 | # Bedrooms 0 | Phys. % Good 0% |
| OPEN-4- 0 | # Full Baths 0 | Funct. % Good 100% |
| Year Built 0 | # Half Baths 0 | Functional Code 9 None |
| Year Remodeled 0 | # Addn Fixtures 0 | 1.Incomp 4.Delap 7.Layoff |
| Foundation 0 | # Fireplaces 0 | 2.O-Built 5.Bsmt 8.Long term |
| 1.Concrete 4.Wood 7. |  | 3.Damage 6.Style None |
| 2.C Block 5.Slab 8. | | Econ. % Good 100% |
| 3.Br/Stone 6.Piers 9. | | Economic Code None |
| Basement 0 | | 0.None 3.No Power 6.Obsolete |
| 1.1/4 Bmt 4.Full Bmt 7. | | 1.Location 4.Generate 9.None |
| 2.1/2 Bmt 5.Crwl 8. | | 2.Encroach 5.Flood Pl 9. |
| 3.3/4 Bmt 6. 9.None | | Entrance Code 0 |
| Bsmt Gar # Cars 0 | | 1.Interior 4.Vacant 7. |
| Wet Basement 0 | | 2.Refusal 5.Estimate 8. |
| 1.Dry 4. 7. | | 3.Informed 6. 9. |
| 2.Damp 5. 8. | Information Code 0 | |
| 3.Wet 6. 9. | 1.Owner 4.Agent 7. | |
| | 2.Relative 5.Estimate 8. | |
| | 3.Tenant 6.Other 9. | |

Date Inspected

Additions, Outbuildings & Improvements

| Type | Year | Units | Grade | Cond | Phys. | Funct. | Sound Value |
|------|------|-------|-------|------|-------|--------|-------------------|
| | | | | | % | % | 1.One Story Fram |
| | | | | | % | % | 2.Two Story Fram |
| | | | | | % | % | 3.Three Story Fr |
| | | | | | % | % | 4.1 & 1/2 Story |
| | | | | | % | % | 5.1 & 3/4 Story |
| | | | | | % | % | 6.2 & 1/2 Story |
| | | | | | % | % | 21.Open Frame Por |
| | | | | | % | % | 22.Encl Frame Por |
| | | | | | % | % | 23.Frame Garage |
| | | | | | % | % | 24.Frame Shed |
| | | | | | % | % | 25.Frame Bay Wind |
| | | | | | % | % | 26.1SFr Overhang |
| | | | | | % | % | 27.Unfin Basement |
| | | | | | % | % | 28.Unfinished Att |
| | | | | | % | % | 29.Finished Attic |

Proposed Value