

ASALI, ANDREW LOUIS
308 SHAKER ROAD
GRAY ME 04039

B38454P103

Previous Owner
OLSEN, CHRISTIAN D
OLSEN, LYNNE E
PO BOX 94
BRIDGTON ME 04009
Sale Date: 7/22/2021

Property Data			Assessment Record				
Neighborhood	81 Fair-Traffic		Year	Land	Buildings	Exempt	Total
Tree Growth Year	0		2011	37,100	132,306	0	169,406
REVIEW	0		2012	37,100	132,306	0	169,406
Building Permit	0		2013	37,100	132,306	0	169,406
Zone/Land Use	12 Limited Residential		2014	37,100	137,706	0	174,806
Secondary Zone	11 Rural Res & Ag		2015	37,100	150,400	0	187,500
Topography	1 Level		2016	37,100	150,400	0	187,500
			2017	37,100	152,100	0	189,200
			2018	37,100	152,100	0	189,200
			2019	45,100	214,000	0	259,100
			2020	45,100	214,000	0	259,100
			2021	45,100	214,000	0	259,100
			2022	45,100	220,100	0	265,200
			2023	45,100	247,400	0	292,500
			Calc.	107,000	419,300	0	526,300

Land Data		Effective		Influence		Influence Codes
Type	Front Foot	Frontage	Depth	Factor	Code	
	11. Water (0-200)			%		1.Unimproved
	12. Water (201-400)			%		2.Excess Frtg
	13. Water (401-800)			%		3.Topography
	14. Water (801-160)			%		4.Size/Shape
	15. Water (1601-32)			%		5.Access
				%		6.Restriction
				%		7.Open Space
				%		8.Environmental
				%		9.Condo
				%		30.Blueberry(1-20
				%		31.Blueberry(21 -
				%		32.Crop Land
				%		33.Pasture
				%		34.Shorefront B
				%		35.Shorefront C
				%		36.ANTENNA SITE
				%		37.Softwood TG
				%		38.Mixed Wood TG
				%		39.Hardwood TG
				%		40.Wasteland
				%		41.Woodland
				%		42.Mobile Home Si
				%		43.Camp Site
				%		44.Lot Improvemen
				%		45.BA SF - Oce
				%		46.SP Meadow Cond
Total Acreage		0.65				

Inspection Witnessed By:

X	Date
No./Date	Description
	Date Insp.

Notes:
5/24- DR FIELD REVIEW

Gray

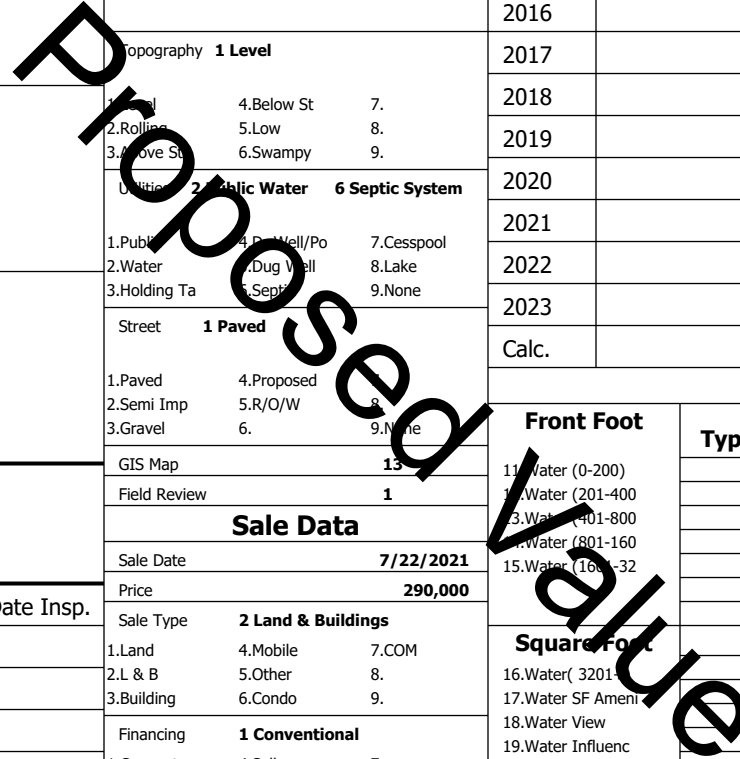

Gray

Map Lot 013-103-026-000

Account 3080

Location 308 SHAKER RD

Card 1 Of 1

8/05/2024

Building Style 1 Conventional	SF Bsmt Living 0	Layout 1 Typical
1.Conv. 5.Garrison 9.NE farm	Fin Bsmt Grade 0 0	1.Typical 4. 7.
2.Ranch 6.Split 10.Colonia	Secondary Heat 0	2.Inadeq 5. 8.
3.R Ranch/ 7.Contemp 11.Cottage	Heat Type 100% 6 Monitor	3. 6. 9.
4.Cape 8.Log 12.Gambrel	1.HWBB 5.FWA 9.None	Attic 9 None
Dwelling Units 2	2.HWCI 6.Monitor 10.UNH2F	1.1/4 Fin 4.Full Fin 7.
Other Units 0	3.HWRF 7.Electric 11.Geother	2.1/2 Fin 5.F/Stair 8.
Stories 2 Two Story	4.Steam 8.F/Wall 12.Heat/Co	3.3/4 Fin 6. 9.None
1.1 4.1.5 7.	Cool Type 0% 4 Warm & Cool Air	Insulation 1 Full
2.2 5.1.75 8.	1.Central 4.W&C Air 7.	1.Full 4.Minimal 7.
3.3 6.2.5 9.	2.Evapor 5. 8.	2.Heavy 5. 8.
Exterior Walls 2 Vinyl/Aluminum	3.H Pump 6. 9.None	3.Capped 6. 9.None
1.Clapboard 5.Stucco 9.B & B	Kitchen Style 2 Typical	Unfinished % 0%
2.Vin/Al 6.Brick 10.Cemplan	1.Modern 4.Obsolete	Grade & Factor 3 Average 110%
3.Compos./ 7.Stone 11.Concret	2.Typical 5. 8.	1.E Grade 4.B Grade 7.SC Grade
4.Asbestos 8.Wood Shi 12.Wood Bo	3.Old Type 6. 9.None	2.D Grade 5.A Grade 8.
Roof Surface 1 Asphalt Shingles	Bath(s) Style 2 Typical Bath(s)	3.Grade 6.AA Grade 9.Same
1.Asphalt 4.Composit 7.Other	1.Modern 4.Obsolete 7.	SQFT (Footprint) 768
2.Slate 5.Wood 8.	2.Typical 5. 8.	Condition 5 Good
3.Metal 6.Roll Roo 9.	3.Old Type 6. 9.None	1.Poor 2.Avg 7.V G
SF Masonry Trim 0	# Rooms 7	2.Fair 3.Good 8.Exc
SOLAR VOLTAIC 0	# Bedrooms 3	3.Avg- 4.Good 9.Same
OPEN-4- 0	# Full Baths 2	Phys. % Good 0%
Year Built 1985	# Half Baths 0	Funct. % Good 100%
Year Remodeled 0	# Addn Fixtures 1	Functional Code 9 None
Foundation 2 Concrete Block	# Fireplaces 0	1.Incomp 4.Delap 5.Layoff
1.Concrete 4.Wood 7.		2.O-Built 5.Bsmt 6.Long term
2.C Block 5.Slab 8.		3.Damage 6.Style 9.None
3.Br/Stone 6.Piers 9.		Econ. % Good 100%
Basement 0		Economic Code None
1.1/4 Bmt 4.Full Bmt 7.		0.None 3.No Power 6.Obsolete
2.1/2 Bmt 5.Crwl 8.		1.Location 4.Generate 9.None
3.3/4 Bmt 6. 9.None		2.Encroach 5.Flood Pl 9.
Bsmt Gar # Cars 1		Entrance Code 5 Estimated
Wet Basement 3 Wet Basement		1.Interior 4.Vacant 7.
1.Dry 4. 7.		2.Refusal 5.Estimate 8.
2.Damp 5. 8.	3.Informed 6. 9.	
3.Wet 6. 9.	Information Code 5 Estimate	
	1.Owner 4.Agent 7.	
	2.Relative 5.Estimate 8.	
	3.Tenant 6.Other 9.	

Date Inspected 5/09/2024

Additions, Outbuildings & Improvements

Type	Year	Units	Grade	Cond	Phys.	Funct.	Sound Value
11 1 Story/Basement	0	704	3 100	0	0 %	100 %	
11 1 Story/Basement	2013	384	3 100	0	0 %	100 %	
21 Open Frame	0	174	0 0	0	0 %	100 %	
68 Wood Deck	0	60	0 0	0	0 %	100 %	
1 One Story Frame	2013	104	0 0	0	0 %	100 %	
					%	%	
					%	%	
					%	%	
					%	%	
					%	%	
					%	%	
					%	%	

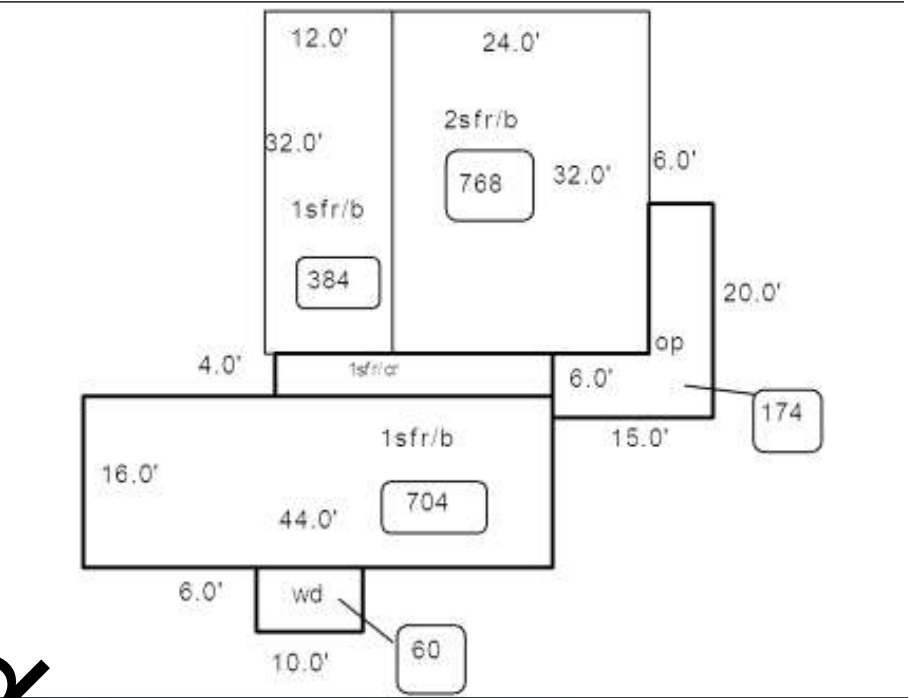

Proposed Value