

THOITS - ET AL, PETER R  
282 SHAKER ROAD  
GRAY ME 04039

B40300P313

Previous Owner  
THOITS, PETER R  
THOITS, FERN E  
282 SHAKER ROAD  
GRAY ME 04039  
Sale Date: 8/14/2023

Property Data		
Neighborhood	81 Fair-Traffic	
Tree Growth Year	0	
REVIEW	0	
Building Permit	0	
Zone/Land Use	11 Rural Residential & Agri	
Secondary Zone	23 Lake District	
Topography	1 Level	
1. Soil	4. Below St	7.
2. Rolling	5. Low	8.
3. Above St	6. Swampy	9.
Utilities	2 Public Water 6 Septic System	
1. Public	4. Dr. Well/Po	7. Cesspool
2. Water	5. Dug Well	8. Lake
3. Holding Ta	6. Septic	9. None
Street	1 Paved	
1. Paved	4. Proposed	8.
2. Semi Imp	5. R/O/W	9.
3. Gravel	6.	
GIS Map	15	
Field Review	1	
Sale Data		
Sale Date	8/14/2023	
Price	120,000	
Sale Type	2 Land & Buildings	
1. Land	4. Mobile	7. COM
2. L & B	5. Other	8.
3. Building	6. Condo	9.
Financing	9 Unknown	
1. Convent	4. Seller	7.
2. FHA/VA	5. Private	8.
3. Assumed	6. Cash	9. Unknown
Validity	5 Partial Interest	
1. Valid	4. Split	7. Multiple
2. Related	5. Partial	8. Other
3. Distress	6. Exempt	9. Estate
Verified	5 Public Record	
1. Buyer	4. Agent	7. Family
2. Seller	5. Pub Rec	8. Other
3. Lender	6. MLS	9.

Assessment Record				
Year	Land	Buildings	Exempt	Total
2011	32,900	73,906	8,500	98,306
2012	32,900	73,906	8,500	98,306
2013	32,900	73,906	8,500	98,306
2014	32,900	73,906	8,500	98,306
2015	32,900	73,900	9,000	97,800
2016	32,900	73,900	9,000	97,800
2017	32,900	73,900	13,500	93,300
2018	32,900	73,900	18,000	88,800
2019	46,200	54,600	20,000	80,800
2020	46,200	54,600	20,000	80,800
2021	46,200	54,600	25,000	75,800
2022	46,200	54,600	25,000	75,800
2023	46,200	73,000	25,000	94,200
Calc.	100,600	319,200	25,000	394,800

Inspection Witnessed By:

X	Date
No./Date	Description
	Date Insp.

Notes:  
8/14/2023 - B40300P313 - Owners of Record are: Peter R. Thoits, Fern E Dunning-Thoits, and Darcey Thoits as Joint Tenants. 5/24- DR FIELD REVIEW

Gray

Land Data					
Type	Effective		Influence		Influence Codes
	Frontage	Depth	Factor	Code	
1. Water (0-200)			%		1. Unimproved
2. Water (201-400)			%		2. Excess Frtg
3. Water (401-800)			%		3. Topography
4. Water (801-1600)			%		4. Size/Shape
5. Water (1601-3200)			%		5. Access
6. Water (3201-6400)			%		6. Restriction
7. Water (6401-12800)			%		7. Open Space
8. Water (12801-25600)			%		8. Environmental
9. Water (25601-51200)			%		9. Condo
10. Water (51201-102400)			%		
11. Water (102401-204800)			%		
12. Water (204801-409600)			%		
13. Water (409601-819200)			%		
14. Water (819201-1638400)			%		
15. Water (1638401-3276800)			%		
16. Water (3276801-6553600)			%		
17. Water SF Amenities			%		
18. Water View			%		
19. Water Influenced			%		
20. ShoreFront A			%		
21. Base Lot			%		
22. Base Lot Vacant			%		
23. Base Lot Unpaved			%		
24. Acres to 10			%		
25. Acres 11-30			%		
26. Acres 31-50			%		
27. Acres 51 & over			%		
28. Acres 71 & Over			%		
29. Woods (41+)			%		
<b>Total Acreage</b> 0.35					

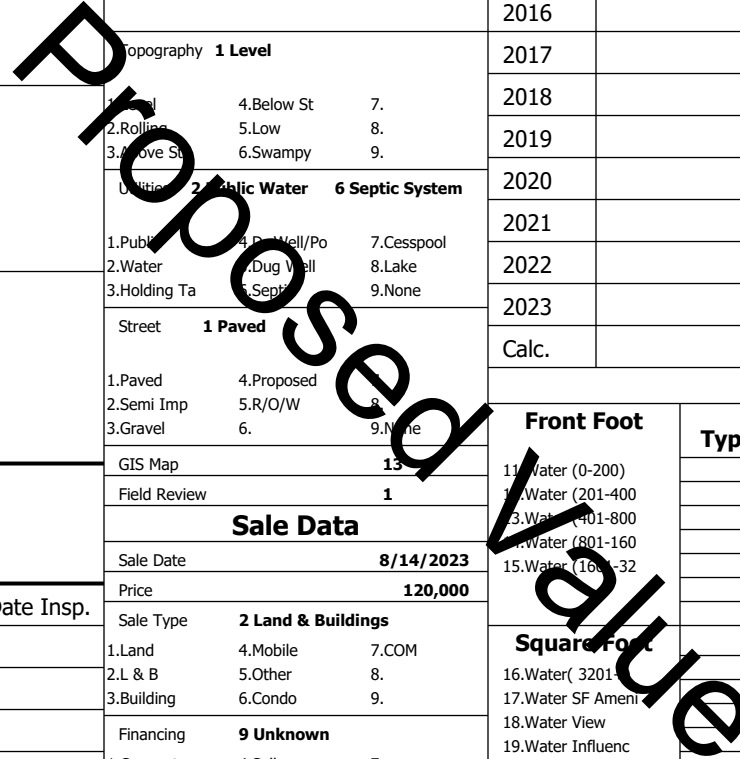

**Gray**

Map Lot 013-102-072-000

Account 3014

Location 282 SHAKER RD

Card 1

Of 1

8/05/2024

Building Style <b>1 Conventional</b>	SF Bsmt Living <b>0</b>	Layout <b>1 Typical</b>
1.Conv. 5.Garrison 9.NE farm	Fin Bsmt Grade <b>0 0</b>	1.Typical 4. 7.
2.Ranch 6.Split 10.Colonia	Secondary Heat <b>0</b>	2.Inadeq 5. 8.
3.R Ranch/ 7.Contemp 11.Cottage	Heat Type <b>100% 5 Forced Warm Air</b>	3. 6. 9.
4.Cape 8.Log 12.Gambrel	1.HWBB 5.FWA 9.None	Attic <b>9 None</b>
Dwelling Units <b>1</b>	2.HWCI 6.Monitor 10.UNH2F	1.1/4 Fin 4.Full Fin 7.
Other Units <b>0</b>	3.HWRF 7.Electric 11.Geother	2.1/2 Fin 5.FI/Stair 8.
Stories <b>5 One &amp; 3/4 Story</b>	4.Steam 8.FI/Wall 12.Heat/Co	3.3/4 Fin 6. 9.None
1.1 4.1.5 7.	Cool Type <b>0% 9 None</b>	Insulation <b>3 Capped Only</b>
2.2 5.1.75 8.	1.Central 4.W&C Air 7.	1.Full 4.Minimal 7.
3.3 6.2.5 9.	2.Evapor 5. 8.	2.Heavy 5. 8.
Exterior Walls <b>2 Vinyl/Aluminum</b>	3.H Pump 6. 9.None	3.Capped 6. 9.None
1.Clapboard 5.Stucco 9.B & B	Kitchen Style <b>2 Typical</b>	Unfinished % <b>0%</b>
2.Vin/Al 6.Brick 10.Cemplan	1.Modern 4.Obsolete	Grade & Factor <b>3 Average 110%</b>
3.Compos./ 7.Stone 11.Concret	2.Typical 5. 8.	1.E Grade 4.B Grade 7.SC Grade
4.Asbestos 8.Wood Shi 12.Wood Bo	3.Old Type 6. 9.None	2.C Grade 5.A Grade 8.
Roof Surface <b>1 Asphalt Shingles</b>	Bath(s) Style <b>2 Typical Bath(s)</b>	3.Grade 6.AA Grade 9.Same
1.Asphalt 4.Composit 7.Other	1.Modern 4.Obsolete 7.	SQFT (Footprint) <b>774</b>
2.Slate 5.Wood 8.	2.Typical 5. 8.	Foundation <b>5 Above Average</b>
3.Metal 6.Roll Roo 9.	3.Old Type 6. 9.None	1.Poor Avg 7.V G
SF Masonry Trim <b>0</b>	# Rooms <b>8</b>	2.Fair Avg 8.Exc
SOLAR VOLTAIC <b>0</b>	# Bedrooms <b>4</b>	3.Avg- Good 9.Same
OPEN-4- <b>0</b>	# Full Baths <b>2</b>	Phys. % Good <b>0%</b>
Year Built <b>1920</b>	# Half Baths <b>0</b>	Funct. % Good <b>100%</b>
Year Remodeled <b>0</b>	# Addn Fixtures <b>0</b>	Functional Code <b>9 None</b>
Foundation <b>3 Brick &amp;/or Stone</b>	# Fireplaces <b>0</b>	1.Incomp 4.Delap 7.Playoff
1.Concrete 4.Wood 7.		2.O-Built 5.Bsmt 8.Long term
2.C Block 5.Slab 8.		3.Damage 6.Style None
3.Br/Stone 6.Piers 9.		Econ. % Good <b>100%</b>
Basement <b>2 1/2 Basement</b>		Economic Code <b>None</b>
1.1/4 Bmt 4.Full Bmt 7.		0.None 3.No Power 6.Obsolete
2.1/2 Bmt 5.Crwl 8.		1.Location 4.Generate 9.None
3.3/4 Bmt 6. 9.None		2.Encroach 5.Flood Pl 9.
Bsmt Gar # Cars <b>0</b>		Entrance Code <b>5 Estimated</b>
Wet Basement <b>1 Dry Basement</b>		1.Interior 4.Vacant 7.
1.Dry 4. 7.		2.Refusal 5.Estimate 8.
2.Damp 5. 8.		3.Informed 6. 9.
3.Wet 6. 9.		Information Code <b>5 Estimate</b>
		1.Owner 4.Agent 7.
		2.Relative 5.Estimate 8.
		3.Tenant 6.Other 9.

Date Inspected 5/09/2024

**Additions, Outbuildings & Improvements**

Type	Year	Units	Grade	Cond	Phys.	Funct.	Sound Value
1 One Story Frame	0	180	0 0	0	0	100 %	
68 Wood Deck	1980	280	0 0	0	0	100 %	
68 Wood Deck	2023	20	0 0	0	0	100 %	
68 Wood Deck	2023	64	0 0	0	0	100 %	
1 One Story Frame	2023	640	3 110	4	0	100 %	
28 Unfinished Attic	2023	352	3 100	4	0	100 %	
					%	%	
					%	%	
					%	%	
					%	%	
					%	%	

