

SOMMA, JOSEPH V
SOMMA, MARY L
16 MARIE ST
GRAY ME 04039

B11453P203

Inspection Witnessed By:

No./Date	Description	Date Insp.
X		

Notes:
5/24- DR FIELD REVIEW

Gray

Property Data			Assessment Record						
Neighborhood 82 Average Location			Year	Land	Buildings	Exempt	Total		
Tree Growth Year 0			2011	35,000	92,330	0	127,330		
REVIEW 0			2012	35,000	92,330	0	127,330		
Building Permit 0			2013	35,000	92,330	0	127,330		
Zone/Land Use 11 Rural Residential & Agri			2014	35,000	92,330	0	127,330		
Secondary Zone			2015	35,000	92,300	0	127,300		
Topography 1 Level			2016	35,000	92,300	0	127,300		
1. Hill 4. Below St 7.			2017	35,000	93,300	0	128,300		
2. Rolling 5. Low 8.			2018	35,000	93,300	0	128,300		
3. Above St 6. Swampy 9.			2019	50,500	163,300	0	213,800		
Utilities 2 Public Water 6 Septic System			2020	50,500	163,300	0	213,800		
1. Public 4. Drilled Well/Po 7. Cesspool			2021	50,500	163,300	0	213,800		
2. Water 8. Dug Well 8. Lake			2022	50,500	163,300	25,000	188,800		
3. Holding Ta 9. None			2023	50,500	185,400	25,000	210,900		
Street 1 Paved			Calc.	109,700	212,400	25,000	297,100		
1. Paved 4. Proposed			Land Data						
2. Semi Imp 5. R/O/W			Front Foot	Type	Effective		Influence		Influence Codes
3. Gravel 6. None					Frontage	Depth	Factor	Code	
GIS Map 15			11. Water (0-200)				%		1. Unimproved
Field Review 1			12. Water (201-400)				%		2. Excess Frtg
Sale Data			13. Water (401-800)				%		3. Topography
Sale Date 5/27/1994			14. Water (801-160)				%		4. Size/Shape
Price			15. Water (161-32)				%		5. Access
Sale Type							%		6. Restriction
1. Land 4. Mobile 7.COM			Square Foot	Square Feet					7. Open Space
2. L & B 5. Other 8.			16. Water (3201-				%		8. Environmental
3. Building 6. Condo 9.			17. Water SF Amen				%		9. Condo
Financing			18. Water View				%		Acres
1. Convent 4. Seller 7.			19. Water Influen				%		30. Blueberry(1-20
2. FHA/VA 5. Private 8.			20. ShoreFront A				%		31. Blueberry(21 -
3. Assumed 6. Cash 9.Unknown							%		32. Crop Land
Validity			Fract. Acre	Acreege/Sites					33. Pasture
1. Valid 4. Split 7. Multiple			21. Base Lot	21	0.50	100	%	0	34. Shorefront B
2. Related 5. Partial 8. Other			22. Base Lot Vacan				%		35. Shorefront C
3. Distress 6. Exempt 9. Estate			23. Base Lot Unpav				%		36. ANTENNA SITE
Verified			Acres				%		37. Softwood TG
1. Buyer 4. Agent 7. Family			24. Acres to 10				%		38. Mixed Wood TG
2. Seller 5. Pub Rec 8. Other			25. Acres 11-30				%		39. Hardwood TG
3. Lender 6. MLS 9.			26. Acres 31-50				%		40. Wasteland
			27. Acres 51& over				%		41. Woodland
			28. Acres 71 & Ove				%		42. Mobile Home Si
			29. Woods (41+)				%		43. Camp Site
			Total Acreage	0.50					44. Lot Improvemen
									45. BA SF - Oce
									46. SP Meadow Cond

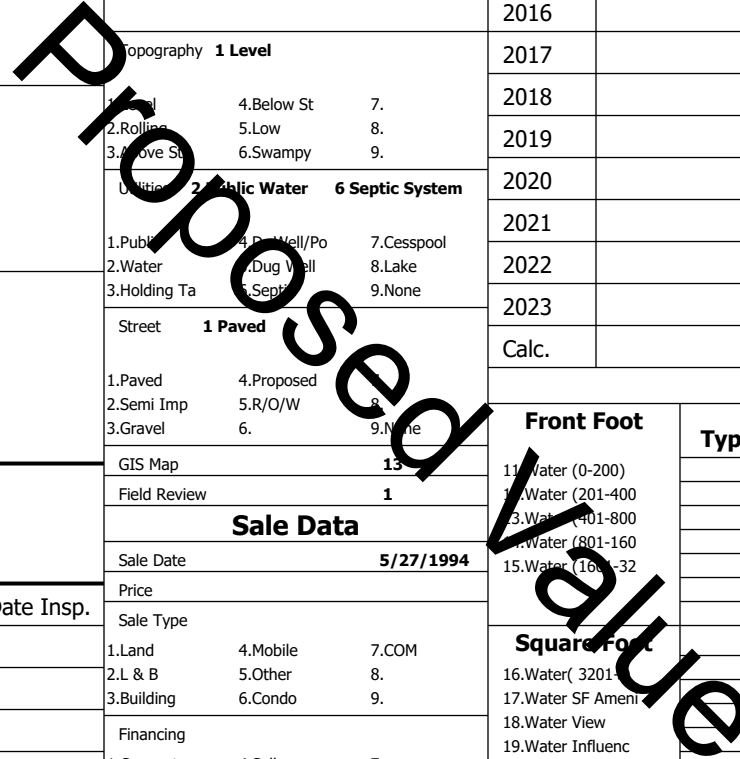

Building Style 3 Raised Ranch/Split	SF Bsmt Living 650	Layout 1 Typical
1.Conv. 5.Garrison 9.NE farm	Fin Bsmt Grade 3 100	1.Typical 4. 7.
2.Ranch 6.Split 10.Colonia	Secondary Heat 0	2.Inadeq 5. 8.
3.R Ranch/ 7.Contemp 11.Cottage	Heat Type 100% 1 Hot Water BB	3. 6. 9.
4.Cape 8.Log 12.Gambrel	1.HWBB 5.FWA 9.None	Attic 9 None
Dwelling Units 1	2.HWCI 6.Monitor 10.UNH2F	1.1/4 Fin 4.Full Fin 7.
Other Units 0	3.HWRF 7.Electric 11.Geother	2.1/2 Fin 5.F/Stair 8.
Stories 1 One Story	4.Steam 8.F/Wall 12.Heat/Co	3.3/4 Fin 6. 9.None
1.1 4.1.5 7.	Cool Type 0% 9 None	Insulation 1 Full
2.2 5.1.75 8.	1.Central 4.W&C Air 7.	1.Full 4.Minimal 7.
3.3 6.2.5 9.	2.Evapor 5. 8.	2.Heavy 5. 8.
Exterior Walls 8 Wood Shingle	3.H Pump 6. 9.None	3.Capped 6. 9.None
1.Clapboar 5.Stucco 9.B & B	Kitchen Style 2 Typical	Unfinished % 0%
2.Vin/Al 6.Brick 10.Cemplan	1.Modern 4.Obsolete	Grade & Factor 3 Average 100%
3.Compos./ 7.Stone 11.Concret	2.Typical 5. 8.	1.E Grade 4.B Grade 7.SC Grade
4.Asbestos 8.Wood Shi 12.Wood Bo	3.Old Type 6. 9.None	2.D Grade 5.A Grade 8.
Roof Surface 3 Metal	Bath(s) Style 2 Typical Bath(s)	3.Grade 6.AA Grade 9.Same
1.Asphalt 4.Composit 7.Other	1.Modern 4.Obsolete 7.	SQFT (Footprint) 912
2.Slate 5.Wood 8.	2.Typical 5. 8.	Condition 4 Average
3.Metal 6.Roll Roo 9.	3.Old Type 6. 9.None	1.Poor 2.Avg 7.V G
SF Masonry Trim 0	# Rooms 6	2.Fair 3.Good 8.Exc
SOLAR VOLTAIC 0	# Bedrooms 3	3.Avg- 4.Good 9.Same
OPEN-4- 0	# Full Baths 1	Phys. % Good 0%
Year Built 1972	# Half Baths 0	Funct. % Good 100%
Year Remodeled 0	# Addn Fixtures 0	Functional Code 9 None
Foundation 1 Concrete	# Fireplaces 0	1.Incomp 4.Delap 5.Delay
1.Concrete 4.Wood 7.		2.O-Built 5.Bsmt 6.Long term
2.C Block 5.Slab 8.		3.Damage 6.Style 7.None
3.Br/Stone 6.Piers 9.		Econ. % Good 100%
Basement 4 Full Basement		Economic Code None
1.1/4 Bmt 4.Full Bmt 7.		0.None 3.No Power 6.Obsolete
2.1/2 Bmt 5.Crwl 8.		1.Location 4.Generate 9.None
3.3/4 Bmt 6. 9.None		2.Encroach 5.Flood Pl 9.
Bsmt Gar # Cars 0		Entrance Code 5 Estimated
Wet Basement 1 Dry Basement		1.Interior 4.Vacant 7.
1.Dry 4. 7.		2.Refusal 5.Estimate 8.
2.Damp 5. 8.		3.Informed 6. 9.
3.Wet 6. 9.		Information Code 5 Estimate
		1.Owner 4.Agent 7.
		2.Relative 5.Estimate 8.
		3.Tenant 6.Other 9.

Date Inspected 5/16/2024

Additions, Outbuildings & Improvements

Type	Year	Units	Grade	Cond	Phys.	Funct.	Sound Value
26 1Sfr Overhang	0	16	0 0	0	0	100 %	
26 1Sfr Overhang	0	16	0 0	0	0	100 %	
63 Swimming Pool	0	512	0 0	0	0	50 %	
62 Patio	0	750	0 0	0	0	100 %	
23 Frame Garage	0	576	0 0	0	0	100 %	
68 Wood Deck	2010	264	0 0	0	0	100 %	
24 Frame Shed	0	30	0 0	0	0	100 %	
90 Generator	0	1	0 0	0	0	100 %	
						%	
						%	

- 1.One Story Fram
- 2.Two Story Fram
- 3.Three Story Fr
- 4.1 & 1/2 Story
- 5.1 & 3/4 Story
- 6.2 & 1/2 Story
- 21.Open Frame Por
- 22.Encl Frame Por
- 23.Frame Garage
- 24.Frame Shed
- 25.Frame Bay Wind
- 26.1Sfr Overhang
- 27.Unfin Basement
- 28.Unfinished Att
- 29.Finished Attic

